

Moulinex®

pro first

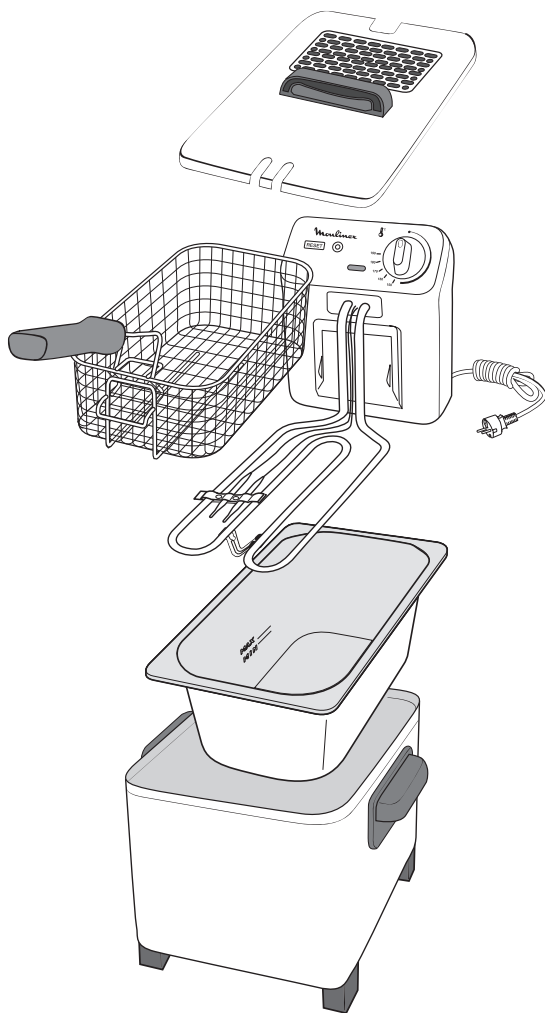

www.moulinex.com



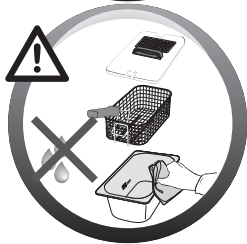
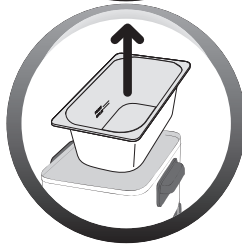
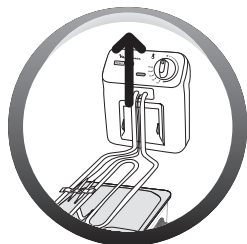
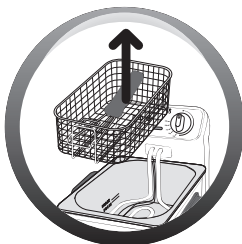
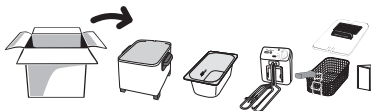
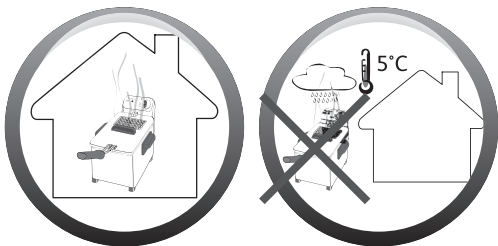

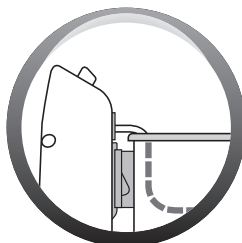
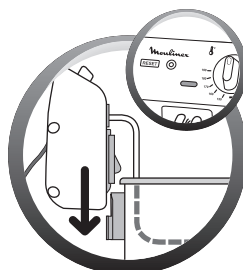
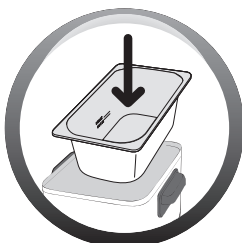
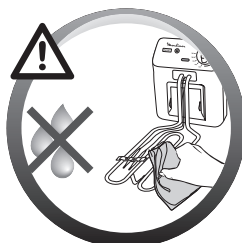
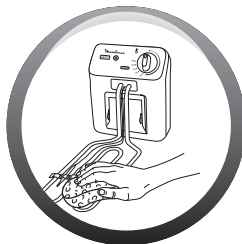



Model 4L
Min. 3,6L
Max. 4L





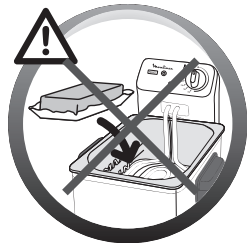
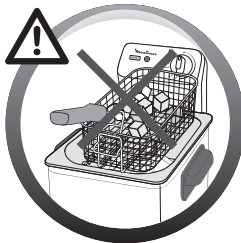
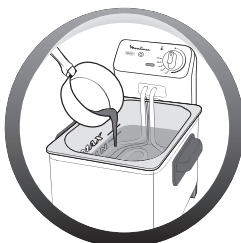

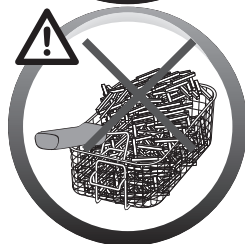
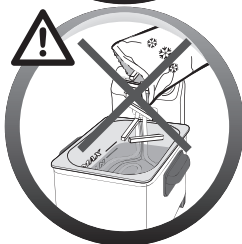
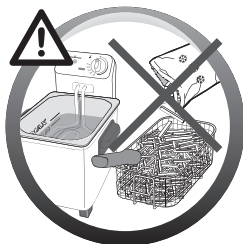
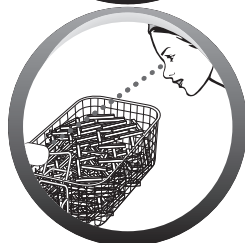
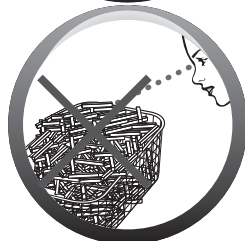
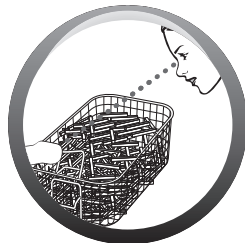

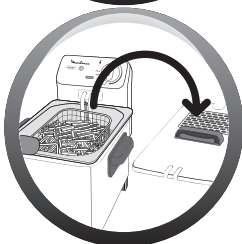
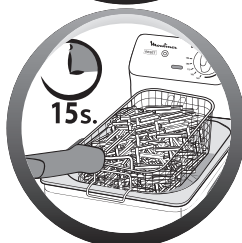
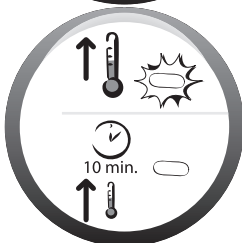
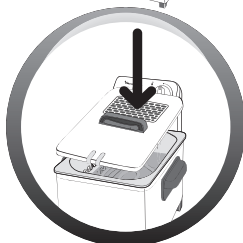
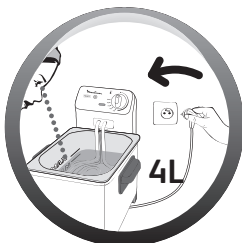



















Model 4L
Min. 3150g
Max. 3500g









| | Nb |  | °C |  |
|---|---|---|-------|---|
|  |  | 600 g | 170°C | 9-12 min. |
|  |  | 1000 g | 170°C | 12-15 min. |
|  |  | 1200 g | 170°C | 9-11 min. |
| | | | 170°C | 6-8 min. |
|  | 8 | | 180°C | 14-16 min. |
|  | 1-2 | | 170°C | 6-8 min. |
|  | 8 | | 150°C | 5-7 min. |
|  | 6-8 | | 170°C | 3-4 min. |
|  | 4 | | 180°C | 5-6 min. |
|  | | 500 g | 180°C | 5-6 min. |
|  | 10-12 | | 180°C | 6-8 min. |
| * * * | Nb |  | °C |  |
|  |  | 450 g | 170°C | 8-12 min. |
|  |  | 900 g | 170°C | 12-16 min. |
|  | | 500 g | 190°C | 8-10 min. |
|  | 8 | | 190°C | 5-7 min. |
|  | | 900 g | 190°C | 6-8 min. |
|  | 1-2 | | 190°C | 14-15 min. |
|  | 12 | | 170°C | 4-5 min. |
|  | 6-8 | | 190°C | 3-4 min. |

