

84050 - Wall Mount for Logitech® Connect

Package Contents:

1. Wall mount
2. Band clamp sub assembly
3. Rubber grommet
4. 1/4" heavy duty lock washers - Qty 2
5. 1/4 - 20 x 3/4" tamper resistant band clamp sub assembly screw
6. 6" hook and loop strap for cable management (not shown)
7. #10 x 1 1/4" tamper resistant mounting screws - Qty 3
8. User's manual

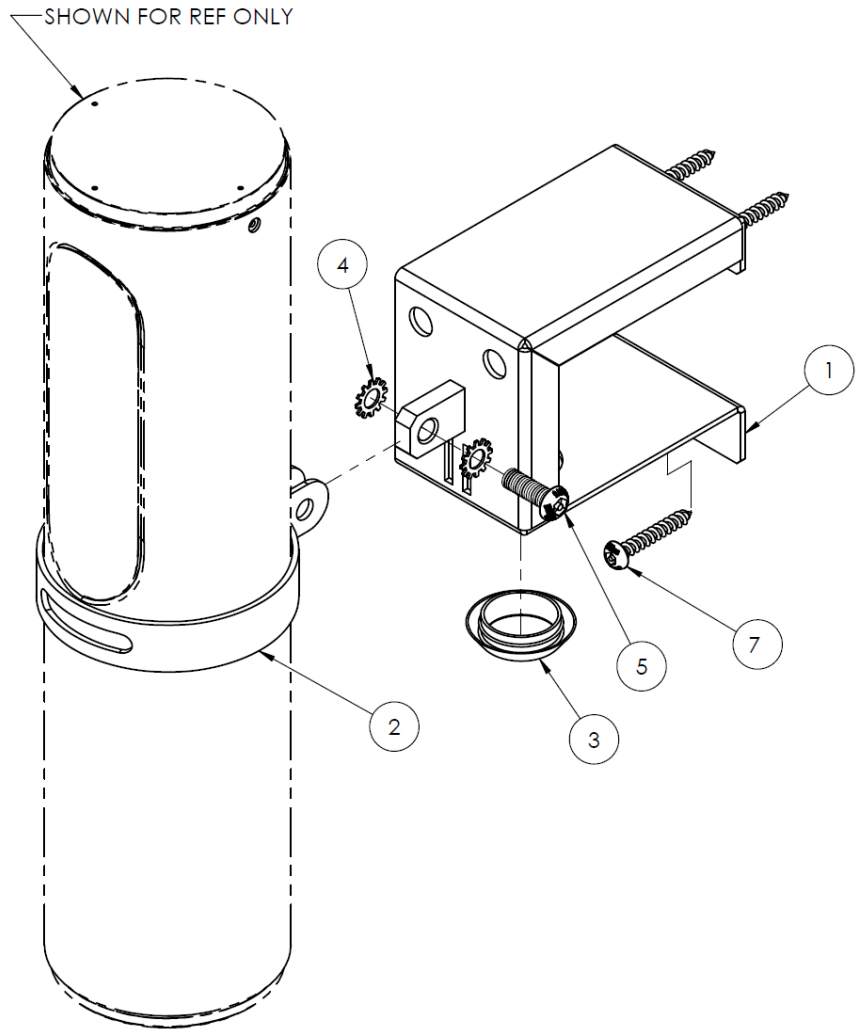

Device Installation:

Note: Prior to installation ensure that all devices are powered off.

Step 1. Locate the rubber grommet and insert it into the hole on the bottom of the wall mount.

Step 2. Determine where the mount will be located.

Note: If wall anchors or other supporting installation devices are needed, please ensure they work with the #10 x 1 1/4" tamper resistant mounting screws or will fit within the U holes and lower mounting hole of the wall mount.

a. Place the mount in its final location, using a level to ensure its level.

b. Mark the surface through the centers of each mounting hole.

c. Drill the marked location to a depth of 1 1/4" using a 1/8" bit.

d. Locate the three #10 x 1 1/4" tamper resistant mounting screws and place them horizontally in the drilled holes, ensuring they are straight and tightened (Do not over tighten as this may strip out the hole).

Step 3. Place the Logitech Connect in the sub assembly band with the Logitech logo fully visible through the oval hole in the front of the sub assembly band.

Step 4.

a. Locate the 1/4" lock washers place one on each side of the mounting post.

b. Line up the sub assembly non-threaded hole and threaded hole with the mounting post and lock washer holes.

c. Insert the 1/4 - 20 x 3/4" tamper resistant band clamp sub assembly screw through the sub assembly non-threaded hole, lock washers, and mounting post holes into the threaded hole of the sub assembly, then tighten till the Logitech connect is secure within the sub assembly.

Step 5. Run the Logitech Connect cables through the rubber grommet and plug them into their coordinating ports.

Step 6. Insert the hook and loop strap through one of the two vertical slits on the back of the mount, then wrap it around the cables and secure the strap to itself, holding the cables firmly in place.

Step 7. Follow all steps in the Logitech Connect manual for setup.