

Inspiron 27 7000

Setup and Specifications

Computer Model: Inspiron 27-7775
Regulatory Model: W16C
Regulatory Type: W16C001



Notes, cautions, and warnings



NOTE: A NOTE indicates important information that helps you make better use of your product.



CAUTION: A CAUTION indicates either potential damage to hardware or loss of data and tells you how to avoid the problem.



WARNING: A WARNING indicates a potential for property damage, personal injury, or death.

Copyright © 2017 Dell Inc. or its subsidiaries. All rights reserved. Dell, EMC, and other trademarks are trademarks of Dell Inc. or its subsidiaries. Other trademarks may be trademarks of their respective owners.

2017 - 05

Rev. A00

Contents

- Set up your computer..... 5**
- Views..... 9**
 - Top..... 9
 - Front..... 9
 - Left..... 10
 - Bottom..... 11
 - Back..... 12
 - Back panel..... 13
 - Tilt..... 15
- Specifications..... 16**
 - Dimensions and weight..... 16
 - System information..... 16
 - Memory..... 16
 - Ports and connectors..... 17
 - Communications..... 17
 - Audio..... 18
 - Storage..... 18
 - Media-card reader..... 18
 - Camera..... 19
 - Video..... 19
 - Stand..... 19
 - Power adapter..... 20
 - Display..... 20
 - Computer environment..... 21



Getting help and contacting Dell..... 22
Self-help resources.....22
Contacting Dell.....22



Set up your computer

- 1 Set up the stand.
 - a) Lift the stand riser.

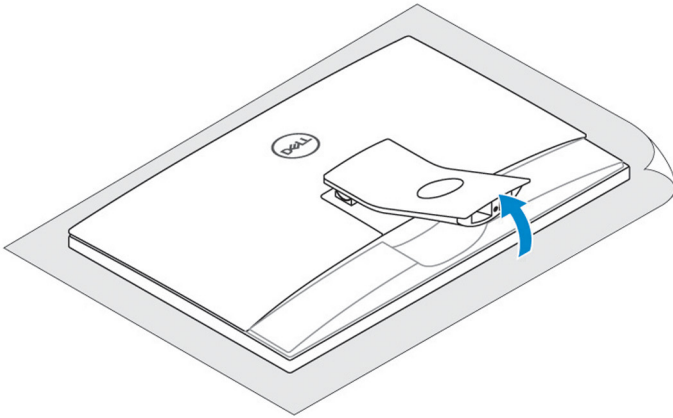

- b) Attach the base.

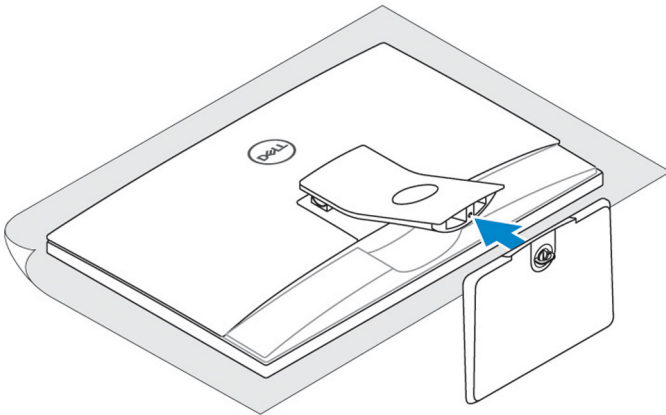

- c) Tighten the captive screw to secure the base to the stand riser.

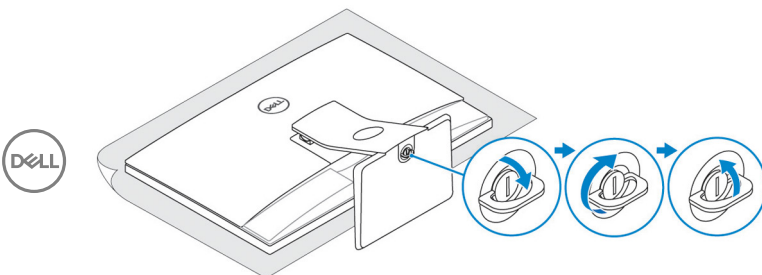

- 2 Set up the keyboard and mouse.
See the documentation that shipped with the keyboard and mouse.
- 3 Connect the power adapter.

 **NOTE:** Route the power-adaptor cable through the routing guide on the stand to avoid potential damage to the adapter.

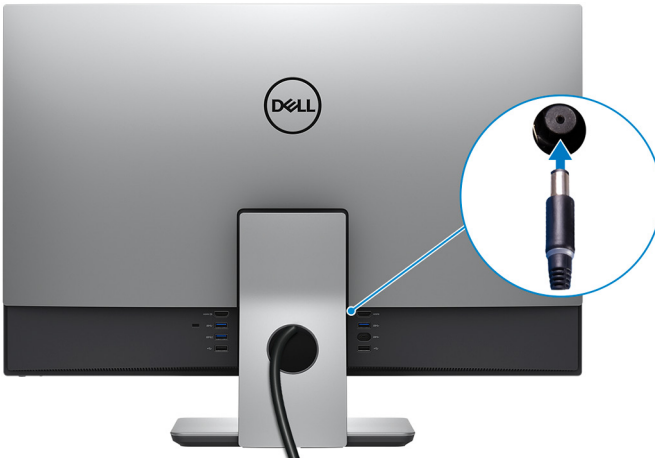

- 4 Press the power button.



5 Finish operating system setup.

For Windows:

- a) Connect to a network.

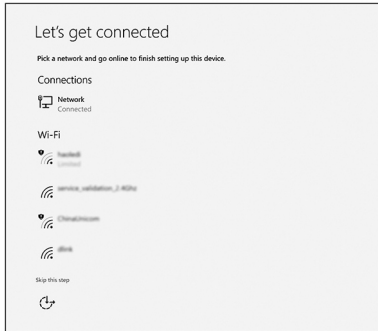

- b) Sign-in to your Microsoft account or create a new account.

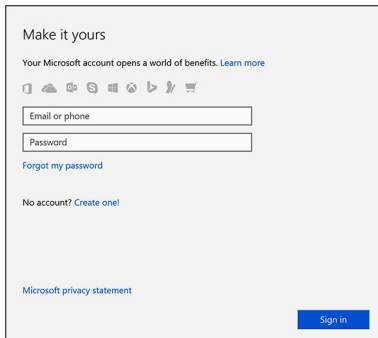

For Ubuntu:

Follow the instructions on the screen to finish setup.



6 Explore Dell resources on your desktop.

Table 1. Locate Dell apps



Register your computer



Dell Help & Support

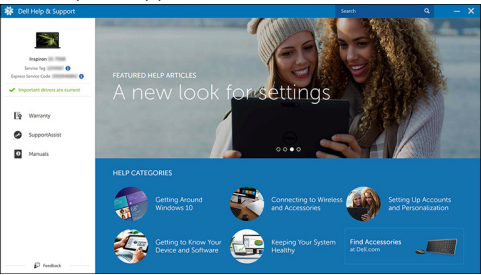

SupportAssist — Check and update your computer



Views

Top



1 **Array microphones (4)**

Provide digital sound input for audio recording, voice calls, and so on.

Front



1 **Infrared emitters (2)**

Emits infrared light, which enables the infrared camera to sense depth and track motion.

2 **Camera-status light**

Turns on when the camera is in use.

3 **Camera**



Enables you to video chat, capture photos, and record videos.

4 **Infrared camera**

Depth-sensing feature of the camera enhances security when paired with Windows Hello face authentication.

Left



1 **SD-card slot**

Reads from and writes to the SD card.

2 **USB 3.1 Generation 1 port with PowerShare**

Connect peripherals such as storage devices and printers.

Provides data transfer speeds up to 5 Gbps. PowerShare enables you to charge your USB devices even when your computer is turned off.



NOTE: If your computer is turned off or in hibernate state, you must connect the power adapter to charge your devices using the PowerShare port. You must enable this feature in the BIOS setup program.



NOTE: Certain USB devices may not charge when the computer is turned off or in sleep state. In such cases, turn on the computer to charge the device.

3 Headset port

Connect a headphone or a headset (headphone and microphone combo).

Bottom

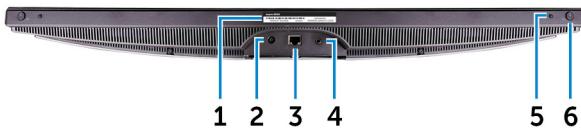

1 Service Tag label

The Service Tag is a unique alphanumeric identifier that enables Dell service technicians to identify the hardware components in your computer and access warranty information.

2 Power-adapter port

Connect a power adapter to provide power to your computer.

3 Network port (with lights)

Connect an Ethernet (RJ45) cable from a router or a broadband modem for network or internet access.

The two lights next to the connector indicate the connectivity status and network activity.

4 Audio-out port

Connect audio-output devices such as speakers, amplifiers, and so on.

5 Input-source selection button

Press to select the video-input source.

6 Power button

Press to turn on the computer if it is turned off, in sleep state, or in hibernate state.

Press to put the computer in sleep state if it is turned on.

Press and hold for 4 seconds to force shut-down the computer.





NOTE: You can customize the power-button behavior in Power Options. For more information, see *Me and My Dell* at www.dell.com/support/manuals.

Back

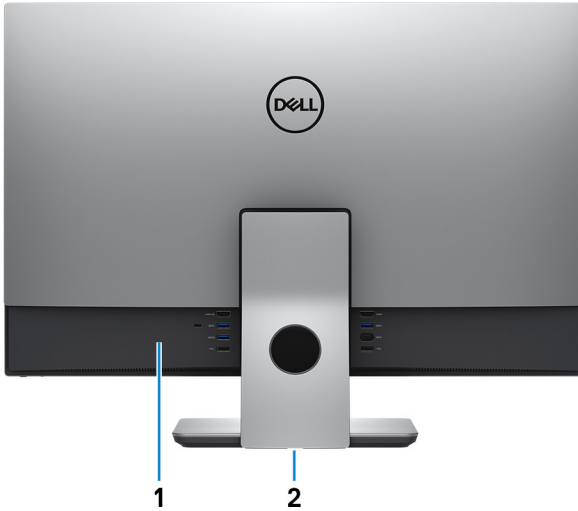

1 Back panel

Connect USB, audio, video, and other devices.

2 Regulatory label

Contains regulatory information of your computer.

Back panel



1 HDMI-in port

Connect a gaming console, Blu-ray player, or other HDMI-out enabled devices.

2 USB 3.1 Generation 1 port

Connect peripherals such as storage devices and printers. Provides data transfer speeds up to 5 Gbps.

3 Security-cable slot (for Kensington locks)

Connect a security cable to prevent unauthorized movement of your computer.

4 USB 3.1 Generation 1 port with PowerShare

Connect peripherals such as storage devices and printers.

Provides data transfer speeds up to 5 Gbps. PowerShare enables you to charge your USB devices even when your computer is turned off.



NOTE: If your computer is turned off or in hibernate state, you must connect the power adapter to charge your devices using the PowerShare port. You must enable this feature in the BIOS setup program.



NOTE: Certain USB devices may not charge when the computer is turned off or in sleep state. In such cases, turn on the computer to charge the device.

5 USB 2.0 port

Connect peripherals such as storage devices and printers. Provides data transfer speeds up to 480 Mbps.

6 USB 2.0 port



Connect peripherals such as storage devices and printers. Provides data transfer speeds up to 480 Mbps.

7 **USB 3.1 Generation 1 (Type-C) port**

Connect to external storage devices. Provides data transfer speeds up to 5 Gbps.



NOTE: This port does not support video/audio streaming.

8 **USB 3.1 Generation 1 port**

Connect peripherals such as storage devices and printers. Provides data transfer speeds up to 5 Gbps.

9 **HDMI-out port**

Connect a TV or another HDMI-in enabled device. Provides video and audio output.

Tilt



Specifications

Dimensions and weight

Table 2. Dimensions and weight

Height	394.10 mm (15.52 in)
Width	613.80 mm (24.17 in)
Depth	53 mm (2.09 in)
Weight (maximum)	10.15 kg (22.38 lb)
Weight (minimum)	10.10 kg (22.27 lb)



NOTE: The weight of your computer varies depending on the configuration ordered and the manufacturing variability.

System information

Table 3. System information

Computer model	Inspiron 27-7775
Processor	<ul style="list-style-type: none">• AMD RYZEN 7 1700• AMD RYZEN 5 1400• AMD RYZEN 3 1200
System chipset	AMD Promontory 2 B350

Memory

Table 4. Memory specifications

Slots	Two SODIMM slots
Type	DDR4



Speed	2400 MHz
Configurations supported	8 GB, 12 GB, 16 GB, 24 GB, and 32 GB

Ports and connectors

Table 5. Ports and connectors specifications

External:	
Network	One RJ45 port
USB	<ul style="list-style-type: none"> One USB 3.1 Generation 1 Type C port Two USB 3.1 Generation 1 ports Two USB 3.1 Generation 1 ports with PowerShare Two USB 2.0 ports
Audio/Video	<ul style="list-style-type: none"> One headset port One audio line-out port One HDMI-out port One HDMI-in port

Table 6. Ports and connectors specifications

Internal:	
M.2 card	One M.2 slot for SSD card

Communications

Table 7. Communication specifications

Ethernet	10/100/1000 Mbps Ethernet controller integrated on system board
Wireless	<ul style="list-style-type: none"> Wi-Fi 802.11a/b/g/n/ac Bluetooth 4.1



Audio

Table 8. Audio specifications

Controller	<ul style="list-style-type: none">Realtek ALC3266-CG Waves MaxxAudio ProRealtek ALC1309 for subwoofer
Speakers	Two
Speaker Output	10 W
Subwoofer output	5 W
Microphone	Array microphone
Volume controls	Program menus

Storage

Table 9. Storage specifications

Interface	<ul style="list-style-type: none">SATA 6 Gbps for hard drivePCIe up to 16 Gbps
Hard drive	One 2.5-inch drive
Capacity supported	Up to 1 TB 7200 rpm
Solid-state drive	One M.2 drive
Capacity supported	<ul style="list-style-type: none">128 GB SATA drive256 GB PCIe4 drive

Media-card reader

Table 10. Media-card reader specifications

Type	One 3-in-1 slot
Cards supported	<ul style="list-style-type: none">SD card



- SD Extended Capacity (SDXC) card
- SD High Capacity (SDHC) card

Camera

Table 11. Camera specifications

Resolution	<ul style="list-style-type: none"> • Still image: 1280 x 720 (HD), 0.92 megapixels • Video: 1280 x 720 (HD) at 30 fps (maximum)
Diagonal viewing angle	74.6 degrees

Video

Table 12. Video specifications

Controller	<ul style="list-style-type: none"> • AMD Radeon RX560 • AMD Radeon RX580
Memory	<ul style="list-style-type: none"> • 4 GB GDDR5 • 8 GB GDDR5

Stand

Table 13. Stand

Height	235.2 mm (9.26 in)
Width	249.20 mm (9.81 in)
Depth	190.10 mm (7.48 in)



Power adapter

Table 14. Power adapter specifications

	180 W	330 W
Input current (maximum)	2.50 A	4.40 A
Output current (continuous)	9.23 A	16.90 A
Input Voltage	100 VAC to 240 VAC	
Input frequency	50 Hz to 60 Hz	
Rated output voltage	19.50 VDC	
Temperature range:		
Operating	0°C to 40°C (32°F to 104°F)	
Storage	–40°C to 70°C (–40°F to 158°F)	

Display

Table 15. Display specifications



	27-inch FHD	27-inch UHD
Resolution (maximum)	1920 x 1080	3840 x 2160
Pixel pitch	0.3114 mm	0.1554 mm
Dimensions:		
Height	12.70 mm (0.50 in)	12.80 mm (0.50 in)
Width	607.10 mm (23.90 in)	608.80 mm (23.97 in)
Diagonal	685 mm (27 in)	686 mm (27 in)
Refresh rate	60 Hz	60 Hz
Controls	Program menus	



Computer environment

Airborne contaminant level: G1 as defined by ISA-S71.04-1985

Table 16. Computer environment

	Operating	Storage
Temperature range	10°C to 35°C (50°F to 95°F)	–40°C to 65°C (–40°F to 149°F)
Relative humidity (maximum)	20% to 80% (non-condensing)	5% to 95% (non-condensing)
	 NOTE: Maximum dew point temperature = 26°C	 NOTE: Maximum dew point temperature = 33°C
Vibration (maximum)*	0.24 GRMS	1.37 GRMS
Shock (maximum)	40 G†	105 G‡
Altitude (maximum)	–15.2 m to 3048 m (–50 ft to 10,000 ft)	–15.2 m to 10,668 m (–50 ft to 35,000 ft)

* Measured using a random vibration spectrum that simulates user environment.

† Measured using a 2 ms half-sine pulse when the hard drive is in use.

‡ Measured using a 2 ms half-sine pulse when the hard-drive head is in parked position.





Getting help and contacting Dell

Self-help resources

You can get information and help on Dell products and services using these self-help resources:

Table 17. Self-help resources

Information about Dell products and services	www.dell.com
Dell Help & Support app	
Get started app	
Accessing help	In Windows search, type Help and Support , and press Enter .
Online help for operating system	www.dell.com/support/windows www.dell.com/support/linux
Troubleshooting information, user manuals, setup instructions, product specifications, technical help blogs, drivers, software updates, and so on.	www.dell.com/support
Learn about your operating system, setting up and using your computer, data backup, diagnostics, and so on.	See <i>Me and My Dell</i> at www.dell.com/support/manuals .

Contacting Dell

To contact Dell for sales, technical support, or customer service issues, see www.dell.com/contactdell.





NOTE: Availability varies by country and product, and some services may not be available in your country.



NOTE: If you do not have an active internet connection, you can find contact information on your purchase invoice, packing slip, bill, or Dell product catalog.

