

Register your product and get support at
www.philips.com/welcome

Portable Netbook
Power Adaptor

SPJ5100



EN User manual

PHILIPS

EN Netbook tips specification table

EN	Tip number	Voltage	Tip dimension	Netbook brand	Polarity
BG	Номер на крайника	Напрежение	Размери на крайника	Марка на преносимия компютър	Поляритет
CS	Číslo koncovky	Napětí	Rozměr koncovky	Značka netbooku	Polarita
DE	Steckernummer	Spannung	Abmessungen des Steckers	Netbook-Marke	Polarität
EL	Αριθμός άκρου	Τάση	Διάσταση άκρου	Μάρκα netbook	Πολικότητα
ES	Número de clavija	Voltaje	Dimensión de la clavija	Marca del netbook	Polaridad
ET	Otsiku number	Pinge	Otsiku mõõtmed	Minisülearvuti kaubamärk	Polaarsus
FI	Kärjen numero	Jännite	Kärjen mitat	Minikannettavan merkki	Napaisuus
FR	Numéro de l'embout	Tension	Dimension de l'embout	Marque du netbook	Polarité
HR	Broj nastavka	Napon	Dimenzije nastavka	Marka netbook računala	Polaritet
HU	Az érintkező száma	Feszültség	Az érintkező mérete	Netbook márka	Polaritás
IT	Numero adattatore	Tensione	Dimensioni adattatore	Marca netbook	Polarità
KO	팁 번호	전압	팁 규격	노트북 브랜드	극성
LV	Uzgaļa numurs	Spriegums	Uzgaļa izmērs	Tīmekļa klēpjdatora zīmols	Polaritāte
LT	Kištuko numeris	Įtampa	Kištuko matmenys	„Netbook“ kompiuterio gamintojas	Polius
NL	Nummer opzetstekker	Voltage	Afmetingen opzetstekker	Merk netbook	Polariteit
PL	Numer złącza	Napięcie	Rozmiar złącza	Marka netbooka	Biegunowość
PT	Número da ponta	Voltagem	Dimensão da ponta	Marca do netbook	Polaridade
RO	Numărul vârfului	Tensiune	Dimensiunea vârfului	Marca netbook-ului	Polaritatea
RU	Номер штекера	Напряжение	Размеры штекера	Марка нетбука	Полярность
SK	Číslo koncovky	Napätie	Rozmer koncovky	Značka netbooku	Polarita
SL	Številka priključnega adapterja	Napetost	Velikost priključnega adapterja	Znamka spletnega prenosnika	Polariteta
SV	Kontaktens nummer	Spänning	Kontaktens mått	Netbook-märke	Polaritet
TR	Uç numarası	Gerilim	Uç boyutu	Netbook markası	Kutuplar
UK	Номер штекера	Напруга	Розмір штекера	Марка нетбука	Полярність
ZH-TW	接頭號碼	電壓	接頭尺寸	小筆電品牌	電極
ZH-CN	接头数	电压	接头尺寸	上网本品牌	极性
	1	12V	4.8/1.7 × 12mm	ASUS Eee PC 900, 901, 904, 1000, 1002, S101, T91, MK90 Gigabyte M912, M1022, S1024, T1028	Centre +ve
	2	19V	2.5/0.65 × 7mm	ASUS Seashell 1005, 1008 and 1101	Centre +ve
	3		4.0/1.7 × 12mm	HP Mini 110, 1000, 1010, 1014, 1019, 1035, 1100, 1120 Compaq Mini 700, 702, 730	Centre +ve
	4		5.5/2.1 × 12mm	Acer Aspire One AOD150, A110, A150, D150, D250, Pro 531 and 751 Dell Inspiron Mini 9, 9n, 910, 10, 10V and 12 series	Centre +ve
	5		5.5/2.5 × 11.5mm	BenQ Joybook U101, U102, U103, U121, U131	Centre +ve
				Toshiba NB100, NB105, NB200	Centre +ve
				LG Xnote X100, X110, X120, X130 Kohjinsha SA1F00 and SH811 series	Centre +ve
				Fujitsu M series - M1010, M2010	Centre +ve
			Asus N10	Centre +ve	
			Lenovo IdealPad S series - S9, 10, 10-2 and 12 MSI Wind NB U90, U100, U115, U120, U123	Centre +ve	
	6		5.5/3.0 (1.0) × 12mm	Samsung NC10, NC20, N110, N120, N130, N140, N310, N510	Centre +ve
	7		7.4/5.1 (0.9) × 12mm	HP Mini Note 2133, 2140, 5101	Centre +ve

1

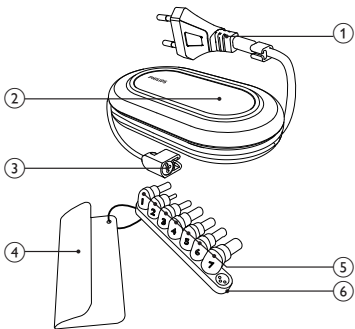

2

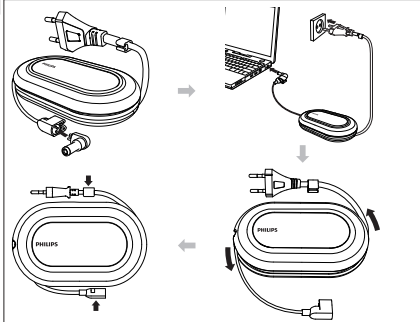

1 Overview of the product (Fig. 1)

- ① AC power plug
- ② LED indicator
- ③ Netbook connector cable
- ④ Netbook tips list
- ⑤ Netbook connector tips
- ⑥ Connector tips holder

2 Get started (Fig. 2)

- 1 From the netbook tips list, select the tip that matches your netbook model.
- 2 Connect the connector tip to the netbook connector cable.
- 3 Connect the power adaptor cable to the power socket of your netbook and a AC power socket.
↳ The LED indicator lights up.

Disclaimers:

To prevent damage to the netbook, select the tip that matches the netbook model. Please refer to the Quick Start Guide (Netbook tips specification table), pamphlet at package or visit www.philips.com (Search > SPJ5100) for the correct tip selection.

3 Troubleshooting

Problems	Causes	Solutions
The portable netbook power adapter does not work properly (or the LED indicator is on but your notebook is not charged properly).	The selected tip may not fit the netbook that you connect with.	Ensure you connect the right tip according to the netbook tips list at tips holder, pamphlet at package or www.philips.com (Search > SPJ5100) for the updated tip selections.
The portable netbook power adapter is hot and your notebook is not charged properly (or the LED indicator is blinking with AC power supplied).	The portable netbook power adapter is connected with higher input power notebook.	The portable netbook power adapter will work again after it cools down. Your notebook will still be charged.
I am not sure if the tip voltage fits my netbook.	N/A	There are voltages embossed at the tips, e.g. 12V, 19V, ...etc.

4 Recycling

Your product is designed and manufactured with high quality materials and components, which can be recycled and reused. When you see the crossed-out wheel bin symbol attached to a product, it means the product is covered by the European Directive 2002/96/EC:



Never dispose of your product with other household waste. Please inform yourself about the local rules on the separate collection of electrical and electronic products. The correct disposal of your old product helps prevent potentially negative consequences on the environment and human health.



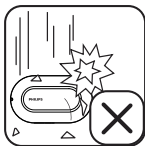
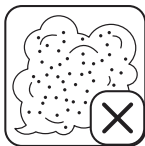
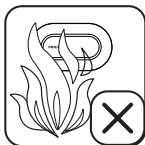
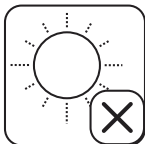
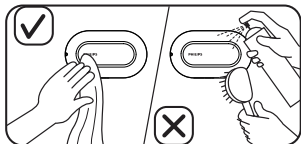

FCC - Notice of compliance

This device complies with Part 15 of the FCC Rules. Operation is subject to the following two conditions:

1. this device may not cause harmful interference, and
2. this device must accept any interference received, including interference that may cause undesired operation.

Note:

This equipment has been tested and found to comply with the limits for a Class B digital device, pursuant to part 15 of the FCC Rules. These limits are designed to provide reasonable protection against harmful interference in a residential installation. This equipment generates, uses, and can radiate radio frequency energy and, if not installed and used in accordance with the instruction manual, may cause harmful interference to radio communications. However, there is no guarantee that interference will not occur in a particular installation. If this equipment does cause harmful interference to radio or television reception, which can be determined by turning the equipment off and on, the user is encouraged to try to correct the interference by one or more of the following measures:

- Relocate the receiving antenna.
- Increase the separation between the equipment and receiver.
- Connect the equipment into an outlet on a circuit different from that to which the receiver is connected.
- Consult the dealer or an experienced radio/TV technician for help.

FCC - Remarques sur la conformité

L'appareil répond aux normes FCC, Part 15.

Fonctionnement soumis aux deux conditions suivantes:

1. Cet appareil ne doit pas provoquer d'interférences nuisibles, et
2. Cet appareil doit accepter toute interférence reçue, y compris les interférences susceptibles de provoquer un fonctionnement peu satisfaisant.

Remarque:

Cet équipement a été testé et a été certifié conforme aux limites imposées pour un appareil numérique de Classe B, conformément à la partie 15 des règlements FCC. Ces limites sont définies aux fins d'assurer une protection raisonnable contre les interférences nuisibles dans une installation résidentielle. Cet équipement génère, utilise et émet des fréquences radio qui, en cas d'une mauvaise installation ou d'une utilisation non-conforme aux instructions de ce manuel d'utilisation peuvent causer des interférences nuisibles aux communications radio. Il n'y a toutefois aucune garantie que des interférences nuisibles ne se produiront pas dans une installation donnée. Si cet équipement cause des interférences nuisibles avec votre poste radio ou de télévision, ce que vous pouvez déterminer en éteignant et en rallumant votre équipement, il est conseillé à l'utilisateur d'essayer de pallier à ces interférences nuisibles en prenant l'une ou l'autre des mesures suivantes:

- Changez la position de l'antenne de réception.
- Augmentez la séparation entre l'équipement et le récepteur.
- Branchez l'équipement sur une source d'alimentation différente de celle sur laquelle le récepteur est branché.
- Consultez votre distributeur ou un technicien qualifié en la matière pour assistance.



© Royal Philips Electronics N.V. 2010
All rights reserved.

Specifications are subject to change without notice. Trademarks are the property of Koninklijke Philips Electronics N.V. or their respective owners.

SPJ5100_QSG_V1.0



100% recycled paper
100% papier recyclé