

**FC9066-FC9060**

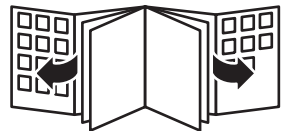

**PHILIPS**

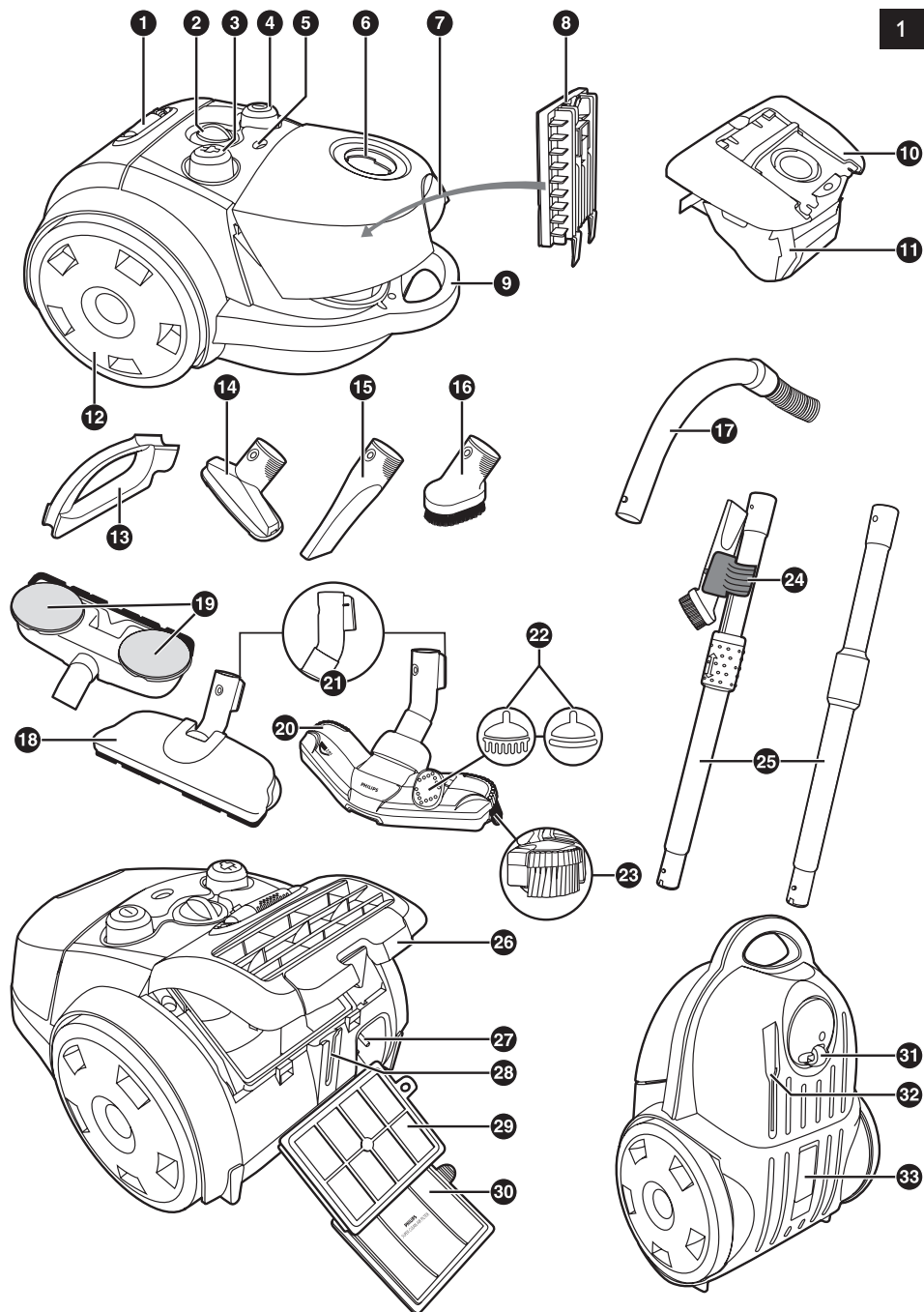







**General description (Fig. 1)**

- 1 Active Fragrance cartridge
- 2 Suction power knob
- 3 Cord rewind button
- 4 On/off button
- 5 Dustbag-full indicator
- 6 Hose connection opening
- 7 Release tab of dustbag compartment cover
- 8 Motor Protection Filter holder
- 9 Front handle
- 10 Dustbag holder
- 11 Paper dustbag
- 12 Rear wheel
- 13 Accessory holder (FC9066 only)
- 14 Small nozzle
- 15 Crevice tool
- 16 Small brush (FC9066 only)
- 17 Hose with handgrip
- 18 Super Parquet nozzle (FC9066 only)
- 19 Super Parquet nozzle polishing pads
- 20 Tri-Active nozzle
- 21 Parking/storage ridge
- 22 Rocker switch for carpet/hard floor settings
- 23 Side brush
- 24 Accessory clip (FC9060 only)
- 25 Telescopic tube
- 26 Filter grille (open)
- 27 Mains plug
- 28 Parking slot
- 29 Super Clean Air HEPA Filter (FC9066 only)
- 30 Super Clean Air Filter (FC9060 only)
- 31 Swivel wheel
- 32 Storage slot
- 33 Type plate

**Important**

Read this user manual carefully before you use the appliance and save it for future reference.

- Check if the voltage indicated on the appliance corresponds to the local mains voltage before you connect the appliance.
- Do not use the appliance if the plug, the cord or the appliance itself is damaged.
- If the mains cord is damaged, you must have it replaced by Philips, a service centre authorised by Philips or similarly qualified persons in order to avoid a hazard.
- This appliance is not intended for use by persons (including children) with reduced physical, sensory or mental capabilities, or lack of experience and knowledge, unless they have been given supervision or instruction concerning use of the appliance by a person responsible for their safety.
- Children should be supervised to ensure that they do not play with the appliance.
- Never suck up water or any other liquid. Never suck up flammable substances and do not suck up ashes until they are cold.
- Do not point the hose, the tube or any other accessory at the eyes or ears nor put it in your mouth when it is connected to the vacuum cleaner and the vacuum cleaner is switched on.

- When you use the vacuum cleaner to vacuum ashes, fine sand, lime, cement dust and similar substances, the pores of the dustbag become clogged. As a result, the dustbag-full indicator will indicate that the dustbag is full. Replace the dustbag, even if it is not full yet (see chapter 'Replacement').
- Never use the appliance without the Motor Protection Filter. This damages the motor and shortens the life of the appliance.
- Only use Philips s-bag™ double-layer paper dustbags.
- The translucent display panel is made of recyclable polycarbonate (>PC<).

### Electromagnetic fields (EMF)

This Philips appliance complies with all standards regarding electromagnetic fields (EMF). If handled properly and according to the instructions in this user manual, the appliance is safe to use based on scientific evidence available today.

### Preparing for use

Connecting accessories

#### Hose

- To connect the hose, push it firmly into the appliance ('click') (Fig. 2).
- To disconnect the hose, push the buttons and pull the hose out of the appliance (Fig. 3).

#### Telescopic tube

- 1** To connect the tubes to each other and to the handgrip of the hose, press the spring-loaded lock button. Then insert the part with the lock button into the part with the hole and fit the lock button into the hole ('click') (Fig. 4).
  - 2** To disconnect the tubes from each other and from the handgrip, press the spring-loaded lock button and pull the part with the lock button out of the part with the hole.
- Use the same method to connect and disconnect the nozzles.

- 3** Adjust the tube to the length you find most comfortable during vacuum cleaning (Fig. 5.)

#### Tri-Active nozzle

The Tri-Active nozzle is a multi-purpose nozzle for carpets and hard floors.

- The side brushes catch more dust and dirt at the sides of the nozzle and allow you to clean better along furniture and other obstacles (Fig. 6).
- The opening at the front of the nozzle allows you to suck up larger particles (Fig. 7).

- 1** Connect the Tri-Active nozzle to the tube.
- 2** Hard floor setting: push the rocker switch on top of the nozzle with your foot to make the brush strip come out of the housing. At the same time the wheel is lifted to prevent scratching and to increase manoeuvrability (Fig. 8).
- 3** Carpet setting: push the rocker switch again to make the brush strip disappear into the nozzle housing. The wheel is lowered automatically (Fig. 9).

#### Small nozzle, crevice tool and small brush (FC9066 only)

- 1** Connect the crevice tool (1), the small nozzle (2) or the small brush (3) (specific types only) directly to the handgrip or to the tube (Fig. 10).

#### Accessory clip (FC9060 only)

The accessory clip can simply be snapped onto the tube.

- The crevice tool and the small brush can be snapped onto the clip (Fig. 11).

### Accessory holder (FC9066 only)

---

The accessory holder can simply be snapped onto the handgrip.

- You can store accessories in the accessory holder by pushing them into the holder. To detach the accessories, pull them out of the holder (Fig. 12).

You can store two accessories at a time in the accessory holder:

- Crevice tool and small nozzle (Fig. 13).

Please note the way in which the small nozzle must be placed in the accessory holder:

- Crevice tool and small brush (Fig. 14).

## Using the appliance

---

### Vacuuming

---

- 1 Pull the cord out of the appliance and put the mains plug in the wall socket.
- 2 Push the on/off button on top of the appliance with your foot to switch on the appliance (Fig. 15).

### Adjusting suction power

---

While you are vacuuming, you can adjust the suction power with the knob on top of the appliance.

- Turn the knob to MAX for maximum suction power (Fig. 16).

Use maximum suction power to vacuum very dirty carpets and hard floors.

- Turn the knob to MIN for minimum suction power.

Use minimum suction power to vacuum curtains, table carpets, etc.

### Parking the tube

---

- If you want to pause for a moment, insert the ridge on the nozzle into the parking slot to park the tube in a convenient position (Fig. 17).

### Active Fragrance Control

---

The scent granules have been specially developed for use in your Philips vacuum cleaner. Only use the Philips s-fresh™ scent granules in your vacuum cleaner.

If the vacuum cleaner is equipped with Active Fragrance Control, keep it out of the reach of children, both during and after use. Store the vacuum cleaner in a locked cupboard if there are small children in the house.

The scent granules are not edible.

In case of eye contact, flush immediately with plenty of water.

### Filling the cartridge

- 1 Place your thumb and index finger on the sides of the cartridge. Press on the disc to remove the cartridge from the holder (Fig. 18).
- 2 To remove the cap of the cartridge, pull while applying pressure on the small pressing points (Fig. 19).
- 3 Open the sachet at the small opening at the top.
- 4 Fill the cartridge with the contents of one whole sachet of scent granules.
- 5 Put the cap back onto the cartridge ('click').
- 6 Reinsert the cartridge into the holder ('click'). It only fits into the holder in one way (Fig. 20). Replace the granules when the cartridge no longer emits any fragrance.



### Setting the fragrance level

- 1 To set the fragrance level, turn the cartridge forwards (maximum emission) or backwards (minimum emission) (Fig. 21).
- 2 Close the cartridge when you store the vacuum cleaner or do not want any fragrance to be emitted. Turn the cartridge backwards until the openings of the cartridge are no longer visible.

### Storage

- 1 Switch off the appliance and remove the mains plug from the wall socket.
- 2 Press the cord rewind button to rewind the mains cord (Fig. 22).
- 3 Put the appliance in upright position and insert the ridge on the nozzle into the slot to attach the nozzle to the appliance (Fig. 23).
- 4 Always put the Tri-Active nozzle in the carpet setting when you store it. Also prevent the side brushes from becoming bent (Fig. 9).

### Replacing/emptying the dustbag

Always unplug the appliance before you replace or empty the dustbag,

#### Replacing the paper dustbag

- Replace the dustbag as soon as the dustbag-full indicator has changed colour permanently, i.e. even when the nozzle is not placed on the floor (Fig. 24).

- 1 Pull at the release tab to open the dustbag compartment cover (Fig. 25).
- 2 Lift the dustbag holder out of the appliance (Fig. 26).

Make sure you hold the dustbag upright when you lift it out of the appliance.

- 3 Pull at the cardboard tag to remove the full dustbag from the holder (Fig. 27).  
 When you do this, the dustbag is sealed automatically.
- 4 Slide the cardboard front of the new dustbag into the two grooves of the dustbag holder as far as possible (Fig. 28).
- 5 Reinsert the dustbag holder into the vacuum cleaner (Fig. 29).

If you have not inserted a dustbag, you cannot close the dustbag compartment cover:

### Cleaning/replacing filters

Always unplug the appliance before you clean or replace the filters.

#### Cleaning the Motor Protection Filter

Clean the Permanent Motor Protection Filter every time you replace the dustbag.

- 1 Remove the dustbag holder with the dustbag (Fig. 26).
- 2 Take the Motor Protection Filter holder out of the appliance and shake it over a dustbin (Fig. 30).
- 3 Put the clean filter back into the filter holder. Fit the two lugs of the filter holder behind the ridge at the bottom to ensure that it fits properly at the top. Then press the filter holder home ('click') (Fig. 31).
- 4 Place the dustbag holder with the dustbag back into the appliance.

### Replacing the Super Clean Air Filter

---

The Super Clean Air Filter located in the back of the appliance has electrostatically charged fibres. These fibres filter a large part of the smaller particles from the exhaust air. Replace the Super Clean Air Filter every six months.

- 1 Open the filter grille (Fig. 32).
- 2 Remove the old filter (Fig. 33).
- 3 Insert the new filter into the appliance.
- 4 Close the filter grille and push the bottom corners until they snap home (Fig. 34).

### Replacing the Super Clean Air HEPA Filter

---

Instead of with the Super Clean Air Filter, this appliance can also be equipped with the special Super Clean Air HEPA Filter. This filter is able to remove 99.5% of all particles down to 0.0003 mm in size from the outlet air. This not only includes normal house dust, but also harmful microscopic vermin such as house dust mites and their excrements, which are well-known causes of respiratory allergies. Replace the Super Clean Air HEPA Filter every six months.

- 1 The Super Clean Air HEPA Filter can be replaced in the same way as the Super Clean Air Filter.

### Obtaining replacement items

If you have any difficulties obtaining replacement items for this appliance, please contact the Philips Customer Care Centre in your country or consult the worldwide guarantee leaflet.

### Dustbags

---

- Philips Classic s-bag™ paper dustbags are available under type number FC8021.
- Philips Clinic s-bag™ high-filtration dustbags are available under type number FC8022.

### Filters

---

- Super Clean Air Filters are available under type number FC8030.
- Super Clean Air HEPA Filters are available under type number FC8031.

### Scent granules

---

- Replacement kits with 4 sachets of scent granules are available under type number FC8025.

### Guarantee & service

If you need information or if you have a problem, please visit the Philips website at [www.philips.com](http://www.philips.com) or contact the Philips Customer Care Centre in your country (you find its phone number in the worldwide guarantee leaflet). If there is no Customer Care Centre in your country, go to your local Philips dealer or contact the Service Department of Philips Domestic Appliances and Personal Care BV.

### Environment

- Do not throw away the appliance with the normal household waste at the end of its life, but hand it in at an official collection point for recycling. By doing this, you help to preserve the environment (Fig. 35).

## Troubleshooting

- 1 The suction power is insufficient.
  - Make sure the suction power knob is in maximum position.
  - Perhaps the dustbag is full. Replace the paper dustbag or empty the reusable dustbag.
  - Perhaps the filters are dirty. Replace the filters.
  - The nozzle, tube or hose may be blocked up. To remove the obstruction, disconnect the blocked-up item and connect it (as far as possible) the other way around. Switch on the vacuum cleaner to force the air through the blocked-up item in opposite direction (Fig. 36).

## 一般说明 (图 1)

- 1 活性香气颗粒筒
- 2 吸力控制旋钮
- 3 电源线回卷按钮
- 4 开/关钮
- 5 集尘袋已满指示灯
- 6 软管连接孔
- 7 集尘袋仓盖的释放钮
- 8 马达保护滤网固定架
- 9 前方握把
- 10 集尘袋固定架
- 11 纸质集尘袋
- 12 后轮
- 13 附件存放架 (仅限 FC9066)
- 14 小号吸嘴
- 15 缝隙工具
- 16 小号毛刷 (仅限 FC9066)
- 17 带握把软管
- 18 洁旋风吸嘴 (仅限 FC9066)
- 19 洁旋风吸嘴纤维软垫
- 20 全方位清洁吸尘嘴
- 21 放置/存放夹片
- 22 地毯/硬地面转换开关
- 23 边刷
- 24 附件夹 (仅限 FC9060)
- 25 伸缩管
- 26 过滤器栅格 (打开状态)
- 27 电源插头
- 28 摆放固定槽
- 29 HEPA 高效能过滤网 (仅限 FC9066)
- 30 高效能过滤网 (仅限 FC9060)
- 31 转轮
- 32 插槽
- 33 型号牌

## 注意事项

使用产品之前，请仔细阅读本用户手册，并妥善保管以供日后参考。

- 在将产品连接电源之前，请先检查产品所标电压与当地的供电电压是否相符。
- 如果插头、电源线或产品本身受损，请勿再使用本产品。
- 如果电源软线损坏，为避免危险，必须由制造厂或其维修部或类似的专职人员来更换。
- 本产品不可由肢体不健全、感觉或精神上有障碍或缺乏相关经验和知识的人（包括儿童）使用，除非有负责他们安全的人员对他们使用本产品进行监督或提供相关指导。

- 应照看好儿童，确保他们不会玩弄本产品。
- 切勿吸取水或其它液体。切勿吸取易燃物质，并且不要吸取未冷却的灰烬。
- 当连接到真空吸尘器并且真空吸尘器已打开时，请勿将软管、硬管或任何其它附件指向眼睛或耳朵，也不要放在口中。
- 在使用真空吸尘器吸收灰尘、细沙、石灰、水泥灰和类似的物质时，集尘袋的袋孔可能发生阻塞。因此，集尘袋已满指示灯将显示集尘袋已满。这时，请更换集尘袋，即使集尘袋并未装满（见“更换”一章）。
- 切勿在未安装马达保护滤网的情况下使用本产品。这将使马达受损，并缩短产品的使用寿命。
- 请仅使用飞利浦 s-bag™ 双层纸质集尘袋。
- 半透明的显示面板使用可回收的聚碳酸酯制成 (>PC<)。

## 电磁场 (EMF)

这款飞利浦产品符合关于电磁场 (EMF) 的相关标准。据目前的科学证明，如果正确使用并按照本用户手册中的说明进行操作，本产品是安全的。

## 使用准备

连接附件

### 软管

- 要连接软管，请将其推入到产品中（会听到咔哒一声）。(图 2)
- 要卸下软管，请按下按钮并将软管从产品拉出。(图 3)

### 伸缩管

- 1** 将硬管互相联结或与握把联结时，按下弯管上的弹簧锁按钮，然后将带有锁定钮的部分插入带有小孔的部分，将锁定钮对准，牢固地插入小孔内（听到咔哒一声）。(图 4)
- 2** 要将硬管互相分离或与握把分离时，请按下弹簧锁按钮，将带有按钮的部分从带有小孔的部分拉出。

请通过同样的方法来连接及拆卸吸嘴。

- 3** 将硬管调整到吸尘过程中感觉最舒适的长度。(图 5)

## 全方位清洁吸尘嘴

Tri-Active 吸尘嘴是用于清洁地毯和硬质地板的一种多用途吸尘嘴。

- 吸尘嘴侧面的侧毛刷可以清洁更多灰尘和污垢，让您沿家具和其他障碍物边缘进行清洁。(图 6)
- 吸尘嘴正面的开口允许吸取体积较大的灰尘微粒。(图 7)

- 1** 将 Tri-Active 吸嘴连接到硬管上。
- 2** 硬质地板设置：用脚推动吸尘嘴顶部的按钮使刷条外翻，同时，轮子将伸出，以防止擦伤地板并提高灵活性。(图 8)

## 14 简体中文

- 地毯设置：再次推动吸尘嘴顶部的按钮使刷条没入吸尘嘴机壳中。轮子将自动降低。(图 9)

### 小号吸嘴、缝隙吸嘴和小号毛刷（仅限 FC9066）

---

- 将缝隙吸嘴 (1)、小号吸嘴 (2) 或小号毛刷 (3)（仅限特定型号）直接连接到握把或硬管上。(图 10)

### 附件夹（仅限 FC9060）

---

附件夹可简单地扣合在硬管上。

- 缝隙吸嘴和小号毛刷可扣合在附件夹上。(图 11)

### 附件存放架（仅限 FC9066）

---

附件架可简单地钩挂到握把上。

- 只需将附件推入附件存放架，就可将其放在附件存放架中。要卸下附件，将其拉出附件存放架即可。(图 12)

附件支架上可同时存放两个附件：

- 缝隙吸嘴和小号吸嘴。(图 13)

请注意小号吸嘴必须放在附件存放架上的特定方向。

- 缝隙吸嘴和小号毛刷(图 14)

## 使用本产品

### 吸尘

---

- 将电源线从吸尘器中拉出，并将电源插头插入插座。
- 用脚推动产品上的 on/off（开/关）按钮来开启机器。(图 15)

### 调整吸力

---

吸尘过程中，您可以使用产品顶端的吸力控制旋钮来调节吸力强度。

- 将旋钮调到MAX时，是最大吸力。(图 16)

对于特别脏的地毯和硬地板，可用最大吸力吸尘。

- 将旋钮调到 MIN 时，是最小吸力。

清洁门帘、台布或其他物品时，可用最小吸力。

### 放置硬管

---

- 如要暂停使用吸尘器，可通过将吸嘴上的夹片插入摆放固定槽以将硬管放妥。(图 17)

### 活性香气控制

---

特别研制的香味颗粒专用于您的飞利浦真空吸尘器。只能使用飞利浦 s-fresh™ 香味颗粒。

**如果吸尘器装备了活性香气控制，那么无论在使用过程中还是使用后，都不要让儿童接触到它。如果房间中有小孩子，请将吸尘器存放在带锁的橱柜中。**

**香味颗粒不可食用。**

如果接触到眼睛，请立即用大量的水清洗。

### 填充香味颗粒筒

- 1** 将您的拇指和食指放在筒的两侧。按下圆盘从支架上取下香味颗粒筒。(图 18)
- 2** 要取下筒盖，可在小按压点上施加压力并拉动。(图 19)
- 3** 打开香袋包装顶部的小开口。
- 4** 用香袋中的全部香味颗粒填充香味颗粒筒。
- 5** 将筒盖放回香味颗粒筒上（会听到咔哒一声）。
- 6** 将香味颗粒筒重新插入支架（会听到咔哒一声）。只有一个位置可以固定到支架中。(图 20)

请在香味颗粒筒不能再散发出香味时更换颗粒。

### 设置香味浓度

- 1** 要设置香味浓度，请向前旋转香味颗粒筒（最浓）或向后旋转香味颗粒筒（最淡）。(图 21)
- 2** 当您存放吸尘器或不需要它发出任何香味时，请关闭香味颗粒筒。将香味颗粒筒向后旋转，直到看不见筒口为止。

### 存放

- 1** 关闭吸尘器的电源，从插座中拔下电源插头。
- 2** 按下电源线回卷按钮将电线回卷到吸尘器中。(图 22)
- 3** 将产品竖立存放并将吸嘴安装到产品上，而后将吸嘴上的夹片插入产品背面的插槽中。(图 23)
- 4** 存放前，必须先将全方位清洁吸嘴处于地毯设置。以避免侧面的毛刷被弯曲。(图 9)

### 更换/清空集尘袋

更换或清空集尘袋前，切记拔下电器插头。

### 更换纸质集尘袋

- 在集尘袋已满指示灯的颜色改变时（在吸嘴没有紧贴地板的情况下），请立即更换集尘袋。(图 24)

- 1** 按释放钮并将机盖向上拉，可打开集尘袋仓盖。(图 25)
- 2** 取出集尘袋固定架。(图 26)

将集尘袋拉出吸尘器时，请确保以向上方向拉出集尘袋。

- 3** 拉起纸板片将装满灰尘的集尘袋取掉。(图 27)
- 4** 这时，集尘袋会自动封闭。
- 4** 将新集尘袋前面的纸板片套入集尘袋固定架上的两个狭槽中。尽量向下按。(图 28)
- 5** 将集尘袋固定架插回真空吸尘器。(图 29)

如果尚未插入集尘袋，将无法关闭集尘袋仓盖。

### 清洁或更换滤尘网

在清洁或更换滤尘网之前，请拔掉产品插头。

### 清洁马达保护滤网

---

每次更换集尘袋时，都应清洁永久性马达保护滤网。

- 1 取下集尘袋固定架和集尘袋。(图 26)
- 2 将马达保护滤网固定架从产品中拉出并在垃圾箱上方晃动以抖落上面的灰尘。(图 30)
- 3 将干净的过滤网放回滤网固定架中。将滤网固定架的两个连接片与放在底部的夹件对好，以确保它们与顶部正确对齐。然后将滤网固定架按回到位（会听到咔哒一声）。(图 31)
- 4 将集尘袋固定架和集尘袋放回吸尘器。

### 更换高效能过滤网

---

位于产品背面的高效能过滤网具有带静电的充电纤维。这些纤维可以从排气中过滤大量微小颗粒。

应每 6 个月更换高效能过滤网。

- 1 打开过滤器栅格。(图 32)
- 2 取出旧的滤网。(图 33)
- 3 将新的滤网插入吸尘器。
- 4 关闭过滤器栅格，推下面的角，直到卡住其位置。(图 34)

### 更换 HEPA 高效能过滤网

---

如果不安装高效能过滤网，本产品还可以安装特殊的 HEPA 高效能过滤网。这种滤网可以从排出空气中过滤 99.5% 的最小为 0.0003 毫米的颗粒。这不仅能过滤正常的室内灰尘，而且还能过滤显微级别的寄生虫和它们的排泄物。众所周知，这些排泄物能引起呼吸道过敏。

每 6 个月更换一次 HEPA 高效能过滤网。

- 1 HEPA 高效能过滤网的更换方法与高效能过滤网的更换方法一样。

### 订购附件或替代品

如果您在购买本产品的附件或替代品时遇到任何困难，请和您所在国家的飞利浦客户服务中心联系，或参阅全球保证书。

### 集尘袋

---

- 飞利浦 Classic s-bag™ 纸质集尘袋的型号是 FC8021。
- 飞利浦 Clinic s-bag™ 高过滤集尘袋的型号是 FC8022。

### 过滤网

---

- 高效能过滤网的型号为 FC8030。
- 可提供型号为 FC8031 的 HEPA 高效能过滤网。

### 香味颗粒

---

- 包含 4 袋香味颗粒的更换套件型号是 FC8025。



## 保修与服务

如果您需要详细信息或有任何问题，请浏览飞利浦网站，地址为 [www.philips.com](http://www.philips.com)。您也可以与贵国的飞利浦顾客服务中心联系（您可以从全球保修卡中找到电话号码）。如果贵国没有飞利浦顾客服务中心，请与当地的飞利浦经销商或与飞利浦家庭小电器的维修中心联系。

## 环保

- 弃置产品时，请不要将其与一般生活垃圾堆放在一起；应将其交给官方指定的回收中心。这样做有利于环保。（图 35）

## 故障种类和处理方法

- 1 吸力不足。
  - 确保吸力控制旋钮在最大位置。
  - 可能集尘袋已满。更换纸质集尘袋或清空循环使用集尘袋。
  - 可能过滤网脏了。请更换过滤网。
  - 检查吸嘴、硬管、软管是否被阻塞。要清除阻塞物，请将阻塞的部分拆下，并将它反向连接（尽可能离远一些）。打开吸尘器的电源，强迫气流反方向通过阻塞的部位。（图 36）

### 产品型号/规格

型号	额定功率	额定电压/ 频率
FC9060 (有调)	1600W	220V~ 50Hz
FC9066 (有调)	1600W	220V~ 50Hz

### 产品附件名称及数量

名称/ 数量	FC9060	FC9066
软管	1	1
可伸缩吸管	1	1
缝隙吸嘴	1	1
小号吸嘴	1	1
小号毛刷	-	1
附件存放架	-	1
附件夹	1	-
全方位吸尘嘴	1	1
洁旋风吸尘嘴	-	1
S-bag™ Classic 双层纸制集尘袋	1	1

## 注意事项

### 维修与养护

- 除说明书上注明允许使用者进行维护和保养的项目外，其他的维护和保养的项目必须由飞利浦指定的维修中心进行。
- 切勿让儿童使用本产品。
- 当使用完毕或离开时，要切断电源。
- 当吸尘器与吸尘软管连接，并接上电源后，切勿将吸尘软管靠近眼睛、耳朵或放在口里。
- 对产品在使用时如出现异常的情况（如噪音、气味、温度升高、烟雾等）应立刻切断电源，停止继续使用。
- 使用者可联系飞利浦全国顾客免费服务热线、当地的飞利浦办事处或飞利浦维修中心进行咨询。

# PHILIPS



产品 : 飞利浦家用  
真空卧式吸尘器  
型号 : FC9060, FC9066  
额定电压 : 220V~  
额定频率 : 50Hz  
额定输入功率: 1600 W  
生产日期 : 请见产品底部  
产地 : 波兰



飞利浦电子香港有限公司 家庭小电器部  
香港湾仔皇后大道东1号 太古广场3座5楼  
电话: (852) 2821 5888

全国顾客服务热线: 4008 800 008

本产品根据国标GB4706.1-2005, GB4706.7-2004, GB4343.1-2003及GB17625.1-2003制造

请妥善保管本使用说明书  
发行日期：2007/04/26

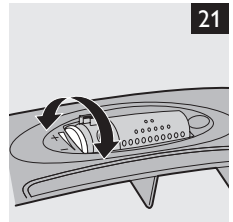
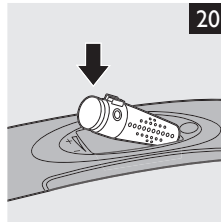
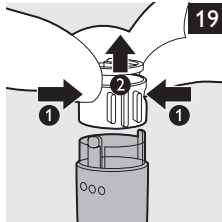
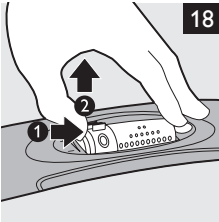
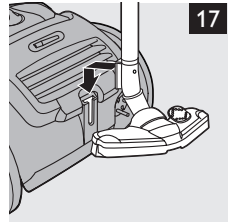
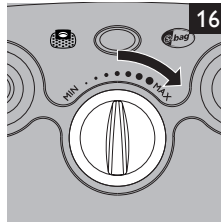
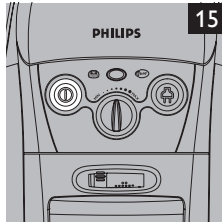
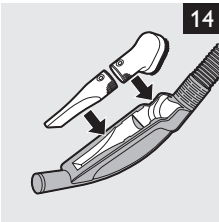
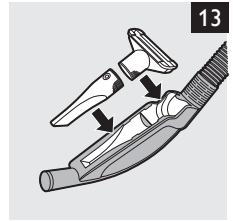
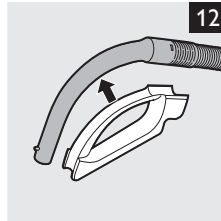
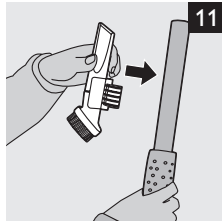
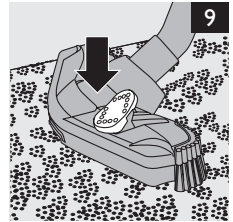
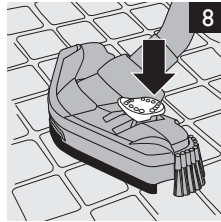
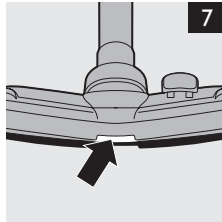
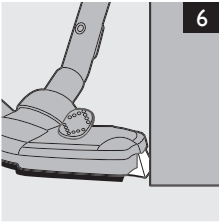
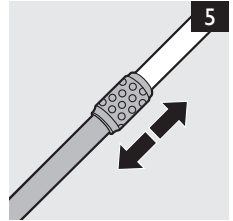
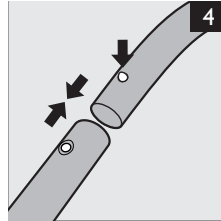
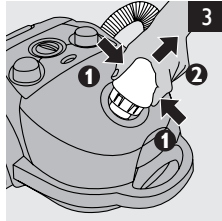
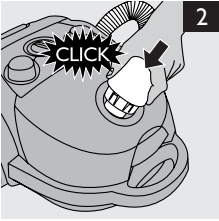

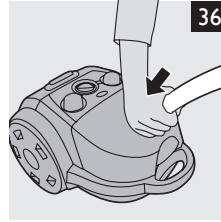
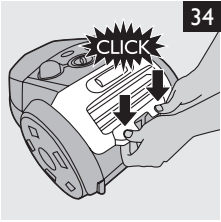
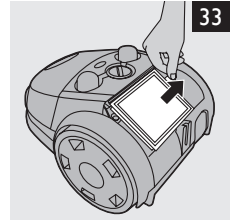
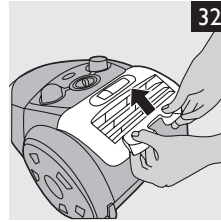
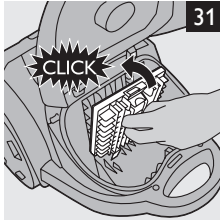
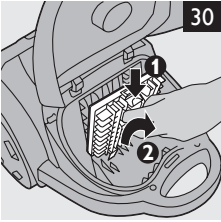
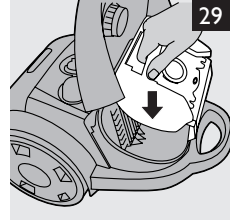
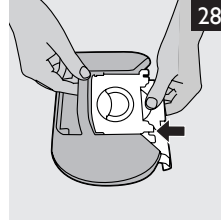
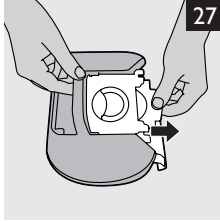
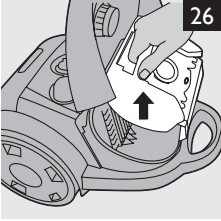
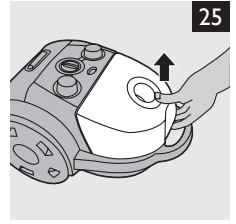
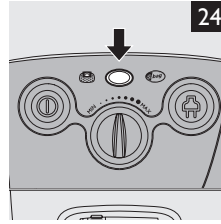
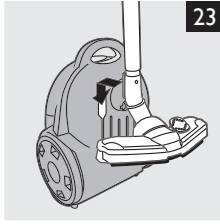
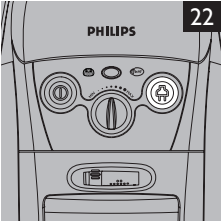



[www.philips.com](http://www.philips.com)

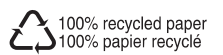

4222.003.3361.2