



# **INSTRUCTIONS FOR USE**

**BEFORE USING THE APPLIANCE**

**SAFEGUARDING THE ENVIRONMENT**

**PRECAUTIONS AND GENERAL  
RECOMMENDATIONS**

**HOW TO OPERATE THE REFRIGERATOR  
COMPARTMENT**

**HOW TO OPERATE THE FREEZER  
COMPARTMENT**

**HOW TO DEFROST AND CLEAN THE  
FREEZER**

**HOW TO CLEAN THE REFRIGERATOR  
COMPARTMENT**

**CLEANING AND MAINTENANCE**

**TROUBLESHOOTING GUIDE**

**AFTER-SALES SERVICE**

**INSTALLATION**

**DOOR REVERSIBILITY**

**ELECTRICAL CONNECTION**

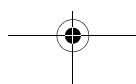
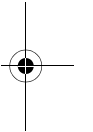
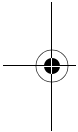

## BEFORE USING THE APPLIANCE

- Your new appliance is designed exclusively for domestic use.

**To get the most out of your new appliance, read the user handbook carefully. It contains a description of the appliance as well as useful tips.**

**Keep this handbook for future consultation.**

- After unpacking the appliance, make sure that it is undamaged and that the doors close correctly. Any damage must be reported to the dealer within 24 hours of delivery of the appliance.
- Wait at least two hours before switching the appliance on, to ensure that the refrigerant circuit is fully efficient.
- Installation of the appliance and electrical connections must be carried out by a qualified electrician, in accordance with the manufacturer's instructions and local safety regulations.
- Clean the inside of the appliance before use.

## SAFEGUARDING THE ENVIRONMENT

### 1. Packaging

The packaging material is 100% recyclable and carries the recycling symbol. Follow local regulations for scrapping.

Keep packing materials (plastic bags, polystyrene parts, etc.) out of the reach of children, as they are a potential source of danger.

### 2. Scrapping/Disposal

The appliance is manufactured using recyclable material.

This appliance is marked according to the European directive 2002/96/EC on Waste Electrical and Electronic Equipment (WEEE).

By ensuring that this appliance is scrapped suitably, you can help prevent potentially damaging consequences for the environment and health.

The symbol  on the appliance, or on the accompanying documents, indicates that this appliance should not be treated as domestic waste but must be taken to a special collection centre for the recycling of electrical and electronic equipment.

When scrapping the appliance, make it unusable by cutting off the power cable and removing the doors and shelves so that children cannot easily climb inside and become trapped. Scrap the appliance in compliance with local regulations on waste disposal, taking it to a special collection centre; do not leave the appliance unattended even for a few days, since it is a potential source of danger for children. For further information on the treatment, recovery and recycling of this product, contact your competent local office, the household waste collection service or the shop where you purchased the appliance.

### Information:

This appliance does not contain CFCs. The refrigerant circuit contains R134a (HFCs) or R600a (HCs), see the rating plate inside the appliance.

Appliances with isobutane (R600a): Isobutane is a natural gas of low environmental impact.

Caution is required, however, since isobutane is flammable. Therefore, ensure that refrigerant circuit pipelines are not damaged.

### Declaration of conformity

This product has been designed for preserving food and is manufactured in compliance with Regulation (CE) No. 1935/2004.



This product has been designed, manufactured and marketed in compliance with:

- the safety objectives prescribed in the Low Voltage Directive 2006/95/CE (which replaced Directive 73/23/CEE as amended);
- the protection requirements of the "EMC" 89/336/CEE directive, amended by Directive 93/68/CEE

Electrical safety of the appliance can only be guaranteed if it is correctly connected to an approved earthing system.



## PRECAUTIONS AND GENERAL RECOMMENDATIONS

- The appliance must be handled and installed by two or more persons.
- Be careful not to damage the floors when you move the appliance (e.g. parquet flooring).
- During installation, make sure the appliance does not damage the power cable.
- Check the appliance is not positioned near a heat source.
- To guarantee adequate ventilation, leave a space on both sides and above the appliance and follow the installation instructions.
- Keep the appliance vent outlets free.
- Do not damage the appliance refrigerant circuit pipes.
- Install and level the appliance on a floor strong enough to take its weight and in a place suitable for its size and use.
- Install the appliance in a dry and well ventilated area. The appliance is intended for operation in environments where ambient temperatures fall within the following ranges, depending on the climatic class indicated on the data plate. The appliance may not work properly if it is left for a long time at a temperature outside the specified range.

Climatic Class	Amb. temp. (°C)	Amb. temp. (°F)
SN	From 10 to 32	From 50 to 90
N	From 16 to 32	From 61 to 90
ST	From 16 to 38	From 61 to 100
T	From 16 to 43	From 61 to 110

- Ensure that the voltage indicated on the appliance data plate corresponds to the domestic supply voltage.
- Do not use single/multiple adapters or extension cables.
- For the water connection, use the pipe supplied with the new appliance; do not reuse the one from the previous appliance.
- Power cable modification or replacement must only be carried out by qualified personnel.
- Electrical disconnection must be possible either by unplugging the appliance or by means of a double-pole switch located upline from the socket.

### SAFETY

- Do not store or use petrol, flammable liquids or gas in the vicinity of this or other electrical appliances. The fumes can create a fire hazard or explosion.
- Do not use mechanical, electric or chemical means other than those recommended by the Manufacturer to speed up the defrost process.
- Do not use or place electrical appliances inside the product if they are not of the type expressly authorised by the Manufacturer.
- The appliance is not intended for use by persons (children included) with restricted physical, sensory or mental abilities or without experience and knowledge of the appliance, unless they are under the supervision or instruction of a person responsible for their safety. Do not allow children to play or hide inside the appliance - risk of becoming trapped and suffocating.
- Do not swallow the contents (non-toxic) of the ice packs (in some models).
- Do not eat ice cubes or ice lollies immediately after taking them out of the freezer since they may cause cold burns.

### USE

- Before carrying out any maintenance or cleaning, always unplug the appliance or disconnect the power supply.
- All appliances equipped with ice-makers and water dispensers must be connected to a water supply that only delivers potable water (with mains water pressure of between 0.17 and 0.81 MPa (1.7 and 8.1 bar)). Ice makers and/or water dispensers not directly connected to the water mains must be filled using potable water only.
- Use the refrigerator compartment to store fresh food only and the freezer compartment to store frozen food, to freeze fresh food, and to make ice cubes only.
- Do not store glass containers with liquids in the freezer since they may burst.

**The Manufacturer declines any liability if the above advice and precautions are not respected**

## HOW TO OPERATE THE REFRIGERATOR COMPARTMENT

This appliance is a refrigerator with a  star freezer compartment.

**Defrosting of the refrigerator compartment is completely automatic.**

### Switching on the refrigerator for the first time

Insert the plug into the mains socket.

The thermostat is used to adjust the temperature of both compartments: refrigerator and freezer.

### How to adjust the temperature of the compartments:

1. For correct operation and optimum storage of food, **follow instructions given in the enclosed product sheet for thermostat adjustment.**
2. To adjust the temperature in the refrigerator compartment, set the thermostat control knob to:
  - **lowest/MIN** numbers for the **LEAST COLD** internal temperatures;
  - **highest/MAX** numbers for the **COLDEST** internal temperatures.

Thermostat set to 0: no operation, no light.

### Note:

The ambient air temperature, frequency of door opening and the position of the appliance can affect internal temperatures. These factors must be taken into account when setting the thermostat.

### How to use the refrigerator compartment

Position the food as illustrated in the figure.

- A. Cooked food
- B. Fish, meat
- C. Fruit and vegetables
- D. Bottles
- E. Eggs
- F. Butter, cheese and dairy products

### Note:

- The space between the shelves and the rear wall of the refrigerator compartment must be unobstructed to allow circulation of air.
- Do not place food in direct contact with the rear wall of the refrigerator compartment.
- Do not place hot food in the refrigerator or freezer.
- Store liquids in closed containers.
- Storing vegetables with a high water content can result in condensation in the crisper drawer: this will not affect the correct operation of the appliance.

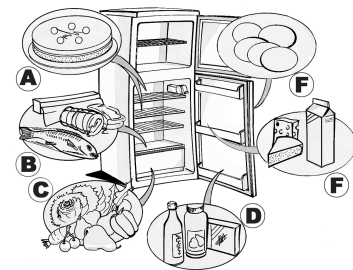
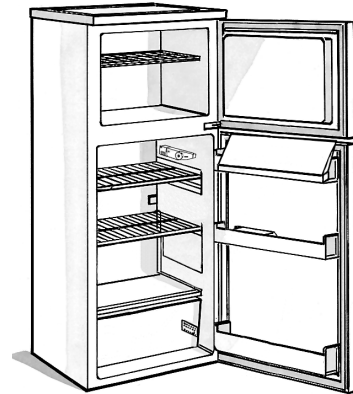

## HOW TO OPERATE THE FREEZER COMPARTMENT

The freezer is a **\*\*\*** star compartment.

This compartment can be used to store frozen foods for the period of time indicated on packaging. The freezer can also be used to freeze fresh food by positioning it on the rack; place frozen food in the lower part of the compartment so that there is no contact with fresh food that has yet to be frozen.

The quantity of fresh food that can be frozen in 24 hours is shown on the rating plate.

**Important:**

**Before freezing, wrap and seal fresh food in:**

- aluminium foil, cling film, air and water-tight plastic bags, polythene containers with lids or freezer containers suitable for freezing fresh food.
- In the event of a power cut, the freezer compartment will maintain a sufficiently low temperature for food storage. However, it is advisable to avoid opening the compartment door during such periods.

**Important:**

**The table alongside shows the recommended maximum storage time for frozen fresh foods.**

**When purchasing frozen food products:**

- Ensure that the packaging is not damaged (frozen food in damaged packaging may have deteriorated). If the package is swollen or has damp patches, it may not have been stored under optimal conditions and defrosting may have already begun.
- When shopping, leave frozen food purchases until last and transport the products in a thermally insulated cool bag.
- Place the items in the freezer compartment as soon as you get home.
- If food has defrosted even partially, do not re-freeze it. Consume within 24 hours.
- Avoid, or reduce temperature variations to the minimum. Respect the best-before date on the package.
- Always observe the storage information on the package.

**Making ice cubes**

- Fill the ice cube tray 3/4 with water and place it at the bottom of the freezer compartment. If the tray sticks to the bottom of the compartment, do not use pointed or sharp instruments to detach it.

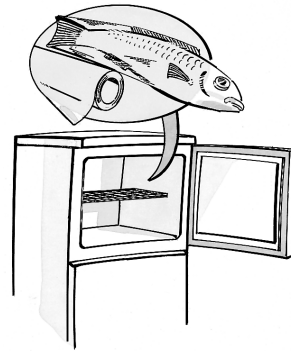

MONTHS	FOOD
1-3	
4-7	
8-12	

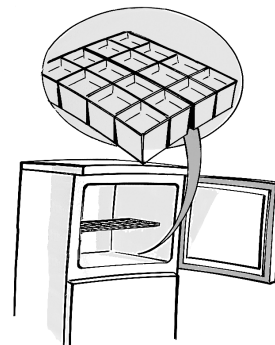

## HOW TO DEFROST AND CLEAN THE FREEZER

**Defrost the freezer compartment once or twice a year, or when the ice on the walls reaches a thickness of about 3 mm. If possible, defrost the freezer when it is nearly empty.**

1. Remove the food from the freezer, wrap in newspaper and group together in a cool place or in a portable cooler.
2. **Disconnect the appliance from the mains power supply.**
3. Leave the door open to allow the frost to melt.
4. Remove the defrost water from the compartment bottom.
5. Clean the interior with a sponge dampened in lukewarm water and neutral detergent.  
**Do not use abrasive products.**
6. Rinse the interior and dry thoroughly.

**Note: Do not use sharp or pointed metal instruments to scrape off ice; do not heat the freezer compartment artificially.**

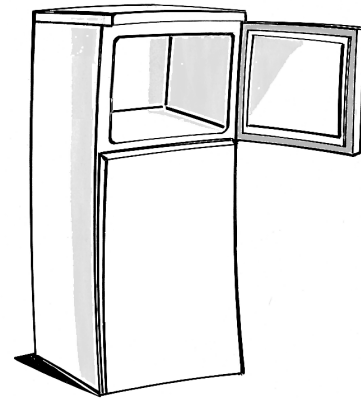

## HOW TO CLEAN THE REFRIGERATOR COMPARTMENT

**Periodically clean the inside of the refrigerator compartment.**

**Defrosting of the refrigerator compartment is completely automatic.**

Droplets of water on the rear wall of the refrigerator compartment indicate that the periodic automatic defrost cycle is in progress.

The defrost water is automatically routed to a drain outlet and into a container from which it evaporates.

Before carrying out any cleaning operations, disconnect the appliance from the power supply.

- Use a sponge dampened in lukewarm water and/or neutral detergent.
- Rinse and dry with a soft cloth.

**Do not use abrasive substances.**

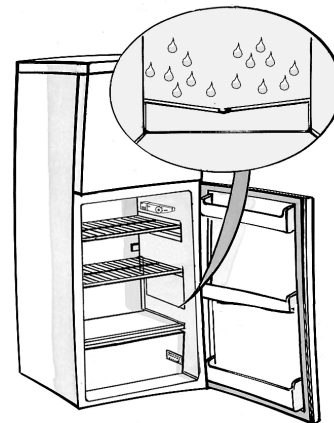

## CLEANING AND MAINTENANCE

### For built-in appliances

- Periodically clean air vents with a vacuum cleaner or a brush (see **figure A**).
- Clean the outside using a soft cloth.

### Vacation

1. Empty the refrigerator and freezer compartments.
2. Disconnect the appliance from the power supply.
3. Defrost the freezer compartment, and clean and dry both compartments.
4. Leave the doors open to prevent formation of unpleasant odours.



Fig. A

## TROUBLESHOOTING GUIDE

### 1. The appliance is not working.

- Is there a power failure?
- Is the plug properly inserted in the socket?
- Is the double-pole switch on?
- Has the fuse blown?
- Is the power cord damaged?
- Is the thermostat set to 0 (Stop)?

### 2. Temperature inside the compartments is not low enough.

- Is the door shut properly?
- Is the appliance installed near a heat source?
- Is the thermostat setting correct?
- Are the air circulation grilles blocked?

### 3. Temperature inside the refrigerator compartment is too low.

- Is the thermostat setting correct?

### 4. Water collects at the bottom of the refrigerator compartment.

- Is the defrost water drain blocked?

### 5. The inside light is not working.

Perform the checks for problem 1, and then:

- Disconnect the appliance from the power supply.  
To inspect the bulb, refer to the instructions and illustration on the attached table.
- Check the bulb and replace it, if necessary, with a new one. Replace using maximum 15W bulb.

### 6. Excessive frost build-up in the freezer compartment

- Is the door shut properly?
- Is food obstructing proper door closure?

### Attention:

- **The front edge of the appliance may be hot. This prevents the formation of condensation and is not a defect.**
- **Gurgling and hissing noises due to expansion in the refrigerant circuit are normal.**

## AFTER-SALES SERVICE

### Before contacting the After-Sales Service:

1. See if you can solve the problem yourself (see "Troubleshooting guide").
2. Switch the appliance on again to see if the problem has been solved.  
If it has not, switch off the appliance again and repeat the operation after one hour.
3. If the problem persists after this course of action, contact After-Sales Service.  
Specify:
  - the nature of the problem,
  - the appliance model,

- the Service number (the number after the word SERVICE on the rating plate inside the appliance),
- your full address,
- Your telephone number and area code.

**SERVICE** 0000 000 00000



**Note: The direction of door opening can be changed. If this operation is performed by After-sales Service it is not covered by the**

## INSTALLATION

- Install the appliance away from heat sources.
- Install the appliance in a dry, well-ventilated place.
- Do not obstruct the top and bottom vent zones.
- Clean the inside (see chapter "How to clean the refrigerator compartment").

### Electrical connection

- **Electrical connections must be made in accordance with local regulations.**
- Voltage and power consumption are indicated on the rating plate (at the side of the crispers).

### Freestanding appliances (not built-in)

- To optimize appliance efficiency, leave a 5 cm gap above the appliance and make sure that adjacent kitchen units are sufficiently distanced to allow air circulation.
- Ensure that the appliance is level, using the front adjustment feet if necessary.

- **Regulations require that the appliance be earthed. The manufacturer declines all liability for injury to persons or animals and for damage to property resulting from failure to observe the above procedures and reminders.**
- If the plug and socket are not of the same type, have the socket replaced by a qualified electrician.
- Do not use extension leads or adapters.

### Disconnecting the appliance

- It must be possible to disconnect the appliance by unplugging it or by means of a two-pole switch fitted upline of the socket.



## DOOR REVERSIBILITY

The doors of your Fridge Freezer can be reversed.

- Ensure the Fridge Freezer is unpugged and empty.
- We recommend you have someone to assist you.

### Tools required

- Phillips style screwdriver
- Flat bladed screwdriver
- 8 mm and 10 mm Socket or spanner.

When laying the Fridge Freezer on it's back in order to gain access to the base, you should never tip it back by more than 45° and must rest it on soft foam packaging or similar material to avoid damaging the cooling pipes at the rear of the Fridge Freezer.

Remove the two screws at the rear of the Fridge Freezer. Lift the top off the Fridge Freezer.

Use the 8 mm socket or spanner to remove the 3 hinge bolts. Remove the 3 bolts from the opposite side.

Remove bracket and plastic surround. Remove and replace the pin in the bracket. Replace on opposite side of the Fridge Freezer cabinet.

Lift the top door off middle hinge bracket and pull away from the body of the Fridge Freezer. Remove retaining screw from the top of the cabinet and replace on the other side.

Remove the middle hinge using an 8 mm socket/spanner. Take care not to lose the white spacer. Put hinge to one side. Lift door off the bottom bracket.

Remove blanking plates from the middle of the cabinet and replace in opposite side. Remove the blanking plates from the doors and replace the hinge bushes on the other side.

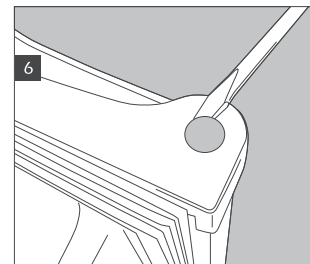
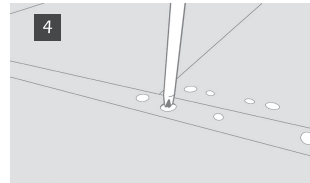
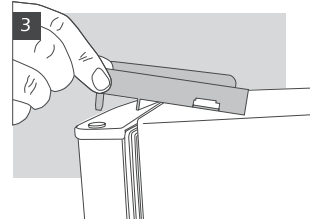
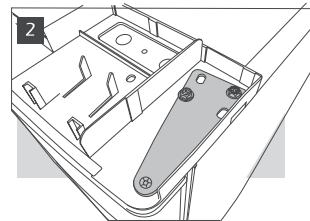
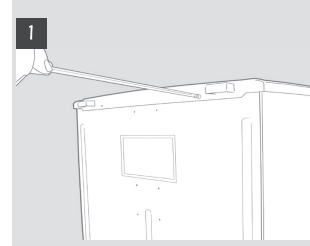

Remove the levelling feet by unscrewing.

Remove bottom bracket using an 8 mm socket or spanner. Remove and replace pin using a 10 mm spanner to undo the nut and a flat bladed screwdriver to remove the pin. You may need to push the pin through from the underside to remove fully.

Remove screw on base and replace on other side. Remove blanking plates from unused side of the Fridge Freezer and replace in holes left by the brackets.

Replace doors and brackets in reverse order. When replacing feet take care to ensure the larger foot is on the side without the bracket.

Check both doors are aligned horizontally and vertically, and that the seals are closed on all sides before finally tightening the bottom hinge

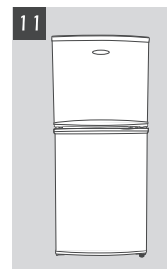
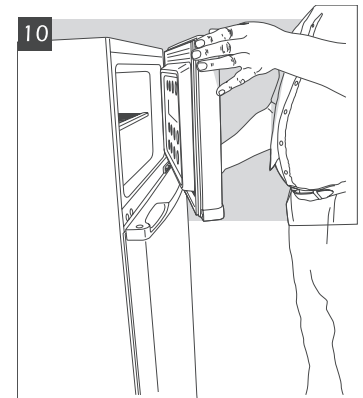
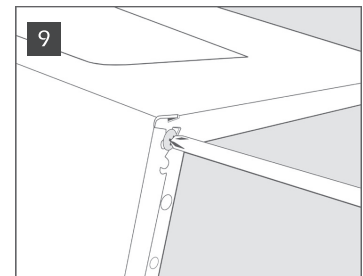
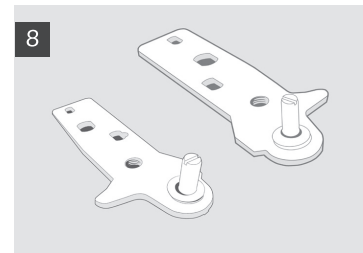
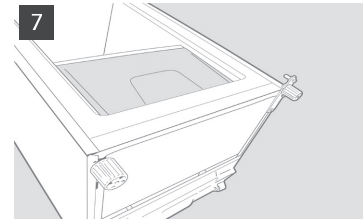

## ELECTRICAL CONNECTION

### 1) For Great Britain only

**Warning - this appliance must be earthed**

#### Fuse replacement

If the mains lead of this appliance is fitted with a BS 1363A 13amp fused plug, to change a fuse in this type of plug use an A.S.T.A. approved fuse to BS 1362 type and proceed as follows:

1. Remove the fuse cover (A) and fuse (B).
2. Fit replacement 13A fuse into fuse cover.
3. Refit both into plug.

#### Important:

The fuse cover must be refitted when changing a fuse and if the fuse cover is lost the plug must not be used until a correct replacement is fitted.

Correct replacement are identified by the colour insert or the colour embossed in words on the base of the plug.

Replacement fuse covers are available from your local electrical store.

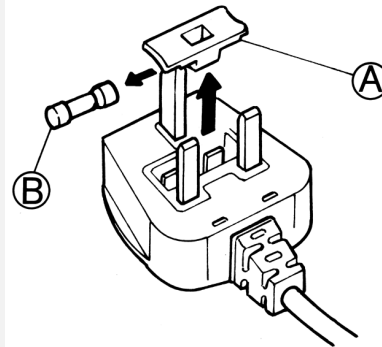

### 2) For the Republic of Ireland only

The information given in respect of Great Britain will frequently apply, but a third type of plug and socket is also used, the 2-pin, side earth type.

### 3) Socket outlet / plug (valid for both countries)

If the fitted plug is not suitable for your socket outlet, please contact Whirlpool Service for further instruction. Please do not attempt to change plug yourself. This procedure needs to be carried out by a qualified Whirlpool technician in compliance with the manufactures instructions and current standard safety regulations.