

User's Manual

MEDICAL GRADE UPS SERIES

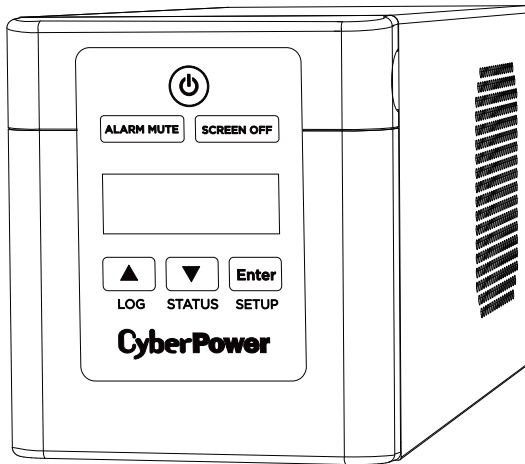

M550L / M750L / M1100XL

CyberPower®

PRODUCT REGISTRATION

Thank you for purchasing a CyberPower product. Please take a few minutes to register your product at www.cyberpower.com. Registration certifies your product's warranty, confirms your ownership in the event of a product loss or theft and entitles you to free technical support. Register your product now to receive the benefits of CyberPower ownership.

INTENDED USE OF UPS SYSTEM

CyberPower Medical Grade UPS systems are intended to support and protect non-medical and medical computer devices that require leakage current reduction, surge protection, voltage regulation, line noise filtering and battery backup during power outages and generator testing, both inside and outside patient care vicinities. CyberPower Medical Grade UPS Systems come with medical-grade receptacles and plugs that reduce the leakage.

SAFETY COMPLIANCE STATEMENT

FCC Compliance Statement This device complies with part 15 of the FCC rules. Operation is subject to the following two conditions: (1) this device may not cause harmful interference, and (2) this device must accept any interference received, including interference that may cause undesired operation.

Note: This equipment has been tested and found to comply with the limits for a Class A digital device, pursuant to part 15 of the FCC Rules. These limits are designed to provide reasonable protection against harmful interference when the equipment is operated in a commercial environment. This equipment generates, uses, and can radiate radio frequency energy and, if not installed and used in accordance with the instruction manual, may cause harmful interference to radio communications. Operation of this equipment in a residential area is likely to cause harmful interference in which case the user will be required to correct the interference at his own expense.

Important: Changes or modifications not expressly approved by the party responsible for compliance could void the user's authority to operate the equipment.

Canadian Compliance Statement

This device complies with Industry Canada licence-exempt RSS standard(s). Operation is subject to the following two conditions: (1) this device may not cause interference, and (2) this device must accept any interference, including interference that may cause undesired operation of the device.

Le présent appareil est conforme aux CNR d'Industrie Canada applicables aux appareils radio exempts de licence. L'exploitation est autorisée aux deux conditions suivantes : (1) l'appareil ne doit pas produire de brouillage, et (2) l'appareil doit accepter tout brouillage radioélectrique subi, même si le brouillage est susceptible d'en compromettre le fonctionnement.

CAN ICES-3 (A)/NMB-3(A)

IMPORTANT SAFETY WARNINGS

(SAVE THESE INSTRUCTIONS)

This manual contains important safety instructions. Please read and follow all instructions carefully during installation and operation of the unit. Read this manual thoroughly before attempting to unpack, install, or operate your UPS.

CAUTION! To prevent the risk of fire or electric shock, install in a temperature and humidity controlled indoor area free of conductive contaminants. (Please see specifications for acceptable temperature and humidity range).

CAUTION! For pluggable equipment, the socket-outlet shall be installed near the equipment and shall be easily accessible.

CAUTION! To reduce the risk of electric shock, do not remove the cover except to service the battery. There are no user serviceable parts inside except for the battery.

CAUTION! Hazardous live parts inside can be energized by the battery even when the AC input power is disconnected.

CAUTION! The UPS must be connected to an AC power outlet with fuse or circuit breaker protection. Do not plug into an outlet that is not grounded. If you need to de-energize this equipment, turn off and unplug the unit.

CAUTION! To avoid electric shock, turn off the unit and unplug it from the AC power source before servicing the battery.

CAUTION! To reduce the risk of fire, connect only to a circuit provided with 20 amperes maximum branch circuit overcurrent protection in accordance with the National Electric Code, ANSI/NFPA 70.

CAUTION! Not for use in a computer room as defined in the Standard for the Protection of information Technology Equipment, ANSI/NFPA 75.

CAUTION! DO NOT USE FOR LIFE SUPPORT EQUIPMENT! CyberPower Systems does not sell products life support applications. DO NOT use in any circumstance that would affect the operation and safety of life support equipment or patient care.

CAUTION! The Serial and USB ports of the UPS units allow the connection and communication with computers, and the connected computers shall comply with UL/ IEC standards.

CAUTION! Combined systems shall comply with the standard IEC 60601-1-1, safety requirements for medical electrical systems. On the other hands, the equipment which doesn't comply with UL 60601-1 shall be kept outside patient environment, as defined in the standard.

CAUTION! DO NOT USE WITH OR NEAR AQUARIUMS! To reduce the risk of fire or electric shock, do not use with or near an aquarium. Condensation from the aquarium can cause the unit to short out.

DO NOT USE THE UPS ON ANY TRANSPORTATION! To reduce the risk of fire or electric shock, do not use the unit on any transportation such as airplanes or ships. The effect of shock or vibration caused during transit and the damp environment can cause the unit to short out.

INSTALLING YOUR UPS SYSTEM

UNPACKING

Inspect the UPS upon receipt. The box should contain the following:

(a) UPS unit

(b) User's manual

(c) Serial cable

(d) USB A+B type cable

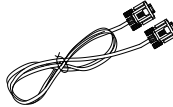
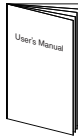
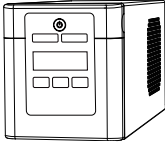

*PowerPanel® Bussiness Edition software is available on our website. Please visit www.cyberpower.com and go to the Software Section for free download.

AUTOMATIC VOLTAGE REGULATOR

The M550L/M750L/M1100XL stabilizes inconsistent utility power voltage to nominal levels that are safe for equipment. Inconsistent utility power may be damaging to important data files and hardware, but with Automatic Voltage Regulation (AVR), damaging voltage levels are corrected to safe levels. AVR automatically increases low utility power and decreases high utility power to a consistent and safe 120 volts.

SYSTEM BLOCK DIAGRAM

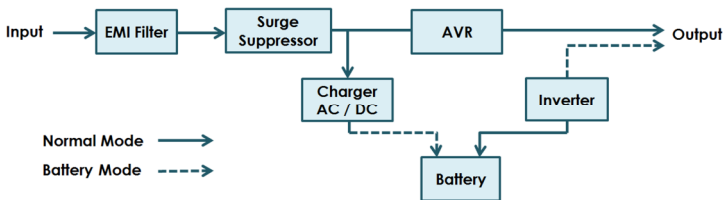

INSTALLING YOUR UPS SYSTEM

HARDWARE INSTALLATION GUIDE

1. Your new UPS may be used immediately upon receipt. However, to ensure the battery's maximum charge capacity, it is recommended that you charge the battery for at least 16 hours. Your UPS is equipped with an auto-charge feature. When the UPS is plugged into an AC outlet, the battery will automatically charge whether the UPS is turned on or off.
Note: This UPS is designed with a safety feature to keep the system from being turned on during shipment. The first time you turn the UPS on, you will need to have it connected to AC power or it will not power up.
2. With the UPS unit turned off and unplugged, connect your computer, monitor, and any other peripherals requiring battery backup into the battery power supplied outlets. DO NOT plug a laser printer, paper shredder, copier, space heater, vacuum, sump pump or other large electrical devices into the "Battery and Surge Protected Outlets". The power demands of these devices may overload and damage the unit.
3. Plug the UPS into a 2 pole, 3 wire grounded receptacle (wall outlet). Make sure the wall branch outlet is protected by a fuse or circuit breaker and does not service equipment with large electrical demands (e.g. air conditioner, copier, etc...). The warranty prohibits the use of extension cords, outlet strips, and surge strips.
4. Press the power switch to turn the unit on. The Power On indicator will illuminate and the unit will "beep". If an overload is detected, an audible alarm will sound and the unit will emit one long beep. To correct this, turn the UPS off and unplug at least one piece of equipment from the battery power supplied outlets. Make sure the circuit breaker is depressed and then turn the UPS on.
5. To maintain optimal battery charge, leave the UPS plugged into an AC outlet at all times.
6. To store the UPS for an extended period, cover it and store with the battery fully charged. While in storage, recharge the battery every three months to ensure battery life.
7. Insure the wall outlet and UPS are located near the equipment being attached for proper accessibility.

BASIC OPERATION

FRONT PANEL DESCRIPTION

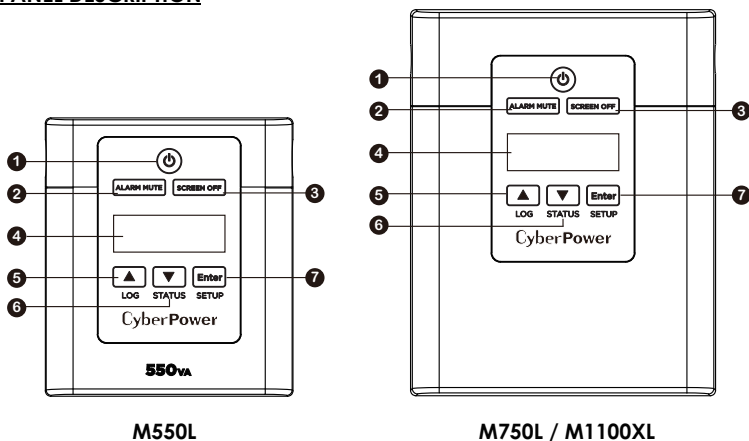

1. Power Switch / Power On Indicator

Used as the master on/off switch for equipment connected to the battery power supplied outlets.

2. Alarm Mute Button

Press the Alarm mute button to mute the alarm while it is beeping. Press the button for 2 seconds to enable / disable the buzzer.

3. Screen off Button

Press the Screen off button to light up / off the LCD. Press the button for 2 seconds to enable / disable the Auto Sleep function of the LCD.

4. LCD module display

The LCD display shows all the UPS information and messages which includes operation mode, Load, Estimated Runtime, Battery information, input, output and Date & Time.

5. Log/Up Button

For UPS log information, press the button for 2 seconds. This button is also used to scroll up.

6. Status/Down Button

For UPS status information, press the button for 2 seconds. This button is also used to scroll down.

7. Setup/Enter Button

Press the Setup button for 2 seconds to enter setup menu and then select the functions for configuration.

For additional information about the LCD Function Setup, please refer to the Function Setup Guide.

BASIC OPERATION

REAR PANEL DESCRIPTION

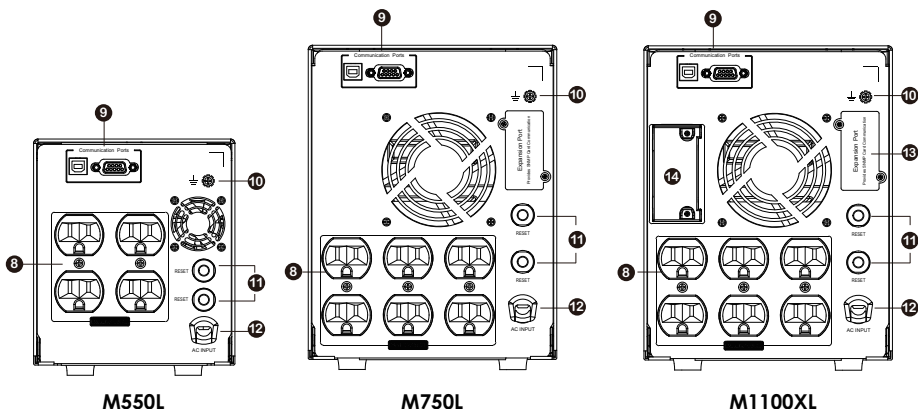

8. Battery and Surge Protected Outlets (Hospital-Grade)

The unit has several battery powered and surge protected outlets (4 outlets for M550L and 6 outlets for M750L/M1100XL) for connected equipment to ensure temporary uninterrupted operation of your equipment during a power failure. (**DO NOT** plug a laser printer, paper shredder, copier, space heater, vacuum, sump pump or other large electrical devices into the "Battery and Surge Protected Outlets". The power demands of these devices may overload and damage the unit.)

9. Serial/USB Ports to PC

The Serial and USB ports allow connection and communication between the personal computer and the UPS unit.

Note: Only one port can be used at a time; when the USB is in use, the serial port will be disabled.

10. TVSS Ground

Use the Transient Voltage Surge Suppression Screw to ground the UPS.

11. Input / Output Circuit Breaker

Located on the back of the UPS, the circuit breaker provides overload and fault protection.

12. AC Input Power Cord

Heavy-duty power cord.

13. SNMP/HTTP Network Slot (For M750L and M1100XL)

Remove the cover panel to install an optional RMCARD to remotely monitor and manage your UPS over a network.

14. Extended Battery Connector (For M1100XL only)

Use to connect the optional CyberPower external battery packs for extended runtime.

BATTERY WARNINGS

Follow the IMPORTANT SAFETY INSTRUCTIONS before servicing the batteries:

Replacement of batteries located in an **OPERATOR ACCESS AREA**.

CAUTION! Risk of explosion if battery is replaced by an incorrect type. Dispose of used batteries according to the instruction.

CAUTION! When replacing batteries, replace with the same number of the following battery: CyberPower / RB1270X2E for the M550L, CyberPower / RB1270X3A for the M750L, CyberPower / RB1290X3B for the M1100XL. Contact CyberPower Systems about replacement batteries.

CAUTION! Risk of Energy Hazard, 12V, maximum 9 Ampere-hour battery. Before replacing batteries, remove conductive jewelry such as chains, wristwatches and rings. High energy conducted through these materials could cause severe burns.

CAUTION! Do not dispose of batteries in a fire. The batteries may explode.

CAUTION! Do not open or mutilate batteries. Released material is harmful to the skin and eyes. It may be toxic.

CAUTION! For UPS which is equipped with extended battery connector, only connect to CyberPower extended battery pack. Contact CyberPower Systems about extended battery pack.

REMANDER: Batteries are considered HAZARDOUS WASTE and must be disposed of properly. Most retailers that sell lead-acid batteries collect used batteries for recycling, as required by local regulations.

BATTERY REPLACEMENT

BEFORE REPLACING THE BATTERY

1. Remove all watches, rings or other metal objects.
2. Only use tools with insulated handles.
3. DO NOT lay tools or other metal parts on top of battery or any battery terminals.
4. Wear rubber gloves and boots.

BATTERY REPLACEMENT PROCEDURE

Step1. Remove the front panel of the UPS.

Step2. Remove two screws from the battery compartment cover.

Step3. Slide the cover completely off from the unit.

Step4. Disconnect the battery wires from the batteries and remove the batteries from the compartment. Insert the new battery pack. Connect the Red battery cable to Red connector on Battery pack and connect Black ones.

Step5. Assemble the battery compartment cover, screws and front panel in the reverse sequence of above steps. Recharge the unit for 12 hours to ensure the UPS performs expected runtime.

M550L

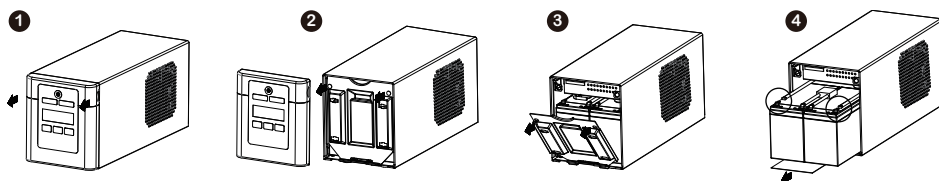

M750L / M1100XL

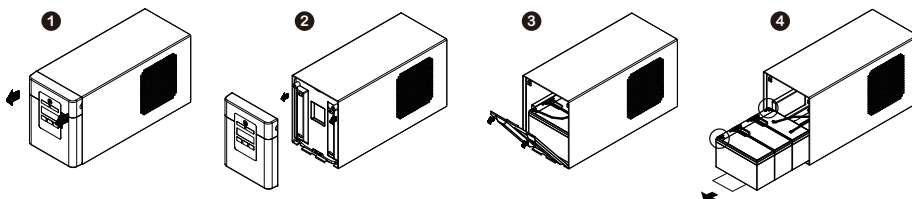

DEFINITIONS FOR ILLUMINATED LCD DISPLAY

Status Menu		
➤ Operation Mode	➤ Load Energy	➤ Input
➤ Load Power	➤ Estimated Runtime	➤ Output
➤ Load VA	➤ Battery Information	➤ Date & Time
➤ Load Amps		
Logs Menu		
➤ Event- Transfer (X1-X10)	➤ Last Battery Change	➤ LCD Firmware Version
➤ Event- Fault (F1-F10)	➤ Next Battery Change	➤ Serial Number
➤ Model Name	➤ UPS Firmware Version	
Setup Menu		
➤ Utility Power	➤ LCD Auto Sleep	➤ Self-Test
➤ MIN O/P Voltage	➤ Cycling Display	➤ Alarm Test
➤ MAX O/P Voltage	➤ Low Battery Warning	➤ Date & Time
➤ Sensitivity	➤ Battery Change Date	➤ Language
➤ Audible Alarm	➤ Auto Self-Test	➤ Back to Default

LCD FUNCTION SETUP GUIDE

BUTTON DESCRIPTION

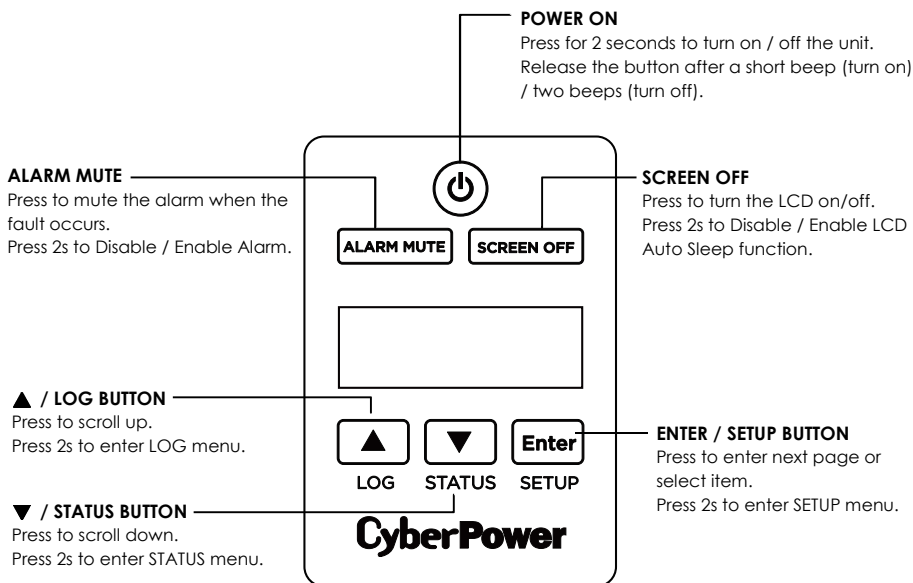

LCD FUNCTION SETUP GUIDE

Function	Options	Default	Description
O/P Voltage Range			
Utility Power	Normal Good Poor (Custom)* ESC	Normal	This determines when the UPS will switch to Battery Mode. If the utility power is Good, the unit will go to Battery Mode more often. If the utility power is Poor, the unit will go to Battery Mode less often to tolerate the utility power fluctuations.
MIN O/P Voltage	97~106V	102V	If the utility voltage is usually low and the connected equipment can work with this condition, you can set the output voltage range lower to avoid UPS going to AVR Mode too often.
MAX O/P Voltage	127~136V	131V	If the utility voltage is usually high and the connected equipment can work with this condition, you can set the output voltage range higher to avoid UPS going to AVR Mode too often.
Sensitivity			
Sensitivity	Medium High Low ESC	Medium	If the connected equipment can tolerate more power events, select Low Sensitivity. The UPS will go Battery Mode less often. If the connected equipment cannot tolerate power events, select High Sensitivity. The UPS will go Battery Mode more often.
Audible Alarm			
Alarm	Enable Disable ESC	Enable	If "Disable" is selected, the unit will mute all alarms except for overload condition.
Display Menu			
LCD Auto Sleep	Never After 1 minutes After 5 minutes After 10 minutes ESC	After 1 minutes	If Auto Sleep is selected, the LCD display will shut off after 1/5/10 minutes if no activity.
Cycling Display	Never After 10 seconds After 20 seconds After 30 seconds ESC	After 20 seconds	If the buttons are not touched in 10/20/30 seconds, it will start cycling the UPS information. In Status Menu, press Enter button once can also enter or leave cycling mode.

Battery Menu			
Low Battery Warning	0~1800s	300s	The audible alarm will sound when the remaining runtime is less than the value selected.
Extended Battery*	0~2	0	Set up the quantity of the extended batteries. * Only M1100XL supports Extended Battery.
Battery Change Date	Jan / Feb / Mar / Apr / May / Jun / Jul / Aug / Sep / Oct / Nov / Dec 2000~2099	---/----	Optional setup information. User can select the install date of new batteries.
Test Menu			
Self-Test?	No Yes	No	If Yes is selected, the UPS will perform a self-test.
Auto Self-Test On Startup	Yes No ESC	No	If Yes is selected, the UPS will perform a self-test when startup.
Auto Self-Test Frequency	Never Every week Every 2 weeks ESC	Never	Set up the frequency of Auto Self-Test.
Alarm Test?	Short Test Continuous Test ESC	---	This option tests the alarm's audible warning and LED indicators to insure they are normal.
Other Setup			
Date & Time	yyyy/mm/dd hh:mm	---/--/-- --:--	Set up year/month/day, hour/minute.
Language	English German French	English	Set up the Language.
Back to Default?	No Yes	No	Restores the UPS factory default settings.

TROUBLESHOOTING

Problem	Possible Cause	Solution
Circuit breaker button is projecting from the back of the unit.	Circuit breaker has tripped due to an overload.	Turn the UPS off and unplug at least one piece of equipment. Wait 10 seconds, reset the circuit breaker by pressing the button in, and then turn the UPS on.
The UPS does not perform expected runtime.	Batteries are not fully charged.	Recharge the battery by leaving the UPS plugged in.
	Batteries are worn out.	Contact CyberPower Systems about replacement batteries.
The UPS will not turn on.	The on/off switch is designed to prevent damage from rapidly turning it off and on.	Turn the UPS off. Wait 10 seconds and then turn the UPS on.
	The unit is not connected to an AC outlet.	The unit must be connected to a 120V 50/60Hz outlet.
	Batteries are worn out.	Contact CyberPower Systems about replacement batteries.
	Mechanical problem.	Contact CyberPower Systems for repair.
PowerPanel® Business Edition is inactive.	The USB/serial cable is not connected.	Connect the USB/serial cable to the UPS unit and an open USB/serial port on the back of the computer. You must use the cable that came with the unit.
	The USB/serial cable is connected to the wrong port.	Check the back of the computer for an additional USB/serial port. Move the cable to this port.
	The serial cable is not the cable that came with the unit.	Please use the serial cable that came with the unit for the software.

Additional troubleshooting information can be found at www.cyberpowersystems.com/support.

TECHNICAL SPECIFICATIONS

MODEL	M550L	M750L	M1100XL
Capacity (VA)	550	750	1100
Capacity (Watts)	440	600	880
INPUT			
Input Voltage Range	90Vac – 150Vac		
Input Frequency Range	50/60Hz ± 3Hz Auto-sensing		
Input Plug Type	NEMA 5-15P		
OUTPUT			
Output Receptacles	NEMA 5-15R (Hospital Grade)		
Output Voltage	120Vac ± 5%		
Output Frequency	50/60Hz ± 1%		
Output Waveform	Simulated Sine Wave		
Transfer Time (Typical)	< 10ms		
Overload Protection	Internal Current Limiting, Circuit Breaker		
SURGE PROTECTION AND FILTERING			
Lightning / Surge Protection	Yes		
BATTERY			
Replaceable Battery Pack	RB1270X2E	RB1270X3A	RB1290X3B
Extended Runtime	No	No	Yes (Max. 2)
Sealed Maintenance Free	Yes		
Recharge Time (Typical)	8 hours		
WARNING DIAGNOSTICS			
Indicators	LCD Display, LED Indicators (Power On)		
Audible Alarms	On Battery, Low Battery, Overload, UPS Fault		
ENVIRONMENTAL			
Operating Temperature	32 °F to 104 °F (0 °C to 40 °C)		
Operating Relative Humidity	0 to 95% Non-condensing		
Storage Temperature	5 °F to 113 °F (-15 °C to 45 °C)		
Storage Relative Humidity	0 to 95% Non-condensing		
MANAGEMENT			
Connectivity Ports	(1) USB Port, (1) Serial Port		
Software	PowerPanel® Business Edition		
PHYSICAL			
Dimensions (WxHxD)	5.4" x 6.4" x 13.7"	6.7" x 8.7" x 17"	
Weight (lb/kg)	30.1lbs	52.8lbs	54.0lbs
SAFETY			
Max. Current Leakage	< 100µA		
Conformance Approvals	UL1778, cUL, UL60601tested , FCC Part15 Class A		

CYBERPOWER GREENPOWER UPS™ TECHNOLOGY

Advanced Energy-Saving Patented Bypass Technology

CyberPower's patented GreenPower UPS™ with Bypass Technology are ENERGY STAR complainant ensuring lower power consumption and energy costs compared to conventional UPS models. Even when utility power is normal, conventional UPS models constantly pass power through a transformer. By contrast, under normal conditions the advanced circuitry of a GreenPower UPS™ bypasses the transformer.

As a result, the power efficiency is significantly increased while decreasing waste heat, using less energy, and reducing energy costs.

When an abnormal power condition occurs, the GreenPower UPS™ automatically runs power through its transformer to regulate voltage and provide "safe" power. Since utility power is normal over 88% of the time, the GreenPower UPS™ operates primarily in its efficient bypass mode.

The GreenPower UPS™ is also manufactured in accordance with the Restriction on Hazardous Substances (RoHS) directive making it one of the most environmentally-friendly on the market today.



LIMITED WARRANTY AND CONNECTED EQUIPMENT GUARANTEE

Read the following terms and conditions carefully before using the CyberPower M550L / M750L / M1100XL (the "Product"). By using the Product you consent to be bound by and become a party to the terms and conditions of this Limited Warranty and Connected Equipment Guarantee (together referred to as this "Warranty"). If you do not agree to the terms and conditions of this Warranty, you should return the Product for a full refund prior to using it.

Who Is Providing This Warranty?

CyberPower Systems (USA), Inc. ("CyberPower") provides this Limited Warranty.

What Does This Warranty Cover?

This warranty covers defects in materials and workmanship in the Product under normal use and conditions. It also covers equipment that was connected to the Product and damaged because of the failure of the Product.

What Is The Period Of Coverage?

This warranty covers the Product for three years and connected equipment for as long as you own the Product.

Who Is Covered?

This warranty only covers the original purchaser. Coverage ends if you sell or otherwise transfer the Product.

How Do You Get Warranty Service?

1. Before contacting CyberPower, identify Your Product Model Number, the Purchase Date, and each item of Connected Equipment (E.G. Computer tower, Computer Monitor, Cable Modem, etc).
2. Visit our web site at www.cyberpowersystems.com/support or Call us at (877) 297-6937.
3. If your product requires warranty service you must provide a copy of your dated purchase receipt or invoice.

How Do You Open A Connected Equipment Claim?

1. Call us at (877) 297-6937 or write to us at Cyber Power Systems (USA), Inc., 4241 12th Ave. E., STE 400, Shakopee, MN 55379, or send us an e-mail message at claims@cpsww.com for instructions, within 10 days of the occurrence.
2. When you contact CyberPower, identify the Product, the Purchase Date, and the item(s) of Connected Equipment. Have information on all applicable insurance or other resources of recovery/payment that are available to the Initial Customer and request a Claim Number.
3. You must provide a dated purchase receipt (or other proof of the original purchase) for the Cyber Power unit and connected equipment. You also need to provide a description of the damage to your connected equipment.
4. You must provide a dated purchase receipt (or other proof of the original purchase) and provide a description of the damage to your connected equipment.
5. Pack and ship the product to CyberPower and, if requested, the item(s) of Connected Equipment, a repair cost estimate for the damage to the Connected Equipment, and all claim forms that CyberPower provides to you. Show the Claim Number on the shipping label or include it with the product. You must prepay all shipping costs, you are responsible for packaging and shipment, and you must pay the cost of the repair estimate.

How Long Do I Have To Make A Claim?

All claims must be made within ten days of the occurrence.

What Will We Do To Correct Problems?

CyberPower will inspect and examine the Product.

If the Product is defective in material or workmanship, CyberPower will repair or replace it at CyberPower's expense, or, if CyberPower is unable to or decides not to repair or replace the Product (if defective) within a reasonable time, CyberPower will refund to you the full purchase price you paid for the Product (purchase receipt showing price paid is required).

If it appears that our Product failed to protect any equipment plugged into it, we will also send you forms for making your claim for the connected equipment. We will repair or replace the equipment that was damaged because of the failure of our Product or pay you the fair market value (NOT REPLACEMENT COST) of the equipment at the time of the damage. We will use Orion Blue Book, or another a third-party valuation guide, or eBay, craigslist, or other source to establish that amount. Our maximum liability is limited to \$400,000 for the M550L, M750L and M1100XL.

Who Pays For Shipping?

We pay when we send items to you; you pay when you send items to us.

What Isn't Covered By The Warranty?

1. This Warranty does not cover any software that was damaged or needs to be replaced due to the failure of the Product or any data that is lost as a result of the failure or the restoration of data or records, or the reinstallation of software.
2. This Warranty does not cover or apply to: misuse, modification, operation or storage outside environmental limits of the Product or the equipment connected to it, nor for damage while in transit or in storage, nor if there has been improper operation or maintenance, or use with items not designed or intended for use with the Product, such as laser printers, appliances, aquariums, medical or life support devices, etc.

What Are The Limitations?

1. The sole and exclusive remedies of the Initial Customer are those provided by this Warranty.
2. This Warranty does not apply unless the Product and the equipment that was connected to it were connected to properly wired and grounded outlets (including compliance with electrical and safety codes of the most current electrical code), without the use of any adapters or other connectors.
3. The Product must have been plugged directly into the power source and the equipment connected to the Product must be directly connected to the Product and not "daisy-chained" together in serial fashion with any extension cords, another Product or device similar to the Product, surge suppressor, or power tap. Any such installation voids the Limited Warranty.
4. The Product and equipment connected to it must have been used properly in a suitable and proper environment and in conformance with any license, instruction manual, or warnings provided with the Product and the equipment connected to it.
5. The Product must have been used at all times within the limitations on the Product's VA capacity. The Product was designed to eliminate disrupting and damaging effects of momentary (less than 1ms) voltage spikes or impulses from lightning or other power transients. If it can be shown that a voltage spike lasting longer than 1ms has occurred, the occurrence will be deemed outside the rated capabilities of the Product and the Limited Warranty is void. CyberPower Does Not Cover or Undertake Any Liability in Any Event for Any of the Following:
 1. Loss of or damage to data, records, or software or the restoration of data or records, or the reinstallation of software.
 2. Damage from causes other than AC Power Line Transients, spikes, or surges on properly installed, grounded and code-compliant 120 volt power lines in the United States and Canada; transients, surges or spikes on standard telephone land lines, PBX telephone equipment lines or Base 10T Ethernet lines, when properly installed and connected. (This exclusion applies, for example, to fluctuations in data transmission or reception, by CATV or RF transmission or fluctuations, or by transients in such transmission.)

3. Damage from any circumstance described as excluded above with respect to the Product.
4. Damages from fire, flood, wind, rain, rising water, leakage or breakage of plumbing, abuse, misuse or alteration of either the product or the Connected Equipment.
5. CyberPower excludes any liability for personal injury under the Limited Warranty and Connected Equipment Guarantee. CyberPower excludes any liability for direct, indirect, special, incidental or consequential damages, whether for damage to or loss of property [EXCEPT FOR (AND ONLY FOR) the specific limited agreement of CyberPower to provide certain warranty benefits regarding "Connected Equipment" under this Warranty], loss of profits, business interruption, or loss of information or data. NOTE: Some States or Provinces do not allow the exclusion or limitation of incidental or consequential damages, so the above limitation may not apply to you.
6. The Product is not for use in high-risk activities or with aquariums. The Product is not designed or intended for use in hazardous environments requiring fail-safe performance, or for use in any circumstance in which the failure of the Product could lead directly to death, personal injury, or severe physical or property damage, or that would affect operation or safety of any medical or life support device (collectively, "High Risk Activities"). CyberPower expressly disclaims any express or implied warranty of fitness for High Risk Activities or with aquariums. CyberPower does not authorize use of any Product in any High Risk Activities or with Aquariums. ANY SUCH USE IS IMPROPER AND IS A MISUSE OF THE PRODUCT.

Where Can I Get More Information?

The application of the United Nations Convention of Contracts for the International Sale of Goods is expressly excluded. CyberPower is the warrantor under this Limited Warranty.

For further information please feel free to contact CyberPower at CyberPower Systems (USA), Inc. 4241 12th Ave E., STE 400, Shakopee, MN 55379; call us at (877) 297-6937; or send us an e-mail message at claims@cpsww.com.

All rights reserved. Reproduction without permission is prohibited.



Customer Support is available on our website.

Visit CyberPower at www.cyberpower.com to get more information.