



ATEN Altusen™

- KA7230 PS/2-USB Console Module (300m max.)
- KA7240 Virtual Media PS/2-USB Console Module (300m max.)
- KA7230S PS/2-USB Console Module (200m max.)
- KA7240S Virtual Media PS/2-USB Console Module (200m max.)

© Copyright 2017 ATEN International Co., Ltd. www.aten.com
 Altusen and the Altusen logo are trademarks of ATEN International Co., Ltd.
 All rights reserved. All other trademarks are the property of their respective owners.
 This product is RoHS compliant PAPE-1215-301G Printing Date: 05/2017



All information, documentation, firmware, software utilities, and specifications contained in this package are subject to change without prior notification by the manufacturer. Please visit our website <http://www.aten.com/download/?cid=dds> for the most up-to-date versions.

Online Registration
 • <http://eservice.aten.com>
Technical Phone Support
International:
 • 886-2-8692-6959
China:
 • 86-10-5255-0110
Japan:
 • 81-3-5615-5811
Korea:
 • 92-2-467-6789
North America:
 • 1-888-999-ATEN Ext: 4988
United Kingdom:
 • 44-8-4481-58923



Support and Documentation Notice

All information, documentation, firmware, software utilities, and specifications contained in this package are subject to change without prior notification by the manufacturer. To reduce the environmental impact of our products, ATEN documentation and software can be found online at <http://www.aten.com/download/>

Technical Support
www.aten.com/support

EMC Information
FEDERAL COMMUNICATIONS COMMISSION INTERFERENCE STATEMENT:
 This equipment has been tested and found to comply with the limits for a Class A digital device, pursuant to Part 15 of the FCC Rules. These limits are designed to provide reasonable protection against harmful interference when the equipment is operated in a commercial environment. This equipment generates, uses, and can radiate radio frequency energy and, if not installed and used in accordance with the instruction manual, may cause harmful interference to radio communications. Operation of this equipment in a residential area is likely to cause harmful interference in which case the user will be required to correct the interference at his own expense.

FCC Caution: Any changes or modifications not expressly approved by the party responsible for compliance could void the user's authority to operate this equipment.
Warning: Operation of this equipment in a residential environment could cause radio interference.
Warning: This equipment is compliant with Class A of CISPR 32. In a residential environment this equipment may cause radio interference.
Suggestion: Shielded twisted pair (STP) cables must be used with the unit to ensure compliance with FCC & CE standards.

This device complies with Part 15 of the FCC Rules. Operation is subject to the following two conditions: (1) this device must not cause harmful interference, and (2) this device must accept any interference received, including interference that may cause undesired operation.

이 기기는 업무용(А급) 전자파적합기기로서 판매자 또는 사용자는 이 점을 주의하시기 바라며, 가정외의 지역에서 사용하는 것을 목적으로 합니다.

1 Package Contents

This User Guide briefly describes how to install and operate the KA7230/KA7230S/KA7240/KA7240S Console Module with the Matrix KVM Switch

The complete KA7230/KA7230S/KA7240/KA7240S package consists of:

- 1 KA7230 or KA7230S or KA7240 or KA7240S Console Module with stacking brackets
- 1 KVM Cable
- 1 Power Adapter
- 1 RS-232 Cable (DB9F to DB9F) (KA7230/KA7240)
- 1 Mounting Kit
- 1 User Instructions

If anything is missing or damaged, please contact your dealer immediately.

2-1 Hardware Review (Front View)

KA7230/KA7230S

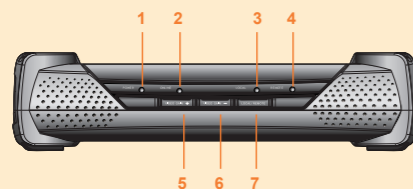

1. Power LED [Indicates the module is turned on and receiving power]
2. Online LED [Indicates connection to a KVM switch]
3. Local LED [Indicates Local Computer has the KVM focus]
4. Remote LED [Indicates KVM Switch has the KVM focus]
5. Video Gain + Switch [Press to increase the video gain]
6. Video Gain - Switch [Press to decrease the video gain]
7. Local / Remote Switch [Press to toggle the Local Computer/KVM Switch focus]

Note: Local Computer / KVM Switch focus may also be toggled using a keyboard hotkey combination as follows:

1. Press and hold [Num Lock]
2. Press and release the minus (-) key twice
3. Release [Num Lock]

2-2 Hardware Review (Front View)

KA7240/KA7240S

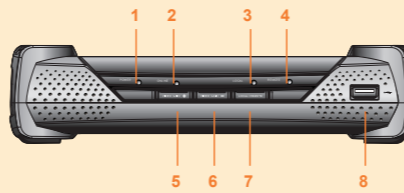

1. Power LED [Indicates the module is turned on and receiving power]
2. Online LED [Indicates connection to a KVM switch]
3. Local LED [Indicates Local Computer has the KVM focus]
4. Remote LED [Indicates KVM Switch has the KVM focus]
5. Video Gain + Switch [Press to increase the video gain]
6. Video Gain - Switch [Press to decrease the video gain]
7. Local / Remote Switch [Press to toggle the Local Computer/KVM Switch focus]
8. USB Port [Virtual Media device plugs in here]

3 Hardware Review (Rear View)

KA7230/KA7230S



1. Grounding Terminal
2. KVM Switch Connection Ports
3. RS-232 Port
4. Console PS/2 Mouse and Keyboard Ports
5. Power Jack
6. Local Computer KVM Port
7. Console Monitor Port
8. Console USB Mouse and Keyboard Ports
9. Firmware Recovery Switch

KA7240/KA7240S



1. Grounding Terminal
2. Local Computer Microphone and Speaker Ports
3. KVM Switch Connection Ports
4. RS-232 Port
5. Console PS/2 Mouse and Keyboard Ports
6. Power Jack
7. Local Computer KVM Port
8. Console Monitor Port
9. Console USB Mouse and Keyboard Ports
10. Firmware Recovery Switch
11. Console Microphone and Speaker Ports

4 Requirements

Console

- A monitor capable of the highest resolution that you will be using on any computer in the installation.
- A PS/2 or USB keyboard
- A PS/2 or USB mouse

Cables

- Cat 5e/6 to connect the KA7230/KA7230S/KA7240/KA7240S to the KVM switch
- For optimal signal integrity and to simplify the layout, a high quality KVM Console Module to Local Computer cable (with custom SPHD-15 connector) is included with this product. No additional cable purchase is necessary.
- RS-232 Cable (DB9F to DB9F) to connect the KA7230/KA7230S/KA7240/KA7240S' RS-232 port to the local PC.

5 Hardware Installation

1. Remove stacking brackets.

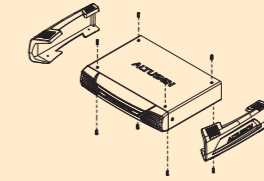

2. Remove the two screws from the side front and the two screws from the bottom front of the unit.

3. Use the screws provided with the rack mount kit to attach the mounting brackets to the sides of the unit.

4. Attach unit to rack.



Before you begin, make sure that power to all the devices you will be connecting up has been turned off. You must unplug the power cords of any computer that has a Keyboard Power On function.

To set up your Console Module, refer to the installation diagram (the numbers in the diagram correspond to the steps below), and do the following:

Note: For KA7230/KA7230S modules, disregard references to microphone and speaker installation.

1. Ground the unit by connecting one end of the grounding wire to the grounding terminal, and the other end of the wire to a suitable grounded object
2. Plug your Console devices (USB or PS/2 keyboard, USB or PS/2 mouse, monitor, microphone and speakers into the switch's Console Ports. Each Port is labeled and marked with an icon to indicate itself.
3. Use Cat 5e/6 cable to connect the upper KVM Switch Port (port 1) on the KA7230/KA7230S/KA7240/KA7240S' rear panel to any available Console Port on the KVM switch's rear panel.
4. (Optional) For a redundant connection to the switch, use Cat 5e/6 cable to connect the lower KVM Switch Port (port 2) on the KA7230/KA7230S/KA7240/KA7240S' rear panel to any available Console Port on the KVM switch's rear panel.
5. Use the KVM Cable provided with this package to connect the Local Computer KVM Port to the local computer.
6. Plug in the power adapter.

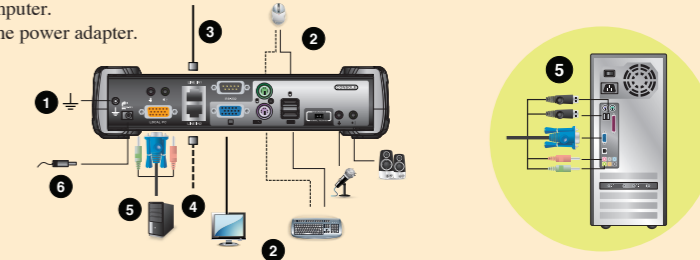

6 Specifications

Function	KA7230/KA7230S	KA7240/KA7240S
Computer Connections	1	
Console Connections	1	
Port Selection	GUI_Hotkey	
Connectors	Console Ports	Keyboard: 1 x USB Type A Female (White); 1 x 6-pin Mini-DIN Female (Purple)
	Video	1 x HDB-15 Female (Blue)
	Mouse	1 x USB Type A Female (White); 1 x 6-pin Mini-DIN Female (Green)
	Local Computer KVM Port	1 x SPHD-17 Female (Yellow)
	USB virtual media 2.0 port	N/A
	KVM Switch Ports	1 x USB Type A Female (White)
	RS-232	2 x RJ-45 Female
	Audio	1 x DB9 Male (Black)
	Power	2 x Mini stereo jack Female (Green)
		2 x Mini stereo jack Female (Pink)
Switches	Local/Remote	1 x DC Jack
	Video Gain Adjustment	1 x Pushbutton
	F/W Upgrade	2 x Pushbutton
LEDs	Power	1 x Slide
	Online	1 (Blue)
	Local	1 (Green)
	Remote	1 (Orange)
Emulation	Keyboard/Mouse	1 (Orange)
Video		PS/2; USB (PC, Sun, Mac)
Scan Interval		1280 x 1024 @ 60 Hz
Power Consumption	DC 5.3V, 6.5 W	1-240 sec.
Environment	Operating Temp.	DC 5.3V, 10.12 W
	Storage Temp.	0° to 50° C
	Humidity	-20° to 60° C
Physical Properties	Housing	0 - 80% RH, Non-condensing
	Weight	Metal
	Dimensions (L x W x H)	1.22 kg
		22.71 x 17.15 x 5.48 cm (including stacking bracket)