

Vostro 15 7580

Quick Start Guide

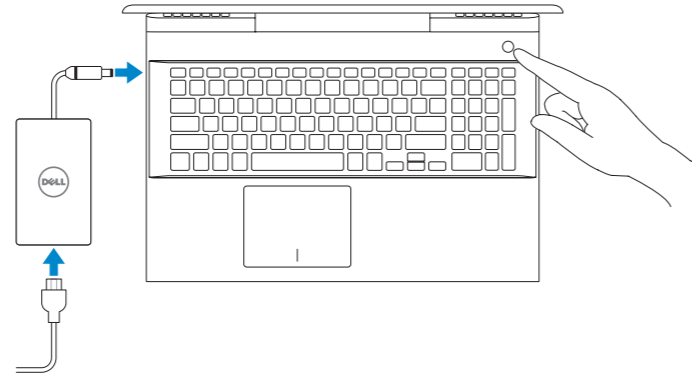

1 Connect the power adapter and press the power button



2 Finish operating system setup

Windows 10

Connect to your network



NOTE: If you are connecting to a secured wireless network, enter the password for the wireless network access when prompted.

Sign in to your Microsoft account or create a local account



Ubuntu

Follow the instructions on the screen to finish setup.

Locate Dell apps



SupportAssist

Check and update your computer

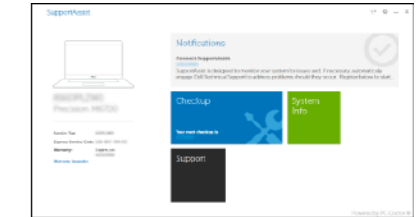

Create recovery media for Windows 10

In Windows search, type Recovery, click Create a recovery media, and follow the instructions on the screen.

Features

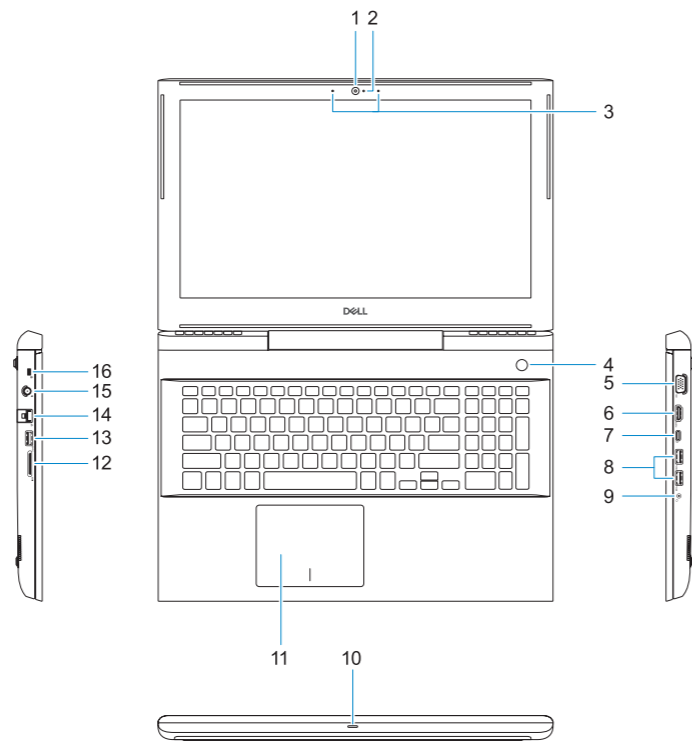

- 1. Camera
- 2. Camera status light
- 3. Dual-array microphones
- 4. Power button/Optional Fingerprint reader
- 5. VGA port
- 6. HDMI port
- 7. USB Type-C port with Thunderbolt™ 3
- 8. USB 3.1 Gen 1 port
- 9. Headset/Mic port
- 10. LED status light
- 11. Touchpad
- 12. SD card reader
- 13. USB 3.1 Gen 1 port
- 14. Network port
- 15. Power connector port
- 16. Noble Wedge lock slot
- 17. Service Tag label

Shortcut keys

- Fn + F1 Mute audio
- Fn + F2 Decrease volume
- Fn + F3 Increase volume
- Fn + F4 Previous track
- Fn + F5 Play/Pause
- Fn + F6 Next track
- Fn + F8 Extend display
- Fn + F9 Search
- Fn + F10 Backlit keyboard

- Fn + F11 Decrease brightness
- Fn + F12 Increase brightness
- Fn + PrtScr Turn off/on wireless

NOTE: For more information, see *Owner's Manual* at Dell.com/support/manuals.

NOTE: Ensure that you download the Dell Power Manager (DPM 3.0) from Dell.com/support before connecting a Dell docking station. For more information on setting up your Dell docking station, see *Dell Docking Solution User's Guide* at Dell.com/support/manuals.

