



LumiStreet

BGP213 LED18-4S/740 II DM50 D9 48/60A

LumiStreet Small - LED module 1800 lm - 740 neutral white - Safety class II (II) - Distribution medium - Dimming via external communication DALI - Universal for diameter 48-60 mm adjustable

Many local authorities today have an outdated public lighting installation that urgently needs to be replaced, yet have only a limited budget available. We have the answer to their needs. With its compact design and modern LED architecture, LumiStreet is a versatile, cost-effective luminaire that fulfils basic functional road lighting requirements. It is made of high-quality components that ensure long lifetime and low maintenance cost. The result? A road lighting luminaire that provides effective illumination while at the same time cutting energy and maintenance bills.

Product data

General Information		Connection	SI [Screw connection block]
Number of light sources	1 [1 pc]	Cable	-
Lamp family code	LED18 [LED module 1800 lm]	Protection class IEC	Safety class II (II)
Light source colour	740 neutral white	Coating	-
Light source replaceable	Yes	Glow-wire test	850/5 [Temperature 850 °C, duration 5 s]
Number of gear units	1 unit	Flammability mark	NO [-]
Driver/power unit/transformer	PSD [Power supply unit with DALI interface]	CE mark	CE mark
Driver included	Yes	ENEC mark	ENEC mark
Optical cover/lens type	FG [Flat glass]	Warranty period	5 years
Luminaire light beam spread	154°	Outdoor optic type	Distribution medium
Embedded control	No [-]	Photocell	No [-]
Control interface	DALI	Remarks	*-Per Lighting Europe guidance paper "Evaluating performance of LED based
Light regulation	Dimming via external communication DALI		

	luminaires - January 2018": statistically there is no relevant difference in lumen maintenance between B50 and for example B10. Therefore the median useful life (B50) value also represents the B10 value.
Supply cable type	No [-]
Constant light output	No
Spare parts available	Yes
Number of products on MCB	20
RoHS mark	-
WEEE mark	-
LED engine type	LED
Product Family Code	BGP213 [LumiStreet Small]

Light Technical

Upward light output ratio	0
Scotopic/photopic lumen ratio	1.6
Standard tilt angle post-top	0°
Standard tilt angle side entry	0°

Operating and Electrical

Input voltage	220-240 V
Input frequency	50 to 60 Hz
Initial CLO power consumption	[DELETE] W
Average CLO power consumption	[DELETE] W
End CLO power consumption	[DELETE] W
Inrush current	22 A
Inrush time	0.29 ms
Driver current	395 mA
Power factor (min.)	0.91

Controls and Dimming

Dimmable	Yes
----------	-----

Mechanical and Housing

Housing material	Aluminum die-cast
Reflector material	Polycarbonate
Optic material	Polycarbonate
Optical cover/lens material	Tempered glass
Fixation material	Aluminum
Mounting device	48/60A [Universal for diameter 48-60 mm adjustable]
Optical cover/lens shape	Flat
Optical cover/lens finish	Clear

Torque	15
Overall length	630 mm
Overall width	270 mm
Overall height	98 mm
Effective projected area	0.038 m²

Approval and Application

Ingress protection code	IP66 [Dust penetration-protected, jet-proof]
Mech. impact protection code	IK08 [5 J vandal-protected]
Surge protection (common/differential)	Philips standard surge protection level kV

Initial Performance (IEC Compliant)

Initial luminous flux	1548 lm
Luminous flux tolerance	+/-7%
Initial LED luminaire efficacy	131 lm/W
Init. Corr. colour temperature	4000 K
Init. colour rendering index	70
Initial chromaticity	(0.381, 0.379) SDCM <5
Initial input power	11.8 W
Power consumption tolerance	+/-11%

Over Time Performance (IEC Compliant)

Control gear failure rate at median useful life 100000 h	10 %
Lumen maintenance at median useful life* 100000 h	L91

Application Conditions

Ambient temperature range	-40 to +50 °C
Performance ambient temperature Tq	25 °C
Maximum dimming level	0% (digital)

Product Data

Full product code	871869634875800
Order product name	BGP213 LED18-4S/740 II DM50 D9 48/60A
EAN/UPC – product	8718696348758
Order code	34875800
Numerator – quantity per pack	1
Numerator – packs per outer box	1
Material no. (12NC)	910925863465
Net weight (piece)	6.110 kg

Dimensional drawing

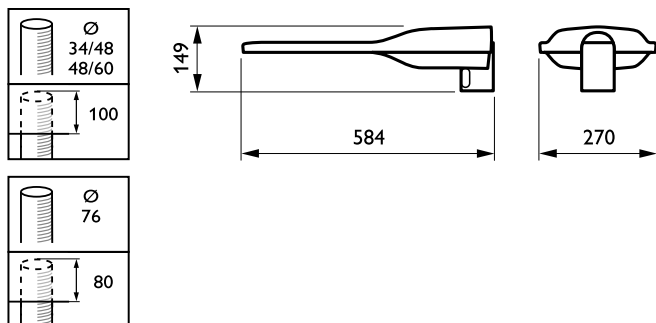

LumiStreet Small BGP/BGS212/213

Photometric data

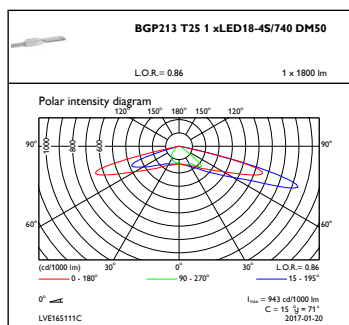

OFPC1_BGP213T251xLED18-4S740DM50

