



StyliD

ST740T LED39S/930 PSD-VLC MB BK

STYLID COMPACT G3 TRACK - LED Module, system flux 3900 lm - 930 warm white - Power supply unit with DALI interface, DC-compatible for central emergency lighting (integrated) - Medium beam - Black

Retailers are increasingly having to contend with rising energy prices. At the same time, they need to retain the quality of light they are used to, flexibility in architectural integration, and the right light effects to catch the customer's eye. Last but not least, they need future-proof solutions that will enable them to implement differentiating concepts in their store. Delivering high-quality light, punch in the beam and outstanding luminous efficacy, StyliD is the ideal energy-efficient solution for today's demanding retail environments, covering a variety of lighting applications, with including CrispWhite for fashion stores and Food recipes for supermarkets.

Product data

General Information			
Number of light sources	1 [1 pc]	Optical cover/lens type	No [-]
Lamp family code	LED39S [LED Module, system flux 3900 lm]	Luminaire light beam spread	30°
Beam angle of light source	120 °	Control interface	DALI
Light source colour	930 warm white	Connection	Push-in connector and pull relief
Light source replaceable	No	Cable	-
Number of gear units	1 unit	Protection class IEC	Safety class II
Driver/power unit/transformer	PSED [Power supply unit with DALI interface, DC-compatible for central emergency lighting (integrated)]	Glow-wire test	Temperature 650 °C, duration 30 s
Driver included	Yes	Flammability mark	F [For mounting on normally flammable surfaces]
Optic type	MB [Medium beam]	CE mark	CE mark
		ENEC mark	ENEC mark
		UL mark	No

Warranty period	5 years
Glare shielding accessories	No [-]
Remarks	*-Per Lighting Europe guidance paper "Evaluating performance of LED based luminaires - January 2018": statistically there is no relevant difference in lumen maintenance between B50 and for example B10. Therefore the median useful life (B50) value also represents the B10 value.
Constant light output	No
Number of products on MCB	24
RoHS mark	RoHS mark
Product Family Code	ST740T [STYLID COMPACT G3 TRACK]

Operating and Electrical

Input voltage	220 to 240 V
Input frequency	50 to 60 Hz
Control signal voltage	0-16 V DC DALI
Inrush current	5.3 A
Inrush time	0.70 ms
Power factor (min.)	0.9

Controls and Dimming

Dimmable	Yes
----------	-----

Mechanical and Housing

Housing material	Metal/Plastic
Reflector material	Polycarbonate aluminium coated
Optic material	Polycarbonate
Optical cover/lens material	Polymethyl methacrylate
Fixation material	-
Optical cover/lens finish	Clear
Overall length	279 mm
Overall width	89 mm
Overall height	191 mm

Approval and Application

Ingress protection code	IP20 [Finger-protected]
-------------------------	--------------------------

Mech. impact protection code	IK02 [0.2 J standard]
------------------------------	------------------------

Initial Performance (IEC Compliant)

Initial luminous flux	3900 lm
Luminous flux tolerance	+/-10%
Initial LED luminaire efficacy	101.2987012987013 lm/W
Init. Corr. colour temperature	3000 K
Init. colour rendering index	≥90
Initial chromaticity	(0.43, 0.40) SDCM <3
Initial input power	38.5 W
Power consumption tolerance	+/-10%

Over Time Performance (IEC Compliant)

Control gear failure rate at median useful life 50000 h	5 %
Lumen maintenance at median useful life* 50000 h	L80

Application Conditions

Ambient temperature range	+10 to +40 °C
Performance ambient temperature Tq	25 °C
Maximum dimming level	1%
Suitable for random switching	Yes (relates to presence/ movement detection and daylight harvesting)

Product Data

Full product code	871869684850000
Order product name	ST740T LED39S/930 PSD-VLC MB BK
EAN/UPC – product	8718696848500
Order code	84850000
Numerator – quantity per pack	1
Numerator – packs per outer box	1
Material no. (12NC)	910500457373
Net weight (piece)	1.200 kg

Dimensional drawing

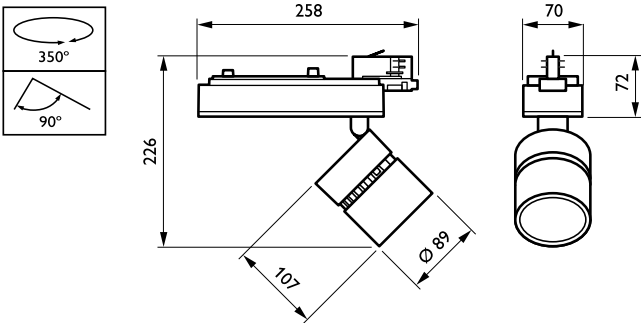

StyliD ST730C-ST750T

Photometric data

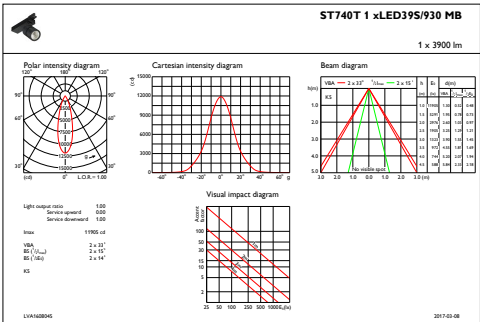

IFAS1_ST740T1xLED39S930MB

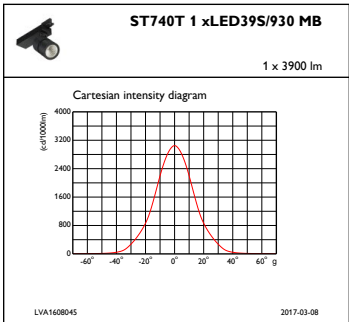

IFCC1_ST740T1xLED39S930MB

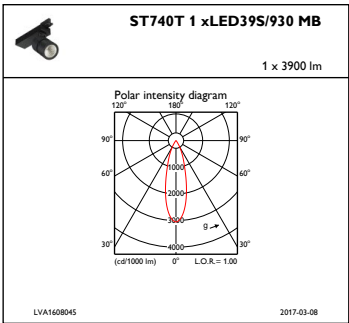

IFPC1_ST740T1xLED39S930MB

