



StyliD PremiumWhite

ST740T LED39S/PW930 PSD-VLC MB WH

STYLID COMPACT G3 TRACK - LED Module, system flux 3900 lm - Premium white with CRI ≥ 90 - Power supply unit with DALI interface, DC-compatible for central emergency lighting (integrated) - Medium beam - White

If you want a high quality of light and color rendering for your store, without having to compromise on energy savings, then StyliD PremiumWhite is exactly what you are looking for. This exciting solution delivers the same sparkling light effects as CDM conventional lighting. So now you can make the switch to LED with confidence!

Product data

General Information		Protection class IEC	Safety class II
Number of light sources	1 pc	Glow-wire test	Temperature 650 °C, duration 30 s
Lamp family code	LED39S [LED Module, system flux 3900 lm]	Flammability mark	For mounting on normally flammable surfaces
Beam angle of light source	120 °	CE mark	CE mark
Light source color	Premium white with CRI ≥ 90	ENEC mark	ENEC mark
Light source replaceable	No	UL mark	-
Number of gear units	1 unit	Warranty period	5 years
Driver/power unit/transformer	Power supply unit with DALI interface, DC-compatible for central emergency lighting (integrated)	Glare shielding accessories	-
Driver included	Yes	Remarks	*-Per Lighting Europe guidance paper "Evaluating performance of LED based luminaires - January 2018": statistically there is no relevant difference in lumen maintenance between B50 and for example B10. Therefore the median useful life (B50) value also represents the B10 value.
Optic type	Medium beam	Constant light output	No
Optical cover/lens type	Clear glass		
Luminaire light beam spread	30°		
Control interface	DALI		
Connection	Push-in connector and pull relief		
Cable	-		

StyliD PremiumWhite

Number of products on MCB of 16 A type B	24
RoHS mark	RoHS mark
Product family code	ST740T [STYLID COMPACT G3 TRACK]

Operating and Electrical

Input Voltage	220 to 240 V
Input Frequency	50 to 60 Hz
Control signal voltage	0-16 V DC DALI
Inrush current	5.3 A
Inrush time	0.70 ms
Power Factor (Min)	0.9

Controls and Dimming

Dimmable	Yes
----------	-----

Mechanical and Housing

Housing Material	Metal/Plastic
Reflector material	Polycarbonate aluminum coated
Optic material	Polycarbonate
Optical cover/lens material	Polymethyl methacrylate
Fixation material	-
Optical cover/lens finish	Clear
Overall length	279 mm
Overall width	89 mm
Overall height	191 mm

Approval and Application

Ingress protection code	IP20 [Finger-protected]
Mech. impact protection code	IK02 [0.2 J standard]

Initial Performance (IEC Compliant)

Initial luminous flux (system flux)	3900 lm
-------------------------------------	---------

Luminous flux tolerance	+/-10%
Initial LED luminaire efficacy	95 lm/W
Init. Corr. Color Temperature	3000 K
Init. Color Rendering Index	≥90
Initial chromaticity	(0.42, 0.38) SDCM <3
Initial input power	41 W
Power consumption tolerance	+/-10%

Over Time Performance (IEC Compliant)

Control gear failure rate at median useful life 50000 h	5 %
Lumen maintenance at median useful life* 50000 h	L80

Application Conditions

Ambient temperature range	+10 to +40 °C
Performance ambient temperature Tq	25 °C
Maximum dim level	1%
Suitable for random switching	Yes (relates to presence/ movement detection and daylight harvesting)

Product Data

Full product code	871869697298400
Order product name	ST740T LED39S/PW930 PSD-VLC MB WH
EAN/UPC - Product	8718696972984
Order code	910500459036
Numerator - Quantity Per Pack	1
Numerator - Packs per outer box	1
Material Nr. (12NC)	910500459036
Net Weight (Piece)	1.200 kg

Dimensional drawing

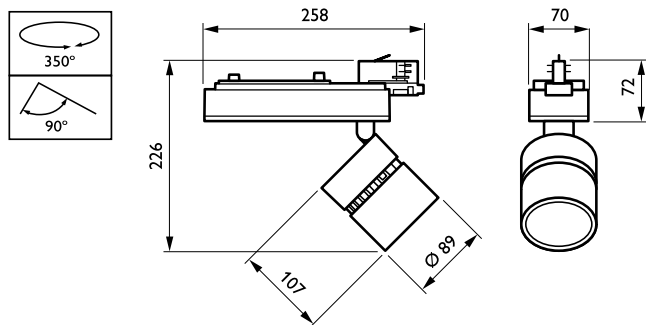

StyliD ST730C-ST750T

Photometric data

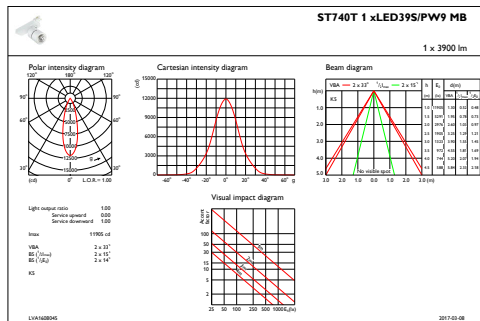

IFAS1_ST740T1xLED39SPW9MB

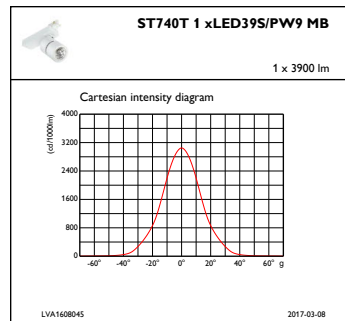

IFCC1_ST740T1xLED39SPW9MB

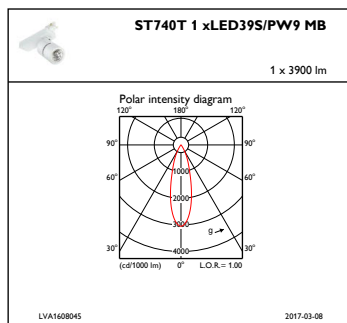

IFPC1_ST740T1xLED39SPW9MB

