



StyliD PremiumWhite

ST740T LED20S/PW930 PSU NB WH

STYLID COMPACT G3 TRACK - LED Module, system flux 2000 lm - Premium white with CRI ≥ 90 - Power supply unit, DC compatible for central emergency lighting - Narrow beam - White

If you want a high quality of light and color rendering for your store, without having to compromise on energy savings, then StyliD PremiumWhite is exactly what you are looking for. This exciting solution delivers the same sparkling light effects as CDM conventional lighting. So now you can make the switch to LED with confidence!

Product data

General Information	
Number of light sources	1 pc
Lamp family code	LED20S [LED Module, system flux 2000 lm]
Beam angle of light source	120 °
Light source color	Premium white with CRI ≥ 90
Light source replaceable	No
Number of gear units	1 unit
Driver/power unit/transformer	Power supply unit, DC compatible for central emergency lighting
Driver included	Yes
Optic type	Narrow beam
Optical cover/lens type	Clear glass
Luminaire light beam spread	10°
Connection	Push-in connector and pull relief
Cable	-
Protection class IEC	Safety class II
Glow-wire test	Temperature 650 °C, duration 30 s
Flammability mark	For mounting on normally flammable surfaces
CE mark	CE mark
ENEC mark	ENEC mark
UL mark	-
Warranty period	5 years
Glare shielding accessories	-
Remarks	*-Per Lighting Europe guidance paper "Evaluating performance of LED based luminaires - January 2018": statistically there is no relevant difference in lumen maintenance between B50 and for example B10. Therefore the median useful life (B50) value also represents the B10 value.
Constant light output	No
Number of products on MCB of 16 A type B	32
RoHS mark	RoHS mark

StyliD PremiumWhite

Product family code	ST740T [STYLID COMPACT G3 TRACK]
---------------------	-----------------------------------

Operating and Electrical

Input Voltage	220 to 240 V
Input Frequency	50 to 60 Hz
Inrush current	20 A
Inrush time	0.25 ms
Power Factor (Min)	0.9

Controls and Dimming

Dimmable	No
----------	----

Mechanical and Housing

Housing Material	Metal/Plastic
Reflector material	Polycarbonate aluminum coated
Optic material	Polycarbonate
Optical cover/lens material	Glass
Fixation material	-
Optical cover/lens finish	Clear
Overall length	258 mm
Overall width	89 mm
Overall height	179 mm

Approval and Application

Ingress protection code	IP20 [Finger-protected]
Mech. impact protection code	IK02 [0.2 J standard]

Initial Performance (IEC Compliant)

Initial luminous flux (system flux)	1900 lm
Luminous flux tolerance	+/-10%
Initial LED luminaire efficacy	73 lm/W

Init. Corr. Color Temperature	3000 K
Init. Color Rendering Index	≥90
Initial chromaticity	(0.42, 0.38) SDCM <3
Initial input power	26 W
Power consumption tolerance	+/-10%

Over Time Performance (IEC Compliant)

Control gear failure rate at median useful life 50000 h	5 %
Lumen maintenance at median useful life* 50000 h	L80

Application Conditions

Ambient temperature range	+10 to +40 °C
Performance ambient temperature Tq	25 °C
Suitable for random switching	Yes (relates to presence/ movement detection and daylight harvesting)

Product Data

Full product code	871869697296000
Order product name	ST740T LED20S/PW930 PSU NB WH
EAN/UPC - Product	8718696972960
Order code	910500459034
Numerator - Quantity Per Pack	1
Numerator - Packs per outer box	1
Material Nr. (12NC)	910500459034
Net Weight (Piece)	1.200 kg

Dimensional drawing

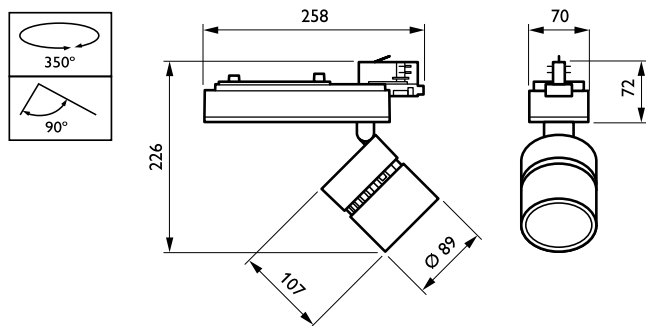

StyliD ST730C-ST750T

Photometric data

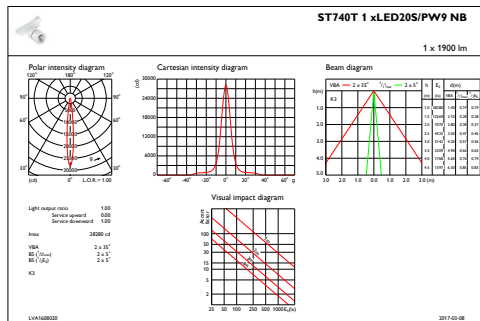

IFAS1_ST740T1xLED20SPW9NB

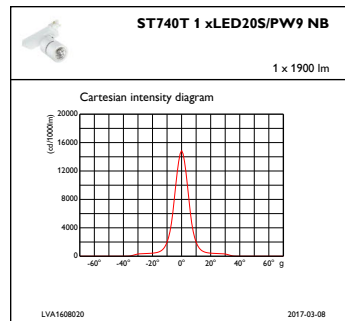

IFCC1_ST740T1xLED20SPW9NB

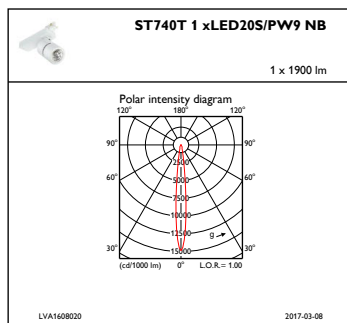

IFPC1_ST740T1xLED20SPW9NB

