



StyliD

ST740T LED49S/830 PSD-VLC MB WH

STYLID COMPACT G3 TRACK - LED Module, system flux 4900 lm - 830 warm white - Power supply unit with DALI interface, DC-compatible for central emergency lighting (integrated) - Medium beam - White

Retailers are increasingly having to contend with rising energy prices. At the same time, they need to retain the quality of light they are used to, flexibility in architectural integration, and the right light effects to catch the customer's eye. Last but not least, they need future-proof solutions that will enable them to implement differentiating concepts in their store. Delivering high-quality light, punch in the beam and outstanding luminous efficacy, StyliD is the ideal energy-efficient solution for today's demanding retail environments, covering a variety of lighting applications, with including CrispWhite for fashion stores and Food recipes for supermarkets.

Product data

General Information			
Number of light sources	1 [1 pc]	Optical cover/lens type	GC [Clear glass]
Lamp family code	LED49S [LED Module, system flux 4900 lm]	Luminaire light beam spread	30°
Beam angle of light source	120 °	Control interface	DALI
Light source color	830 warm white	Connection	PIP [Push-in connector and pull relief]
Light source replaceable	No	Cable	-
Number of gear units	1 unit	Protection class IEC	Safety class II (II)
Driver/power unit/transformer	PSED [Power supply unit with DALI interface, DC-compatible for central emergency lighting (integrated)]	Glow-wire test	650/30 [Temperature 650 °C, duration 30 s]
Driver included	Yes	Flammability mark	F [For mounting on normally flammable surfaces]
Optic type	MB [Medium beam]	CE mark	CE mark
		ENEC mark	ENEC mark
		UL mark	-

Warranty period	5 years
Glare shielding accessories	No [-]
Remarks	*-Per Lighting Europe guidance paper "Evaluating performance of LED based luminaires - January 2018": statistically there is no relevant difference in lumen maintenance between B50 and for example B10. Therefore the median useful life (B50) value also represents the B10 value.
Constant light output	No
Number of products on MCB of 16 A type B	24
RoHS mark	RoHS mark
Product family code	ST740T [STYLID COMPACT G3 TRACK]

Operating and Electrical

Input Voltage	220 to 240 V
Input Frequency	50 to 60 Hz
Control signal voltage	0-16 V DC DALI
Inrush current	5.3 A
Inrush time	0.70 ms
Power Factor (Min)	0.9

Controls and Dimming

Dimmable	Yes
----------	-----

Mechanical and Housing

Housing Material	Metal/Plastic
Reflector material	Polycarbonate aluminum coated
Optic material	Polycarbonate
Optical cover/lens material	Polymethyl methacrylate
Fixation material	-
Optical cover/lens finish	Clear
Overall length	279 mm
Overall width	89 mm
Overall height	191 mm

Approval and Application

Ingress protection code	IP20 [Finger-protected]
-------------------------	--------------------------

Mech. impact protection code	IK02 [0.2 J standard]
------------------------------	------------------------

Initial Performance (IEC Compliant)

Initial luminous flux (system flux)	4900 lm
Luminous flux tolerance	+/-10%
Initial LED luminaire efficacy	113 lm/W
Init. Corr. Color Temperature	3000 K
Init. Color Rendering Index	≥80
Initial chromaticity	(0.43, 0.40) SDCM <3
Initial input power	43.5 W
Power consumption tolerance	+/-10%

Over Time Performance (IEC Compliant)

Control gear failure rate at median useful life 50000 h	5 %
Lumen maintenance at median useful life* 50000 h	L80

Application Conditions

Ambient temperature range	+10 to +40 °C
Performance ambient temperature Tq	25 °C
Maximum dim level	1%
Suitable for random switching	Yes (relates to presence/ movement detection and daylight harvesting)

Product Data

Full product code	871869697301100
Order product name	ST740T LED49S/830 PSD-VLC MB WH
EAN/UPC - Product	8718696973011
Order code	97301100
Numerator - Quantity Per Pack	1
Numerator - Packs per outer box	1
Material Nr. (12NC)	910500459039
Net Weight (Piece)	1.200 kg

Dimensional drawing

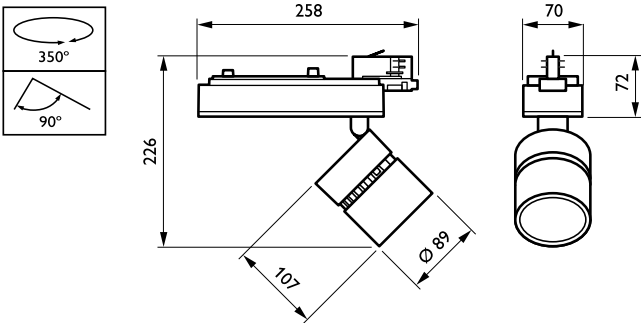

StyliD ST730C-ST750T

Photometric data

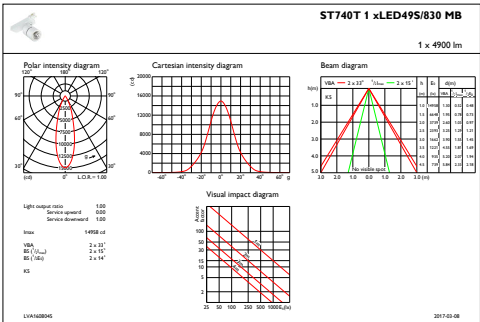

IFAS1_ST740T1xLED49S830MB

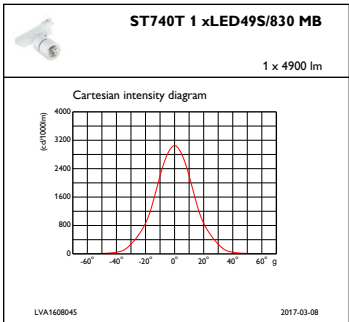

IFCC1_ST740T1xLED49S830MB

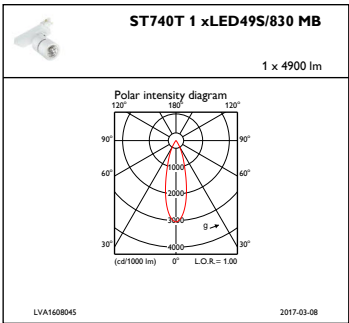

IFPC1_ST740T1xLED49S830MB

