

# WorkForce Pro WF-3720DWF

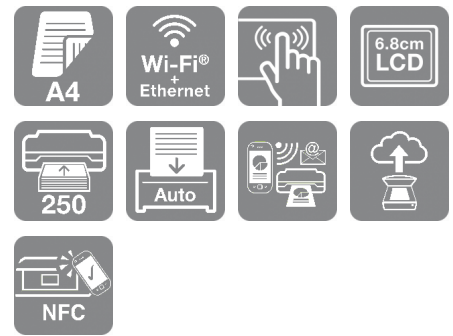

## DATASHEET / BROCHURE



## Space-saving and affordable 4-in-1 for business-quality printing with Wi-Fi, Wi-Fi Direct and fast double-sided printing

Looking for a space-saving, cost-effective, yet advanced printer? The WF-3720DWF is a great choice for home offices or small businesses. It packs in lots of features including fast double-sided printing, a high-capacity paper tray and a 6.8cm touchscreen. It's easy to use too with NFC<sup>1</sup>, Wi-Fi, Wi-Fi Direct and Epson's free mobile printing apps<sup>2</sup>.

### Style and substance

With its modern design, the compact WF-3720DWF is a great fit for the home or office. Its stylish and sleek design is complemented by a 6.8cm touchscreen.

### Business quality

Even at high speeds, this 4-in-1 printer produces top quality, laser-like prints thanks to Epson's most advanced printhead technology, PrecisionCore. The WF-3720DWF is designed for business with double-sided printing, a 35 page automatic document feeder and 250 sheet paper tray. It also supports advanced Scan-to functions including Scan-to: Email, Cloud, FTP and Network.

### Low running costs

Achieve professional, crisp and clear business documents that are water, smudge and highlighter resistant, with Epson's DURABrite Ultra Ink. Offering great value, the inks are supplied individually, so you only ever have to replace the colour used. Plus, with XL cartridges you can print up to three times more pages<sup>3</sup> - that equates to 1,100 black and 950 colour pages<sup>4</sup>.

### Print from anywhere

From your home or office, there's the option to use Wi-Fi connectivity or Wi-Fi Direct for printing from compatible wireless devices without a Wi-Fi network. You can also print via NFC with a simple tap of a compatible Android device on the printer<sup>1</sup>. And there's Epson's free mobile printing apps and solutions including Email print, which allows you to send items to print from almost anywhere in the world<sup>2</sup>.

## KEY FEATURES

- **Print, scan, copy and fax**  
4-in-1 with fast duplex printing
- **Fast business-quality printing**  
20ppm in black 10ppm in colour<sup>5</sup>
- **Connectivity**  
Wi-Fi, Wi-Fi Direct, NFC<sup>1</sup> and Ethernet
- **Front paper tray**  
250-sheet capacity
- **Epson's free mobile printing apps<sup>2</sup>**  
Freedom to print and scan anywhere<sup>2</sup>

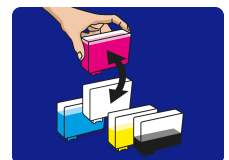

## PRODUCT SPECIFICATIONS

### TECHNOLOGY

Printing Method	PrecisionCore™ Print Head
Minimum Droplet Size	3,8 pl, With Variable-Sized Droplet Technology
Ink Technology	DURABrite™ Ultra

### PRINT

Printing Speed ISO/IEC 24734	20 pages/min Monochrome, 10 pages/min Colour
Duplex Printing Speed ISO/IEC 24734	10 A4 pages/min Monochrome, 7 A4 pages/min Colour
Maximum Printing Speed	33 pages/min Monochrome (plain paper), 20 pages/min Colour (plain paper)
Printing Resolution	4.800 x 2.400 dpi
Max Duty cycle	20.000 pages per month
	The maximum number of printed pages per month based on the performance capabilities of the printer, including ISO rated print speeds and paper handling capabilities.
Recommended Duty Cycle	200 - 800 pages per month
Colours	Black, Cyan, Yellow, Magenta

For detailed information on printing speeds please visit <http://www.epson.eu/testing>.

### SCAN

Scanning Resolution	1.200 dpi x 2.400 dpi (Horizontal x Vertical)
Output formats	BMP, JPEG, TIFF, multi-TIFF, PDF, searchable PDF, PNG
Scanner type	Contact image sensor (CIS)

### FAX

Fax speed dials (max)	100 names and numbers
Page memory	Up to 180 pages (ITU-T No.1 chart)
Fax Functions	PC Fax, Address Book, Delay Send, Broadcast Fax

### PAPER / MEDIA HANDLING

Paper Formats	A4, A5, A6, B5, C6 (Envelope), DL (Envelope), No. 10 (Envelope), Letter, 10 x 15 cm, 13 x 18 cm, 16:9, User defined, Legal, Executive, B6
Automatic Document Feeder	35 pages
Duplex	Yes (A4, plain paper)
Paper Tray Capacity	250 Sheets maximum
Number of paper trays	1

### CONNECTIVITY

Interfaces	Hi-Speed USB - compatible with USB 2.0 specification, Ethernet interface (100 Base-TX / 10 Base-T), Wireless LAN IEEE 802.11b/g/n, Wi-Fi Direct, Near Field Communication (NFC), USB host
------------	---

### GENERAL

Energy Use	15 W (standalone copying, ISO/IEC 24712 pattern), 1,2 W (sleep mode), 6,4 W (Ready), 0,3 W (Power off), ENERGY STAR® qualified
------------	--

### OTHER

Warranty	12 months Carry in
----------	--------------------

## LOGISTICS INFORMATION

SKU	C11CF24403
EAN code	8715946628943
Dimensions Single Carton	475 x 435 x 315 mm
Carton Weight	10,62 Kg
Country of Origin	Indonesia
Layer	2 Units

## WorkForce Pro WF-3720DWF

### WHAT'S IN THE BOX

- Driver and utilities (CD)
- Individual Ink Cartridges
- Main unit
- Warranty document
- Power cable
- Setup guide

### INK YIELD DATA



Golf ball 34XL



1.100 pages\*



950 pages\*

\* Approx. page yield based on ISO/IEC 24711/24712 or ISO/IEC 29102/29103. Actual yield will vary depending on images printed and usage conditions. For more information visit <http://www.epson.eu/pageyield>



1. Requires NFC and Wi-Fi Direct enabled device with Android OS 4.0 or higher. Requires download of Epson iPrint app from Google Play.
2. Epson iPrint requires a wireless connection and the Epson printing app. Epson Email print, Epson Remote Print Driver and Epson scan-to-cloud require an internet connection. For more information, supported languages and devices, please visit [www.epsonconnect.eu](http://www.epsonconnect.eu)
3. Comparison based on ISO yield of 34 and 34XL series ink cartridges. For more information on ISO yields visit [www.epson.eu/pageyield](http://www.epson.eu/pageyield)
4. Approx. page yield based on ISO/IEC 24711/24712. Actual yield will vary depending on images printed and usage conditions. For more information visit [www.epson.eu/pageyield](http://www.epson.eu/pageyield)
5. Determined in accordance with ISO/IEC 24734 showing the average of ESAT from the Office Category Test for default A4 simplex. For more information, please visit [www.epson.eu/testing](http://www.epson.eu/testing)

# EPSON®