



Color Variants

AC200191
Stainless steel and glass
Width 86 cm

Optional accessories

AA200510
Remote control for canopy extractor AC200
AA210110
1 activated charcoal filter with high efficient odour reduction due to increased surface. For air recirculation module AA 211 812.
AA211812
Patented air recirculation module including 1 activated charcoal filter with high efficient odour reduction due to increased surface

AC200191
Canopy extractor 200 series
Stainless steel and glass
Width 86 cm
Air extraction / Air recirculation

Can be integrated invisibly in upper cabinet
Energy-saving, low-noise fan
Rim extraction with flat and easy-to-clean glass underside
Dimmable, neutral white LED light for ideal illumination of the whole cooktop
Air extraction or air recirculation system
Energy efficiency class A++

Output

Performance and noise level, output level 3/Intensive:
Air output according to EN 61591.
Sound power level according to EN 60704-3.
Sound pressure level according to EN 60704-2-13.
Odour reduction for air recirculation in accordance with EN 61591.
Air extraction:
570 / 800 m³/h.
64 / 70 dB (A) re 1 pW.
51 / 57 dB (A) re 20 µPa.
Air recirculation:
540 / 790 m³/h.
72 / 77 dB (A) re 1 pW.
59 / 65 dB (A) re 20 µPa.
Odour reduction air recirculation 94 %.

Features

3 electronically controlled power levels and 1 intensive mode.
Remote control is available as a special accessory.
Interval ventilation, 6 min.
Run-on function, 6 min.
Grease filter saturation indicator.
Metal grease filter, dishwasher-safe.
Glas filter cover.
Neutral white LED light (4000 K), dimmable.
Lamp output 2 x 1 W.
Illuminance 266 lx.
Fan technology with highly efficient, brushless DC motor (BLDC).

Consumption data

Energy efficiency class A++ at a range of energy efficiency classes from A++ to E.
Energy consumption 25.5 kwh/year.
Ventilation efficiency class A.
Illumination efficiency class A.
Grease filter efficiency class D.
Sound level min. 41 dB / max. 64 dB normal mode.

Planning notes

Patented air recirculation module with activated charcoal filter can be installed in the upper cabinet. The activated carbon filter can be changed from the front by simply pulling out the filter drawer.
The door of the upper cabinet must be fully open in order to change the activated charcoal filter.
Can be integrated invisibly in upper cabinet.
Vario cooktops with intensive production of vapours like VR/VP should be placed in the middle beneath the hood (in this case air recirculation is not recommended).
Clearance above gas appliances min. 65 cm (more than total load gas 12 kW min. 70 cm).

Characteristics
Product name/family
Color chimney
Typology
Traditional
Approval certificates
CE, Eurasian, G-Mark, Ukraine, VDE
Length electrical supply cord (cm)
100
Required niche size for installation (HxWxD)
418mm x 836mm x 264mm
Height of the chimney (mm)
Height of product, without chimney (mm)
Net weight (kg)
9.788
Type of control
Electronic
Number of speed settings
Maximum output air extraction (m3/h)
570
Boost position output recirculating (m3/h)
790
Maximum output recirculating air (m3/h)
540
Boost position air extraction (m³/h)
800
Number of lights
2
Noise level (dB)
64
Diameter of air outlet (mm)
120 / 150
Grease filter material
Washable aluminium
Odour filter
No
Operating Mode
Convertible
Delay Shut off modes
6M
Required accessories
Optional accessories
AA200510, AA210110, AA211812
Type of lamps used
LED
Total power of the lamps (W)
2
Grease filter type
Kassette
Clean filter reminders

Consumption and connection features
Connection Rating (W)
172
Current (A)
3
Voltage (V)
220-240
Frequency (Hz)
50
Plug type
Gardy plug w/ earthing
Installation typology
Built-in
Universal Product Code
Material body
Stainless steel
Approval certificates
CE, Eurasian, G-Mark, Ukraine, VDE
Length of electrical supply cord (in)
Plug type
Gardy plug w/ earthing
Dimensions of the product, with chimney (if exists) (in)
/ x x
Dimensions of the packed product (in)
14.56 x 38.18 x 18.30
Height of the chimney (in)
Vertical rise height
Required distance above cooktop/ranges
Net weight (lbs)
22
Gross weight (lbs)
30
Motor location
Integrated motor in hood body

Clearance above electric appliances min. 50 cm.
When installing a ventilation hood with air extraction mode and a chimney-vented fireplace, the power supply line of the ventilation appliance needs a suitable safety switch.

Connection

Total connected load 172 W.
Connecting cable 1.0 m with plug.

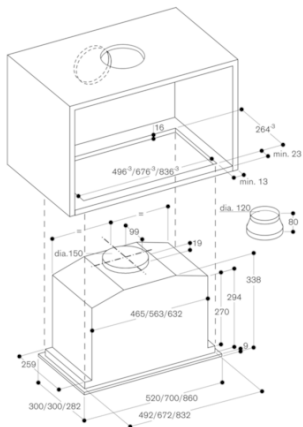

View of upper cabinet from above with AC 200 and AA 211 812

