

# Expression Home XP-3105

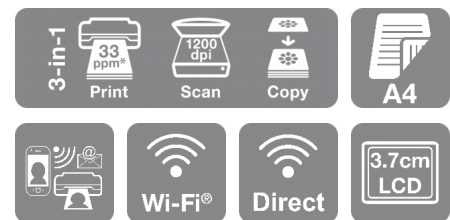

## DATASHEET



Save money, space and time with this 3-in-1 with A4 double-sided printing, individual inks, mobile printing and an LCD screen.

This stylish and affordable 3-in-1 delivers much more than just the basics from its compact footprint. Its prints are clear, vibrant and cost effective thanks to individual inks and double-sided printing. Printing away from a desktop is made easy with a range of compatible mobile printing apps and a 3.7cm LCD screen.

### Sleek and stylish 3-in-1

Don't let a printer impact your decor - our stylish and compact 3-in-1 printers are designed to integrate into the home. This affordable model efficiently uses your space combining printing, scanning and copying facilities in one unit.

### Easy to use

Keep things simple – that's the mantra behind the XP-3100. It provides a range of essential features while being incredibly easy to use. It's also flexible with Wi-Fi for printing and scanning wirelessly around the home, and Wi-Fi Direct for printing without a wireless network. Its 3.7cm LCD screen makes it easy to print without a computer and double-sided printing reduces paper usage.

### Efficient & affordable

The 603 ink series provides a low-cost yet reliable printing solution. This four-colour ink set can print an array of documents with defined text and graphics. Each colour is supplied individually, so you only replace the colours you need.

### Unleash smart devices

Print and scan from smart devices using Epson's free iPrint app<sup>1</sup>. Feeling artistic? The Epson Creative Print app can print photos directly from Facebook, create custom greeting cards and stationery, and even turn photos into colouring book templates<sup>1</sup>. Alternatively, Email Print makes it possible to print from almost anywhere in the world by simply emailing files to the printer<sup>1</sup>. You can also take advantage of Apple Airprint<sup>2</sup>.

## KEY FEATURES

- **Stylish 3-in-1 with LCD screen**  
Save money, space and time
- **Mobile printing**  
Freedom to print from almost anywhere<sup>1</sup>
- **Individual inks**  
Save money by only replacing the colour used
- **Wi-Fi & Wi-Fi Direct**  
Wireless printing with or without a network
- **A4 double-sided printing**  
Automatically print on both sides to reduce paper usage

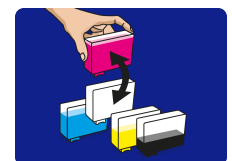

## PRODUCT SPECIFICATIONS

### TECHNOLOGY

Printing Method	Epson Micro Piezo™ print head
Minimum Droplet Size	3 pl, With Variable-Sized Droplet Technology
Ink Technology	Pigment black and Dye colour Inks
Printing Resolution	5.760 x 1.440 dpi
Nozzle Configuration	180 Nozzles black, 59 Nozzles per colour

### PRINT

Printing Speed ISO/IEC 24734	10 pages/min Monochrome, 5 pages/min Colour
Maximum Printing Speed	42 Seconds per 10 x 15 cm photo (Epson Premium Glossy Photo Paper), 33 pages/min Monochrome (plain paper), 15 pages/min Colour (plain paper)
Colours	Black, Cyan, Yellow, Magenta
For detailed information on printing speeds please visit <a href="http://www.epson.eu/testing">http://www.epson.eu/testing</a> .	

### SCAN

Scanning Resolution	1.200 dpi x 2.400 dpi (Horizontal x Vertical)
Scanner type	Contact image sensor (CIS)

### PAPER / MEDIA HANDLING

Number of paper trays	1
Paper Formats	A4, A5, A6, B5, C6 (Envelope), DL (Envelope), No. 10 (Envelope), Letter Legal, 9 x 13 cm, 10 x 15 cm, 13 x 18 cm, 13 x 20 cm, 20 x 25 cm, 100 x 148 mm, 16:9
Duplex	Yes (A4, plain paper)
Print Margin	0 mm top, 0 mm right, 0 mm bottom, 0 mm left (Wherever margin is defined. Otherwise 3mm top, left, right, bottom.)
Paper Tray Capacity	100 Sheets Standard, 20 Photo Sheets
Media Handling	Automatic duplex (A4, plain paper), Borderless print

### GENERAL

Energy Use	5 W (Ready), 0,3 W (Power off), 12 W (standalone copying, ISO/IEC 24712 pattern), 0,8 W (sleep mode)
Product dimensions	375 x 300 x 170 mm (Width x Depth x Height)
Product weight	4,3 kg
Compatible Operating Systems	Mac OS X 10.6.8 or later, Windows 10 (32/64 bit), Windows 7, Windows 8, Windows 8.1, Windows Vista, Windows XP SP3 or later (32-bit), Windows XP Professional x64 Edition SP2
Included Software	Epson Easy Photo Print, Epson Scan 2
WLAN Security	WEP 64 Bit, WEP 128 Bit, WPA PSK (TKIP), WPA PSK (AES)
Mobile & Cloud printing services	Epson Connect (iPrint, Email Print, Remote Print Driver), Apple AirPrint, Google Cloud Print
Colour	Black

### OTHER FEATURES

LCD screen	Type: Colour, Diagonal: 3,7 cm
Features	Red eye removal, Photo Enhance

### OTHER

Warranty	12 months Carry in Optional warranty extension available
----------	---

## LOGISTICS INFORMATION

SKU	C11CG32404
EAN code	8715946665269
Country of Origin	Indonesia
Layer	4 Units

Epson Deutschland GmbH  
Otto-Hahn-Str. 4  
D-40670 Meerbusch  
Info-Line: 02159 92 79 500  
Telefax: +49 (0) 2159/538-3000  
[www.epson.de](http://www.epson.de)

Epson in Österreich  
Info-Line: 01 253 49 78 333  
[www.epson.at](http://www.epson.at)  
Epson in der Schweiz  
Info-Line: 022 592 7923  
[www.epson.ch](http://www.epson.ch)

Alle Marken und eingetragenen Warenzeichen sind das Eigentum der Seiko Epson Corporation oder der jeweiligen Rechteinhaber.  
Diese Produktinformationen können ohne vorherige Ankündigung geändert werden.

## Expression Home XP-3105

### WHAT'S IN THE BOX

- Software (CD)
- Setup guide
- Power cable
- Main unit
- Individual Ink Cartridges
- Warranty document

### INK CARTRIDGE COMPATIBILITY



### INK YIELD DATA

	Starfish 603	Starfish 603XL
Black	150 pages*	500 pages*
Cyan, Magenta, Yellow	130 pages*	350 pages*

\* Approx. page yield based on ISO/IEC 24711/24712 or ISO/IEC 29102/29103. Actual yield will vary depending on images printed and usage conditions. For more information visit <http://www.epson.eu/pageyield>

1. – Epson iPrint and Epson Creative Print require a wireless connection and the Epson printing apps. Epson Email print and Epson Remote Print Driver require an internet connection. For more information, supported languages and devices, please visit [www.epsonconnect.eu](http://www.epsonconnect.eu).
2. AirPrint-enabled printers work with iPhone 4s and later, iPad 2 and later, all models of iPad Air and iPad mini, and iPod touch 5th generation with the latest version of iOS, and Mac with the latest version of OS X.

**EPSON®**