



INFOSHEET

HP Presence Aware



Automatically wake your PC when you approach it, and lock it when you leave with HP Presence Aware.

Wake and lock with your presence

This smart functionality is powered by an advanced proximity sensor that is located in the bezel of the PC. The proximity sensor detects your presence and triggers the camera and Windows Hello to confirm your identity and unlock your PC¹.

Locks automatically when you leave

Walk Away Lock allows the system to dim and/or lock when you are no longer present in front of your system.



Wakes automatically when you get back

Wake On Presence detects your presence and awakes system (seamlessly authenticate with Windows Hello)¹.

“Approximately

1 in 4

leave their computers unlocked when away from their desk².

Leaving your computer unlocked is a lot like leaving your car running with the doors unlocked.

Anyone could sit at your computer and gain access to your private information.”

Available on the
HP EliteBook x360 1030/1040 G7

How to change settings

To adjust HP Presence Aware settings in Windows 10, go to **Start**, and select **Settings > System > Power & sleep**.

Note: HP Presence Aware is supported on select HP PCs - HP EliteBook x360 1030 G7 and HP EliteBook x360 1040 G7.

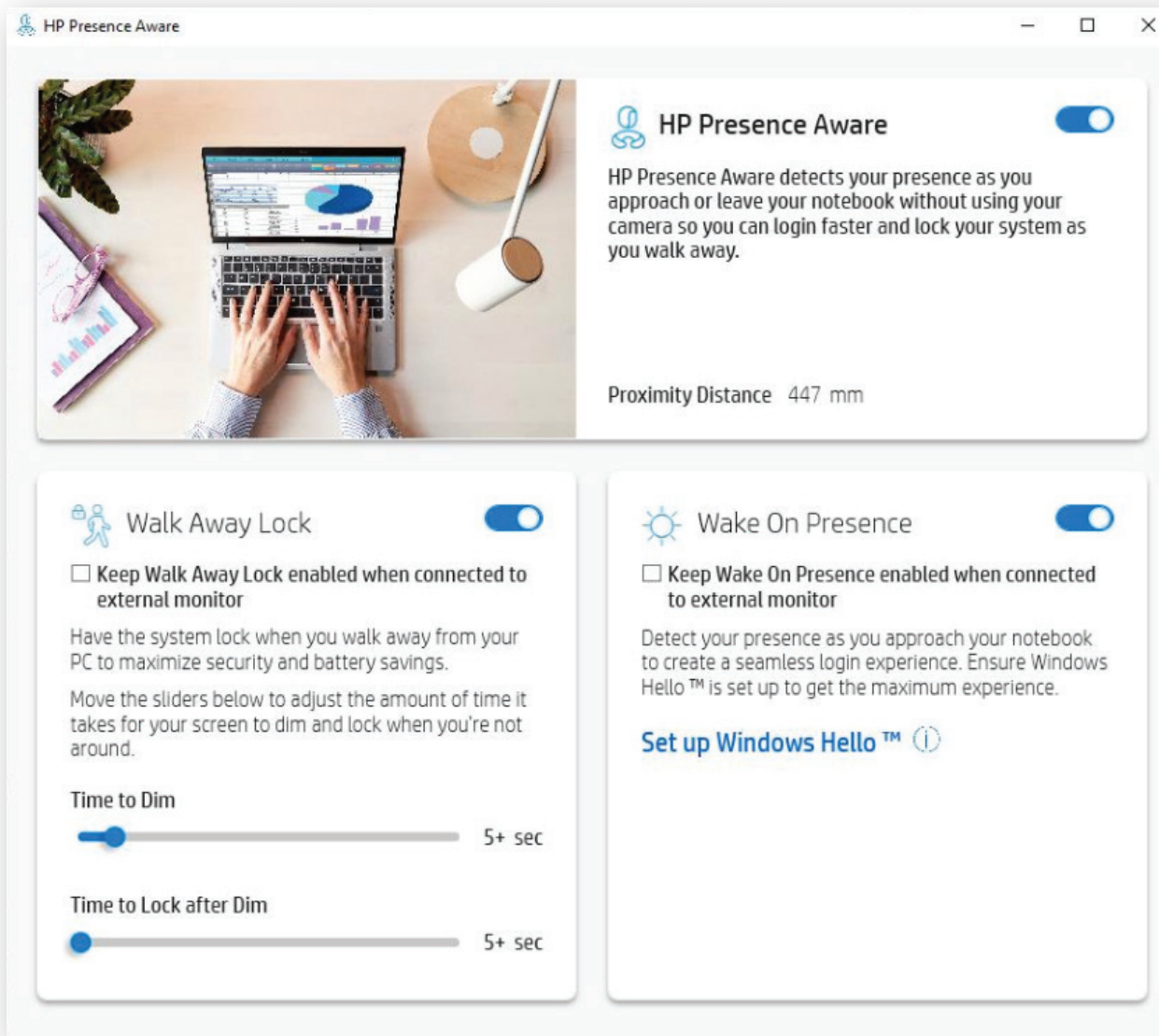

Where do you get HP Presence Aware?

The application is available on the Microsoft store for supported platforms.

In order to access HP Presence Aware please note this application is under power and sleep in PC settings.

1. Requires Windows 10 and set up of facial recognition through Windows Hello.
2. Results are based on 1,000 surveys completed by full-time office workers on behalf of the Fellowes, Inc. between March 5 and 9, 2012 by Toluna Research. Respondents were drawn from a national online panel maintained by Toluna, and completed the survey online. The margin of error is 3.1%.
<https://assets.fellowes.com/press/Fellowes%20BusinessProfessionals%20Press%20Release.pdf>

