

# Product data sheet

Specifications



Antimicrobial Flush mounted push button head, Harmony XB5, plastic, black, 30mm, spring return, unmarked

ZB5FA2

## Main

|                               |                                      |
|-------------------------------|--------------------------------------|
| Range of product              | Harmony XB5                          |
| Product or component type     | Head for non-illuminated push-button |
| Device short name             | ZB5                                  |
| Product compatibility         | ZBYF...<br>ZBZF32<br>ZBZF33<br>ZB5AZ |
| Bezel material                | Dark grey plastic                    |
| Mounting diameter             | 30.5 mm                              |
| Head type                     | Built-in-flush                       |
| Sale per indivisible quantity | 1                                    |
| Shape of signaling unit head  | Round                                |
| Type of operator              | spring return                        |
| Operator profile              | Black flush, unmarked                |

## Complementary

|                             |  |
|-----------------------------|--|
| CAD overall width           | 37 mm  |
| CAD overall height          | 37 mm  |
| CAD overall depth           | 30 mm  |
| Net weight                  | 0.03 kg  |
| Mechanical durability       | 10000000 cycles  |
| Electrical composition code | C1 for <9 contacts using single blocks in front mounting<br>C2 for <9 contacts using single and double blocks in front mounting<br>C11 for <3 contacts using single blocks in front mounting<br>C15 for <1 contacts using single blocks in front mounting<br>SF1 for <3 contacts using single blocks in front mounting |
| Device presentation         | Basic element  |

## Environment

|                                       |             |
|---------------------------------------|-------------|
| Protective treatment                  | TH          |
| Ambient air temperature for storage   | -40...70 °C |
| Ambient air temperature for operation | -40...70 °C |

|                                    |   |
|------------------------------------|---|
| Overvoltage category               | Class II conforming to IEC 60536  |
| IP degree of protection            | IP66 conforming to IEC 60529<br>IP67 conforming to IEC 60529<br>IP69 conforming to IEC 60529<br>IP69K conforming to ISO 20653<br>Type 13 conforming to UL 50 E<br>Type 12 conforming to UL 50 E<br>Type 4 conforming to UL 50 E<br>Type 4X conforming to UL 50 E    |
| Resistance to high pressure washer | 7000000 Pa at 55 °C, distance : 0.1 m   |
| IK degree of protection            | IK03 conforming to IEC 50102  |
| Standards                          | EN/IEC 60947-5-1<br>JIS C8201-5-1<br>EN/IEC 60947-5-4<br>CSA C22.2 No 14<br>UL 508<br>EN/IEC 60947-1<br>JIS C8201-1<br>ISO 21702<br>ISO 22196:2011  |
| Product certifications             | DNV<br>GL<br>CSA<br>UL listed<br>LROS (Lloyds register of shipping)<br>BV   |
| Shock resistance                   | 30 gn (duration = 18 ms) for half sine wave acceleration conforming to IEC 60068-2-27<br>50 gn (duration = 11 ms) for half sine wave acceleration conforming to IEC 60068-2-27<br>25 gn (duration = 6 ms) for 1000 shocks on each axis conforming to IEC 60068-2-27 |
| Vibration resistance               | 5 gn (f= 10...500 Hz) conforming to IEC 60068-2-6<br>2 mm peak to peak (f= 2...10 Hz) conforming to IEC 60068-2-6   |

### Packing Units

|                              |          |
|------------------------------|----------|
| Unit Type of Package 1       | PCE      |
| Number of Units in Package 1 | 1        |
| Package 1 Height             | 4.3 cm   |
| Package 1 Width              | 5.4 cm   |
| Package 1 Length             | 5.6 cm   |
| Package 1 Weight             | 24.0 g   |
| Unit Type of Package 2       | S02      |
| Number of Units in Package 2 | 80       |
| Package 2 Height             | 15.0 cm  |
| Package 2 Width              | 30.0 cm  |
| Package 2 Length             | 40.0 cm  |
| Package 2 Weight             | 2.211 kg |

### Offer Sustainability

|                            |   |
|----------------------------|---|
| Sustainable offer status   | Green Premium product   |
| REACH Regulation           | <a href="#">REACH Declaration</a>   |
| REACH free of SVHC         | Yes   |
| EU RoHS Directive          | Pro-active compliance (Product out of EU RoHS legal scope)<br><a href="#">EU RoHS Declaration</a> |
| Mercury free               | Yes   |
| RoHS exemption information | <a href="#">Yes</a>   |
| China RoHS Regulation      | <a href="#">China RoHS declaration</a>  |
| Environmental Disclosure   | <a href="#">Product Environmental Profile</a>   |

|                           |   |
|---------------------------|---|
| Circularity Profile       | <a href="#">End of Life Information</a>   |
| California proposition 65 | WARNING: This product can expose you to chemicals including: Di-isodecyl phthalate (DIDP), which is known to the State of California to cause birth defects or other reproductive harm. For more information go to <a href="http://www.P65Warnings.ca.gov">www.P65Warnings.ca.gov</a> |
| Contractual warranty      |   |
| Warranty                  | 18 months   |

Dimensions

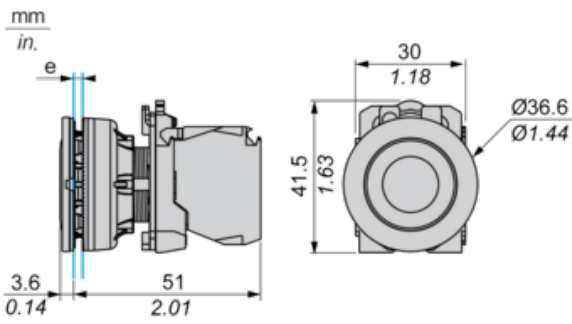

e: Clamping thickness: 1 to 6 mm / 0.04 to 0.24 in.

Panel Cut-out for Pushbuttons, Switches and Pilot Lights (Finished Holes, Ready for Installation)

Connection by Screw Clamp Terminals or Plug-in Connectors

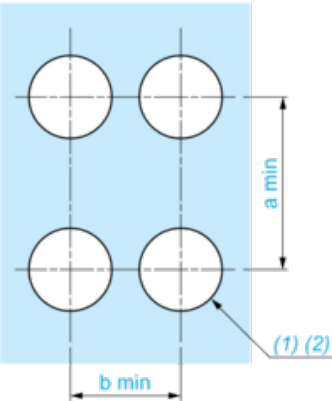

- (1) Diameter on finished panel or support
- (2) Ø30.75 mm recommended ( $\text{Ø}30.5 \begin{smallmatrix} +0.5 \\ 0 \end{smallmatrix}$ ) / Ø1.21 in. recommended ( $\text{Ø}1.20 \text{ in. } \begin{smallmatrix} +0.0196 \\ 0 \end{smallmatrix}$ )

| Connections                                   | a in mm | a in in. | b in mm | b in in. |
|---|---------|----------|---------|----------|
| By screw clamp terminals or plug-in connector | 40      | 1.57     | 40      | 1.57     |
| By Faston connectors                          | 45      | 1.77     | 40      | 1.57     |

Electrical Composition Corresponding to Code C1

---



Electrical Composition Corresponding to Code C2

---

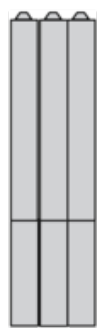

Electrical Composition Corresponding to Codes C9, C11, SF1 and SR1

---

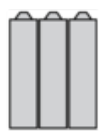

Electrical Composition Corresponding to Code C15

1 N/O

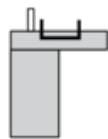

1 N/C

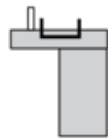

1 N/O + N/C or 1 N/O + N/O or 1 N/C + N/C

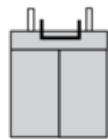

Legend

---

Single contact



Double contact



Light block



Possible location









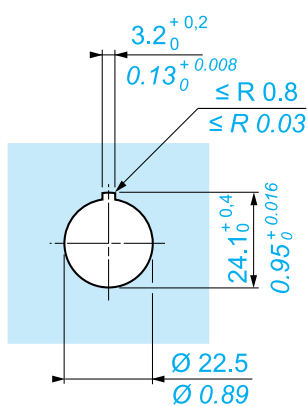
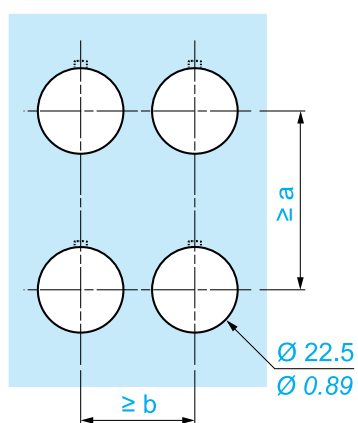
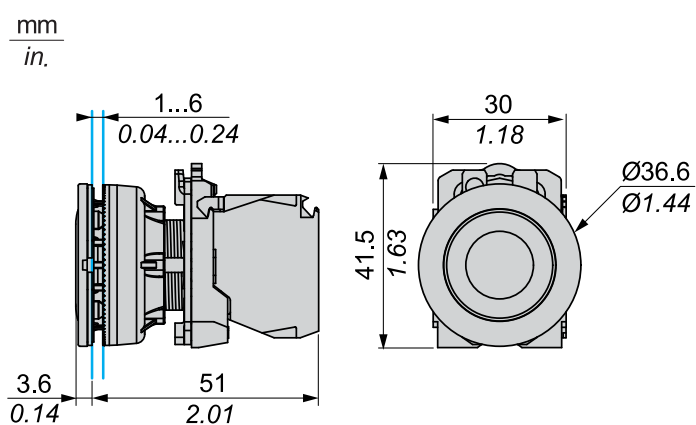

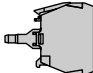

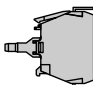
## Technical Illustration

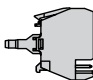
# ZB5FA2

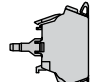
## Dimensions

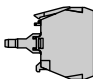

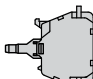
|   |   | a (mm) | a (in.) | b (mm) | b (in.) |
|---|---|--------|---------|--------|---------|
|    |    | 40     | 1.57    | 30     | 1.18    |
| ZBE●●●●●  | ZBV●●●●●  |        |         |        |         |
|   |   | 45     | 1.77    | 32     | 1.26    |
| ZBE●●●●●3   | ZBV●●●●●3   |        |         |        |         |
|  |  | 40     | 1.57    | 30     | 1.18    |
| ZBE●●●●●4   | ZBV●●●●●4   |        |         |        |         |
|  |  | 50     | 1.97    | 30     | 1.18    |
| ZBE●●●●●5   | ZBV●●●●●5   |        |         |        |         |
|  |  | 40     | 1.57    | 30     | 1.18    |
| ZBE●●●●●9   | ZBV●●●●●9   |        |         |        |         |
|  |  | 40     | 1.57    | 30     | 1.18    |
| ZBRT●   | ZBRV1   |        |         |        |         |

**Recommended replacement(s)**