

## Series 7 Managed Network Switch

SIL 73204MP  
SIL 73208MP  
SIL 73416MP  
SIL 73024MP

### Industrial Gigabit PoE+ Managed Switches

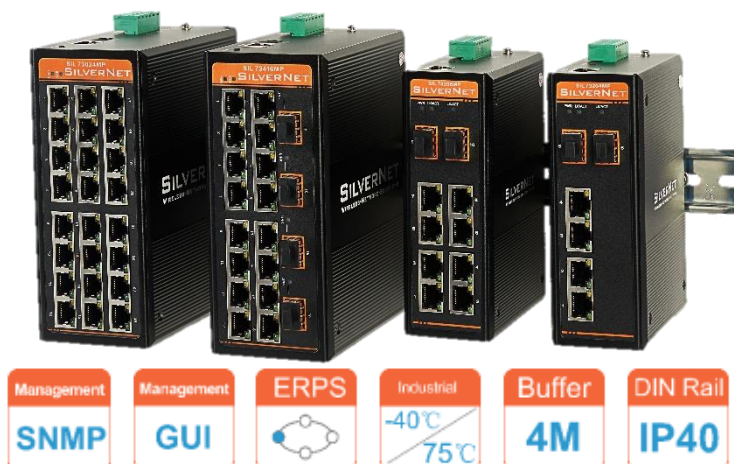

#### OVERVIEW

SilverNet Industrial Gigabit PoE+ Managed Switches are a range of fully managed layer 2 Switches, offering an ideal solution for deployment in harsh environments thanks to their rugged industrial design.

Choose from one of four different configurations; 4 or 8 x 10/100/1000Base-T ports with 2 x 1000Base-FX SFP slots, 16 x 10/100/1000Base-T ports with 4 x 1000Base-FX SFP slots, or 24 x 10/100/1000Base-T ports.

These Switches have a number of intelligent features, including a dual input design, no fan, low power consumption, overcurrent protection, and high reliability.

The SilverNet Industrial Gigabit PoE+ Managed Switches offer a versatile solution for extending Ethernet over distance through fibre daisy chain. This negates the need for separate power supplies for IP video cameras and wireless access points. These Switches also have an extended temperature range, allowing them to operate effectively in outdoor cabinets and harsh industrial environments.

In compliance with the IEEE802.3af/at standard, Power-over-Ethernet delivery over twisted pair cables is possible.

The switches also include fibre optics ports with a modular SFP slot that supports any type of MSA-compliant pluggable 1.25Gbps SFP transceiver.

#### Features

- 4, 8, 16 or 24 x 10/100/1000Base-T
- 2 or 4 x 1000Base-FX SFP slots
- 20Gbps or 56Gbps bandwidth
- IEEE803.af/at compliant
- RJ45 supports auto MDI/MDI-X function
- Auto negotiation speed, half/full duplex
- Store and forward
- Max packet size: 10K bytes
- MAC address size: 8K
- Wide range power design (9~56VDC)
- Operating temperature (-40°C ~+75°C)
- Resettable fuse to protect against overcurrent
- Reverse Polarity Protection
- DIN Rail or wall mountable
- EFT protection for power line
- Ethernet ESD protection
- IP40 Protection
- Rugged

Copyright © SilverNet Limited. All rights reserved. All other company and product names may be trademarks of their respective companies. Whilst every effort is made to make sure the information shown is accurate, SilverNet Limited can not accept liability for any errors that may arise. No freedom to use information, patents, trademarks or other intellectual property rights is implied by the publication of this document. E&OE. SilverNet Limited reserve the right to change specifications and other information within this document without notice and your attention is brought to the fact that performance figures are under ideal conditions. Actual performance will depend on many environmental factors and it is recommended that a site survey is undertaken prior to installation. Please also note that this equipment may also be subject to local legislative restrictions. It is the end users responsibility to ensure that the installation complies with any such restrictions that are in force.



Distributed By:

# Technical Specifications

Part No.	SIL 73204MP	SIL 73208MP	SIL 73416MP	SIL 73024MP
Ports				
Total number of ports	6 ports	10 ports	20 ports	24 ports
Gigabit Ethernet	4 ports	8 ports	16 ports	24 ports
Gigabit Fibre	2 SFP		4 SFP	N/A
Number of PoE ports	4 ports	8 ports	16 ports	16 ports (Ports 1-16)
Max output per port	30W			
Performance				
Switch Bandwidth	20Gbps		56Gbps	
MAC address size	8K			
Processing type	Store and Forward			
Time delay	<10µs			
Jumbo Frames	10K bytes			
Packet buffer space	4Mbit			
Power				
Power input	9~56VDC, Redundant (2 Inputs Available)			
Power consumption	<10W (Excluding PoE)		<15W (Excluding PoE)	
Standards				
Standards	G.8032 (ERPS) IEEE.802.3, IEEE802.3u, IEEE802.3z, IEEE802.3x, IEEE802.3ad, IEEE802.1p, IEEE802.1x, IEEE802.3ab, IEEE802.1Q, IGMP snooping			
EMC	UKCA BS EN 55032:2015/A11:2020 UKCA BS EN IEC 61000-3-2:2019+A1:2023 UKCA BS EN 61000-3-3:2013/A2:2023 UKCA BS EN 55035:2017/A11:2020			
EMI	FCC Part 15 Class A			
EMS	IEC 61000-4-2 (ESD): Level 4 (8K/15K) IEC 61000-4-3 (RS): Level 3 (10V/m) IEC 61000-4-4 (EFT): Level 3 (1V/2V) IEC 61000-4-5 (surge): Level 3 (4KV/2KV) IEC 61000-4-6 (RF coupling): (10V/m) IEC61000-4-8 (Power Frequency Magnetic Field):Level 4 (30A/m)			
LVD	UKCA BS EN IEC 62368-1:2020+A11:2020			
ROHS	UKCA BS IEC 62321-1:2013, IEC 62321-3-1:2013 UKCA BS IEC 62321-4:2013+AMD1:2017, IEC 62321-5:2013 UKCA BS IEC 62321-6:2015, IEC 62321-7-1:2015 UKCA BS IEC 62321-7-2:2017, IEC 62321-8:2017			
Shock	IEC 60068-2-27			
Freefall	IEC 60068-2-32 0.5m			
Vibration	IEC 60068-2-6			
Physical				
Dimensions and weight	Dimensions Approx. 120 x 90 x 40mm Weight: 0.6kg	Dimensions Approx. 120 x 90 x 40mm Weight: 0.65kg	Dimensions Approx. 160 x 140 x 75mm Weight: 1.1kg	Dimensions Approx. 160 x 140 x 70mm Weight: 1.15kg
Enclosure	IP40 Protection, Aluminium Alloy			
Mounting	DIN Rail, Wall mountable			
Environment				
Operating Temperature	-40~+75°C (Storage -40~+85°C)			
Humidity	5-90% (non-condensing)			

## Standard Features

### STANDARD FEATURES

#### Physical Ports

RJ45 with Auto MDI/MDI-X and Auto-negotiation  
SFP 100/1000Base-X

#### SIL 73204MP

4-port 10/100/1000Base-T with PoE+ and 2-ports SFP (fibre) 100/1000Base-X

#### SIL 73208MP

8-port 10/100/1000Base-T with PoE+ Plus 2-ports SFP (fibre) 100/1000Base-X

#### SIL 73416MP

16-port 10/100/1000Base-T with PoE+ and 4-ports SFP (fibre) 100/1000Base-X

#### SIL 73024MP

24-port 10/100/1000Base-T with ports 1 to 16 operating on PoE+

#### Power over Ethernet

Complies with IEEE 802.3af / IEEE 802.3at Power over Ethernet (minimum 48-56VDC input required)  
IEEE 802.3af / 802.3at / devices powered  
Supports PoE power up to 30.8 Watts for each PoE port  
Auto detect powered device (PD)  
Circuit protection helps reduce power interference between ports  
Remote power feeding up to 100m  
PoE Management features  
IEEE 802.3af and IEEE 802.3at mode switch control  
Total PoE power budget control  
Per port PoE function enable/disable  
PoE Admin mode control  
PoE Port Power feeding priority  
Per PoE port power limit  
PD classification detection  
Temperature threshold control  
PoE Usage threshold control  
PD Alive check/reboot  
PoE schedule

#### Rugged Design

IP40 Aluminium metal case protection  
DIN-rail and wall mount design  
48V DC, redundant power with polarity reverse protect function  
Supports EFT protection 4K for power line  
Supports 4K Ethernet ESD protection  
-40°C~+75°C operating temperature

#### Security

IP-Based Access Control List (ACL)  
MAC-Based Access Control List  
Source MAC / IP address binding  
DHCP Snooping to filter untrusted DHCP messages

#### Layer 2 Features

Prevents packet loss with back pressure (Half-Duplex) and IEEE 802.3x pause frame flow control (Full-Duplex)  
Store and Forward architecture and runt/CRC filtering  
Storm control support  
Broadcast / Multicast / Unicast  
Supports VLAN  
IEEE 802.1Q Tagged VLAN  
Up to 255 VLANs groups, out of 4094 VLAN IDs  
Provider Bridging (VLAN Q-in-Q) support (IEEE 802.1ad)  
Supports Spanning Tree Protocol  
STP, IEEE 802.1D Spanning Tree Protocol  
RSTP, IEEE 802.1w Rapid Spanning Tree Protocol  
MSTP, IEEE 802.1s Multiple Spanning Tree Protocol, spanning tree by VLAN  
BPDU Guard  
Supports Link Aggregation  
802.3ad Link Aggregation Control Protocol (LACP)  
Provides Port Mirror (1-to-1)  
Port mirroring to monitor the incoming or outgoing traffic on a particular port  
Loop protection to reduce the possibility of broadcast loops

#### Quality of Service

Ingress shaper and egress rate limit per port bandwidth control  
8 priority queues on all switch ports  
Traffic classification  
IEEE 802.1p CoS  
Typical network application  
Strict priority and Weighted Round Robin (WRR) CoS policies  
Supports QoS and In/Out bandwidth control on each port

#### Multicast

Supports IGMP snooping v1, v2 and v3  
Supports MLD snooping v1 and v2  
Querier mode support  
IGMP snooping port filtering

#### Management

Switch Management Interfaces  
Console / Telnet Command Line Interface  
Web switch management  
SNMP v1 and v2c switch management  
Built-in Trivial File Transfer Protocol (TFTP) client  
Firmware upload / download via HTTP / TFTP  
NTP (Network Time Protocol)  
Reset button for system reboot or reset to factory default

# Dimension Diagrams

## SIL 73204MP & SIL 73208MP

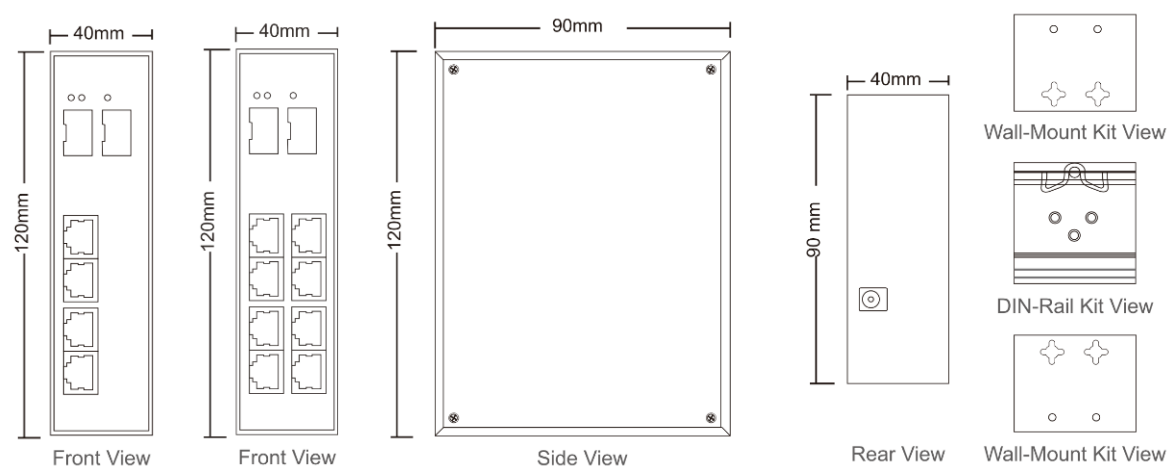

## SIL 73416MP & SIL 73024MP

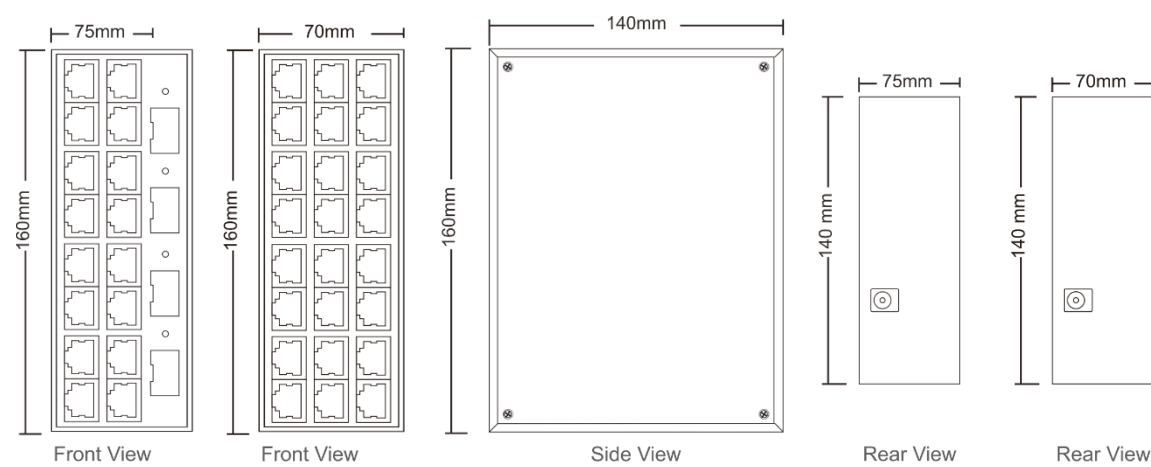

## Typical Applications

### Connection Applications

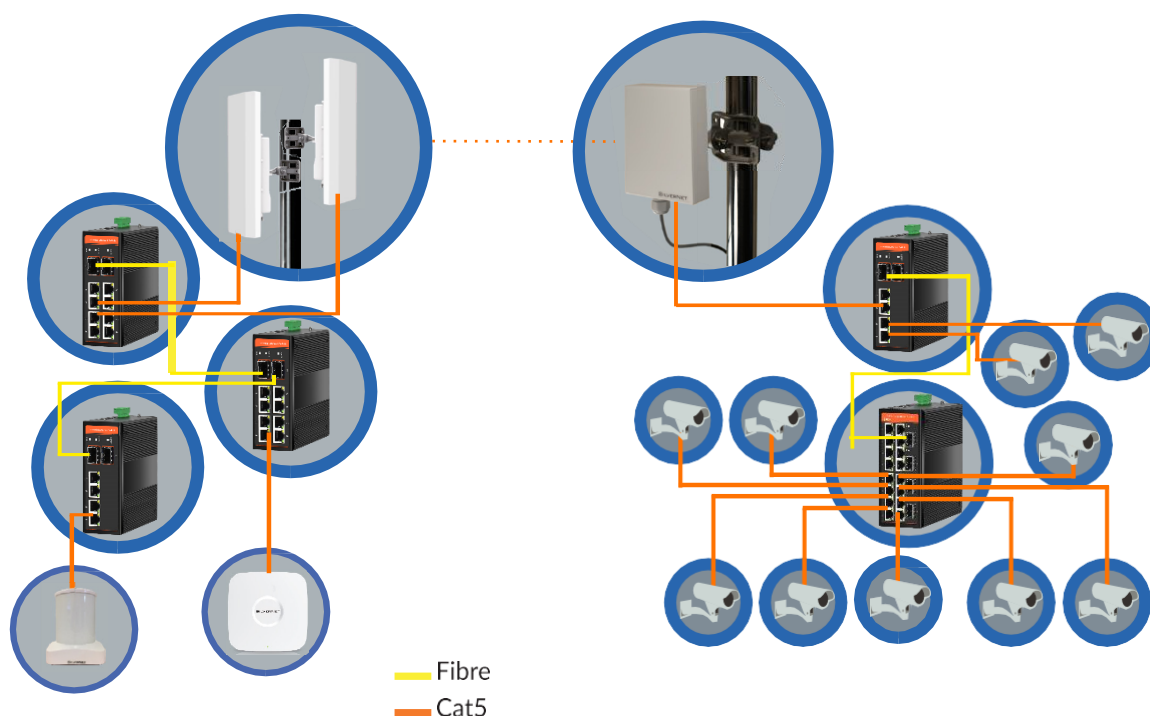

### Redundant Ring

Fast Recovery for Critical Network Applications

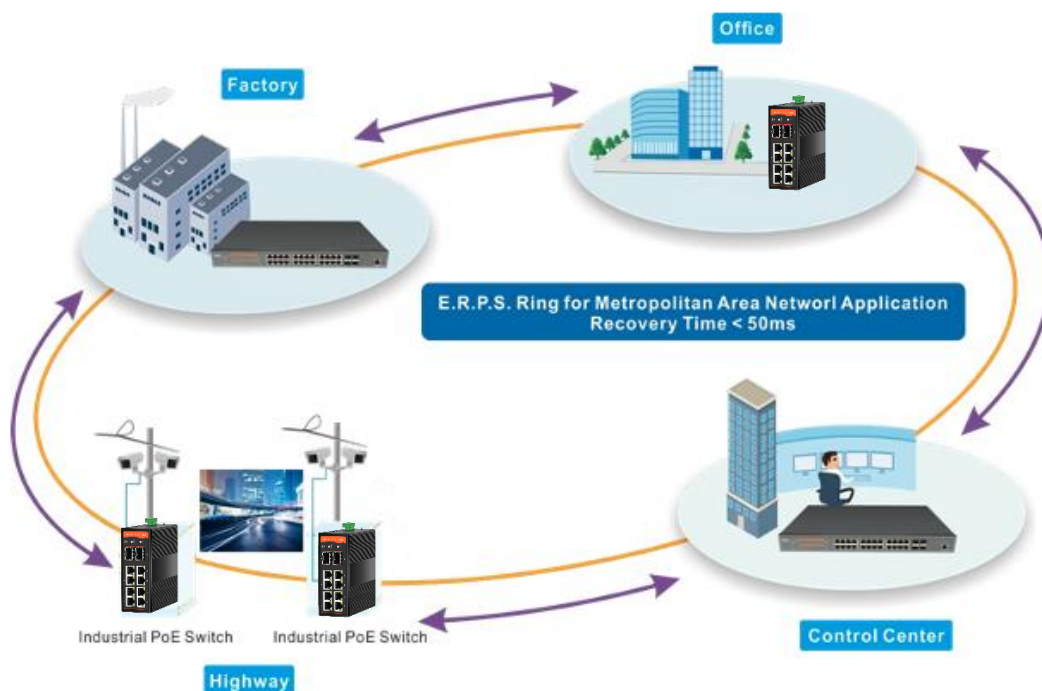

# Part Numbers & Accessories

## Managed Fibre Switches

Part Code	Description
SIL 73204MP	10/100/1000M 2Gx4GE POE+, two SFP slot, Excluding Power Supply
SIL 73208MP	10/100/1000M 2Gx8GE POE+, two SFP slot, Excluding Power Supply
SIL 73416MP	10/100/1000M 4Gx16GE POE+, four SFP slot, Excluding Power Supply
SIL 73024MP	10/100/1000M 24GE, 16 ports POE+, Excluding Power Supply

## Power Supplies

Part Code	Description
SIL NDR-120-48 (48V 2.5A)	120W 48V 2.5A Industrial Din Rail Power Supply
SIL NDR-240-48 (48V 5A)	240W 48V 5A Industrial Din Rail Power Supply
SIL NDR-480-48 (48V 10A)	480W 48V 10A Industrial Din Rail Power Supply

## 1Gbps Fibre Transmission

Part Code	Description
SIL-SFP0-01-25-X850-0-5D	1G Multimode 850nm SFP, 550m
SIL-SFP0-01-25-X131-10XD	1G Singlemode 1310nm SFP, 10km
SIL-SFP0-01-25-X131-40XD	1G Singlemode 1310nm SFP, 40km
SIL-SFP0-01-25-X155-80XD	1G Singlemode 1550nm SFP, 80km
1Gbps BiDi	
SIL-SFP0-01-25-B131-10XD	1G SM 1310nm TX FP 10km with DDM, 1550nm RX
SIL-SFP0-01-25-B155-10XD	1G SM 1550nm TX FP 10km with DDM, 1310nm RX
SIL-SFP0-01-25-B139-10XD	1G SM 1310nm TX FP 10km with DDM, 1490nm RX
SIL-SFP0-01-25-B149-10XD	1G SM 1490nm TX FP 10km with DDM, 1310nm RX
SIL-SFP0-01-25-B131-40XD	1G SM 1310nm TX DFB 40km with DDM, 1550nm RX
SIL-SFP0-01-25-B155-40XD	1G SM 1550nm TX DFB 40km with DDM, 1310nm RX
SFP to Ethernet	
SIL-SFP0-01-25-XXXT-0-1	1G RJ45 Copper SFP, 100m