

Make the most of WiFi 6 speed.

MX4200



WiFi 6 whole home
mesh tri-band system

Model#

MX4200v2

MX8400 (2-pack), MX12600 (3-pack)

40+ devices

Capacity per node



AX4200

up to 4.2 Gbps



1 node covers homes with up to

3 bedrooms

More devices than ever before.

MX4200

Model #s
 MX4200v2
 MX8400v2 (2-pack)
 MX12600v2 (3-pack)



Industry-leading technology .

An advanced Qualcomm™ chipset delivers the ultimate WiFi 6 experience. This next-gen technology evolves home and business WiFi with wire-like stability and beyond-fast performance.

Qualcomm
 immersive home
 216 platform

Wi-Fi 6

Powerful WiFi 6 Mesh Coverage.

Linksys' Intelligent Mesh™ technology, combined with WiFi 6, is designed to deliver gigabit WiFi speeds everywhere in your home, including the backyard and outdoor smart home devices.

Supports even the biggest WiFi users.

With 3.5x the capacity of WiFi 5, WiFi 6 provides enough bandwidth for as many as 40 devices.

Eliminates interference.

BSS Colouring technology eliminates interference from nearby WiFi networks, for a strong, clear signal to all your devices.

USB and Ethernet ports offer versatile connectivity.

With four Gigabit-Ethernet ports and a USB 3.0 port, you can easily connect shared storage devices and more.

A WiFi mesh network in minutes.

Intuitive easy setup with the Linksys App.

3 year warranty and customer support 24/7.

Three years of Free Technical Support. Talk to Linksys support staff whenever you need them, online or by phone

Works with all Internet Providers.

Retail packaging.



At a glance.

- Enjoy 3.5X faster speeds with WiFi 6 technology delivering up to 4.2 Gbps with 8-stream connectivity.*
- WiFi 6 delivers even more range than WiFi 5.
- Intelligent Mesh™ technology delivers gigabit WiFi speeds throughout your home.
- 1.4 GHz quad-core processor for smooth video calls, streaming, and gaming
- Modular system can be scaled with your growing WiFi needs.
- Parental controls to protect your kids online.
- Works with Apple HomeKit
- 3-Year Limited Product Warranty.

The Linksys **AX4200** WiFi 6 Whole Home Mesh Tri-Band System delivers next-level streaming and gaming to more than 40 devices on your network.

With easy set up, advanced security and parental controls, the Linksys **AX4200** WiFi 6 Whole Home Mesh Tri-Band System is an essential upgrade to any home.

Sending and receiving multiple streams of data simultaneously, WiFi 6 (AX) has 3,5x the capacity of WiFi 5 (AC) technology. The Linksys **AX4200** WiFi 6 Whole Home Mesh Tri-Band System can handle as many as 40 devices, so laptops, televisions, smart-home systems and more can all operate simultaneously with ease.

BSS Colouring technology minimises congestion by eliminating interference from nearby wireless networks delivering a strong, clear wireless signal throughout your home.

As with any Linksys Intelligent mesh™ WiFi system, increasing your coverage is as simple as adding any other Intelligent mesh™ WiFi node or router.

Product details.

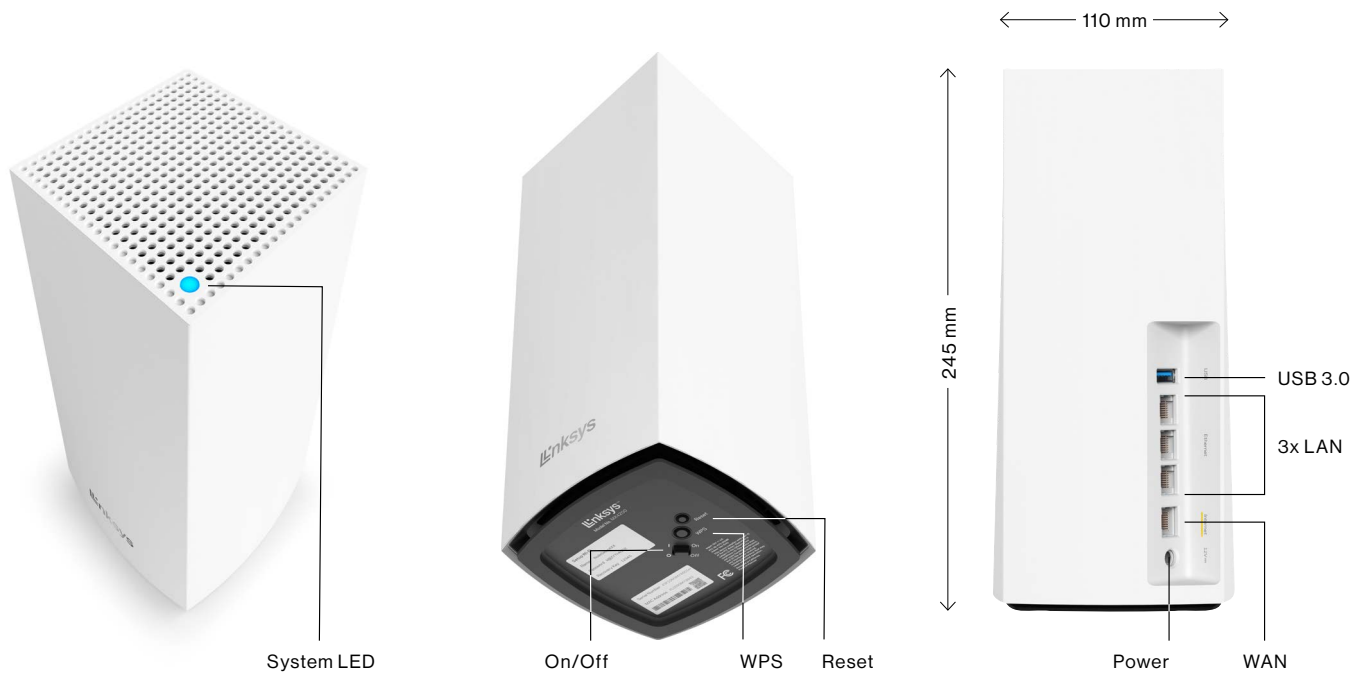

Easy App-led setup.

Setting up a WiFi 6 Whole Home Mesh Tri-Band System is easy. Download and install the free Linksys app on any iOS or Android smartphone. When you launch the app, it automatically identifies the device to be set up and provides an animated setup guide that will have you online in minutes. With the Linksys App, you can always monitor and manage your home WiFi from anywhere, using a smartphone or tablet.

1. Download and install the free Linksys app.
2. Connect one MX4200 node to your modem (-router), plug in & switch on.
3. Open the app and follow the on-screen instructions.

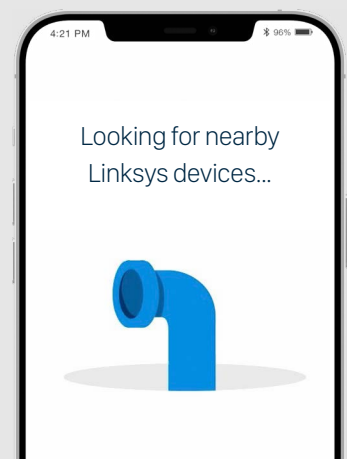
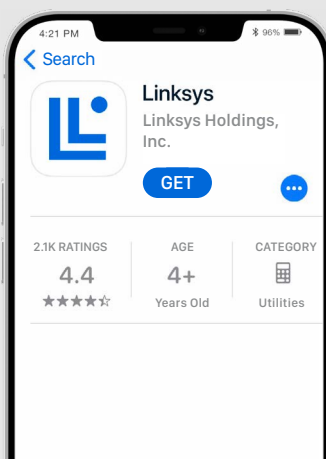

Linksys™

Intelligent Mesh™



Model #s
MX4200v2
MX8400v2 (2-pack)
MX12600v2 (3-pack)

MX4200 WiFi 6 whole home mesh tri-band system

The Linksys **MX4200** tri-band intelligent mesh™ system's easy-to-add-on modular system of nodes all work together to give you flawless and seamless WiFi everywhere and easily replaces a standard router with Mesh WiFi.

As your home and family expands, easily add more nodes to expand your network.



Each MX4200 WiFi 6 AX4200 Tri-Band node adds up to 3 rooms** or 1 floor**, at speeds up to 4.2 Gbps*.

One MX4200 node covers homes with up to 3 bedrooms**.



Two MX4200 nodes cover homes with up to 6 bedrooms**.



Three MX4200 nodes cover homes with up to 9 bedrooms**.





Easily control your home WiFi.

Linksys App at a glance.

- View which devices are connected, and easily limit internet usage with Parental Controls.
- Assign bandwidth hierarchy with Device Prioritisation.
- Keep your WiFi secure with Automatic Firmware updates.
- Give guests access and share their password via text message.

Control your WiFi in real time, wherever you are.

The Linksys app is the command center for your WiFi. Use the Linksys app anywhere you have an internet connection to check connected devices, set up guest access, or keep your kids off the internet when they should be doing homework.

Parental control.

Create device schedules, block certain websites or pause WiFi for homework.

Guest access.

Easily share a guest network with visitors. Your main WiFi stays separated by a firewall

Device prioritisation.

Prioritise streaming devices while your kids surf or play games.

Auto firmware update.

Keep your WiFi safe and secure with Automatic Firmware updates.

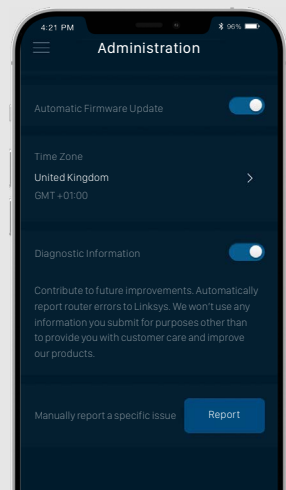
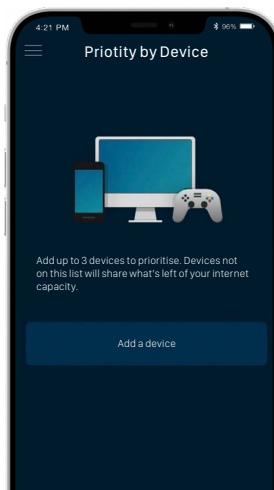
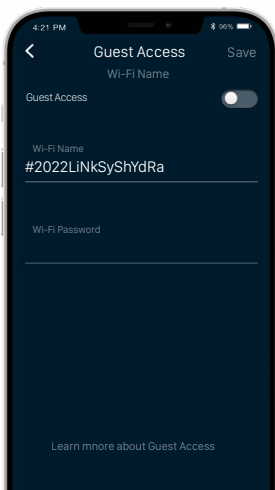
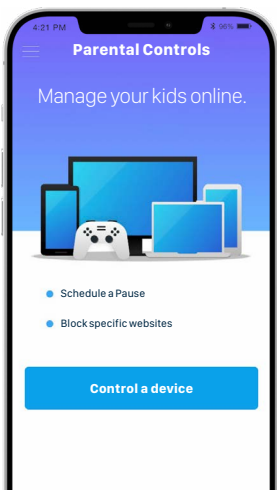

Specifications.

Dimensions.

Package Includes

- Tri-Band WiFi 6 node + power adapter(s), 1-pack (MX4200) 2-pack (MX8400), 3-pack (MX12600).
- Ethernet Cable.
- Quick Start Guide, Regulatory and Warranty Documentation.

WiFi Specifications

WiFi AX4200* with 8-stream WiFi, 4x4 MU-MIMO and 1024-QAM.

Radio 1 – 2.4 GHz Band
 802.11ax - 574 Mbps*
 Radio 2 – 5 GHz Band
 802.11ax - 1,201 Mbps*
 Radio 3 – 5 GHz Band
 802.11ax - 2,402 Mbps*

Simultaneous Tri-Band
 IEEE 802.11 b/g/n – 2.4 Ghz – 1024 QAM support.
 IEEE 802.11 b/n/ac/ax – 5 Ghz – 1024 QAM support.
 Tri-Band Dynamic Backhaul OFDMA Technology
 Downlink and uplink MU-MIMO supported
 Advanced Beamforming+ technology
 Seamless roaming technology.

Required for set-up

- 1 Internet connection with a modem or modem-router.
- 2 Mobile devices with Android 4.4 or iOS 9 and higher, with data connection.

Processor and Memory

AX optimised
 1.4 GHz Quad-Core.
 512 MB Flash and 1GB DDR4 SDRAM.

Bluetooth®

4.0/LE for secure and easy App-based Setup.

Security

WPA2 personal encryption,
 WPA2 / WPA3 Mixed Mode.

Wired Connectivity

4 Gigabit Ethernet ports (1x WAN, 3x LAN)
 1x USB 3.0 port for SMB file sharing, FTP and UPNP/DLNA media streaming.

Radio Operating Frequencies

2.4 GHz 2,400-2,483.5 MHz
 5 GHz 5,150-5,250 MHz,
 5,250-5,350 MHz,
 5,470-5,725 MHz
 Bluetooth 2,400-2,483.5 MHz

WiFi Antennas: 2x Di-Pole antennas + 4x Monopole antennas (and high powered amplifiers) for expanded coverage.

Antenna Gain WiFi

2,400-2,483.5 MHz 2.45 dBi
 5,150-5,250 MHz 4.00 dBi
 5,250-5,350 MHz 4.07 dBi
 5,470-5,725 MHz 5.2 dBi

Antenna Gain Bluetooth

..... 5.3 dBi

Output Power (EIRP) WiFi

2,400-2,483.5 MHz 19.48 dBm
 Beamforming 19.98 dBm
 5,150-5,250 MHz 21.98 dBm
 Beamforming 22.49 dBm
 5,150-5,250 MHz 22.07 dBm
 Beamforming 22.62 dBm
 5,470-5,725 MHz 28.98 dBm
 Beamforming 29.59 dBm

Power adapter

Input 100-240 V - 50-60 Hz, 1.0A
 Output 12 V, 3 A

Temperature

– Operating 0 to 40° C
 – Storage -20 to 60° C

Humidity (non-condensing)

– Operating 5 to 90% RH
 – Storage 10 to 80% RH

Product:

Weight 0.95 kg
 Width 11 cm
 Height 25.9 cm
 Depth 11 cm

Packaged Unit

Weight 1.41 kg
 Width 31.04 cm
 Height 25.08 cm
 Depth 13.49 cm

Case Pack

Quantity (*PL) 2 per pack
 Weight (*PL) 3.49 kg
 Width (*PL) 33.2 cm
 Height (*PL) 28.9 cm
 Depth (*PL) 29.1 cm

Manufacturer Linksys USA, Inc
 Brand Linksys
 Model Number MX4200v2/ MX8400v2/ MX12600v2
 Description WiFi 6 Tri-Band Mesh Router Node(s), 1-, 2-, 3-pack

Linksys UK Limited
 Amsterdam Branch, Herikerbergweg
 106, 1101 CM, Amsterdam Z.O.
 The Netherlands

Linksys UK Ltd.
 Regent Park, Booth Drive,
 Park Farm South, Wellingborough,
 Northants, NN8 6GR, United Kingdom

Part Number	Tarif code	UPC	EAN	Plug type
MX4200-UK		745883809950	4260184670734	
MX4200-ME	8517620000	745883809943	4260184670444	Euro (CEE 7/16) + British (BS1363)
MX4200-EU		745883809912	4260184670413	
MX8400-UK		745883810031	4260184670741	
MX8400-ME	8517620000	745883810024	4260184670482	Euro (CEE 7/16) + British (BS1363)
MX8400-EU		745883810017	4260184670475	
MX12600-UK		745883821235	4260184672073	
MX12600-ME	8517620000	745883819973	4260184672004	Euro (CEE 7/16) + British (BS1363)
MX12600-EU		745883821228	4260184672035	

© 2022 Linksys Holdings, Inc. and/or its affiliates. All rights reserved. Made in Vietnam.

© 2022 Linksys Holdings, Inc. and/or its affiliates. All rights reserved. Linksys, Intelligent Mesh and many product names and logos are trademarks of Linksys Holdings Inc. and/or its affiliates. Third-party trademarks mentioned are the property of their respective owners. App Store is a service mark of Apple Inc. Google Play is a trademark of Google Inc. Bluetooth® is a registered trademark owned by Bluetooth SIG Inc. and its use by Linksys is under license. Wi-Fi and Wi-Fi Protected Setup are either trademarks or registered trademarks of the Wi-Fi Alliance. The Wi-Fi CERTIFIED Logo is a certification mark of the Wi-Fi Alliance. Specifications are subject to change without notice. Maximum performance derived from IEEE Standard 802.11 specifications.

* Actual performance may vary, including lower wireless network capacity, data throughput rate, range, and coverage. Range specifications are based on performance test results under normal use case conditions. Actual data throughput and range depend upon many factors, conditions and variables, including building materials and construction, volume of network traffic, mix of wireless products used, interference, wireless obstructions and other adverse conditions. Actual data throughput will be lower than specified and may depend on mix of wireless products used, your wireless device's WiFi standard, and external factors. Wireless coverage claims are used only as reference and are not guaranteed, as each wireless network is unique.

User Documentation is also available at: www.linksys.com/support

