

MTB1

MONITOR ARM

User Manual

Overview

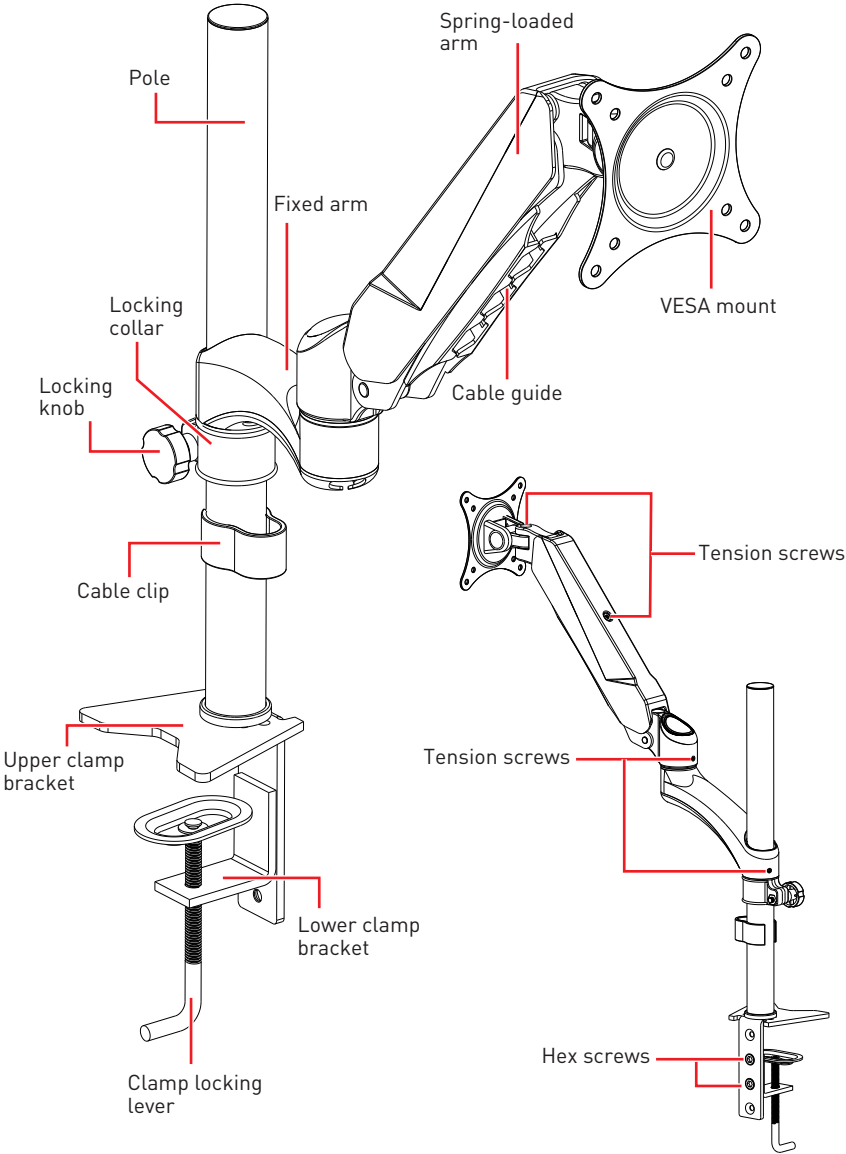

Specifications

Monitor display size	15" ~ 27"
Maximum load capacity	8 kg (17.6 lb.)
VESA standards	75x75, 100x100
Tilt	-90° / +85°
Swivel	180°
Roll	360°
Maximum arm extension	560 mm (22 in.)

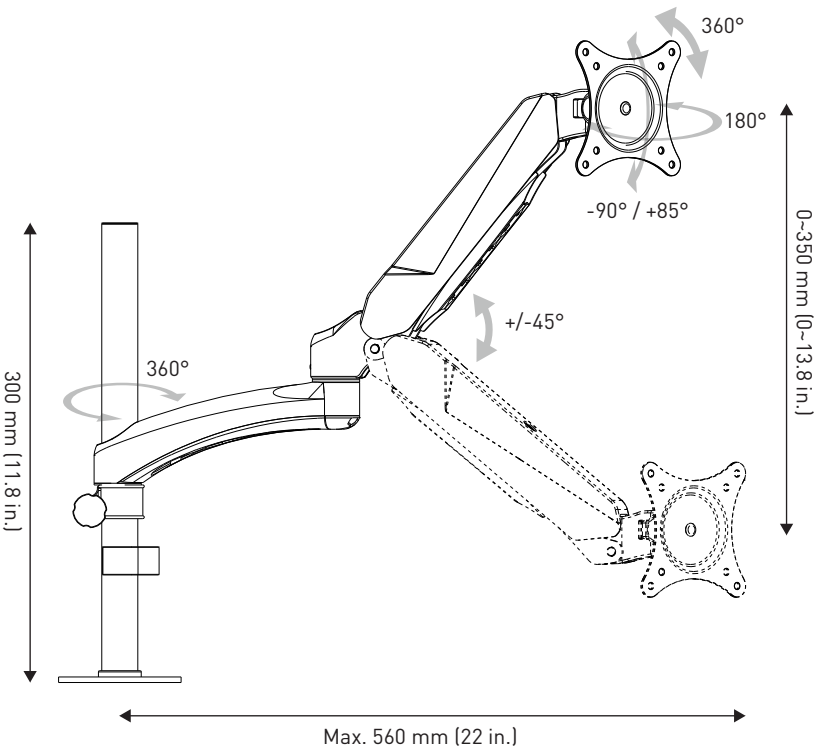

Safety Warnings



WARNING

- Before installing this product, you must read and fully understand the installation instructions. Otherwise, it may cause personal injury, property loss or factory warranty failure.
- The table clamp can support a maximum thickness of 7cm. Confirm the desktop edge before installation.
- Pay attention to the installation weight. Exceeding this limit will result in function unavailability, even serious personal injury and property loss.

Package contents

Please check the contents of your monitor arm package. It should contain:

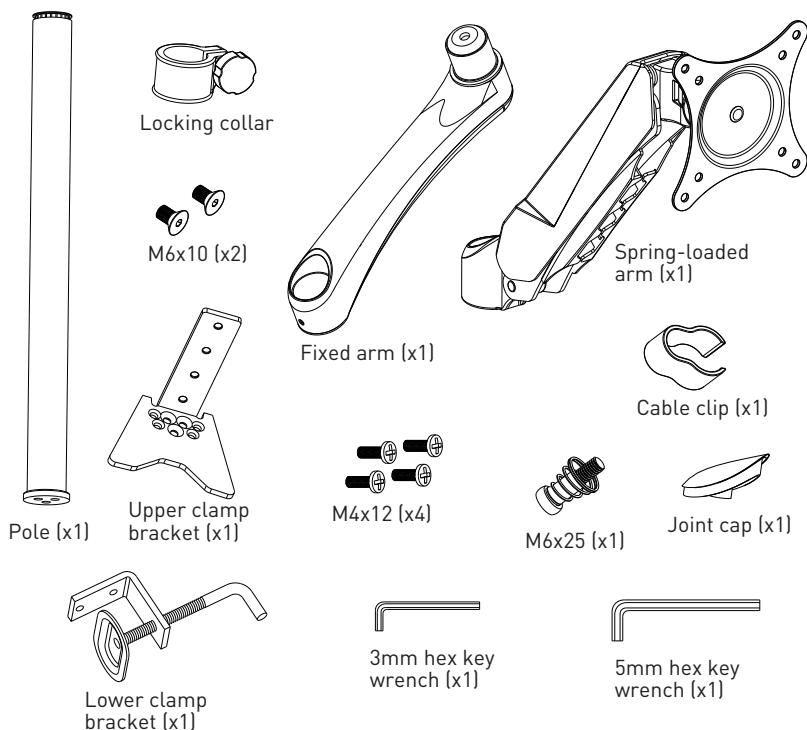

Important

If the parts are missing or damaged, do not operate the monitor arm, please contact your retailer.

Attaching the Pole

1. Use a Phillips screwdriver to remove 3 screws from the bottom of the pole.

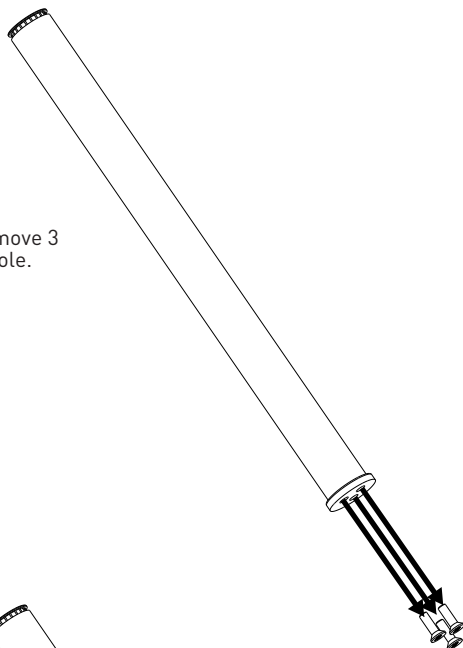

2. Align the upper clamp bracket with the bottom of the pole and secure it with 3 screws .

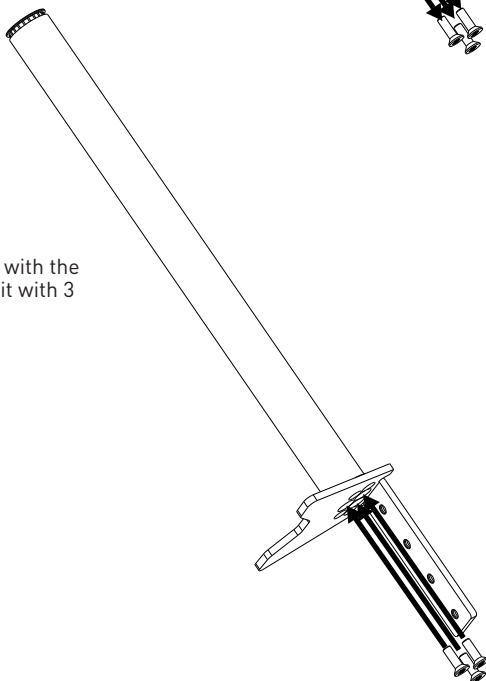

3. Align the holes in the clamp brackets according to the thickness of the edge of the desktop. Attach the lower clamp bracket and use the included hex key wrenches to screw it with 2 included M6x10 screws.

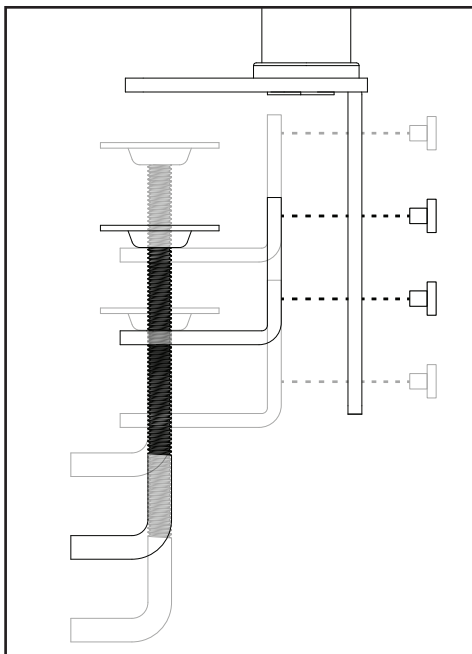

4. Loosen the clamp locking lever and fit the clamp over the edge of the desk.
5. Place the clamp at a 90 degree angle to the edge of the desktop.
6. Tighten the clamp locking lever with a tool to securely mount the pole.

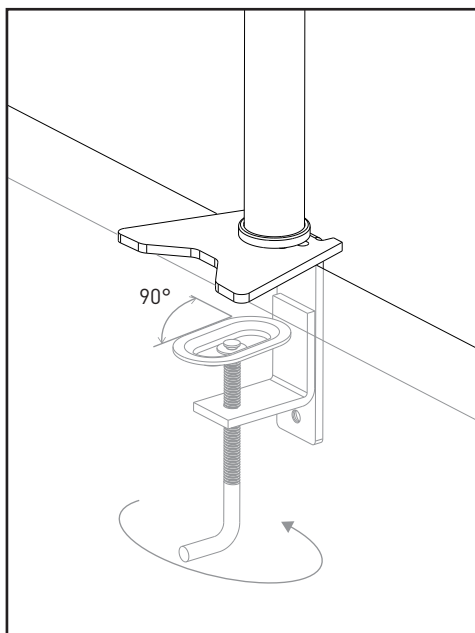

Attaching the Fixed Arm

1. Slide the locking collar onto the pole. Adjust the locking collar to the height as needed, and then tighten the knob to lock it in place.

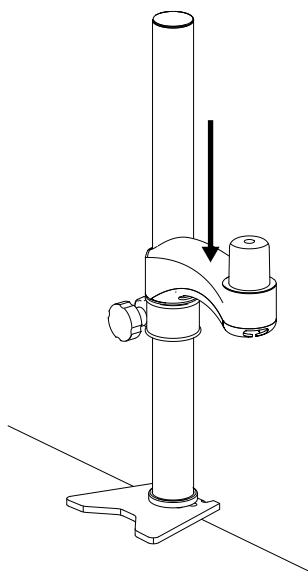
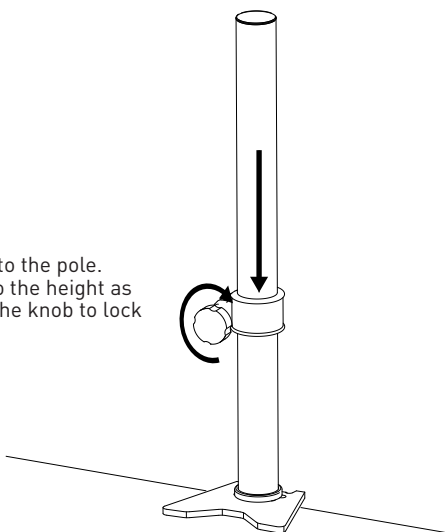

2. Slide the fixed arm onto the pole.

Attaching the Monitor to the VESA Mount



IMPORTANT

Place the monitor on a soft, protected surface to avoid scratching the display panel.

1. Align the mounting holes in the VESA mount with the corresponding mounting holes in the monitor.
2. Use a Phillips screwdriver to tighten them with 4 included M4x12 screws.

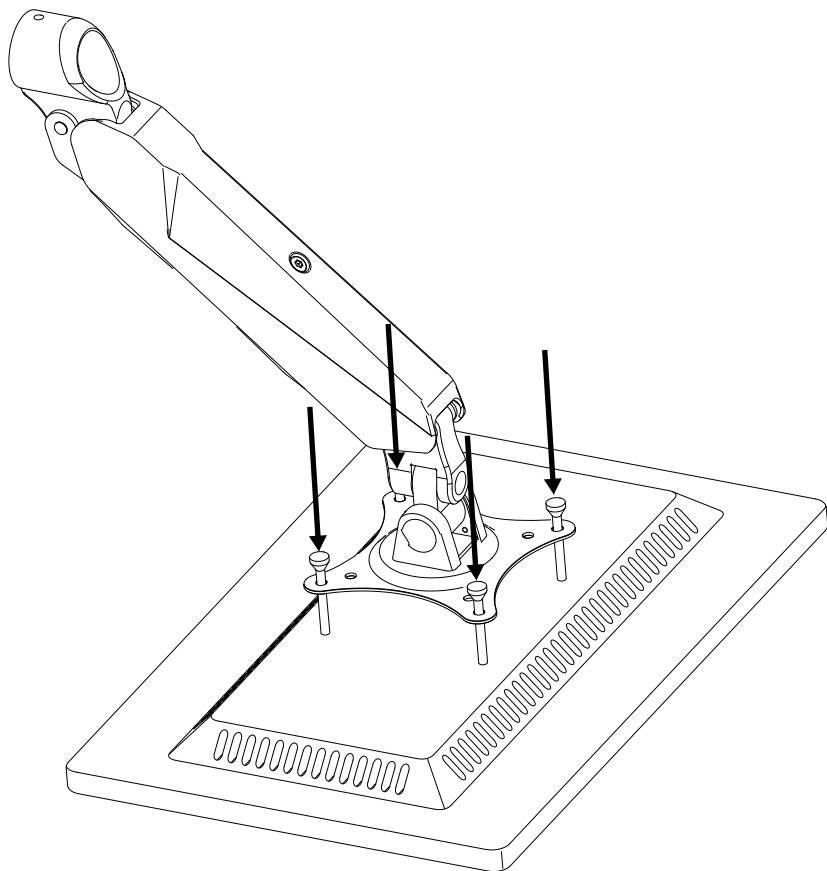

Attaching the Spring-Loaded Arm

1. Slide the spring-loaded arm onto the fixed arm.

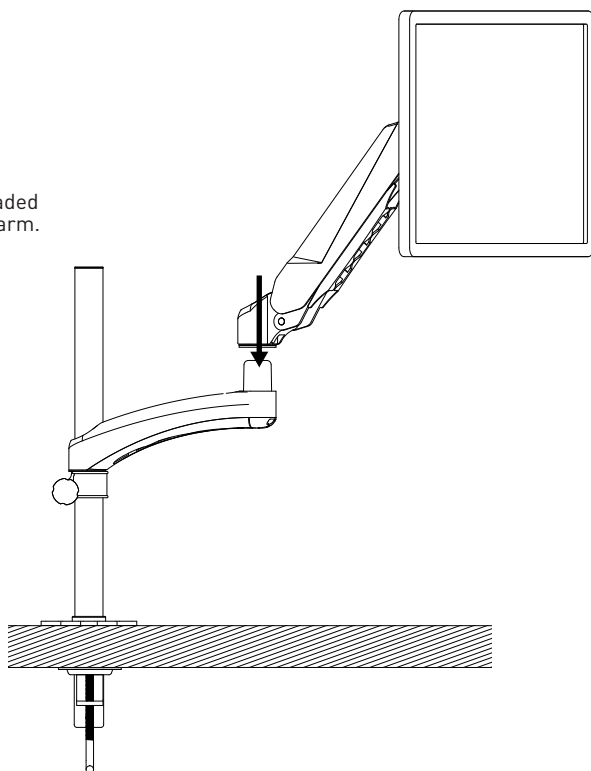

2. Insert the included M6x25 screw through the bottom of the joint.
3. Insert the included joint cap onto the screw.
4. Use a Phillips screwdriver to tighten the screw.

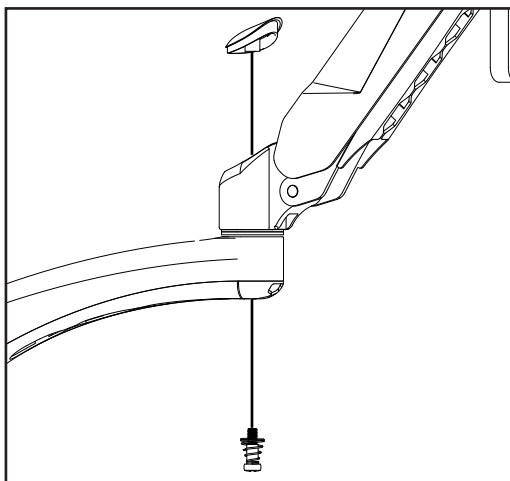

Adjusting the Tension

Adjust the monitor's position and orientation as desired. Use the included hex key wrenches to adjust the tension screw as shown to hold the monitor in position.

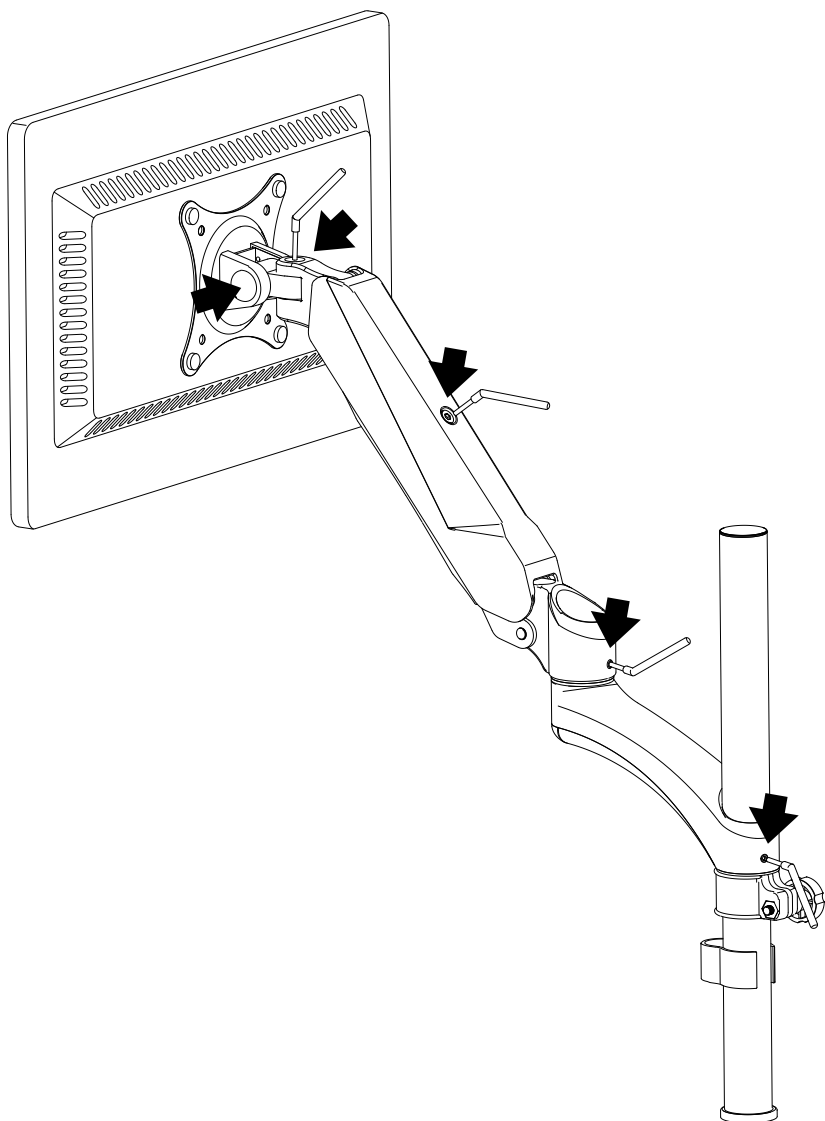

Organizing the Cables

1. Insert monitor cables into the cable guide on the underside of the arms.
2. Clip cables on the pole.

