

# WORK & MOVE Desk

Installation guide

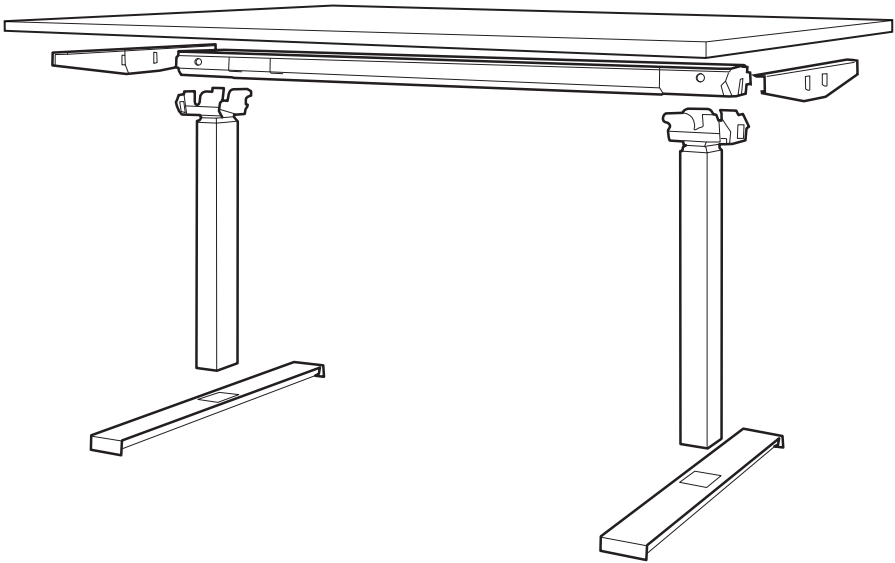

[www.bakkerelkhuisen.com](http://www.bakkerelkhuisen.com)

# 1.

Parts:

**A.** Cantilever (2x)

**B.** Columns (2x)

**C.** Beam

**D.** Feet (2x)

**E.** Manual controller

**F.** WORK & MOVE  
connector

**G.** Power cable

**H.** Tabletop

**I.** Leveling feet (8x)

**J.** Screws:

- 22x Mounting screws (20 + 2 extra)

- 2x Mounting screws for the manual controller

- 3x Cable clamps

- 8x M6 screws for

mounting the  
feet on columns.

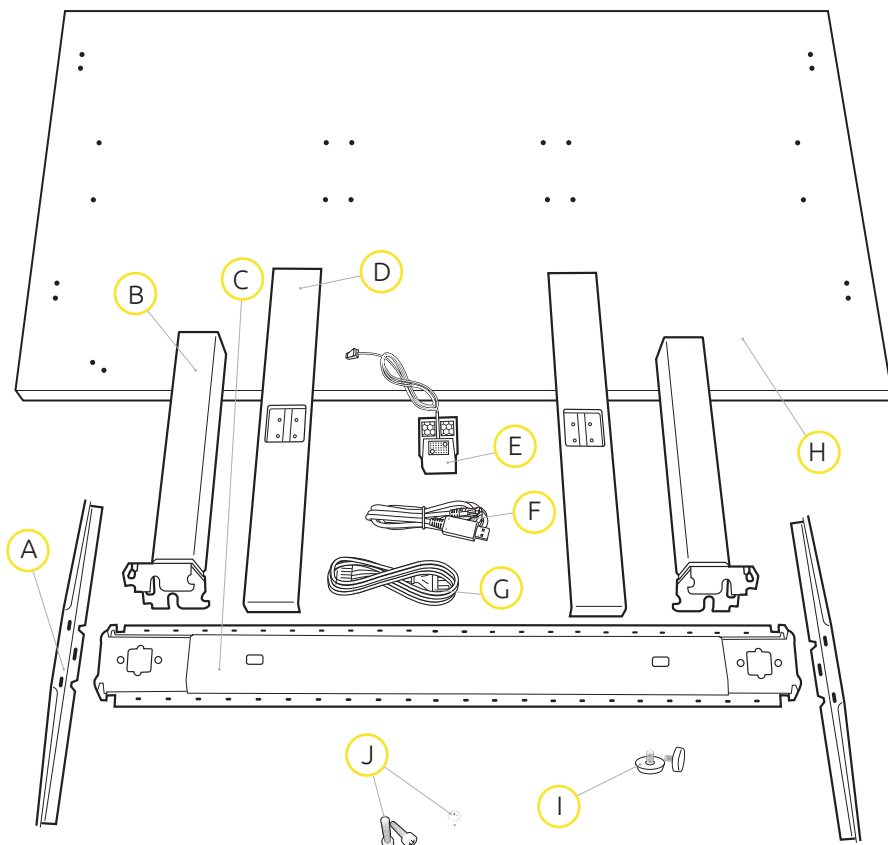

2.

Turn tabletop upside down with the drill holes facing up.

3.

Extend beam to required length  
(width 1150 to 1750 mm), adjustable in 50 mm steps.

Make sure, when placing the beam on the tabletop, that the RJ45 socket is on the same side as the drill holes for the desk controller.

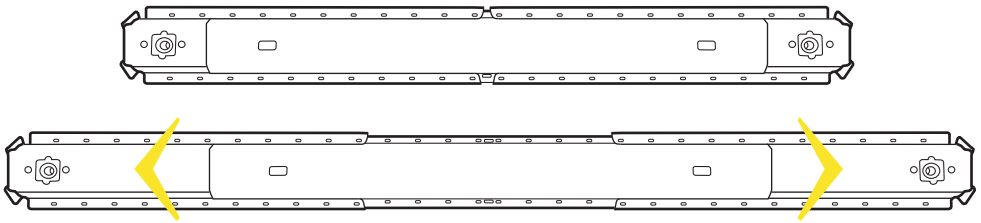

! The beam must **not** be pulled completely apart  
to make sure the drive shaft is not pulled apart.

Minimum adjustment in the connection end is 100 mm  
(to keep power and RJ45 (data cable) sockets accessible),  
otherwise adjustable in 50 mm steps.

## 4.

### 4.1

Place a cantilever slightly tilted at end of beam.

### 4.2

Press cantilever into place until a click is heard and pawls lock cantilever in correct position.

### 4.3

Mount cantilever on the end of both sides of the beam.

! *Make sure that the cantilevers are placed correctly and cannot be twisted off the beam.*

! *Do not extract the beam using the cantilevers as handles.*

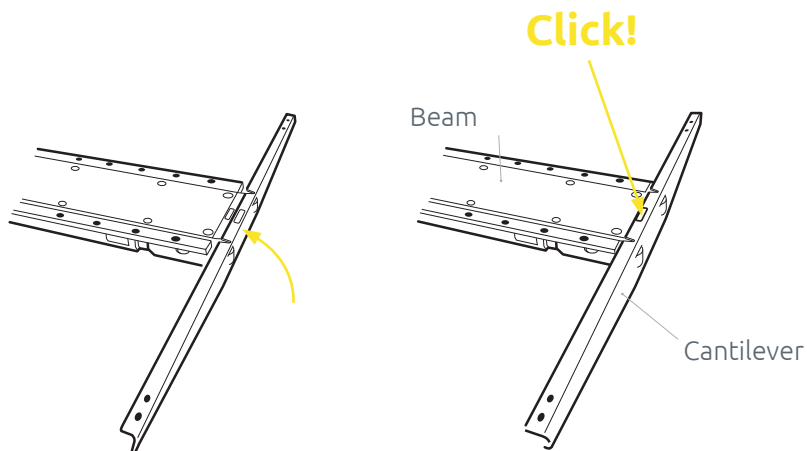

## 5.

Place assembled frame in correct position.

Make sure that the drill holes match the holes in the beam & cantilevers.

## 6.

Fasten frame to tabletop using 20 mounting screws as follows (lining up with drill holes):

- A. 8 screws at ends of beam. Use one of these to fix mains cable to beam with cable clamp creating a cable relief, see step 9.
- B. 4 screws at extension points.
- C. 8 screws in cantilevers.

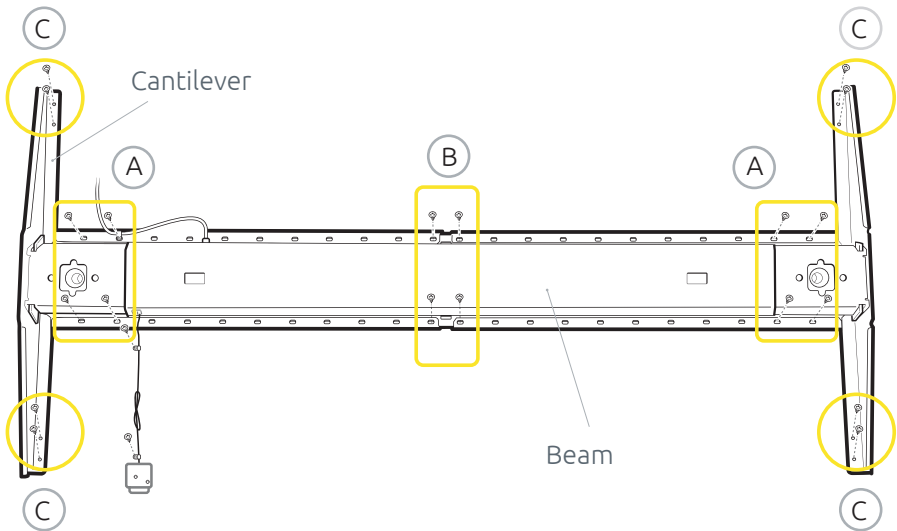

## 7.

Mount columns.

### 7.1

Ensure columns are completely retracted.

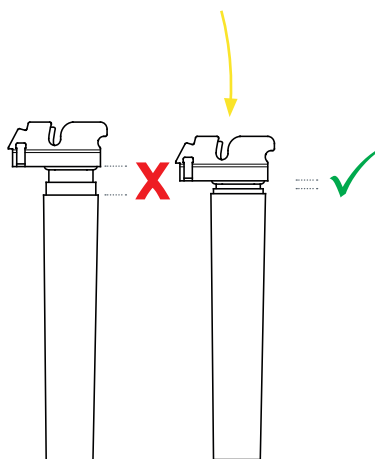

! If the column extracts when turned upside down, press by hand to completely retracted position.

### 7.2

Tilt columns and place correctly on beam using guiding notches.

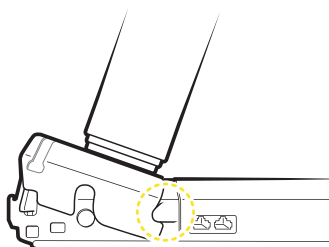

### 7.3

Fix column to beam by pressing down until a “click” is heard and **both** pawls lock column in correct position.

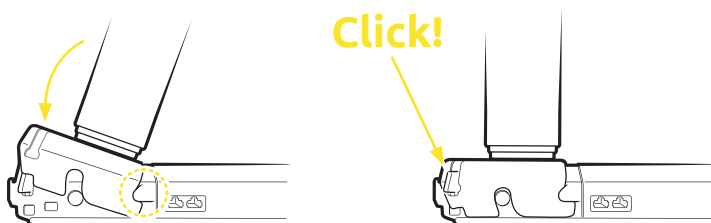

! Check that both pawls are visible after mounting of the columns. Otherwise, remove column and try again.

## 8.

Mount manual controller or the WORK & MOVE cable.

! *Ensure that only one manual controller is connected to the beam at the same time.\**

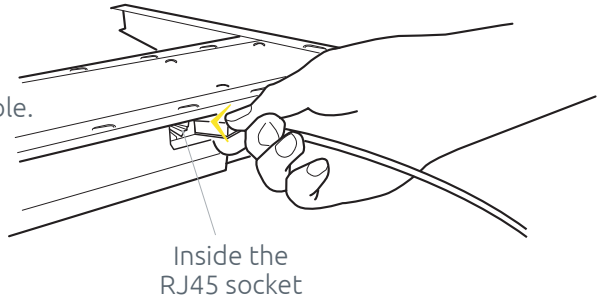

*\* If this is connected you can put the black WORK & MOVE cable into the RJ45 socket so you can operate the table with the WORK & MOVE software that's installed on your laptop. If you don't want to use the WORK & MOVE software, you still can use the Linak manual controller to alternate between sitting and standing.*

## 9.

Connect power cable.

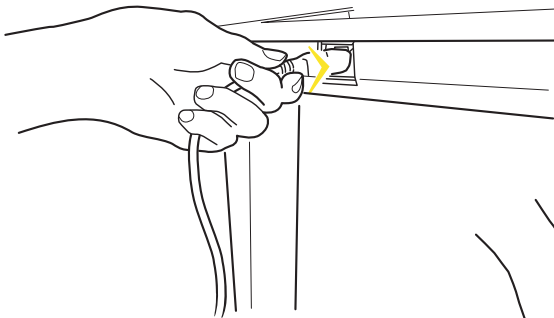

! *Ensure to make a cable relief using the cable clamp when fastening the cable to the tabletop.*

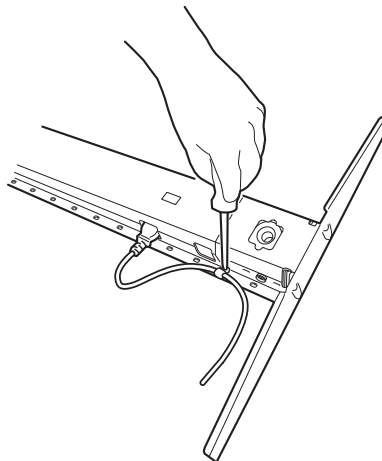

# 10.

Mount feet.

## 10.1

Mount feet on columns using eight M6 mounting screws.

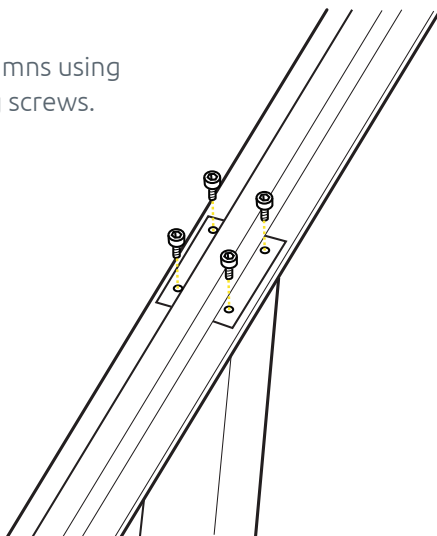



## 10.2

Mount leveling feet.

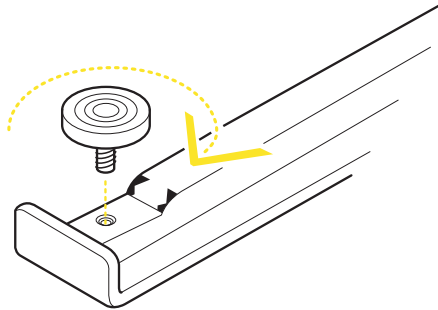

## 11.

Turn the WORK and MOVE desk around on his feet and make sure that it's level. If necessary, level out the table with the adjustment leveling feet screws (see 10.2).

## 12.

Connect the WORK & MOVE desk to the power outlet and check that both the manual and WORK & MOVE controllers are working.

**Your desk is now ready for use.**

**!** *If you want to use the desk with the WORK & MOVE cable you will need to install the software on your laptop.*

# Disassembly

- ! For disassembling the beam, use a WORK & MOVE Desk frame disassembly tool (ordering code BNELINWMDT).

The disassembly tool has ridges on one side.

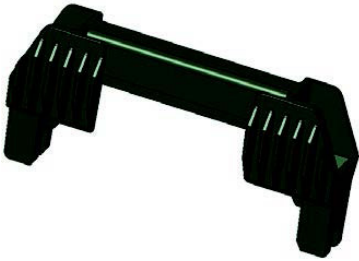

1.

Set the desk to its minimum height so columns are completely retracted.

2.

Disconnect from mains supply.

3.

Turn table upside down.

4.

Disconnect, unscrew and remove the manual controller.

5.

Unscrew and remove the feet.

6.

Unscrew the beam and the cantilevers from the tabletop.

7.

Place disassembly tool on beam with the ridges facing towards the cantilever.

8.

Press straight down to loosen cantilever.

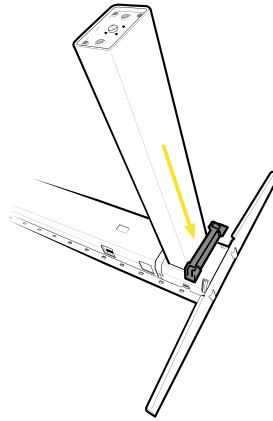

9.

At the same time press disassembly tool down and tilt column to remove from beam.

10.

Twist cantilever slightly to release it from beam.

11.

Repeat step 7 to 10 for the other side of the frame.

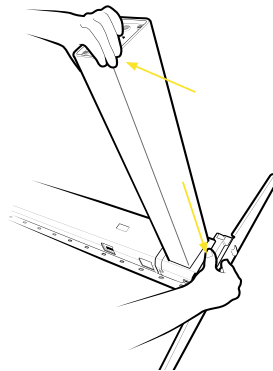

## **BakkerElkhuizen**

Taalstraat 151

5261 BC Vught

The Netherlands

tel. +31 36 546 7265

fax. +31 36 546 7830

email. [info@bakkerelkhuizen.com](mailto:info@bakkerelkhuizen.com)

All rights reserved. All trade names are registered trademarks of the respective manufacturers listed. All specifications are subject to change without prior notice.