

HP Z24n G3 WUXGA Display

Exquisitely crafted for every detail

Meticulously crafted to surpass every design standard, the HP Z24n G3 WUXGA Display is the HP's thinnest 24 inch diagonal screen performance monitor. It is composed of authentic aluminum and delivers an impressive, frameless viewing experience. Bring your ideas to life with remarkable color accuracy in precise WUXGA resolution.

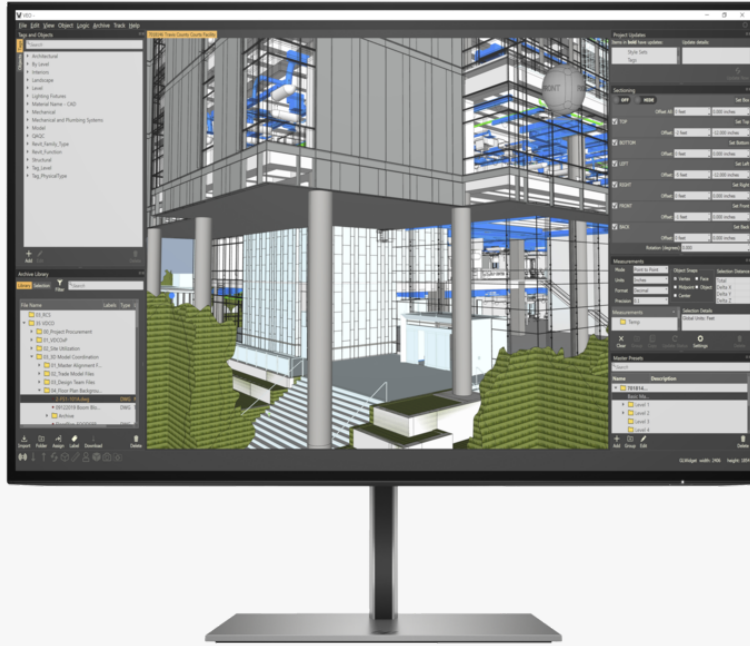

*Product image may differ from actual product

Universally consistent colors

Out of the box, you get remarkable color accuracy from screen to screen¹. Achieve precise, vibrant detail with 99% sRGB color gamut and WUXGA resolution.

Design pushed to the edge

This stunning 24" (61 cm) diagonal screen monitor is meticulously crafted with a razor thin profile and frameless design. Get ultimate comfort with 4-way ergonomic adjustability.

Always on low blue light

Experience exceptional vibrancy with HP Eye Ease, the always on low blue light filter that reduces blue light exposure with zero impact to true color accuracy.

Sustainability in action

Responsibly reimagined

Make a conscious choice with this monitor that's been built with the environment in mind. Its plastics consist of over 80% recycled materials² plus it has 100% sustainably sourced and recyclable packaging³. It is ENERGY STAR[®] certified and EPEAT[®] 2020 registered⁴.



HP Z24n G3 WUXGA Display

Featuring

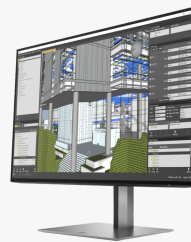
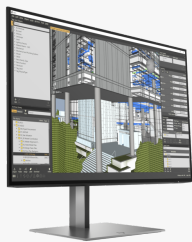

Easily connect multiple monitors

Declutter your desk and connect a series of displays by daisy chaining with a single DisplayPort™ cable.⁵

All the ports you need

Connect to a Workstation, a PC and additional displays.

Easily mount a Mini

Mount your HPZ2 Mini or HP Desktop Mini directly to the monitor for a clean workspace.⁶

HP Zero BrightDot Guarantee

Even if just a third of a pixel fails or is stuck in one position, HP will replace the entire display.⁷

Optional integrated audio

Easily attach the Z Display Conferencing Speaker Bar for stereo quality audio and dual microphones.⁸

3-year limited warranty

The assurance of HP's three-year standard limited warranty.



HP Z24n G3 WUXGA Display

Specifications

Display specifications

Display size (diagonal, metric)
61 cm (24")

Aspect ratio
16:10¹

Curvature
Flat

Native resolution
WUXGA (1920 x 1200)¹

Resolution (maximum)
WUXGA (1920 x 1200 @ 60 Hz)

Resolutions supported
640 x 480; 800 x 600; 1024 x 768; 1280 x 720; 1280 x 800; 1280 x 1024; 1440 x 900; 1600 x 900; 1600 x 1200; 1680 x 1050; 1920 x 1080; 1920 x 1200

Panel type
IPS¹

Bezel
4-sided micro-edge

Panel active area
51.84 x 32.4 cm

Panel bit depth
8 bit (6 bit + 2 FRC)

Display colors
Up to 16.7 million colors supported (through FRC technology)

Display color gamut
99% sRGB; 85% DCI-P3

Display scan frequency
50-60 Hz (Vertical) 30-75 KHz (Horizontal)

Response time
5ms GtG (with overdrive)¹

Brightness
350 nits¹

Contrast ratio
1000:1 (Static)¹ 10000000:1 (Dynamic)¹

Pixel pitch
0.270 mm

Pixels per inch (ppi)
96 ppi

Viewing angle
178° (Vertical) 178° (Horizontal)

Backlight type
Edge-lit

Display features
Language selection; On-screen controls; Pivot rotation; Anti-glare; Height adjustable

Display User Control Options
Exit; Information; Management; Power control; Input control; Menu control; Brightness+; Image; Color

Management software
HP Display Center; HP Display Manager

Low blue light modes
Yes, HP Eye Ease (TÜV Low Blue Light Hardware Solution certified)

Flicker-free
Yes

Screen treatment
Anti-glare

Hardness
3H

VESA mount
100 mm x 100 mm (bracket included)

Height adjustment range
150 mm

Tilt
-5 to +20°

Swivel
±45°

Pivot
±90

Camera
No integrated camera

Microphone
No

Connectivity and communications

Port and connectors
1 HDMI 1.4
1 DisplayPort™ 1.2
1 DisplayPort™ 1.2-out
4 SuperSpeed USB Type-A 5Gbps signaling rate
1 USB-B

HDCP
Yes, DisplayPort™ and HDMI

Power supply
100 - 240 VAC 50/60 Hz (Internal)

Power consumption
63 W (maximum), 28 W (typical), 0.5 W (standby)

Logistics and Physical

Product color
Turbo Silver

Detachable stand
Yes

Physical security
Security lock-ready²

Dimensions without Stand (W x D x H)
53.17 x 3.85 x 34.29 cm

Dimensions with stand (W x D x H)
53.17 x 19.5 x 52.14 cm

Weight
4.9 kg (With stand.)

Packaged Dimensions (W x D x H)
62.5 x 41.5 x 14.2 cm

Packaged weight
7.6 kg

Certification and compliance

Energy efficiency
ENERGY STAR® certified E

Ecolabels
TCO Certified; EPEAT® registered; TCO Certified Edge

Environmental specifications
Low halogen

Certifications
BIS; BSMI; CB; CCC; CE; cTUVus; EAC; ErP; FCC; GS Mark; ISO 9241-307; KC/KCC; NOM; PSB; SEPA; TUV-S; VCCI; WEEE; ISC; Low blue light; Ukraine Energy label; WW application; UAE

Operating temperature range
41 to 95°F

Additional information

Manufacturer Warranty
3 year limited warranty including 3 year of parts and labour. Certain restrictions and exclusions apply.

What's in the box
Monitor; Documentation; VESA Mount adapter; USB Type-A to B cable; Cable manager; AC power cord; DisplayPort™ 1.4 cable⁴



HP Z24n G3 WUXGA Display

Accessories and services (not included)

HP Business PC Security Lock v3 Kit



Help prevent chassis tampering and secure your PC and display in workspaces and public areas with the affordable HP Business PC Security Lock v3 Kit.
Product number: 3XJ17AA

HP Integrated Work Center for Desktop Mini and Thin Client



Make the most of small work spaces with an HP IWC Desktop Mini/Thin Client that lets you create a compact desktop solution by combining a display¹ with an HP Desktop Mini, HP Thin Client or HP Chromebox¹ and giving you convenient front access to all of its inputs.

Product number: G1V61AA

¹ Not all 24-inch monitors supported please refer list of compatible monitors.

² IWC is compatible with displays up to 24 diagonal inches. See QuickSpecs for exact device compatibility.

HP Z24n G3 WUXGA Display

Footnotes

Messaging Footnotes

¹ All performance specifications represent the typical specifications provided by HP's component manufacturers; actual performance may vary either higher or lower.

² Recycled plastic content percentage is based on the definition set in the IEEE 1680.1-2018 EPEAT standard.

³ 100% outer box/corrugate cushion packaging made from sustainably sourced certified and recycled fibers. Fiber cushions made from 100% recycled wood fiber and organic material. Any plastic cushions are made from >90% recycled plastic. Excludes plastic bags and plastic foam sheeting.

⁴ Based on US EPEAT® registration according to IEEE 1680.1-2020 EPEAT®. Status varies by country. Visit www.epeat.net for more information.

⁵ Requires an additional DisplayPort™ cable to daisy chain.

⁶ Z2 Mini and Desktop mini and B550 Z Display G3 PC Mounting Bracket sold separately.

⁷ The HP Pixel Policy allows no bright sub-pixel defects for this display. For complete details, see <http://support.hp.com/us-en/document/c00288895>.

⁸ Z Display Conferencing Speaker Bar Sold Separately.

Technical Specifications Footnotes

¹ All specifications represent the typical specifications provided by HP's component manufacturers; actual performance may vary either higher or lower.

² Lock sold separately.

³ Based on US EPEAT® registration according to IEEE 1680.1-2018 EPEAT®. EPEAT® status varies by country. Visit www.epeat.net for more information.

⁴ Included cables may vary by country.

