

OptiPlex 3090 Ultra All-in-One Bundle

Setup and Specifications



Notes, cautions, and warnings

 **NOTE:** A NOTE indicates important information that helps you make better use of your product.

 **CAUTION:** A CAUTION indicates either potential damage to hardware or loss of data and tells you how to avoid the problem.

 **WARNING:** A WARNING indicates a potential for property damage, personal injury, or death.

Contents

Chapter 1: Set up your OptiPlex 3090 Ultra All-in-One Bundle.....	4
Installing the device.....	4
Stand tilt, pivot, and swivel images.....	12
Chapter 2: Powering the system.....	14
Chapter 3: Dell power button sync.....	15
Chapter 4: Create a USB recovery drive for Windows.....	16
Chapter 5: Views of OptiPlex 3090 Ultra All-in-One Bundle.....	17
Back view.....	17
Bottom view.....	18
Front view.....	18
Left and right view.....	20
Service tag location.....	20
Chapter 6: Specifications of OptiPlex 3090 Ultra All-in-One Bundle.....	21
External ports and connectors.....	21
Dimensions and weight.....	22
Display settings and operations.....	22
Chapter 7: Getting help.....	23
Contacting Dell.....	23

Set up your OptiPlex 3090 Ultra All-in-One Bundle

Installing the device

1. Align and insert the slots on the stand into the tab on the stand base.
2. Lift and tilt the stand base.
3. Tighten the captive screw to secure the stand to the base.

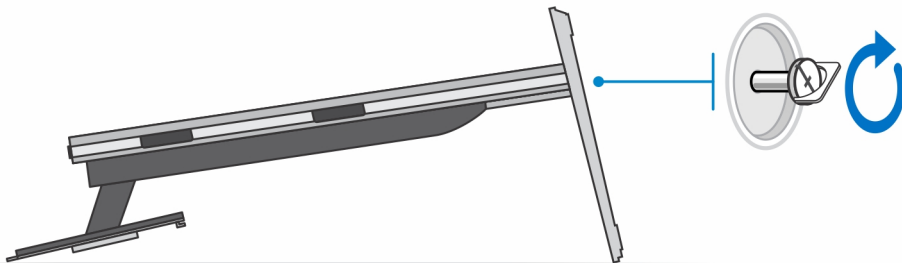
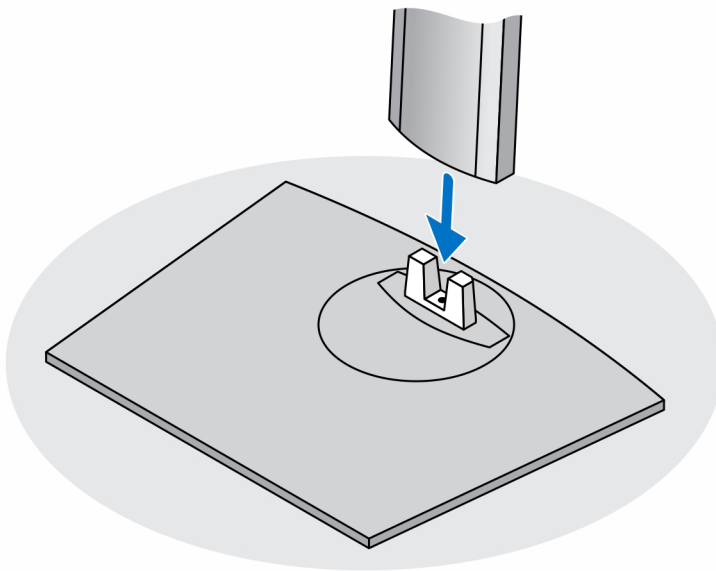

4. Write the service tag number of the OptiPlex device in the blank space provided in the service tag of the monitor.

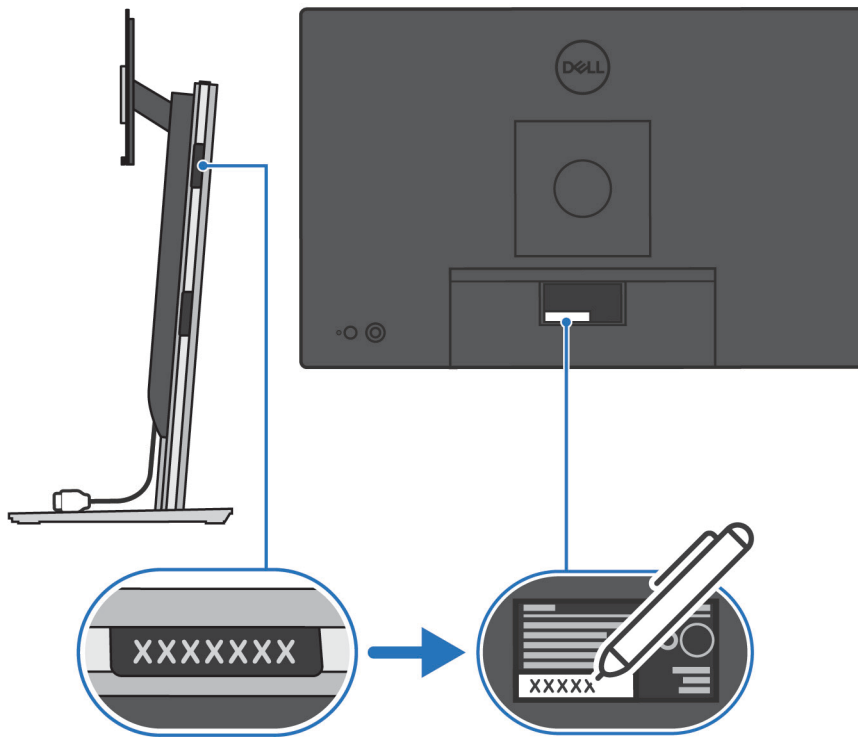

5. Open the packaging from one side, to install the stand to the monitor.
6. Align and insert the hooks on the mounting bracket on the stand into the slots on the monitor, until you hear a click.
7. Remove the monitor along with the stands from the packaging box.

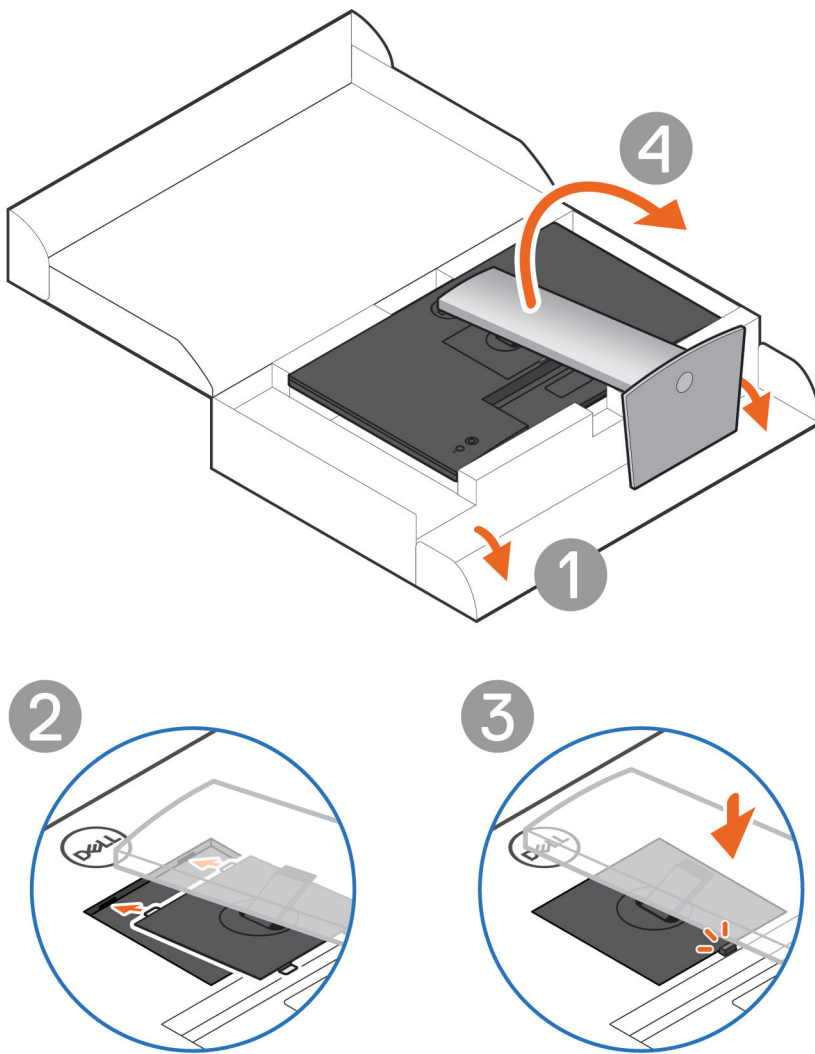

8. Connect the USB Type-C cable of the OptiPlex device to the USB Type-C port on the monitor.

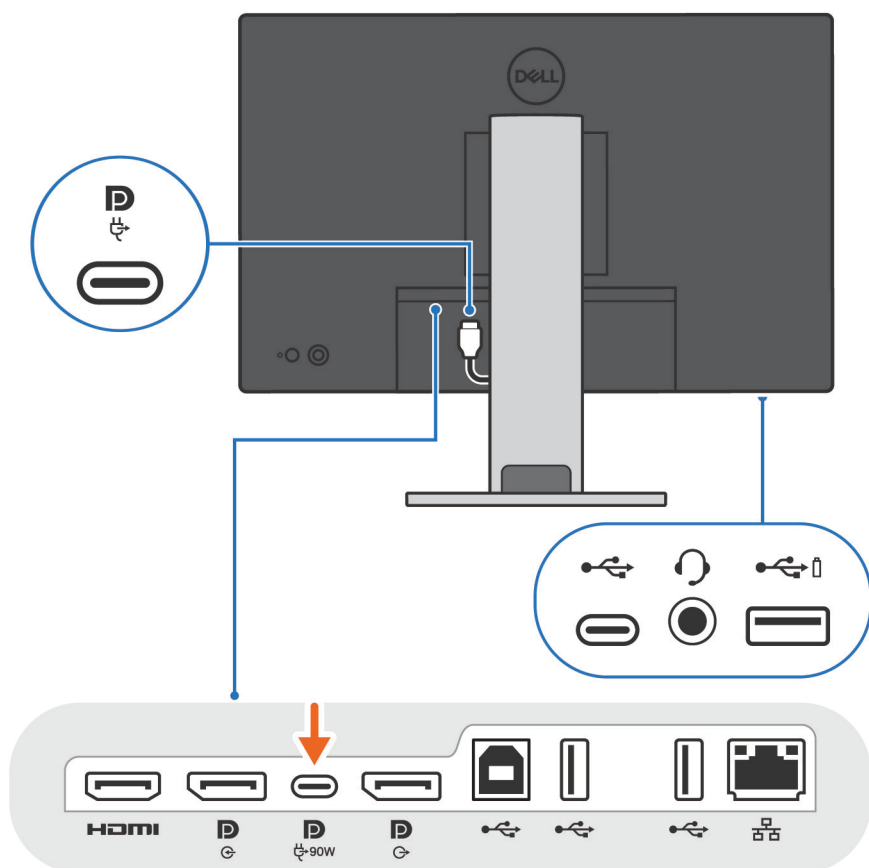

9. Connect the keyboard cable, mouse cable, and network cable to the monitor.

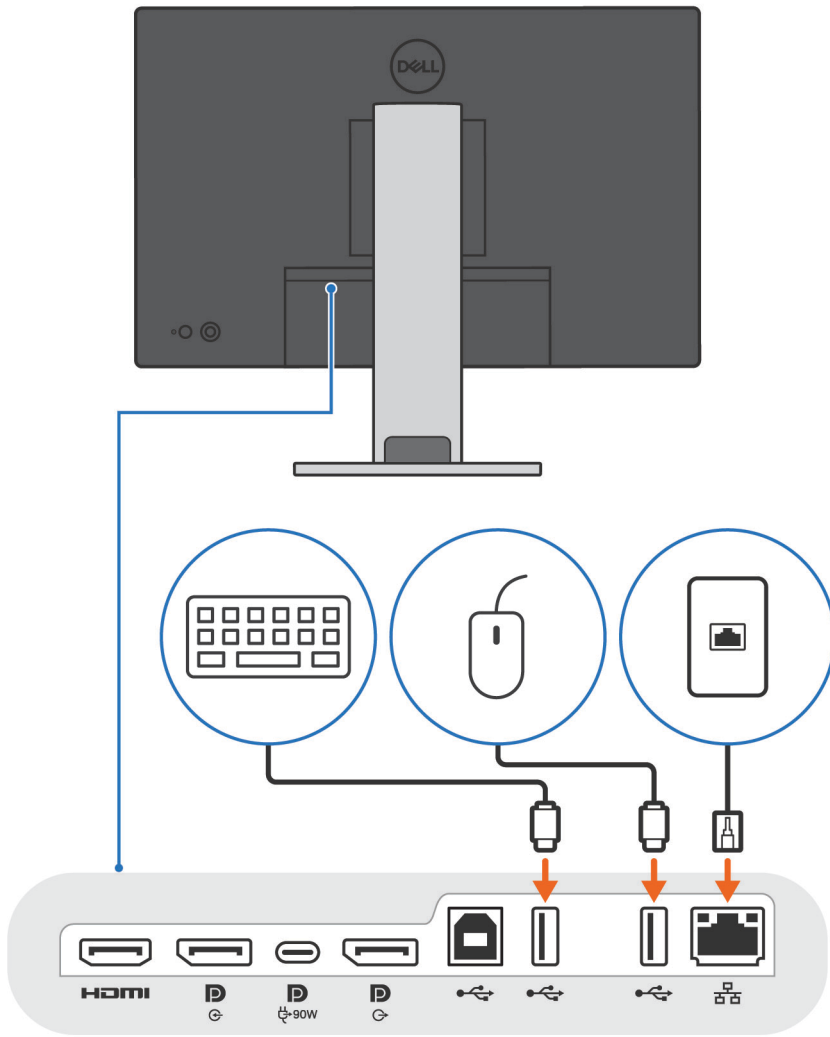

10. Connect the monitor power cord to the power port.

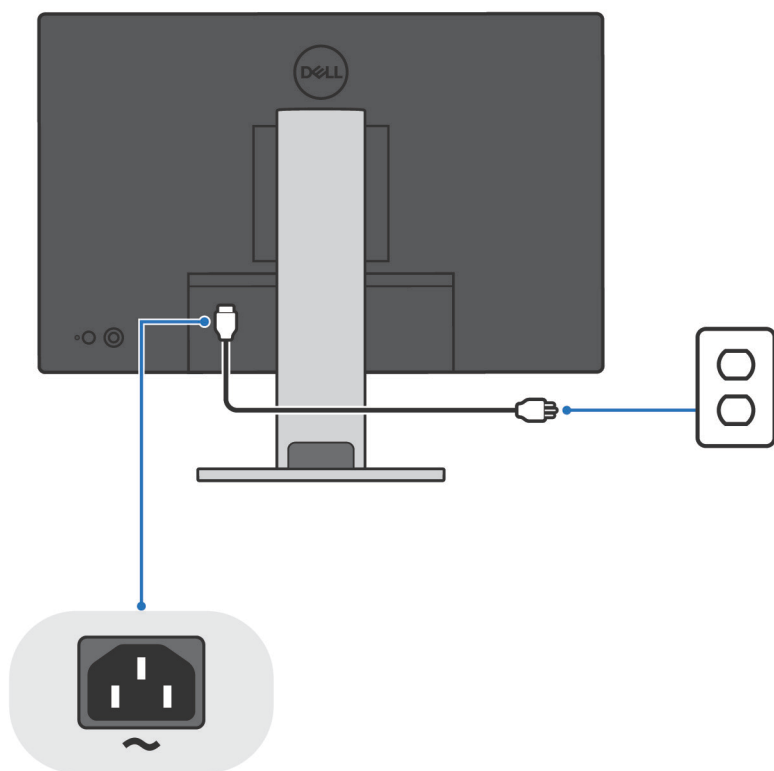

11. Power On the computer.

NOTE: To enable the Dell power button sync between the monitor and the computer, press the power button on the monitor first and then press the power button on the computer.

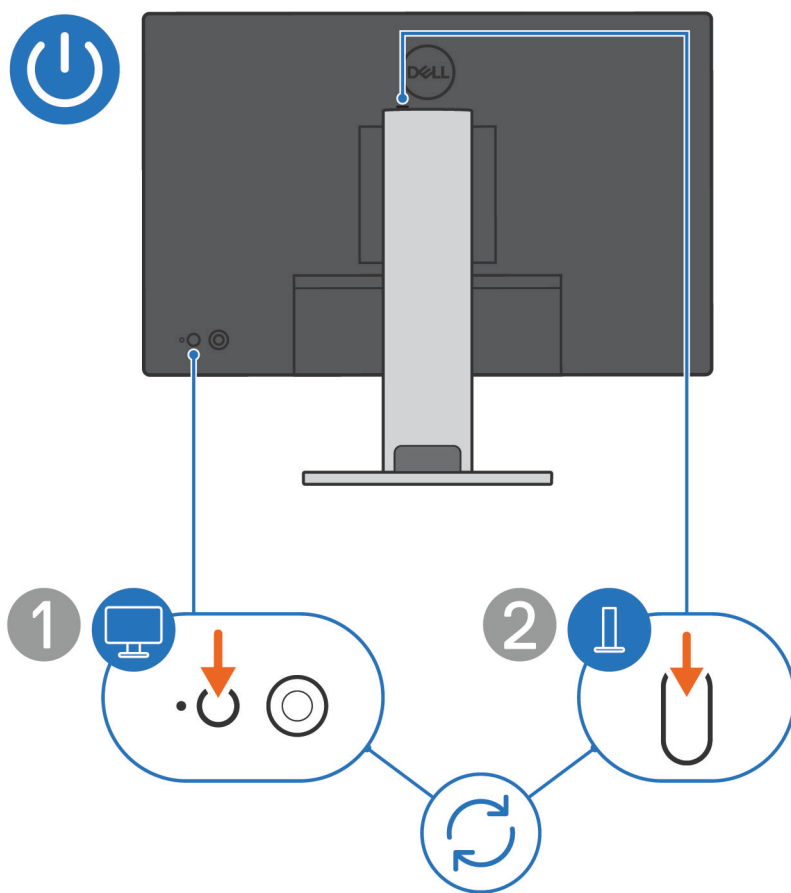

NOTE: When connecting the OptiPlex device and the monitor for the next time, press the monitor power button, both the monitor and computer will turn On.

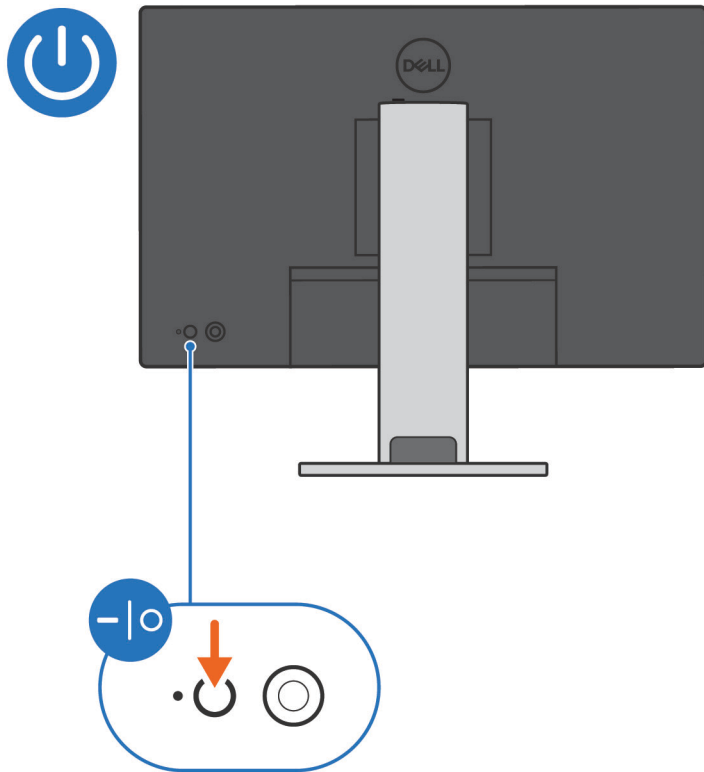

NOTE: For more information on Dell power button sync feature, see [Dell power button sync](#).

12. Lock the device and the stand cover.

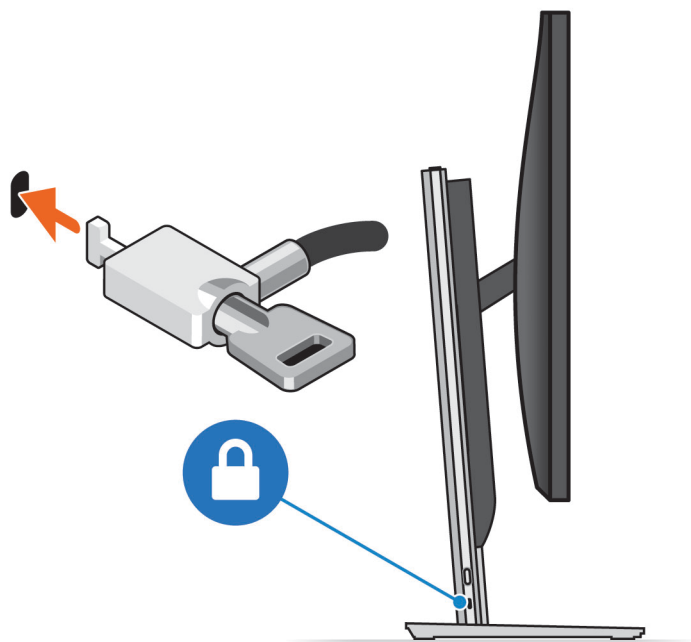

Stand tilt, pivot, and swivel images

Monitor rotate:

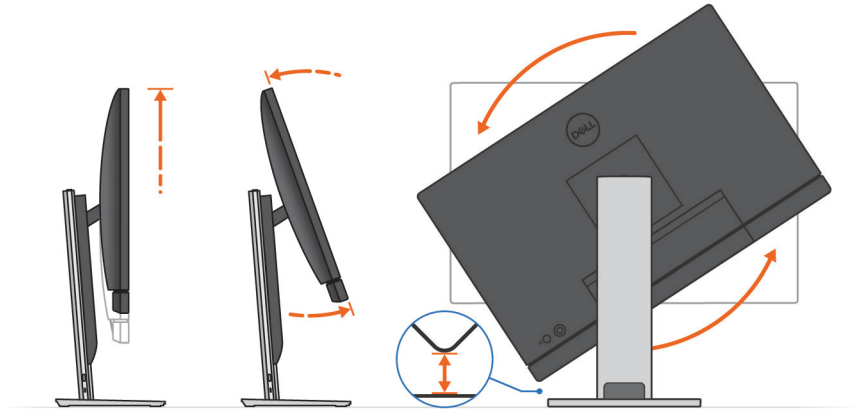

Monitor tilt:

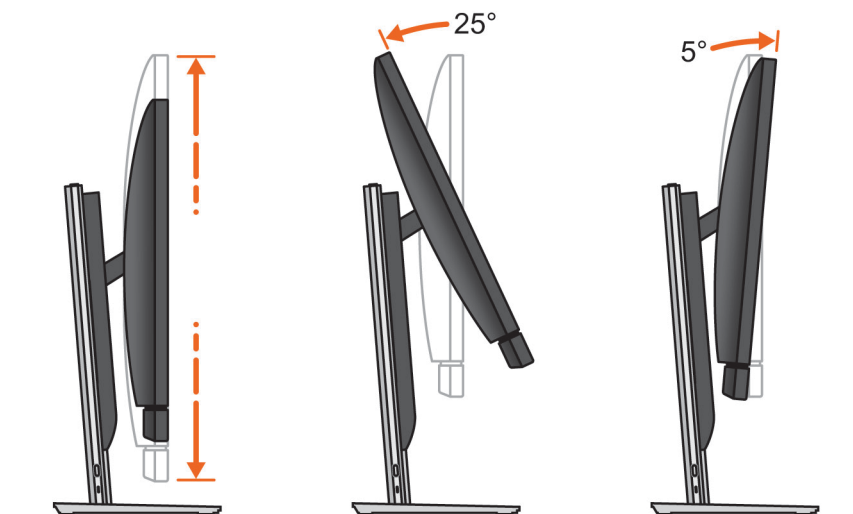

Monitor swivel:

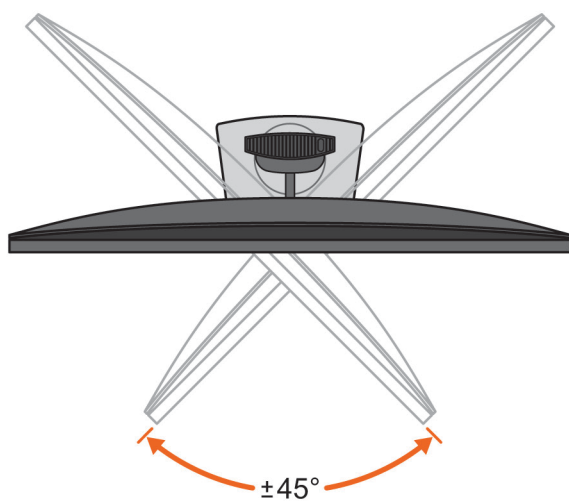

Powering the system

This system can be powered using a 65 W adapter (4.5 mm input power source) or through the USB Type-C cable connected to a display capable of providing power delivery of 65 W or greater. During normal operation, when the device is connected with a single power source (primary power source), connecting a second power source and disconnecting the primary power source will shut down the device. However, if the secondary power source is disconnected while the primary power source is connected, the system continues to operate normally.

When the device is powered with both the power sources—AC adapter and USB Type-C cable, the AC adapter is the primary power source and USB Type-C is the secondary power source. Disconnecting the AC adapter will shut down the system. If the secondary power source is disconnected, the system continues to operate normally.

 **NOTE:** Hotswap between the AC adapter and USB Type-C power source is not supported.

Table 1. Powering the system

Primary Power Source	Secondary power source connected	Power source disconnected	Operation
AC Adapter	Rear Type-C	AC Adapter	Shut down
AC Adapter	Rear Type-C	Rear Type-C	Normal operation
Rear Type-C	AC Adapter	AC Adapter	Normal operation
Rear Type-C	AC Adapter	Rear Type-C	Shut down

Dell power button sync

The C-series monitors are enabled with Dell power button sync feature to control computer power state from monitor power button. This feature is compatible with Dell OptiPlex 3090 Ultra platform, and is only supported over USB Type-C interface. For the first time, the user needs to establish a sync between the computer and the Dell power button sync enabled monitor by powering on the monitor first and then the computer.

Connecting the monitor and the computer for Dell power button sync for the first time

Please follow the instructions below:

1. Ensure the computer and the monitor is switched off.
2. Press the power button on the monitor to turn on the monitor.
3. Connect the USB Type-C cable from the computer to the monitor.
4. Both the monitor and the computer will turn on momentarily. After a while (approximately 6 seconds), both the computer and the monitor will turn off.
5. When connecting the computer and the monitor for the next time, press either the monitor or the computer power button, both the monitor and computer will turn On.
6. The computer power state will automatically contract and sync with the monitor.

Create a USB recovery drive for Windows

Create a recovery drive to troubleshoot and fix problems that may occur with Windows. An empty USB flash drive with a minimum capacity of 16 GB is required to create the recovery drive.

 **NOTE:** This process may take up to an hour to complete.

 **NOTE:** The following steps may vary depending on the version of Windows installed. Refer to the [Microsoft support site](#) for latest instructions.

1. Connect the USB flash drive to your computer.
2. In Windows search, type **Recovery**.
3. In the search results, click **Create a recovery drive**.
The **User Account Control** window is displayed.
4. Click **Yes** to continue.
The **Recovery Drive** window is displayed.
5. Select **Back up system files to the recovery drive** and click **Next**.
6. Select the **USB flash drive** and click **Next**.
A message appears, indicating that all data in the USB flash drive will be deleted.
7. Click **Create**.
8. Click **Finish**.
For more information about reinstalling Windows using the USB recovery drive, see the *Troubleshooting* section of your product's *Service Manual* at www.dell.com/support/manuals.

Views of OptiPlex 3090 Ultra All-in-One Bundle

Back view

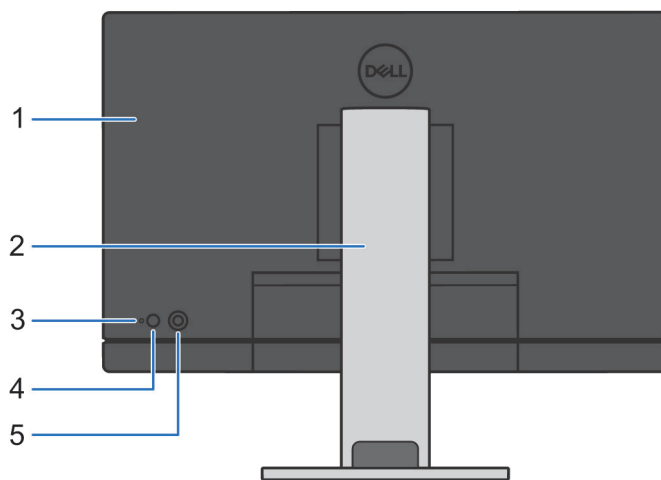

1. Monitor
3. Power button status light
5. Joystick

2. Height Adjustable Stand
4. Power button

Bottom view

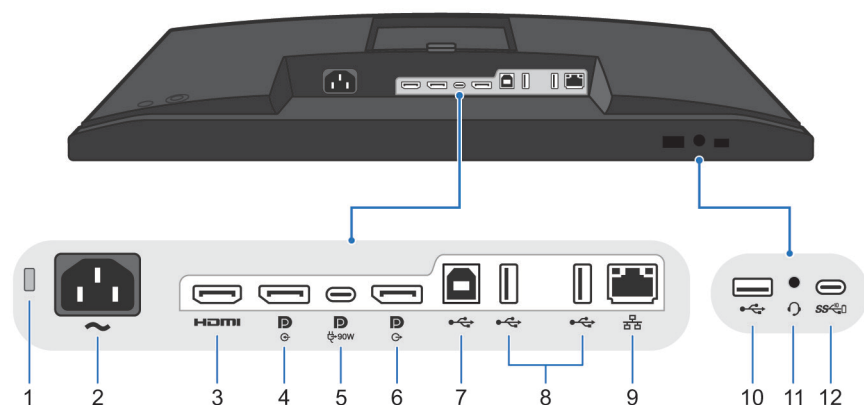

- | | |
|------------------------------------|--|
| 1. Security lock slot | 2. Power port connector |
| 3. HDMI port | 4. DisplayPort in |
| 5. USB Type-C upstream/DisplayPort | 6. DisplayPort out |
| 7. USB-B upstream port | 8. Two super speed USB 5 Gbps (USB 3.2 Gen1) |
| 9. RJ-45 connector | 10. Super speed USB 5 Gbps (USB 3.2 Gen1) |
| 11. Headphone jack | 12. USB Type-C downstream port |

Front view

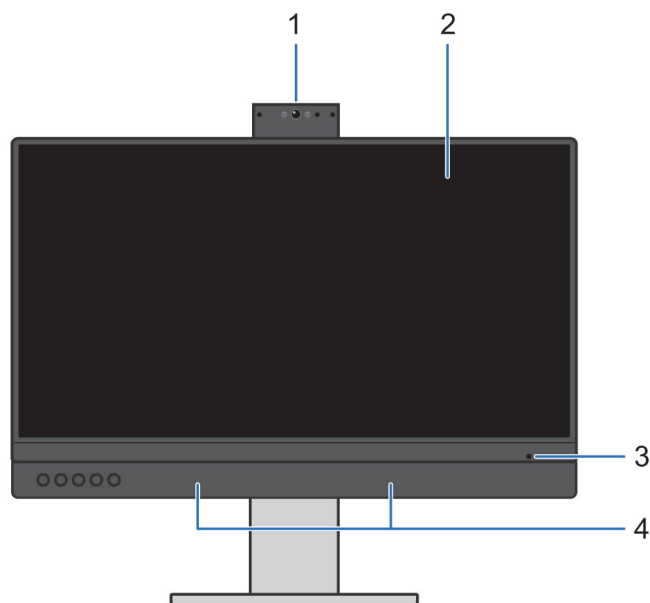

- | | |
|------------------------|----------------------|
| 1. Webcam | 2. Display |
| 3. Power LED indicator | 4. In-built speakers |

Webcam:

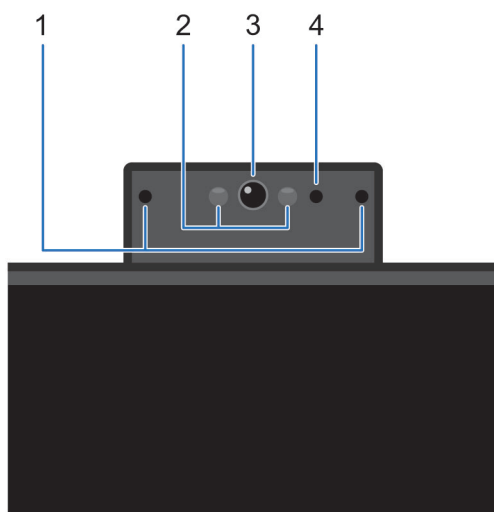

- 1. Microphones
- 3. Webcam lens

- 2. IR LED
- 4. Webcam LED indicator

Front controls:

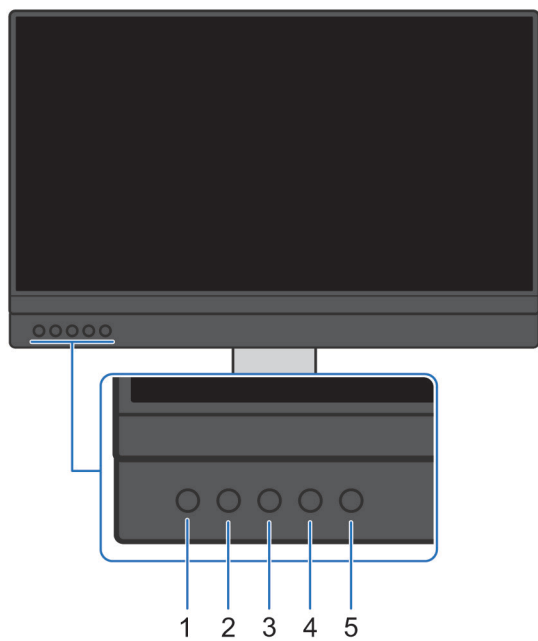

- 1. Teams button and LED
- 3. Volume down and LED
- 5. Microphone mute and LED

- 2. Hookswitch and LED
- 4. Volume up and LED

Left and right view

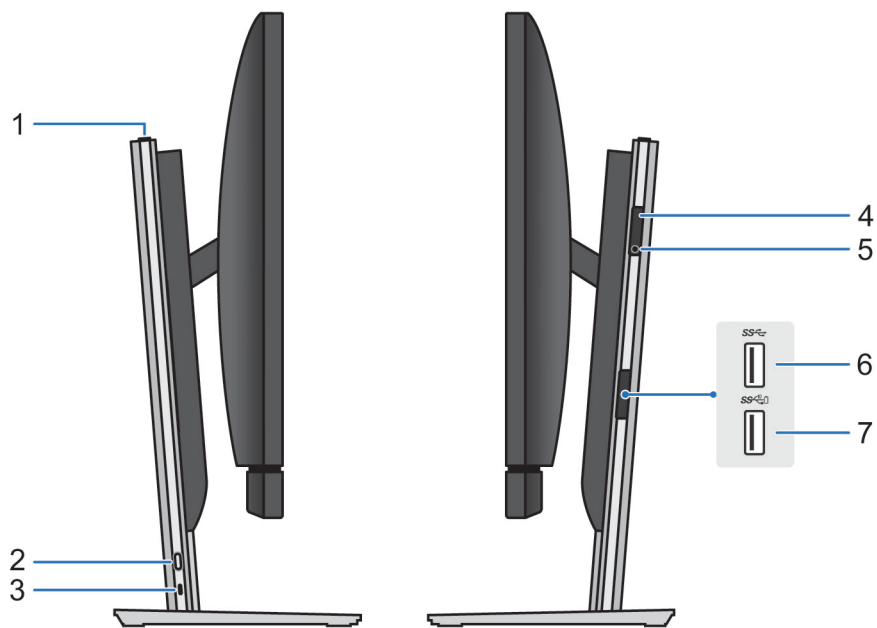

1. Power button
2. Stand release button
3. Security screw hole to secure stand cover
4. Service tag label
5. Headset/Universal audio jack
6. USB 3.2 Gen 2 Type-A port
7. USB 3.2 Gen 2 Type-A port with PowerShare

Service tag location

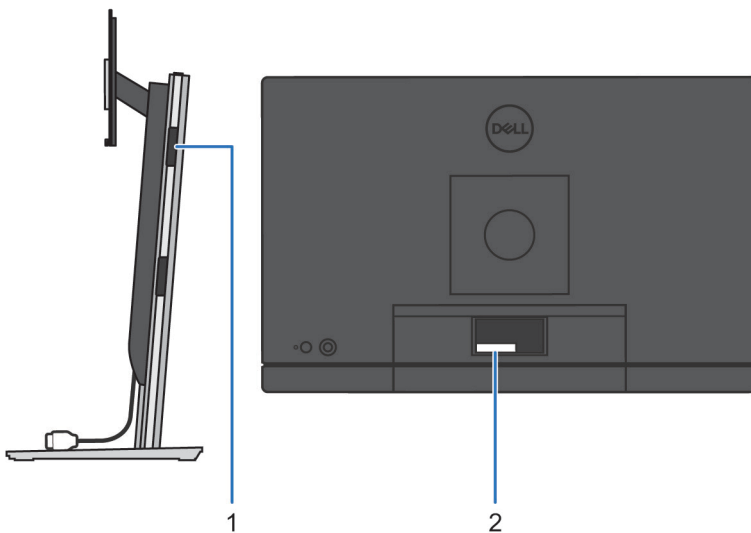

1. Service tag location of the computer
2. Service tag location of the monitor

Specifications of OptiPlex 3090 Ultra All-in-One Bundle

External ports and connectors

The following table lists the external ports and connectors of your OptiPlex 3090 Ultra All-in-One Bundle.

Table 2. External ports

Description	Values
Network port	One RJ-45 Ethernet port
USB ports	<ul style="list-style-type: none"> One USB Type-C upstream/DisplayPort (bottom) One USB-B upstream port (bottom) Three super speed USB 5 Gbps (USB 3.2 Gen1) (bottom) One USB Type-C downstream port (bottom) One USB 3.2 Gen 2 Type-A port (right) One USB 3.2 Gen 2 Type-A port with PowerShare (right)
Audio port	<ul style="list-style-type: none"> One Headset/Universal audio jack One Headphone jack
Video port	<ul style="list-style-type: none"> HDMI port DisplayPort in DisplayPort out
Power button	<ul style="list-style-type: none"> Power button on the monitor Power button on the computer
Power-adaptor port	DC-in port
Security-cable slot	<ul style="list-style-type: none"> One Security screw hole to secure stand cover One Monitor security lock slot
Status LED lights	<ul style="list-style-type: none"> Power button status light (back) Power LED indicator (front) Teams button and LED (front) Hookswitch and LED (front) Volume down and LED (front) Volume up and LED (front) Microphone mute and LED (front)
Others	<ul style="list-style-type: none"> Joystick (back) Webcam (front) Stand release button (left) Service tag label on the computer (right) Service tag label on the monitor (back)

NOTE: For more information about the ports and connectors of OptiPlex 3090 Ultra see the *Views and Specifications* section of your product's *Setup and specifications guide* at www.dell.com/support/manuals.

Dimensions and weight

The following table lists the height, width, depth, and weight of your OptiPlex 3090 Ultra All-in-One Bundle.

Table 3. Dimensions and weight

Description	Values
Height	<ul style="list-style-type: none">Minimum: 364.00 mm (14.33 in.)Maximum: 514.00 mm (20.24 in.) <i>NOTE:</i> The Height Adjustable Stand is height adjustable.
Width	538.40 mm (21.19 in.)
Depth	185.00 mm (7.28 in.)
Weight <i>NOTE:</i> The weight of your computer depends on the configuration ordered and manufacturing variability.	<ul style="list-style-type: none">Minimum: 7.60 kg (16.75 lb)Maximum: 7.80 kg (17.19 lb)

Display settings and operations

For more information in display settings and operations, see the user guide [Dell-C2422HE](#).

Getting help

Contacting Dell

 **NOTE:** If you do not have an active Internet connection, you can find contact information on your purchase invoice, packing slip, bill, or Dell product catalog.

Dell provides several online and telephone-based support and service options. Availability varies by country and product, and some services may not be available in your area. To contact Dell for sales, technical support, or customer service issues:

1. Go to **Dell.com/support**.
2. Select your support category.
3. Verify your country or region in the **Choose a Country/Region** drop-down list at the bottom of the page.
4. Select the appropriate service or support link based on your need.