

**Warranty and Service:**  
For any information or problem, contact your local Philips dealer or authorized service center. For a list of authorized Philips service centers visit [www.philips.co.in](http://www.philips.co.in) or contact our consumer care at 1800 102 2929 (Toll-free) or 1860 180 1111 (standard call rates apply)

**Warranty Card:**  
This apparatus is covered under warranty against any defect due to defective material or workmanship for TWO YEAR on the product and FIVE YEAR warranty on the motor from the date of purchase. Warranty does not cover the damage to the product/ motor due to mishandling, negligence, breakage or cracking of transparent jars, domes, lids, cap and denting of stainless steel jars. Should a defect develop during the period of warranty, Philips Domestic Appliances India Ltd. undertakes to repair the apparatus FREE OF CHARGE through the dealer from whom it has been purchased or at any of the Philips Authorized Service Centers.

The warranty is not valid in case:

1. Apparatus is not used according to the user manual.
2. Defects caused by improper or reckless use.
3. Repairs are done by persons other than Philips Authorized service center.
4. Modifications of any nature made in the apparatus.
5. Tampered serial number.
6. Incomplete warranty card after purchase.
7. Product is used for a commercial purpose (i.e. other than domestic use).
8. Usage of parts not recommended by Philips or those made by other manufacturers.

All consumables and parts susceptible to normal wear and tear are not covered under warranty.

Week/ S. No. \_\_\_\_\_

Date of Purchase \_\_\_\_\_

Dealer's Name: \_\_\_\_\_

Dealer's Stamp: \_\_\_\_\_

Customer's Name and Address: \_\_\_\_\_

Model No.: \_\_\_\_\_

Dealer's Signature: \_\_\_\_\_



[www.philips.co.in](http://www.philips.co.in)



[www.philips.co.in](http://www.philips.co.in)

HL7777/00



Mixer Grinder

Please read the guidelines provided in this DFU for important instructions, about appliance usage and warranty before using the product

PHILIPS

9.0 Troubleshooting

S. No	Problem	Cause	Solution
1.	Appliance does not work.	No electricity supply.	Ensure that the plug is plugged in well.
2.	Appliance suddenly stops working while in use.	The appliance is equipped with an 'Over Load Protector' (OLP) switch. If appliance overheats, It automatically cuts off power supply.	Unplug the appliance and let it cool for 2-3 minutes. Remove jar from base unit At the bottom of base unit there Is a red colored switch (OLP). Reset OLP by pressing it. Put plug back into wall socket and switch on appliance again. (see heading 'Overload Protection').
3.	Blade unit is blocked.	The quantity being processed is probably too large.	Switch off appliance. Remove ingredients that are blocking the blade unit, refer the maximum capacity of jars table.
4.	Appliance gives an unpleasant smell during first few times of use.	This is normal for the first few times.	If appliance continues to smell after using a few times: • Ensure that jars are clean and there are no ingredients stuck inside it. • Ensure that appliance has been assembled correctly.
5.	Appliance makes a lot of noise.	Jars have not been properly locked.	Make sure that jar has been properly and tightly locked.
		Blade is loose (fixed blade)..	Contact nearest customer care center.
6.	There are fumes from the appliance.	Appliance may have been used for long time.	Switch off appliance and let it cool for 60 min.
7.	Unsatisfactory grinding/ blending/ mixing performance.	Incorrect jar selection.	Use jar as per the selection.
		Incorrect preset menu selection.	Use appropriate menu.
		Overloading ingredients in jar.	Refer to the maximum capacity of jars.
		Large size of ingredients.	Cut ingredients into appropriate size.
8.	Leakage from jar lid.	Gasket has not been fitted.	Unplug appliance. Remove jar from base unit. Remove lid to check if gasket has been assembled correctly.
9.	Leakage from blend and carry jar while blending.	Blend and carry jar is not properly assembled.	Disassemble blend and carry jar, assemble again by fixing the blade and jar collar.
10.	Leakage from blend and carry jar while carrying.	Blend and carry cap and gasket are not locked properly.	Remove lid to check if gasket has been assembled correctly.
11.	Bad odour in preset jar.	Jar might have not washed properly.	Remove the blade using stirrer and clean thoroughly.
11.	Preset menu is not working.	Appliance might be in OFF condition.	Turn the switch knob to ON position and then press the preset function when LED light turns white.

In case these measures do not work, contact the nearest PHILIPS service center or call at customer care numbers. 1800 102 2929 (Toll-free) or 1860 180 1111 "standard call rates apply"

1.0 Introduction

Philips brings to you a quiet mixer grinder with preset menus and 4 unique jars.

- 1.5L Quiet Pro jar with interchangeable blade
- 0.5L Chutney jar
- 1.0L Power bullet jar ( Blender/Preset jar)
- 1.0L Blend and carry jar with sipping cap

Technical specifications

Model No.	HL7777/00
Voltage	230V~50Hz
Power consumption	750 Watt
Motor	Universal motor (750W)
No load speed	13000 ± 500 RPM no load (with closed loop speed control), 11000 ± 500 RPM with load
Speed control	Rotary switch with OFF ,ON and 3 speeds with preset menus
Insulation	Class F
Protection	Class I
Rating	Total rated ON time 30 minutes (max), Continuous ON for 5 minutes (max.) and Off for 2 minutes (min.) Rest time 45 minutes
Protection against dust & moisture	Ordinary
Protection against ingress of water	IPXO
Material of body	ABS
Material of jars	Stainless steel, PC
Flex Cord	PVC insulated 1.2 meter chord length embedded with 3 pin plug

2.0 General description:

1. Base unit: The motor, switch knob, preset menus, mains cord, and overload protector switch

2. Safety Switch: Ensures that the unit runs only when the jar is placed on unit.

3. Switch Knob: To toggle between manual and preset modes, Turn the rotary switch knob clockwise from OFF to ON (light indication) and then to speeds 1, 2 and 3

4. Preset menu panel: Displays preset menus with optimised timing and speed for each menu

5. Anti-slip rubber feet: For better placement of base unit

6. Overload protector

7. 1.5 L Multipurpose (Quiet Pro) double wall jar with transparent lid, double wall and removable blade. Suitable for wet grinding and dry grinding with interchangeable blades
8. Wet blade (for 1.5L jar)

9. Dry blade (for 1.5L jar)

10. 0.5 L chutney jar with transparent lid and fixed blade: Suitable for grinding chutneys, small quantity of masala and spices.

11. 1.0 L Preset (Power Bullet) jar with removable blade: suitable for preset applications like mincing chicken and meat, smoothies, purees, thick and thin sauces, smooth and coarse dips and Ice crushing

12. 1.0 L Blend and carry jar (with sipping cap) : Suitable for making smoothies/milkshakes and carry on the go

13. Detachable blade holder assembly – for blend and carry jar

14. Jar collar for blend and carry jar

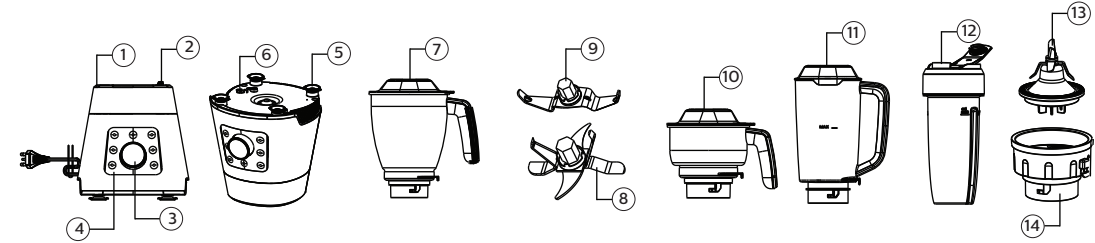

3.0 Important safety instructions

The use of any electrical appliance requires the following of basic common sense safety rules.

- Primarily there is danger of injury or death and
- Secondly the danger of damage to the appliance.

These are indicated in the text by the following two conventions:

- WARNING:** Danger to the person!
- IMPORTANT:** Damage to the appliance!

In addition, we offer the following essential safety advices, we recommend that you read the following instructions carefully, before using the appliance:

3.1 Placing:

- Do not place a mixer grinder on wet surface.
- Keep mixer away from hoc gas burner, electric hot plate or similar appliances. Or near source of water like sink, near tap etc.,
- This appliance is strictly for household use, do not use for outdoors or for commercial purpose.

3.2 Mains Cord:

- Do not use the appliance when the mains cord, the plug or other components are damaged. Only the company or a service center authorized by Philips must replace it.
- Check if the voltage indicated on the base of the appliance, corresponds to the local electrical mains voltage before you connect the appliance.
- The mains lead should reach without straining the connections.
- Do not let the mains lead hang over the edge of a worktop where a child could reach it.
- Do not let the lead run across an open space e.g. between a low socket and table.
- Do not let the lead run across a cooker or toaster or other hot area which might damage the cable.
- Do not stretch the power cord.

3.3 Usage Safety:

- Do not operate the mixer without the lid in place.
- Don't touch moving parts & blades when the Mixer Grinder is in operation.
- Dont use any other attachment like plate, other lid. It may cause hazard
- Always hold the lid/dome firmly while processing
- Do not put your hand inside the mixer when the knob is in ON condition
- Keep the Mixer Grinder at least 6" (150 mm) away from the wall.
- Always unplug the appliance before reaching in to the jar with your fingers or an object e.g. spoon etc
- Do not leave unit unattended while in operation.
- Do not grind hot ingredients in the Mixer grinder.
- Do not move the appliances during operation
- Do not overload Mixie. When hot air emanates from the opening on the Top Cap, switch off the Mixie and wait for 3-5 minutes, before re-starting.
- Do not add solid ingredients in the jar when the motor is running
- Never touch the mixer grinder switch knob or plugs with wet hands.
- Do not forcefully disassemble the jars after usage.
- Do not run the appliance for more than 3 min continuously
- This appliance should not be used 2000metres above the sea level.
- Never load the jar with ingredients beyond the maximum level or below the blade. Also never load nonfood hard substances (Check more for standard recipes details).

- Have sufficient place around the Mixer Grinder to keep the various items and Ingredients required.

3.4 Cleaning Safety:

- Handle the blades carefully. Wash them under running water and do not rub by hand.
- To protect against electrical hazards, do not immerse any part of the Mixer Grinder like base, plug or cord in water or any other liquids.
- Wipe the surface with soft wet cloth.
- Do not clean the mixer accessories using a dishwasher. Always rinse under tap water.

3.5 Children Safety:

- Always disconnect the plug from the power outlet before cleaning.
- The appliance is not intended for use by persons (including children) with reduced physical, sensory or mental capabilities or lack of experience and knowledge, unless they have been given supervision or instruction concerning use of the appliance by a person responsible for their safety. Children should be supervised to ensure that they do not play with the appliance (Fig1).
- Teach children to be aware of danger in the kitchen, warn them of the dangers of reaching up to areas where they cannot see properly or should not be reaching.

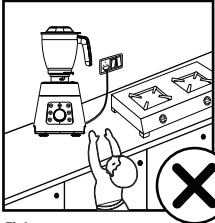

Fig1

3.6 Other Safety Guidelines:

- Always unplug the appliance after use.
- Switch off and unplug the appliance from the power supply before:
  - Removing it from the stand, changing accessories or approaching parts that move in use.
  - Assembling, disassembling or cleaning it.
  - After use or when It is left unattended
  - Before reaching into the jar with your fingers or an object e.g. spatula.
  - When not in use.
- Do not pull the cord to disconnect; instead grasp the plug and pull to disconnect.
- Do not drop base unit or jar.
- Wear and tear of gasket or overloading may cause the spillage.
- Never use accessories or parts not recommended by Philips or those made by other manufacturers else the warranty will become invalid.
- Do not use the jars as storage containers.
- In the event of any failure of your Mixer Grinder, do not attempt to repair it at home or allow any unauthorized person to do so. Ensure repairs are carried out only at an authorized Philips Consumer Centre.

3.7 Electrical Safety:

- Check that the voltage on the rating plate of your appliance corresponds with your house electricity supply which must be A.C. (Alternating Current).
- If the socket outlets in your home are not suitable for the plug supplied with this appliance, the plug should be removed and the appropriate one fitted.

**WARNING :** If plug is detached from the mains lead, it must be destroyed. As a plug with uncovered flexible cord is hazardous if engaged to a live socket.

4.0 Assembly and operating the product

Unpack the accessories carefully as the blades are sharp. Before the first use, thoroughly clean parts that come in contact with food.

Before you start your appliance:

- When operating the Grinder for the first time or after long storage or when the Mixie has been shifted over a long distance, rotate the Motor Shaft by hand through the Motor Coupler, until the Motor Shaft rotates freely.
- Make sure the blade unit is securely fastened, the lid is properly assembled to the jar, and jars are properly placed and locked in base unit before you use the appliance.
- Always ensure that speed selector knob is at 'OFF' position before using accessories.

4.1 Introduction to Preset menu

Function	Symbol	Description
Pulse		Press once for single pulse. Recommended to use pulse function before wet/chutney grinding
Ice crushing		Use to convert normal sized ice cubes right from fridge into finely crushed form for preparing ice golas, cocktails, mock tails, frappes etc.
Chicken mincing*		Used to mince boneless chicken/ meat into a granular form for preparing kebabs, patties, vadas, deep fried snacks etc.
Vegetable mincing		Used to mince hard vegetables such as carrot, beetroot into a granular form for preparing koftas, deep fried snacks etc.
Smoothies/ milkshakes		A combination of different speeds for preparing uniform and frothy smoothies and milkshakes ( <i>Explore recipe book for interesting recipes</i> )
Sauces/ Dips		A combination of different speeds for preparing different kind of continental, Arabic, Indian sauces/ dips with uniform consistency and texture ( <i>Explore recipe book for interesting recipes</i> )
Cancel		Used to stop/ cancel the preset function in between

\*Note: This function can be repeated again or Pulse is pressed to get a desired consistency for mutton mincing

4.1.1 How to assemble preset jar

- Fix the blade inside the jar and rotate it in anticlockwise direction using spatula while holding the coupler firmly. (As shown in illustration)
- Fill all ingredients and liquid into the preset jar upto the MAX line ( in case of meat/chicken and ice cubes, follow the recipe book or standard recipe table)
- Close the lid and place it in base unit.
- After blending/grinding, remove the jar from base unit, switch OFF the appliance, tilt the jar to remove the ingredients using spatula or spoon.
- Use the same procedure given above to remove the blade (Rotate it in clockwise direction) for easy cleaning and maintainance.



4.1.2 Important instructions for preset jar:

- Any jars can be used in preset menu. But only preset jar will give optimum and desired results.**
- Don't over fill the jar. Make sure that ingredients and liquid reach no higher than the MAX line. Do not exceed the maximum quantities and processing times indicated in the relevant table.
- Only use plastic and wooden utensils with this product to avoid scratching. Never use any accessories or parts from other manufacturers or that Philips does not specifically recommend if you use such accessories or parts, your product warranty becomes invalid.
- Handle the blades with care as they are sharp. Use caution when cleaning the blades.
- If food sticks to the wall of the blender jar, switch off the appliance and unplug it.
- Carefully remove the blade with spatula then use a wooden spatula to remove the food from the wall.
- Do not use if the jar is chipped or cracked.
- Never fill the jars with ingredients hotter than 40°C.
- Cut large ingredients into small pieces of approx. 2cm before processing.

**Refer Recipe book given for specialized recipes for all preset menus**

4.1.3 Important Operational guidelines while using preset menu

Step1		Keep the switch knob in OFF condition
Step2		Place the preset jar and lock it properly in clockwise direction. <b>Preset function will work only if the jar is fixed properly</b>
Step3		Switch on the main power and rotate knob clockwise to ON

Step4		All LED for preset functions will glow in white color. 'P' (Pulse) will glow in green and 'X' (cancel) will glow in red color.
Step5		To pulse, Press the 'P' (pulse) button, LED only for 'P' will glow and operation will start. While using 'P' operation, motor will run for maximum 5 seconds continuously. One press will pulse one time.
Step6		To use preset function, press any preset function after step 4. Eg, For mincing chicken/Meat , press chicken mincing function. Now the chicken mincing LED will glow in white and X (Cancel) will glow in red color. Once the function is complete, the respective preset menu will blink in green color 5 times and all LED starts glowing. After which jar can be removed.
Step7		If required, pause the operation to check the consistency or add the ingredients, press the same preset function again. Particular operation will stop and the corresponding LED will keep blinking in white and green color.
Step8		To continue the operation press the same corresponding function again, it will continue the process from where it was stopped and LED will turn to white.

**CAUTION**  
During the preset function, if jar is opened or not fixed properly, the corresponding preset function will pause, to continue the process, you need to fix the jar and press the same function again.

DANGER

Lid or jar should not be opened while running the application

4.2.1 How to assemble Blend and Carry Jar:

- Place the Blend and the carry bottle on dry place vertically
- Fill ingredients and liquid into the bottle up to the MAX line.
- Place the blade holder assembly on the blend and carry bottle, then place housing (jar collar) and rotate in clockwise direction to tighten like a bottle cap.
- Invert the bottle, place it on the base unit and blend.
- After blending, remove the jar by holding the jar collar, invert the bottle, and remove the jar collar in anticlockwise direction, followed by blade and replace it with cap.

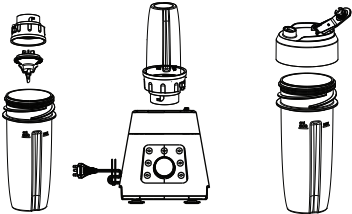

Blade	Function
	Dry blade is used for dry grinding of spices and masalas like Garam masala, turmeric, Onion paste, tomato puree etc
	Wet blade is suitable for grinding rice batter, dhal batter

4.2.2 Important instructions for Blend and Carry Jar

- Do not over fill the bottle/jar. Make sure that ingredients and liquid reach no higher than the MAX line. Do not exceed the maximum quantities and processing times indicated in the relevant table
- Only use plastic and wooden utensils with this product to avoid scratching. Never use any accessories or parts from other manufacturers or that Philips does not specifically recommend if you use such accessories or parts, your product warranty becomes invalid.
- Handle the blades with care as they are sharp. Use caution when cleaning the blades.
- If food sticks to the wall of the blender jar, switch off the appliance and unplug it. Then use a wooden spatula to remove the food from the wall.
- Do not use if the bottle is chipped or cracked.
- Never fill the jars with ingredients hotter than 40°C.
- Cut large ingredients into small pieces of approx. 2cm before processing.
- While adding ingredients in bottle, add hard vegetables first then add soft vegetables and fill enough water for hassle free blending.
- Refer healthy smoothie recipes given separately for Blend and Carry bottle.

4.2.3 Important Operational guidelines while using blend and carry

- Before turning ON the appliance, please check if jar and lid are properly locked and rotary knob is on 'OFF' position.
- Switch ON the main power and rotate the knob clockwise to ON position. All LED will glow in white.
- Use speed III for blending. At this position, all LED will turn off.
- Once done, turn the knob to OFF position.

4.3 How to assemble SS multipurpose and chutney jars to the base unit

- Fix the blade inside the jar and rotate it in anticlockwise direction using spatula while holding the coupler firmly. ( As shown in illustration)
- Fill the ingredients above the blade level.
- Place the Jar assembly with the lid on the base unit
- Rotate clockwise
- Switch ON the main power and rotate the knob clockwise to ON position. All LED will glow in white.
- Use speed I,II, III for grinding. At this position, all LED will turn off.
- Recommended speed: for Wet/dry/chutney grinding/blending, liquidizing, pureeing, start with Speed I and Speed II for 10-15 sec and continue on Speed III till you finish grinding
- During manual operation, motor will run for max. 5 min continuously at any speed.

5.0 Preset/Switch knob panel:

**Pulse and cancel button will keep on blinking during the following scenarios which indicates the "Error"**

Error indication scenarios	How to correct
After continuously running for 5 min, Motor will stop automatically and appliance will go to error mode.	Turn the switch knob to OFF condition, Properly fix the jar then resume normal grinding.
Jar is suddenly removed while grinding in normal condition	
Turning the knobs to 1,2,3 positions without jar	Turn the switch knob to OFF condition. Switch off the mains. Properly fix the jar again and switch ON the mains. Then resume normal grinding.
Power resumes after sudden power failure while the appliance is running(Preset and manual mode)	

6.0 Cleaning and maintenance:

**Cleaning the Mixer Body and Top Cap**

- Remove the mains plug from wall socket
- Clean body, top cap and preset menu panel with a damp cloth and wipe dry.

8.0 Standard recipes

Jar capacity	Recipe	Quantity	Speed	Time
1.5L Multi-purpose jar	Urad dal (Wet blade)	200g + 450ml water soaked for 6-8hrs. Add 50ml water	P,1,2,3	5.0 min
	Rice batter (Wet blade)	250g + 282ml water soaked for 6-8hrs. Add 50ml water	P,1,2,3	5.0 min
	Wet masala (Wet blade)	150g onion +150 g tomato	P,1,2,3	2.0 min
	Garam masala (Dry blade)	250g of assorted spices, roasted and cooled	P,1,2,3	2.0 min
	Turmeric (Dry blade)	150g, roasted and cooled	P,1,2,3	1.30 min
0.5L Chutney jar	Coconut Chutney	60g fresh coconut, coriander leaves, ginger, cumin, green chilli, salt + add 30 ml water gradually	P,1,2,3	1.30 min
	Ginger garlic paste	50g ginger + 50g garlic	P,1,2,3	1.30 min
1.0L Blend and carry jar	Banana/ Cheeku/ Strawberry Milkshake	300ml milk +100g cut fruits +3 tablespoon sugar	P,1,2,3	1.00 min
1.0L preset jar	Nuts cream smoothie	75g assorted dry fruits and nuts + 300 ml milk + 2 scoops ice cream	Smoothie/ Milkshake	-
	Minced meat	Boneless meat/Chicken – 300 g (Sinews removed)	Meat mincing	-
	Ice crushing	Small ice cubes right from freezer – 8-10 cubes	Ice crushing	-
Egg whites	Whisking eggs	This appliance is not suitable for whisking egg whites	NA	NA

9.0 Overload protection

Mixer Grinder is fitted with an automatic power shut off mechanism to avoid motor burning due to overloading. If mixer stops due to over loading, the red knob at the bottom will come out. Switch off the mixer. Remove excess load from the jar. Wait for 3-5 minutes. Press red knob using a pointed object and start mixer again

Please note

- This mixer is intended for household only.
- Parts illustrated in this use and care manual are indicative only.
- Parts provided the product may differ with illustration.
- Specifications are subject to change without notice.

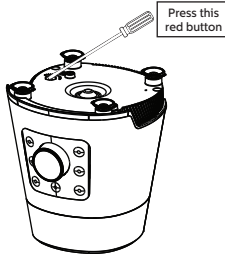

\*rated max