

Dell S3422DWG

User's Guide

Monitor Model: S3422DWG
Regulatory Model: S3422DWGc





NOTE: A NOTE indicates important information that helps you make better use of your computer.



CAUTION: A CAUTION indicates potential damage to hardware or loss of data if instructions are not followed.



WARNING: A WARNING indicates a potential for property damage, personal injury, or death.

Copyright © 2021-2023 Dell Inc. or its subsidiaries. All rights reserved. Dell, EMC, and other trademarks are trademarks of Dell Inc. or its subsidiaries. Other trademarks may be trademarks of their respective owners.

2023 – 03

Rev. A05



Contents

- Safety instructions. 6**
- About your monitor 7**
 - Package contents 7
 - Product features 8
 - Identifying parts and controls 10
 - Front view 10
 - Back view 11
 - Side view. 12
 - Bottom view 12
- Monitor specifications 15**
 - Resolution specifications 17
 - Supported video modes 17
 - Preset display modes 18
 - Electrical specifications. 26
 - Physical characteristics. 27
 - Environmental characteristics 28
 - Plug and play capability 29
- LCD monitor quality and pixel policy 29**
- Ergonomics. 30**
- Handling and moving your display. 32**
- Maintenance guidelines 33**
 - Cleaning your monitor. 33



Setting up the monitor 34

 Connecting the stand 34

 Connecting your monitor 35

 Connecting the HDMI, DP 1.4 and USB 3.0 cable 36

 Organizing cables 36

 Securing your monitor using Kensington (optional) . . . 37

 Removing the stand 38

 Wall mounting (optional) 39

Operating your monitor 40

 Power on the monitor 41

 Using the joystick control 41

 Joystick Description 42

 Using the rear-panel controls 42

 Using the On-Screen Display (OSD) menu 44

 Accessing the menu system 44

 OSD warning messages 55

 Setting up your monitor 58

 Setting the maximum resolution 58

 Using the tilt and vertical extension. 59

 Tilt Extension 59

 Vertical Extension 59

Troubleshooting 60

 Self-Test 60

 Built-in diagnostics 62



Common problems 64

Product-specific problems 67

Appendix. 68

Safety Instructions. 68

FCC notices (U.S. Only) and other regulatory information 68

Contacting Dell. 69



Safety instructions

 **CAUTION: Use of controls, adjustments, or procedures other than those specified in this documentation may result in exposure to shock, electrical hazards, and/or mechanical hazards.**

- Place the monitor on a solid surface and handle it carefully. The screen is fragile and can be damaged if dropped or hit sharply.
- Always be sure that your monitor is electrically rated to operate with the AC power available in your location.
- Keep the monitor in room temperature. Excessive cold or hot conditions can have an adverse effect on the liquid crystal of the display.
- Do not subject the monitor to severe vibration or high impact conditions. For example, do not place the monitor inside a car trunk.
- Unplug the monitor when it is going to be left unused for an extended period of time.
- To avoid electric shock, do not attempt to remove any cover or touch the inside of the monitor.



About your monitor



Package contents

Your monitor ships with the components shown below. Ensure that you have received all the components and see [Contacting Dell](#) for more information if something is missing.

 **NOTE: Some items may be optional and may not ship with your monitor. Some features or media may not be available in certain countries.**

	Monitor
	Stand riser
	Stand base
	Power cable (varies by countries)
	HDMI 2.0 cable

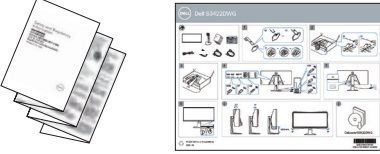

	USB 3.0 upstream cable (enables the USB ports on the monitor)
	DP1.4 Cable
	<ul style="list-style-type: none"> • Quick Setup Guide • Safety and Regulatory Information

Product features

The Dell S3422DWG monitor has an active matrix, Thin-Film Transistor (TFT), Liquid Crystal Display (LCD), anti-static, and LED backlight. The monitor features include:

- 86.42 cm (34.0 in.) viewable area display (measured diagonally). 3440 x 1440 resolution, with full-screen support for lower resolutions.
- Supports the high refresh rates of 100 Hz and 144 Hz and a rapid response time of 1 ms in **MPRT** mode.

 **NOTE: 1 ms is achievable in the MPRT mode to reduce visible motion blur and increased image responsiveness. However, this may introduce some slight and noticeable visual artifacts into the image. As every system setup and every gamer’s needs are different, we recommend that users experiment with the different modes to find the setting that is right for them.**

- AMD FreeSync™ Premium Pro for Tear free, stutter free, low latency HDR gaming.
- Color gamut of sRGB 99% and DCI-P3 90%.
- VESA DisplayHDR™ 400.



- Enabled with gaming console VRR supportability.
- Digital connectivity with DP and HDMI.
- Equipped with one SuperSpeed USB 5 Gbps (USB 3.2 Gen1) Type B upstream port, one SuperSpeed USB 5 Gbps (USB 3.2 Gen1) Type-A downstream charging port, and three SuperSpeed USB 5 Gbps (USB 3.2 Gen1) Type-A downstream ports.
- Plug and play capability if supported by your computer.
- On-Screen Display (OSD) adjustments for ease of setup and screen optimization.
- Removable stand and Video Electronics Standards Association (VESA™) 100 mm mounting holes for flexible mounting solutions.
- Tilt, swivel and height adjustment capabilities.
- Security-lock slot.
- ≤0.3 W in the Standby Mode
- Supports Dell Display Manager.
- Optimize eye comfort with a flicker-free screen and **Comfortview** feature which minimizes blue light emission.

⚠ WARNING: The possible long-term effects of blue light emission from the monitor may cause damage to the eyes, including eye fatigue, digital eye strain, and so on. ComfortView feature is designed to reduce the amount of blue light emitted from the monitor to optimize eye comfort.

⚠ WARNING: If provided with a 3-pin attachment plug on the power cord, plug the cord into a grounded (earthed) 3-pin outlet. Do not disable the power cord grounding pin, for example, by attaching a 2-pin adapter. The grounding pin is an important safety feature.

⚠ WARNING: Please confirm the distribution system in building installation shall provide the circuit breaker rated 120/240V, 20A (maximum).



Identifying parts and controls

Front view

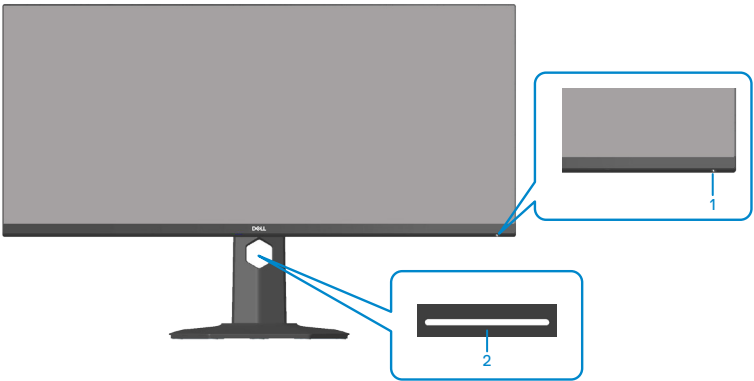

Label	Description	Use
1	Power On/Off button	<p>Use the power button to turn the monitor on and off.</p> <p>Solid white light indicates the monitor is turned on and functioning normally.</p> <p>Blinking white light indicates the monitor is in Standby Mode.</p>
2	Downlights	<p>When the monitor is completely set up, tap the touch sensor to turn the downlights on or off. (see Downlights).</p> <p>This feature can be activated or deactivated via the OSD (see Downlight).</p> <p> NOTE: On monitors that are manufactured from July 2021, the downlights can be turned on or off only using the OSD menu.</p>



Back view

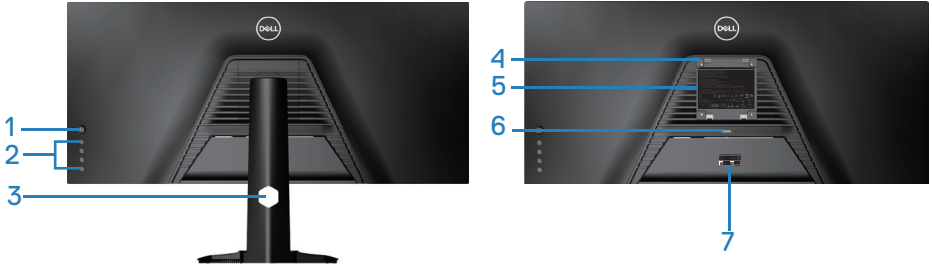

Back View with monitor stand

Label	Description	Use
1	Joystick	Use it to control the OSD menu.
2	Function buttons	Press the function buttons to adjust items in the OSD menu. (For more information, see Operating your monitor)
3	Cable management slot	Organizes the cables when the cables are routed through the slot.
4	VESA mounting holes (behind VESA cover)	VESA mounting holes (100 mm x 100 mm). Use for Wall mounting the monitor through a VESA-compatible wall mount kit.
5	Regulatory information label	Lists the regulatory approvals.
6	Stand release button	Releases stand from monitor.
7	Regulatory label (including Barcode serial number and Service Tag label)	Lists the regulatory approvals. Refer to this label if you need to contact Dell for technical support. The Service Tag is a unique alphanumeric identifier that enables Dell service technicians to identify the hardware components in your computer and access warranty information.



Side view



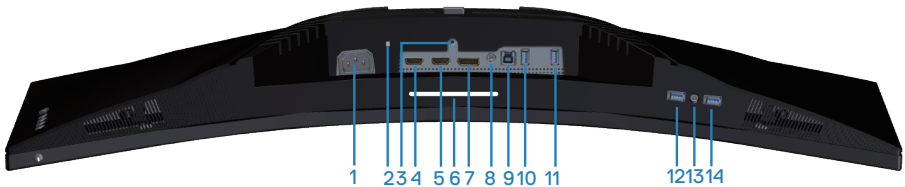

Bottom view



Bottom view without monitor stand

Label	Description	Use
1	Power connector	Connect the power cable (shipped with your monitor).
2	Security-lock slot	Secure your monitor using a security lock (purchased separately) to prevent unauthorized movement of your monitor.
3	Stand lock feature	Lock the stand to the monitor using a M3 x 6 mm screw (screw not included).
4	HDMI 1 2.0 port	Connect to your computer using a HDMI cable.
5	HDMI 2 2.0 port	Connect to your computer using a HDMI cable.

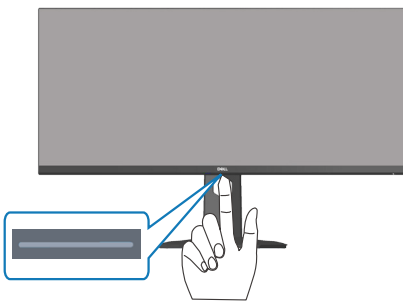

6	Downlights	<p>When the monitor is completely set up, tap the touch sensor to turn the downlights on or off.</p> <p>The factory setting is on, so the downlights are active if the power cable is connected.</p> <p> NOTE: On monitors that are manufactured from July 2021, the downlights can be turned on or off only using the OSD menu.</p> 
7	DP 1.4 port	Connect to your computer using a DP cable.
8	Audio line out port	Connect to an external speaker or a sub-woofer (purchased separately).*
9	5 Gbps (USB 3.2 Gen1) Type-B upstream port	Connect the USB cable from this port to your computer to enable the USB ports on your monitor.
10	SuperSpeed USB 5 Gbps (USB 3.2 Gen1) Type-A downstream port (3)	<p>Connect your USB 3.2 Gen1 (5 Gbps) device.*</p> <p> NOTE: To use these ports, you must connect the USB cable (shipped with your monitor) to the USB-upstream port on the monitor and to your computer.</p>
11	SuperSpeed USB 5 Gbps (USB 3.2 Gen1) Type-A downstream port (3)	<p>Connect your USB 3.2 Gen1 (5 Gbps) device.*</p> <p> NOTE: To use these ports, you must connect the USB cable (shipped with your monitor) to the USB-upstream port on the monitor and to your computer.</p>



12	SuperSpeed USB 5 Gbps (USB 3.2 Gen1) Type-A downstream port with Power Charging	Connect to your computer to charge your USB device.
13	Headphone out port	Connect to the headphone.
14	SuperSpeed USB 5 Gbps (USB 3.2 Gen1) Type-A downstream port (3)	Connect your USB 3.2 Gen1 (5 Gbps) device.*  NOTE: To use this port, you must connect the USB upstream cable (shipped with your monitor) between the monitor and the computer.

*To avoid signal interference, when a wireless USB device has been connected to a USB downstream port, it is not recommended to connect any other USB devices to the adjacent port.



Monitor specifications

Model	S3422DWG
Screen type	Active matrix-TFT LCD
Panel type	Vertical Alignment
Viewable image	
Diagonal	864.2 mm (34.0 in.)
Horizontal, Active Area	797.2 mm (31.19 in.)
Vertical, Active Area	333.7 mm (13.14 in.)
Total Area	266048.26 mm ² (412.38 in. ²)
Native resolution and refresh rate	3440 x 1440 at 100 Hz (HDMI1 and HDMI2) 3440 x 1440 at 144 Hz (DP)
Pixel pitch	0.23175 mm x 0.23175 mm
Pixel per inch (PPI)	109
Viewing angle	
Horizontal	178° (typical)
Vertical	178° (typical)
Luminance output	400 cd/m ² (typical)
Contrast ratio	3000:1 (typical)
Faceplate coating	Anti-glare with 3H hardness, Haze 40%
Backlight	LED edgelight system
Response time	8 ms gray to gray in Fast Mode 4 ms gray to gray in Super Fast Mode 2 ms gray to gray in Extreme Mode* 1 ms gray to gray in MPRT Mode *The 2 ms gray-to-gray is achievable in the Extreme mode to reduce visible motion blur and increased image responsiveness. However this may introduce some slight and noticeable visual artifacts into the image. As every system setup and every user's needs are different modes to find the setting that is right for them.



Color depth	16.7 million colors
Color gamut	sRGB CIE 1931 99% DCI-P3 CIE 1976 90%
Connectivity	2 x HDMI 2.0 with HDCP 2.2 1 x DP 1.4 port 1 x USB 3.2 Gen1 (5 Gbps) upstream port 4 x USB 3.2 Gen1 (5 Gbps) downstream ports with BC1.2 charging at 2 A (maximum) 1 x Audio line out 1 x Headphone out
Bezel width (edge of monitor to active area)	
Top	8.45 mm
Left/Right	8.49 mm
Bottom	24.19 mm
Adjustability	
Height adjustable stand	100 mm
Tilt	-5° to 21°
Swivel	N/A
Slant Adjust	-4° to 4°
Dell display manager compatibility	Easy Arrange and other key features
Security	Security-lock slot (cable lock optional purchase)



Resolution specifications

Model	S3422DWG
Horizontal scan range	29 kHz to 200 kHz
Vertical scan range	48 Hz to 100 Hz (HDMI) 48 Hz to 144 Hz (DP)
Maximum preset resolution	3440 x 1440 at 144 Hz (DP) 3440 x 1440 at 100 Hz (HDMI)

Supported video modes

Model	S3422DWG
Video display capabilities (HDMI/DP)	480p, 480i(HDMI), 576p, 720p, 1080p, 576i(HDMI), 1080i(HDMI), 1440p, 2160p



Preset display modes

HDMI HDR Preset Display Modes

Display Mode	Horizontal Frequency (kHz)	Vertical Frequency (Hz)	Pixel Clock (MHz)	Sync Polarity (Horizontal / Vertical)
VESA,640 x 480	37.50	75.00	31.50	-/-
VESA,640 x 480	31.47	59.94	25.18	-/-
IBM,720 x 400	31.47	70.08	28.32	-/+
VESA,800 x 600	37.88	60.32	40.00	+/+
VESA,800 x 600	46.88	75.00	49.50	+/+
VESA,1024 x 768	48.36	60.00	65.00	-/-
VESA,1024 x 768	60.02	75.03	78.75	+/+
VESA,1152 x 864	67.50	75.00	108.00	+/+
VESA,1280 x 720	44.77	59.86	74.50	-/+
VESA,1280 x 800	49.31	59.91	71.00	+/+
VESA,1280 x 960	60.00	60.00	108.00	+/+
VESA,1280 x 1024	63.98	60.02	108.00	+/+
VESA,1280 x1024	79.98	75.02	135.00	+/+
VESA,1440 x 900	55.94	59.89	106.50	-/+
VESA,1680 x 1050	65.29	59.95	146.25	-/+
VESA,1920 x 1080	67.50	60.00	148.50	+/+
VESA,1920 x 1080	137.26	119.98	285.50	+/-
VESA,2560x1440	183.00	120.00	497.75	+/-
VESA,3440x1440	88.82	59.97	319.75	+/-
VESA,3440x1440	150.97	99.98	543.50	+/-



HDMI SDR Preset Display Modes

Display Mode	Horizontal Frequency (kHz)	Vertical Frequency (Hz)	Pixel Clock (MHz)	Sync Polarity (Horizontal / Vertical)
VESA,640 x 480	37.50	75.00	31.50	-/-
VESA,640 x 480	31.47	59.94	25.18	-/-
IBM,720 x 400	31.47	70.08	28.32	-/+
VESA,800 x 600	37.88	60.32	40.00	+/+
VESA,800 x 600	46.88	75.00	49.50	+/+
VESA,1024 x 768	48.36	60.00	65.00	-/-
VESA,1024 x 768	60.02	75.03	78.75	+/+
VESA,1152 x 864	67.50	75.00	108.00	+/+
VESA,1280 x 720	44.77	59.86	74.50	-/+
VESA,1280 x 800	49.31	59.91	71.00	+/+
VESA,1280 x 960	60.00	60.00	108.00	+/+
VESA,1280 x 1024	63.98	60.02	108.00	+/+
VESA,1280 x1024	79.98	75.02	135.00	+/+
VESA,1440 x 900	55.94	59.89	106.50	-/+
VESA,1680 x 1050	65.29	59.95	146.25	-/+
VESA,1920 x 1080	67.50	60.00	148.50	+/+
VESA,1920 x 1080	137.26	119.98	285.50	+/-
VESA,2560x1440	88.79	59.95	241.50	+/-
VESA,2560x1440	183.00	120.00	497.75	+/-
VESA,3440x1440	88.82	59.97	319.75	+/-
VESA,3440x1440	150.97	99.98	543.50	+/-



HDMI PIP Preset Display Modes

Display Mode	Horizontal Frequency (kHz)	Vertical Frequency (Hz)	Pixel Clock (MHz)	Sync Polarity (Horizontal / Vertical)
VESA,640 x 480	37.50	75.00	31.50	-/-
VESA,640 x 480	31.47	59.94	25.18	-/-
IBM,720 x 400	31.47	70.08	28.32	-/+
VESA,800 x 600	37.88	60.32	40.00	+/+
VESA,800 x 600	46.88	75.00	49.50	+/+
VESA,1024 x 768	48.36	60.00	65.00	-/-
VESA,1024 x 768	60.02	75.03	78.75	+/+
VESA,1152 x 864	67.50	75.00	108.00	+/+
VESA,1280 x 720	44.77	59.86	74.50	-/+
VESA,1280 x 800	49.31	59.91	71.00	+/+
VESA,1280 x 960	60.00	60.00	108.00	+/+
VESA,1280 x 1024	63.98	60.02	108.00	+/+
VESA,1280 x1024	79.98	75.02	135.00	+/+
VESA,1440 x 900	55.94	59.89	106.50	-/+
VESA,1680 x 1050	65.29	59.95	146.25	-/+
VESA,1920 x 1080	67.50	60.00	148.50	+/+
VESA,1920 x 1080	137.26	119.98	285.50	+/-
VESA,2560x1440	88.79	59.95	241.50	+/-
VESA,2560x1440	183.00	120.00	497.75	+/-
VESA,3440x1440	88.82	59.97	319.75	+/-
VESA,3440x1440	150.97	99.98	543.50	+/-



HDMI PBP Preset Display Modes

Display Mode	Horizontal Frequency (kHz)	Vertical Frequency (Hz)	Pixel Clock (MHz)	Sync Polarity (Horizontal / Vertical)
VESA,640 x 480	37.50	75.00	31.50	-/-
VESA,640 x 480	31.47	59.94	25.18	-/-
IBM,720 x 400	31.47	70.08	28.32	-/+
VESA,720x480	31.50	60.00	27.03	+/+
VESA,800 x 600	37.88	60.32	40.00	+/+
VESA,800 x 600	46.88	75.00	49.50	+/+
VESA,1024 x 768	48.36	60.00	65.00	-/-
VESA,1024 x 768	60.02	75.03	78.75	+/+
VESA,1152 x 864	67.50	75.00	108.00	+/+
VESA,1280 x 720	44.77	59.86	74.50	-/+
VESA,1280 x 800	49.31	59.91	71.00	+/+
VESA,1280 x 960	60.00	60.00	108.00	+/+
VESA,1280 x 1024	63.98	60.02	108.00	+/+
VESA,1280 x1024	79.98	75.02	135.00	+/+
VESA,1440 x 900	55.94	59.89	106.50	-/+
VESA,1680 x 1050	65.29	59.95	146.25	-/+
VESA,1720x1440	88.82	59.97	167.00	+/-
VESA,1720x1440	88.82	59.97	167.00	+/-



DP HDR Preset Display Modes

Display Mode	Horizontal Frequency (kHz)	Vertical Frequency (Hz)	Pixel Clock (MHz)	Sync Polarity (Horizontal / Vertical)
VESA,640 x 480	37.50	75.00	31.50	-/-
VESA,640 x 480	31.47	59.94	25.18	-/-
IBM,720 x 400	31.47	70.08	28.32	-/+
VESA,800 x 600	37.88	60.32	40.00	+/+
VESA,800 x 600	46.88	75.00	49.50	+/+
VESA,1024 x 768	48.36	60.00	65.00	-/-
VESA,1024 x 768	60.02	75.03	78.75	+/+
VESA,1152 x 864	67.50	75.00	108.00	+/+
VESA,1280 x 720	44.77	59.86	74.50	-/+
VESA,1280 x 800	49.31	59.91	71.00	+/+
VESA,1280 x 960	60.00	60.00	108.00	+/+
VESA,1280 x 1024	63.98	60.02	108.00	+/+
VESA,1280 x1024	79.98	75.02	135.00	+/+
VESA,1440 x 900	55.94	59.89	106.50	-/+
VESA,1680 x 1050	65.29	59.95	146.25	-/+
VESA,1920 x 1080	67.50	60.00	148.50	+/+
VESA,1920 x 1080	137.26	119.98	285.50	+/-
VESA,1920x1080	166.59	143.98	346.50	+/-
VESA,2560x1440	88.79	59.95	241.50	+/-
VESA,2560x1440	183.00	119.99	497.75	+/-
VESA,2560x 1440	222.15	143.97	604.25	+/-
VESA,3440x1440	88.82	59.97	319.75	+/-
VESA,3440x 1440	150.97	99.98	543.50	+/-
VESA,3440x1440	222.15	143.98	799.74	+/-



DP SDR Preset Display Modes

Display Mode	Horizontal Frequency (kHz)	Vertical Frequency (Hz)	Pixel Clock (MHz)	Sync Polarity (Horizontal / Vertical)
VESA,640 x 480	37.50	75.00	31.50	-/-
VESA,640 x 480	31.47	59.94	25.18	-/-
IBM,720 x 400	31.47	70.08	28.32	-/+
VESA,800 x 600	37.88	60.32	40.00	+/+
VESA,800 x 600	46.88	75.00	49.50	+/+
VESA,1024 x 768	48.36	60.00	65.00	-/-
VESA,1024 x 768	60.02	75.03	78.75	+/+
VESA,1152 x 864	67.50	75.00	108.00	+/+
VESA,1280 x 720	44.77	59.86	74.50	-/+
VESA,1280 x 800	49.31	59.91	71.00	+/+
VESA,1280 x 960	60.00	60.00	108.00	+/+
VESA,1280 x 1024	63.98	60.02	108.00	+/+
VESA,1280 x1024	79.98	75.02	135.00	+/+
VESA,1440 x 900	55.94	59.89	106.50	-/+
VESA,1680 x 1050	65.29	59.95	146.25	-/+
VESA,1920 x 1080	67.50	60.00	148.50	+/+
VESA,1920 x 1080	137.26	119.98	285.50	+/-
VESA,1920x1080	166.59	143.98	346.50	+/-
VESA,2560x1440	88.79	59.95	241.50	+/-
VESA,2560x1440	183.00	120.00	497.75	+/-
VESA,2560x 1440	222.15	143.97	604.25	+/-
VESA,3440x1440	88.82	59.97	319.75	+/-
VESA,3440x 1440	150.97	99.98	543.50	+/-
VESA,3440x1440	222.15	143.98	799.74	+/-



DP PIP Preset Display Modes

Display Mode	Horizontal Frequency (kHz)	Vertical Frequency (Hz)	Pixel Clock (MHz)	Sync Polarity (Horizontal / Vertical)
VESA,640 x 480	37.50	75.00	31.50	-/-
VESA,640 x 480	31.47	59.94	25.18	-/-
IBM,720 x 400	31.47	70.08	28.32	-/+
VESA,800 x 600	37.88	60.32	40.00	+/+
VESA,800 x 600	46.88	75.00	49.50	+/+
VESA,1024 x 768	48.36	60.00	65.00	-/-
VESA,1024 x 768	60.02	75.03	78.75	+/+
VESA,1152 x 864	67.50	75.00	108.00	+/+
VESA,1280 x 720	44.77	59.86	74.50	-/+
VESA,1280 x 800	49.31	59.91	71.00	+/+
VESA,1280 x 960	60.00	60.00	108.00	+/+
VESA,1280 x 1024	63.98	60.02	108.00	+/+
VESA,1280 x1024	79.98	75.02	135.00	+/+
VESA,1440 x 900	55.94	59.89	106.50	-/+
VESA,1680 x 1050	65.29	59.95	146.25	-/+
VESA,1920 x 1080	67.50	60.00	148.50	+/+
VESA,1920 x 1080	137.26	119.98	285.50	+/-
VESA,1920x1080	166.59	143.98	346.50	+/-
VESA,2560x1440	88.79	59.95	241.50	+/-
VESA,2560x1440	183.00	120.00	497.75	+/-
VESA,2560x 1440	222.15	143.97	604.25	+/-
VESA,3440x1440	88.82	59.97	319.75	+/-
VESA,3440x 1440	150.97	99.98	543.50	+/-



DP PBP Preset Display Modes

Display Mode	Horizontal Frequency (kHz)	Vertical Frequency (Hz)	Pixel Clock (MHz)	Sync Polarity (Horizontal / Vertical)
VESA,640 x 480	37.50	75.00	31.50	-/-
VESA,640 x 480	31.47	59.94	25.18	-/-
IBM,720 x 400	31.47	70.08	28.32	-/+
VESA,720x480	31.50	60.00	27.03	+/+
VESA,800 x 600	37.88	60.32	40.00	+/+
VESA,800 x 600	46.88	75.00	49.50	+/+
VESA,1024 x 768	48.36	60.00	65.00	-/-
VESA,1024 x 768	60.02	75.03	78.75	+/+
VESA,1152 x 864	67.50	75.00	108.00	+/+
VESA,1280 x 720	44.77	59.86	74.50	-/+
VESA,1280 x 800	49.31	59.91	71.00	+/+
VESA,1280 x 960	60.00	60.00	108.00	+/+
VESA,1280 x 1024	63.98	60.02	108.00	+/+
VESA,1280 x1024	79.98	75.02	135.00	+/+
VESA,1440 x 900	55.94	59.89	106.50	-/+
VESA,1680 x 1050	65.29	59.95	146.25	-/+
VESA,1720x1440	88.82	59.97	167.00	+/-
VESA,1920 x 1080	67.50	60.00	148.50	+/+

 **NOTE: This monitor supports AMD FreeSync™ Premium Pro Technology.**



Electrical specifications

Model	S3422DWG
Video input signals	HDMI 2.0 (HDCP), 600 mV for each differential line, 100 ohm input impedance per differential pair DP 1.4, 600 mV for each differential line, 100 ohm input impedance per differential pair
AC input voltage/ frequency/current	100 VAC to 240 VAC / 50 Hz or 60 Hz \pm 3 Hz / 1.6A (max.)
Inrush current	120 V: 30 A (Max.) at 0°C (cold start) 240 V: 60 A (Max.) at 0°C (cold start)
Power Consumption	0.2 W (Off Mode) ¹ 0.3 W (Standby Mode) ¹ 29.9 W (On Mode) ¹ 90 W (Max) ² 31 W (Pon) ³ 96.4 kWh (TEC) ³

¹ As defined in EU 2019/2021 and EU 2019/2013.

² Max brightness and contrast setting with maximum power loading on all USB ports.

³ Pon: Power consumption of On Mode measured with reference to Energy Star test method.

TEC: Total energy consumption in kWh measured with reference to Energy Star test method.

This document is informational only and reflects laboratory performance. Your product may perform differently, depending on the software, components and peripherals you ordered and shall have no obligation to update such information. Accordingly, the customer should not rely upon this information in making decisions about electrical tolerances or otherwise. No warranty as to accuracy or completeness is expressed or implied.



Physical characteristics

Model	S3422DWG
Signal cable type	<ul style="list-style-type: none">• Digital: HDMI, 19 pins• Universal Serial Bus: USB, 9 pins• Digital: DisplayPort, 20 pins
Dimensions (with stand)	
Height (extended)	527.31 mm (20.76 in.)
Height (compressed)	427.31 mm (16.82 in.)
Width	807.90 mm (31.81 in.)
Depth	237.61 mm (9.35 in.)
Dimensions (without stand)	
Height	366.36 mm (14.42 in.)
Width	807.90 mm (31.81 in.)
Depth	85.81 mm (3.38 in.)
Stand dimensions	
Height	420.30 mm (16.55 in.)
Width	284.56 mm (11.20 in.)
Depth	237.61 mm (9.35 in.)
Weight	
Weight with packaging	14.95 kg (32.95 lb.)
Weight with stand assembly and cables	10.38 kg (22.88 lb.)
Weight without stand assembly (no cables)	7.71 kg (16.99 lb.)
Weight of stand assembly	2.35 kg (5.11 lb.)
Front-frame gloss	Black frame 2-4 gloss units



Environmental characteristics

Model	S3422DWG
Compliant Standards	
<ul style="list-style-type: none">RoHS-compliantBFR/PVC free monitor (excluding external cables)Arsenic-free glass and Mercury-free for the panel onlyEnergy Gauge shows the energy level being consumed by the monitor in real time.	
Temperature	
Operating	0°C to 40°C (32°F to 104°F)
Non-operating	<ul style="list-style-type: none">Storage: -20°C to 60°C (-4°F to 140°F)Shipping: -20°C to 60°C (-4°F to 140°F)
Humidity	
Operating	10% to 80% (non-condensing)
Non-operating	<ul style="list-style-type: none">Storage 10% to 90% (non-condensing)Shipping 10% to 90% (non-condensing)
Altitude	
Operating (maximum)	5,000 m (16,400 ft)
Non-operating (maximum)	12,192 m (40,000 ft)
Thermal dissipation	<ul style="list-style-type: none">307.29 BTU/hour (maximum)109.26 BTU/hour (typical)



Plug and play capability

You can install the monitor in any Plug and Play-compatible system. The monitor automatically provides the computer system with its Extended Display Identification Data (EDID) using Display Data Channel (DDC) protocols so the system can configure itself and optimize the monitor settings. Most monitor installations are automatic, you can select different settings if desired. For more information about changing the monitor settings, see [Operating your monitor](#).

LCD monitor quality and pixel policy

During the LCD Monitor manufacturing process, it is not uncommon for one or more pixels to become fixed in an unchanging state which are hard to see and do not affect the display quality or usability. For more information on Dell Monitor Quality and Pixel Policy, see Dell Support site at www.dell.com/support/monitors



Ergonomics

 **CAUTION: Improper or prolonged usage of keyboard may result in injury.**

 **CAUTION: Viewing the monitor screen for extended periods of time may result in eye strain.**

For comfort and efficiency, observe the following guidelines when setting up and using your computer workstation:

- Position your computer so that the monitor and keyboard are directly in front of you as you work. Special shelves are commercially available to help you correctly position your keyboard.
- To reduce the risk of eye strain and neck/arm/back/shoulder pain from using the monitor for long periods of time, we suggest you to:
 1. Set the distance of the screen between 20 to 28 in. (50 - 70 cm) from your eyes.
 2. Blink frequently to moisten your eyes or wet your eyes with water after prolonged usage of the monitor.
 3. Take regular and frequent breaks for 20 minutes every two hours.
 4. Look away from your monitor and gaze at a distant object at 20 feet away for at least 20 seconds during the breaks.
 5. Perform stretches to relieve tension in the neck, arm, back, and shoulders during the breaks.
- Make sure that the monitor screen is at eye level or slightly lower when you are sitting in front of the monitor.
- Adjust the tilt of the monitor, its contrast, and brightness settings.
- Adjust the ambient lighting around you (such as overhead lights, desk lamps, and the curtains or blinds on nearby windows) to minimize reflections and glare on the monitor screen.
- Use a chair that provides good lower-back support.
- Keep your forearms horizontal with your wrists in a neutral, comfortable position while using the keyboard or mouse.
- Always leave space to rest your hands while using the keyboard or mouse.
- Let your upper arms rest naturally on both sides.
- Ensure that your feet are resting flat on the floor.



- When sitting, make sure that the weight of your legs is on your feet and not on the front portion of your seat. Adjust your chair's height or use a footrest if necessary to maintain a proper posture.
- Vary your work activities. Try to organize your work so that you do not have to sit and work for extended periods of time. Try to stand or get up and walk around at regular intervals.
- Keep the area under your desk clear of obstructions and cables or power cords that may interfere with comfortable seating or present a potential trip hazard.

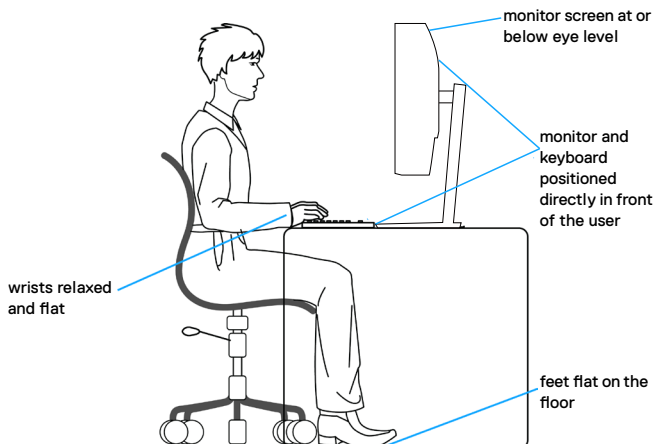

Handling and moving your display

To ensure the monitor is handled safely when lifting or moving it, follow the guidelines mentioned below:

- Before moving or lifting the monitor, turn off your computer and the monitor.
- Disconnect all cables from the monitor.
- Place the monitor in the original box with the original packing materials.
- Hold the bottom edge and the side of the monitor firmly without applying excessive pressure when lifting or moving the monitor.

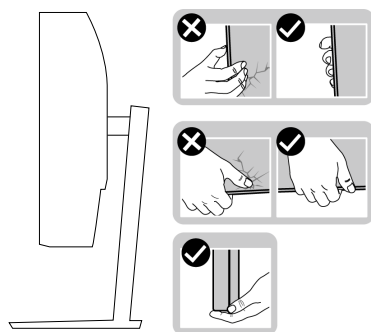

- When lifting or moving the monitor, ensure the screen is facing away from you and do not press on the display area to avoid any scratches or damage.

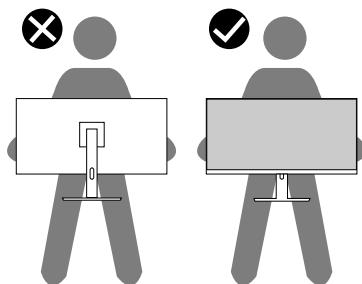

- When transporting the monitor, avoid any sudden shock or vibration to it.
- When lifting or moving the monitor, do not turn the monitor upside down while holding the stand base or stand riser. This may result in accidental damage to the monitor or cause personal injury.



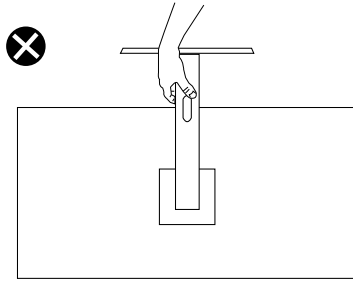

Maintenance guidelines

Cleaning your monitor

- ⚠ **WARNING:** Before cleaning the monitor, unplug the monitor power cable from the electrical outlet.
- ⚠ **CAUTION:** Read and follow the [Safety Instructions](#) before cleaning the monitor.

For best practices, follow the instructions in the list below while unpacking, cleaning or handling your monitor:

- To clean your screen, lightly dampen a soft, clean cloth with water. If possible, use a special screen-cleaning tissue or solution suitable for the anti-static coating. Do not use benzene, thinner, ammonia, abrasive cleaners or compressed air.
- Use a lightly-dampened cloth to clean the monitor. Avoid using detergent of any kind as some detergents leave a milky film on the monitor.
- If you notice white powder when you unpack your monitor, wipe it off with a cloth.
- Handle your monitor with care as the black-colored monitor may get scratched and show white scuff marks.
- To help maintain the best image quality on your monitor, use a dynamically changing screen saver and turn off your monitor when not in use.



Setting up the monitor

Connecting the stand

 **NOTE:** The stand is detached when the monitor is shipped from the factory.

 **NOTE:** The following procedure is applicable for the stand that shipped with your monitor. If you are connecting a third-party stand, see the documentation that shipped with the stand.

To attach the monitor stand:

1. Follow the instructions on the flaps of carton to remove the stand from the top cushion that secures it.
2. Connect the stand base to the stand riser.
3. Open the screw handle on the stand base and tighten the screw to secure the stand riser to the stand base.
4. Close the screw handle.

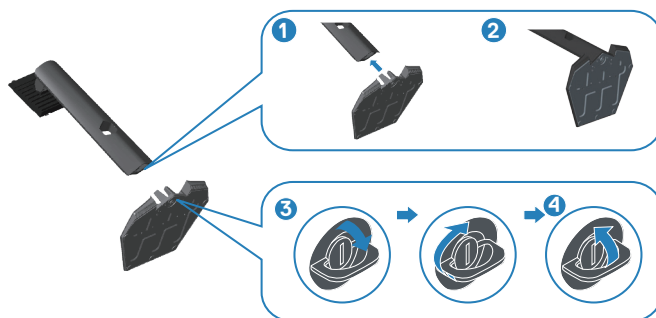



5. Slide the tabs on the stand assembly into the slots on the monitor and press the stand assembly down to snap it into place.

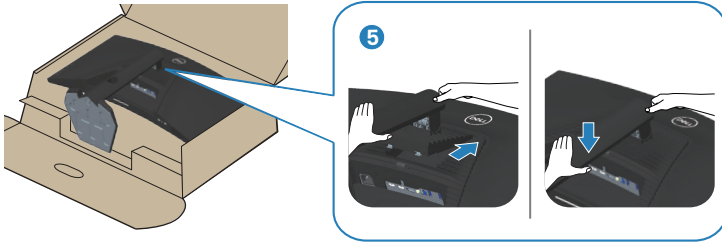



6. Place the monitor upright.

Connecting your monitor

-  **WARNING:** Before you begin any of the procedures in this section, follow the [Safety Instructions](#).
-  **NOTE:** Do not connect all cables to the computer at the same time. It is recommend to route the cables through the cable-management slot before you connect them to the monitor.

To connect your monitor to the computer:

1. Turn off your computer and disconnect the power cable.
2. Connect the HDMI or DP 1.4 cable from your monitor to the computer.
3. Connect the USB upstream cable (shipped with your monitor) to an appropriate USB 3.0 port on your computer. (See [Bottom view](#) for details.)
4. Connect the USB 3.0 peripherals to the downstream USB 3.0 ports on the monitor.



Connecting the HDMI, DP 1.4 and USB 3.0 cable

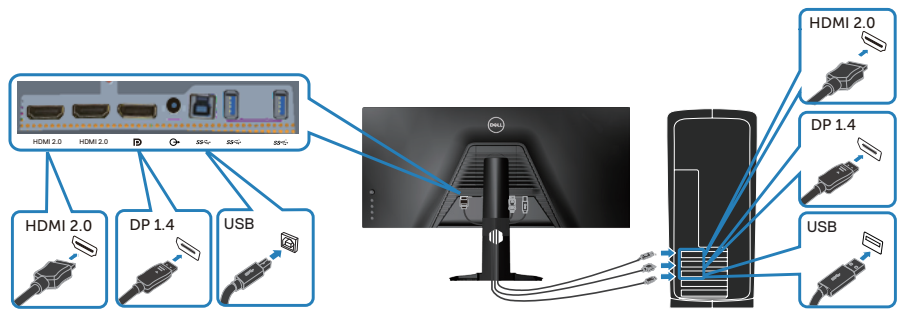

5. Connect the power cables from your computer and monitor into a wall outlet.

Organizing cables

Use the cable-management slot to route the cables connected to your monitor.

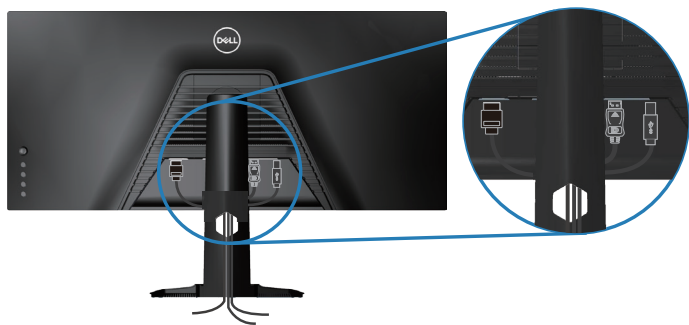

Securing your monitor using Kensington (optional)

The security lock slot is located at the bottom of the monitor. (See [Security lock slot](#))

For more information on using the Kensington (purchased separately), see the documentation that is shipped with the lock.

Secure your monitor to a table using the Kensington security lock.

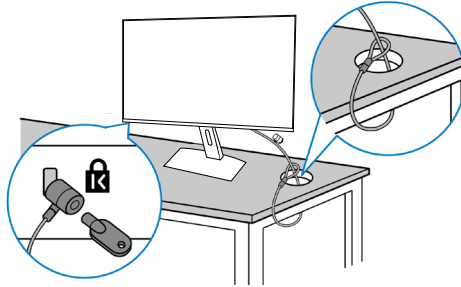

 **NOTE:** The image is for the purpose of illustration only. Appearance of the lock may vary.



Removing the stand

 **NOTE:** To prevent scratches on the screen when removing the stand, ensure that the monitor is placed on a soft and clean surface.

 **NOTE:** The following procedure is applicable only for the stand that shipped with your monitor. If you are connecting a third-party stand, see the documentation that shipped with the stand.

To remove the stand:

1. Place the monitor on a soft cloth or cushion at the edge of the desk.



2. Press and hold the stand release button, and then lift the stand off the monitor.

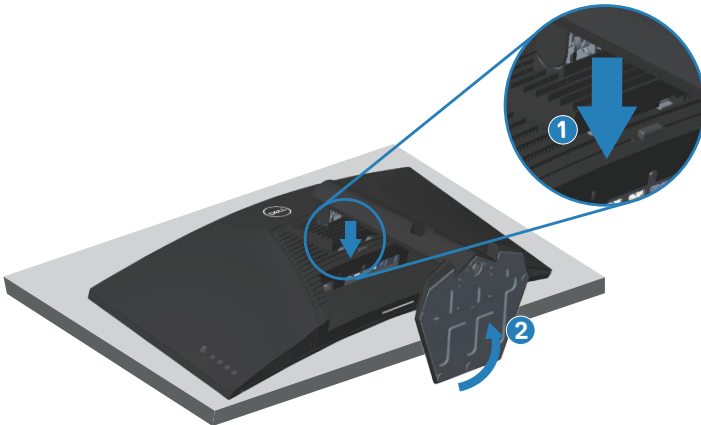



Wall mounting (optional)

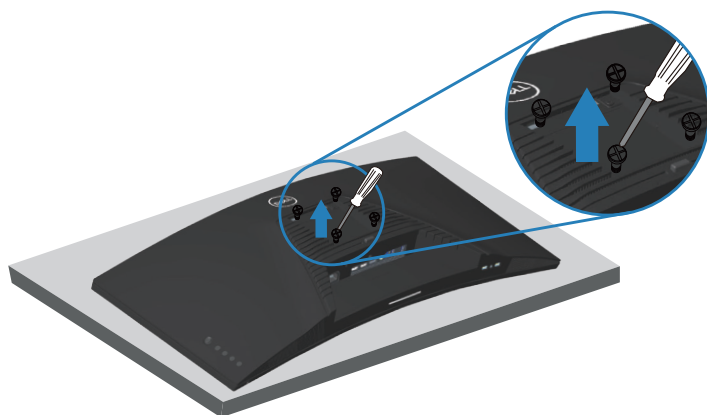

(Screw dimension: M4 x 10 mm).

See the documentation that shipped with the VESA-compatible wall mounting kit.

1. Lay the monitor on a soft cloth or cushion at the edge of the desk.
2. Remove the stand. See [Removing the stand](#) for details.
3. Remove the four screws that secure the panel to the monitor.
4. Attach the mounting bracket from the wall mounting kit to the monitor.
5. To mount the monitor on the wall, see the documentation that shipped with the wall mounting kit.



NOTE: For use only with UL or CSA or GS-listed wall mount bracket with minimum weight/load bearing capacity of 30.84 kg.



Operating your monitor

⚠ **CAUTION:** Before using the monitor, it is recommended to fasten the stand riser to a wall using cable tie or a cord that can support the weight of the monitor in order to prevent the monitor from falling.

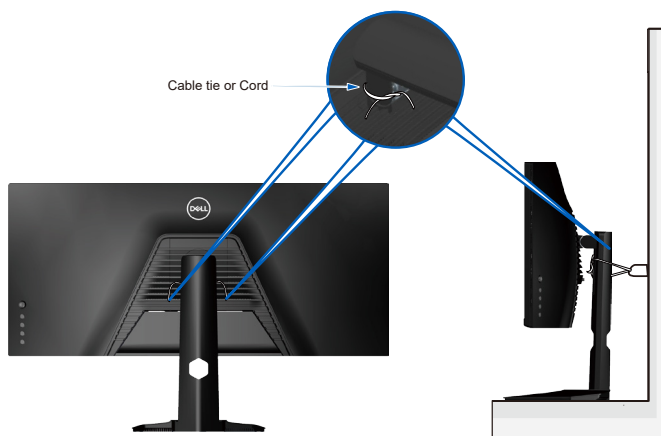

Power on the monitor

Press the  button to turn on the monitor.

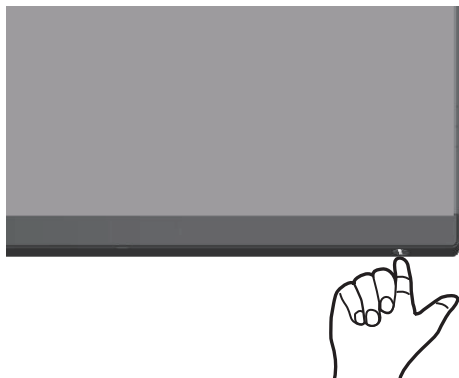

Using the joystick control



Use the buttons on the bottom of the monitor to adjust the image settings.



1. Press the joystick button to launch the OSD main menu.
2. Move the joystick up/down/left/right to toggle between options.
3. Press the joystick button again to confirm the settings and exit.



Joystick Description



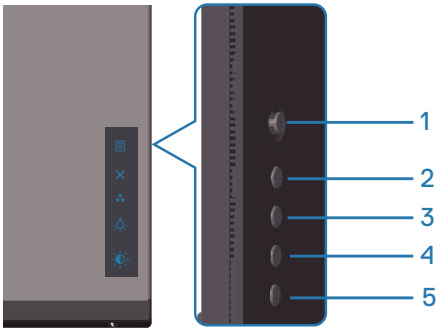

Joystick	Description
	<ul style="list-style-type: none">• When the OSD menu is on, press the button to confirm the selection or save the settings.• When the OSD menu is off, press the button to launch the OSD main menu. See Accessing the menu system.
	<ul style="list-style-type: none">• For 2-way (right and left) directional navigation.• Move right to enter the submenu.• Move left to exit from the submenu.• Increases (right) or decreases (left) the parameters of selected menu item.
	<ul style="list-style-type: none">• For 2-way (up and down) directional navigation.• Toggles between the menu items.• Increases (up) or decreases (down) the parameters of selected menu item.

Using the rear-panel controls

Use the control buttons on the rear of the monitor to adjust the display settings. As you use these buttons to adjust the settings, an OSD shows the numeric values of each feature as they change.



The following table describes the rear-panel buttons:

Control Buttons		Description
1	 Menu	Use the Menu button at launch your on-screen display (OSD) and select the OSD menu. See Accessing the menu system .
2	 Exit	Use this button to go back to the main menu or exit the OSD main menu.
3	 Shortcut key/Presets Modes	Use this button for choose from a list of preset modes.
4	 Shortcut key/Downlight	Use this button to turn on or turn off lights on the bottom of the monitor.
5	 Shortcut key/Brightness/Contrast	Use the buttons for Brightness/Contrast.



Using the On-Screen Display (OSD) menu

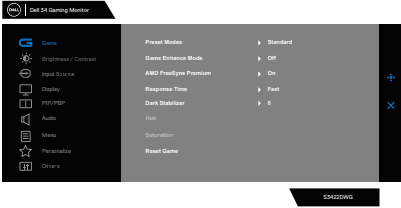

Accessing the menu system

Icon	Menu and Submenus	Description
	Game	







Preset Modes	<p>Allows you to choose from a list of preset color modes.</p> <ul style="list-style-type: none"> • Standard: Loads the monitor's default color settings. This is the default preset mode. • FPS: Loads color settings ideal for First-Person Shooter games. • MOBA/RTS: Loads color settings ideal for Multiplayer Online Battle Arena (MOBA) and Real-Time Strategy (RTS) games. • RPG: Loads color settings ideal for Role-Playing games. • SPORTS: Loads color settings ideal for "SPORTS" games. • Game 1/Game 2/Game 3: Allows you to customize the color settings for your gaming needs. • ComfortView: Decreases the level of blue light emitted from the screen to make viewing more comfortable for your eyes. WARNING: The possible long-term effects of blue light emission from the monitor may cause personal injury such as digital eye strain, eye fatigue and damage to the eyes. Using monitor for extended periods of time may also cause pain in parts of body such as neck, arm, back and shoulder. For more information, see Ergonomics. • Warm: Increases the color temperature. The screen appears warmer with a red/yellow tint. • Cool: Decreases the color temperature. The screen appears cooler with a blue tint. • Custom Color: Allows you to manually adjust the color settings. Move the joystick to adjust the Gain, Offset, Hue, and Saturation values and create your own preset color mode.
---------------------	--



Game Enhance Mode	<p>Adjusts Game Enhance Mode to Off, Timer, Frame Rate or Display Alignment.</p> <ul style="list-style-type: none"> • Off: Select to disable the functions under Game Enhance Mode. • Timer: Allows you to disable or enable the timer at the upper left corner of the display. The timer shows the time elapsed since the game starts. Select an option from the time-interval list to keep you aware of the remaining time. • Frame Rate: Selecting On allows you to display the current frames per second when playing games. The higher the rate, the smoother the motion appears. • Display Alignment: Activating the function may help ensure the perfect alignment of the video contents from multiple displays.
AMD FreeSync Premium Pro	<p>Allows you to set the AMD FreeSync Premium Pro On or Off.</p>
Response Time	<p>Allows you to set the Response Time to Fast, Super Fast, Extreme or MPRT.</p> <p> NOTE: When Response Time is set to MPRT, Brightness cannot be adjusted.</p>
Dark Stabilizer	<p>The feature improves the visibility in the dark gaming scenarios. The higher the value (between 0 to 3), the better visibility in dark area of the display image.</p>
Hue	<p>This feature can shift the color of the video image to green or purple. This is used to adjust the desired flesh tone color.</p> <p>Use the joystick to adjust the hue from 0 to 100. Move the joystick up to increase the green shade of the video image.</p> <p>Move the joystick down to increase the purple shade of the video image.</p> <p> NOTE: The Hue adjustment is available only when you select FPS, MOBA/RTS, SPORTS, or RPG preset mode.</p>

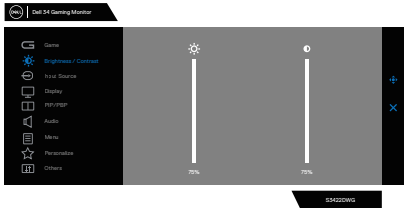

	Saturation	<p>This feature can adjust the color saturation of the video image.</p> <p>Use the joystick to adjust the saturation from 0 to 100.</p> <p>Move the joystick up to increase the colorful appearance of the video image.</p> <p>Move the joystick down to increase the monochrome appearance of the video image.</p> <p> NOTE: The Saturation adjustment is available only when you select FPS, MOBA/RTS, SPORTS, or RPG preset mode.</p>
	Reset Game	Resets all settings under the Game menu to the factory defaults.
	Brightness/Contrast	<p>Use this menu to adjust the brightness and contrast.</p> 
	Brightness	<p>Brightness adjusts the luminance of the backlight(minimum 0; maximum 100).Move the joystick up to increase brightness.Move the joystick down to decrease brightness.</p> <p> NOTE: When Response Time is set to MPRT, Brightness cannot be adjusted.</p>
	Contrast	<p>Adjust the Brightness first, and then adjust Contrastonly if further adjustment is necessary.</p> <p>Move the joystick up to increase contrast and Move thejoystick down to decrease contrast (between 0 and 100).</p> <p>The Contrast function adjusts the degree of differencebetween darkness and lightness on the monitor screen.</p>





Input Source

Use the input source menu to select between the different video signals that may be connected to your monitor.



DP

Select DP input when you are using the DP (DisplayPort) connector. Press the joystick button to confirm the selection.

HDMI 1

Select the **HDMI 1** or **HDMI 2** input when you are using the HDMI connector. Press the joystick button to confirm the selection.

HDMI 2

Auto Select

Turn on the function to allow the monitor to automatically scan for available input sources. Press the joystick button to confirm the selection.

Reset Input Source

Resets all settings under the Input Source menu to the factory defaults.



Display

Use the display to adjust image.

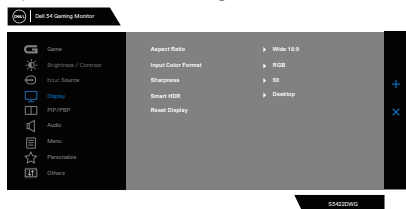

Aspect Ratio

Adjusts the image ratio to 21:9, Auto Resize or 4:3.



Input Color Format	<ul style="list-style-type: none">• RGB: Select this option if your monitor is connected to a computer or a media player that supports RGB output.• YCbCr: Select this option if your media player supports only YCbCr output. 
Sharpness	<p>Makes the image look sharper or softer.</p> <p>Move the joystick up and down to adjust the sharpness from '0' to '100'.</p>



	Smart HDR	<p>Move the joystick to switch the Smart HDR feature between Desktop, Movie HDR, Game HDR, DisplayHDR, and Off.</p> <p>Smart HDR (High Dynamic Range) automatically enhances the display output by adjusting the settings optimally to resemble life-like visuals.</p> <ul style="list-style-type: none"> • Desktop: This is the default mode. This mode is more suitable for general usage of the monitor with a desktop computer. • Movie HDR: Use this mode during playback of HDR video content to expand the contrast ratio, brightness, and color palette. It matches the video quality with real life visuals. • Game HDR: Use this mode when playing games that support HDR to expand the contrast ratio, brightness, and color palette. It makes gaming experience more realistic as intended by game developers. • DisplayHDR 400: Best used with content that complies with DisplayHDR 400 standards. • Off: Disables Smart HDR function. <p> NOTE: The possible peak luminance during HDR mode is 500-nits (typical). The actual value and duration during HDR playback might vary according to the video content.</p>
	Reset Display	Select this option to restore default display settings.





PIP/PBP

Allows you to watch more images at the same time.

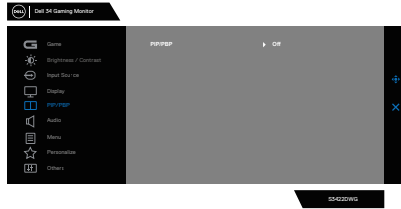

PIP/PBP Mode

Adjusts the PIP or PBP mode. You can disable this feature by selecting Off.

 **NOTE: FreeSync is turned off when PIP/PBP is enabled.**

PIP/PBP (Sub)

Select between DP, HDMI1 or HDMI2 video signals that may be connected to your monitor for the PIP/PBP sub-window.

Main Window	Sub-Window		
	DP	HDMI1	HDMI2
DP	—	✓	✓
HDMI1	✓	—	✓
HDMI2	✓	✓	—

Video Swap

Select to swap videos between main window and sub-window in PIP/PBP mode.

Audio





Allows you to set the Audio Main or Sub.

Contrast (Sub)





Adjust the contrast level of the picture in PIP/PBP mode.

 **NOTE: Only applicable when user turns on PIP/PBP.**





	Audio	
	Volume	Allows you to set the volume level of headphone output. Use the joystick to adjust the volume level from 0 to 100.
	Reset Audio	Resets all settings under the Audio menu to the factory defaults.
	Menu	<p>Select this option to adjust the settings of the OSD, such as the languages of the OSD, the amount of time the menu remains on screen, and so on.</p> 
	Language	Set the OSD display to one of eight languages.(English, Spanish, French, German, Brazilian Portuguese,Russian, Simplified Chinese, or Japanese).
	Transparency	Select this option to change the menu transparency bymoving the joystick up or down (min. 0/max. 100).
	Timer	OSD Hold Time: Sets the length of time the OSDremains active after you press a button.Move the joystick to adjust the slider in 1-secondincrements, from 5 to 60 seconds.
	Reset Menu	Resets all settings under the Reset menu to the factorydefaults.



	Personalize	<p>Select this option to adjust the settings of the personalization.</p> 
	Shortcut Key 1	<p>Select from Preset Modes, Game Enhance Mode, AMD FreeSync Premium Pro, Dark Stabilizer, Brightness/Contrast, Input Source, Aspect Ratio, Smart HDR, Volume, Downlight set as shortcut key.</p>
	Shortcut Key 2	
	Shortcut Key 3	
	Power Button LED	<p>Allows you to set the state of the power light to save energy.</p>
	USB	<p>Allows you to set the USB On During Standby or Off During Standby to save energy.</p>
	Downlight	<p>Allows you to turn on or turn off lights on the bottom of the monitor.</p> <p>When the downlights are on, they light up blue.</p> <p>To turn off the touch sensor, select Off.</p> <p> NOTE: On monitors that are manufactured from July 2021, the downlights can be turned on or off only using the OSD menu.</p>
	Reset Personalization	<p>Resets all settings under the Personalize menu to the factory preset values.</p>
	Others	<p>Change the OSD settings, such as the DDC/CI, LCD conditioning, and so on.</p> 
	Display Info	<p>Display the monitor's current settings.</p>

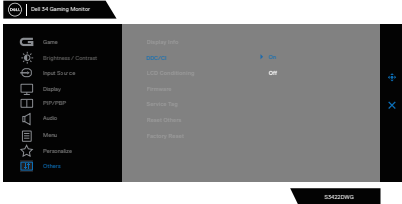
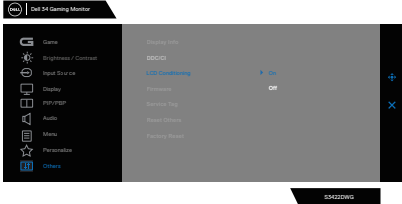

	<p>DDC/CI</p> <p>DDC/CI (Display Data Channel/Command Interface) allows your monitor parameters (brightness, colorbalance, and etc.) to be adjustable via the software on your computer. You can disable this feature by selecting Off. Enable this feature for best user experience and optimum performance of your monitor.</p> 
	<p>LCD Conditioning</p> <p>Helps reduce minor cases of image retention. Depending on the degree of image retention, the program may take some time to run. You can enable this feature by selecting On.</p> 
	<p>Firmware</p> <p>Display the version of the firmware about the display.</p>
	<p>Service Tag</p> <p>Display the service tag number of the display. The Service Tag is a unique alphanumeric identifier that allows Dell to identify the product specifications and access warranty information.</p> <p> NOTE: The Service Tag is also printed on a label located at the back of the cover.</p>
	<p>Reset Others</p> <p>Reset all settings under the others setting menu to the factory preset values.</p>
	<p>Factory Reset</p> <p>Restore all preset values to the factory default settings.</p>

 **NOTE: Your monitor has a built-in feature to automatically calibrate the brightness to compensate for LED aging.**



OSD warning messages

When the monitor does not support a particular resolution mode, the following message is displayed:-

For DP

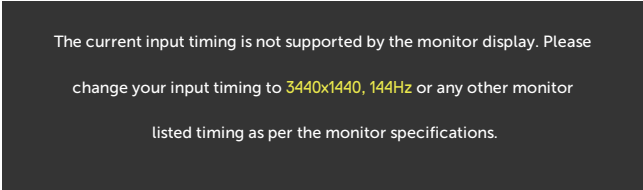
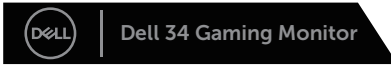

S2422DWG

For HDMI

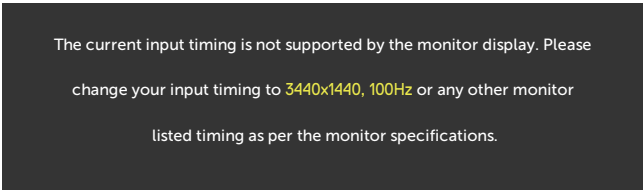

S2422DWG

This means that the monitor cannot synchronize with the signal that it is receiving from the computer. See [Monitor specifications](#) for the Horizontal and Vertical frequency ranges addressable by this monitor. Recommended mode is 3440 x 1440.

Before the **DDC/CI** function is disabled, the following message is displayed:

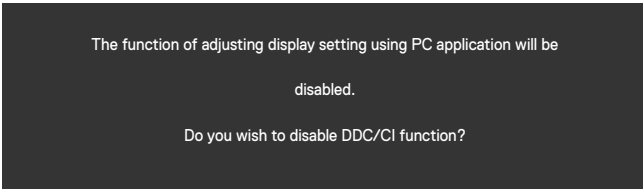
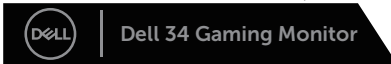

S3422DWG



When the monitor enters the **Standby Mode**, the following message appears:

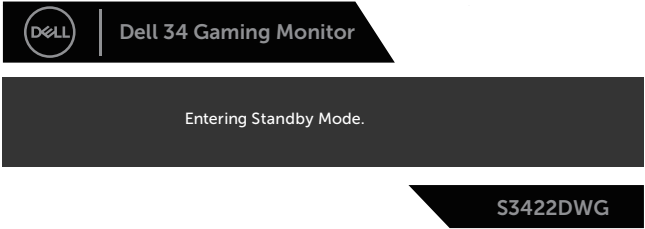

If you press any button other than the power button, the following messages will appear depending on the selected input:



If an HDMI or DP cable is not connected, a floating dialog box as shown below appears. The monitor will enter Standby Mode after 4 minutes if left at this state.



or



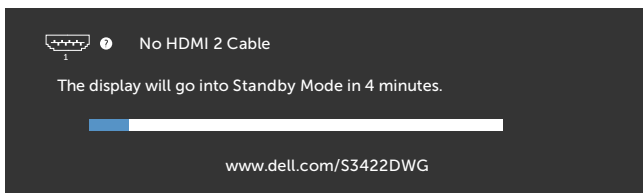

S3422DWG

or

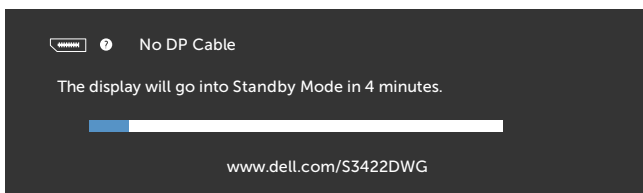

S3422DWG

When you select OSD items of Factory Reset in Other feature, the following message will appear:

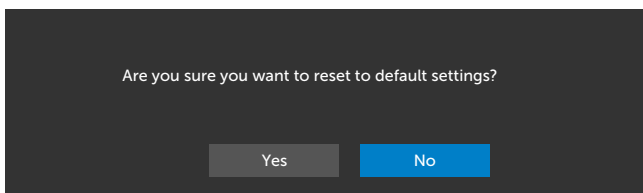

S3422DWG

See [Troubleshooting](#) for more information.



Setting up your monitor

Setting the maximum resolution

To set the maximum resolution for the monitor:

In Windows 8.1:

1. For Windows 8.1, select the Desktop tile to switch to classic desktop.
2. Right-click on the desktop and click **Screen Resolution**.
3. If you have more than one monitor connected, ensure that you select **S3422DWG**.
4. Click the **Screen Resolution** dropdown list and select **3440 x 1440**.
5. Click **OK**.

In Windows 10 and Windows 11:

1. Right-click on the desktop and click **Display settings**.
2. If you have more than one monitor connected, ensure to select **S3422DWG**.
3. Click the **Display Resolution** dropdown list and select **3440 x 1440**.
4. Click **Keep changes**.

If you do not see **3440 x 1440** as an option, you may need to update your graphics driver. Depending on your computer, complete one of the following procedures:

If you have a Dell desktop or portable computer:

- Go to www.dell.com/support, enter your computer's Service Tag, and download the latest driver for your graphics card.

If you are using a non-Dell computer (portable or desktop):

- Go to the support site for your computer and download the latest graphic drivers.
- Go to your graphics card website and download the latest graphic drivers.



Using the tilt and vertical extension

 **NOTE:** These values are applicable to the stand that was shipped with your monitor. To set up with any other stand, see the documentation that shipped with the stand.

Tilt Extension

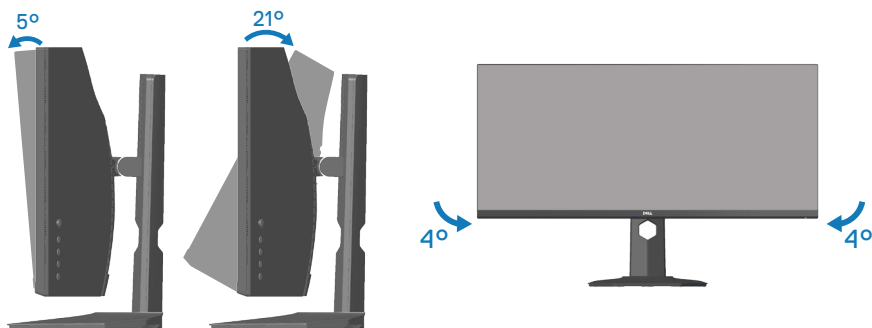

 **NOTE:** The stand is detached when the monitor is shipped from the factory.

 **NOTE:** The slant angle of this monitor is between -4° and $+4^{\circ}$, not allowing for pivot movements.

Vertical Extension

 **NOTE:** The stand can be extended vertically up to 100 mm.

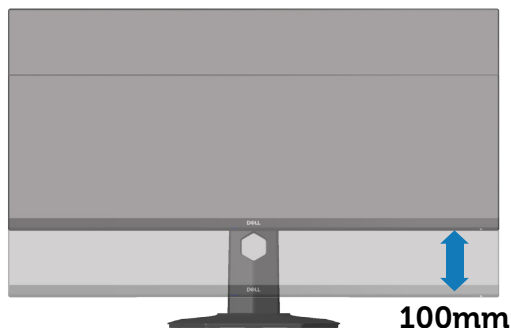

Troubleshooting

 **WARNING:** Before you begin any of the procedures in this section, follow the [Safety Instructions](#).

Self-Test

Your monitor provides a self-test feature that allows you to check if your monitor is functioning properly. If your monitor and computer are properly connected but the monitor screen remains dark, run the monitor self-test by performing the following steps:

1. Turn off both your computer and the monitor.
2. Disconnect all video cables from the monitor. This way, the computer doesn't have to be involved.
3. Turn on the monitor.

If the monitor is working correctly, it detects that there is no signal and one of the following message appears. While in self-test mode, the power LED remains white.



or



or



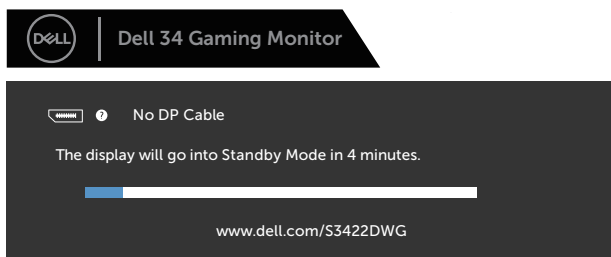

S3422DWG

 **NOTE: This box also appears during normal system operation, if the video cable is disconnected or damaged.**

4. Turn off your monitor and reconnect the video cable; then turn on your computer and the monitor.

If your monitor remains dark after you reconnect the cables, check your video controller and computer.



Built-in diagnostics

Your monitor has a built-in diagnostic tool that helps you determine if any screen abnormality you experience is an inherent problem with your monitor, or with your computer and video card.

 **NOTE: You can run the built-in diagnostics only when the video cable is unplugged and the monitor is in self-test mode.**

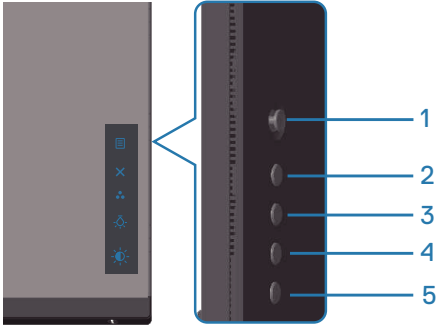

To run the built-in diagnostics:

1. Ensure that the screen is clean (no dust particles on the surface of the screen).
2. Unplug the video cable(s) from the back of the computer or monitor. The monitor then goes into the self-test mode.
3. Press and hold the Exit button (button 5) for four seconds to enter the OSD lock/unlock menu.

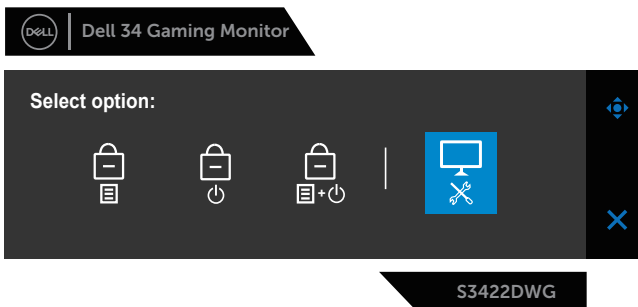

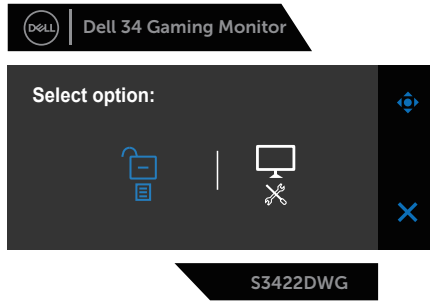

4. Select the  icon to run the built-in diagnostics.
5. Carefully inspect the screen for abnormalities.
6. Press the Right button (button 1) on the back cover again. The color of the screen changes to grey.
7. Inspect the display for any abnormalities.
8. Repeat step 6 and 7 to inspect the display in red, green, blue, black, white and text pattern screens.

The test is complete when the text pattern screen appears. To exit, press the Up button (button 1) again.

If you do not detect any screen abnormalities upon using the built-in diagnostic tool, the monitor is functioning properly. Check the video card and computer.



Common problems

The following table contains general information about common monitor problems you might encounter and the possible solutions:

Common Symptoms	Possible Solutions
No Video/Power LED off	<ul style="list-style-type: none">• Ensure that the video cable connecting the monitor and the computer is properly connected and secure.• Verify that the power outlet is functioning properly using any other electrical equipment.• Ensure that the power button is pressed.• Ensure that the correct input source is selected via the Input Source menu.
No Video/Power LED on	<ul style="list-style-type: none">• Increase brightness and contrast controls using the OSD.• Perform monitor self-test feature check.• Check for bent or broken pins in the video cable connector.• Run the built-in diagnostics.• Ensure that the correct input source is selected via the Input Source menu.
Poor Focus	<ul style="list-style-type: none">• Eliminate video extension cables.• Reset the monitor to Factory Settings (Factory Reset).• Change the video resolution to the correct aspect ratio.
Shaky/Jittery Video	<ul style="list-style-type: none">• Reset the monitor to Factory Settings (Factory Reset).• Check environmental factors.• Relocate the monitor and test in another room.
Missing Pixels	<ul style="list-style-type: none">• Cycle power On-Off.• Pixel that is permanently Off is a natural defect that can occur in LCD technology.• For more information on Dell Monitor Quality and Pixel Policy, see Dell Support site at: www.dell.com/support/monitors.



Stuck-on Pixels	<ul style="list-style-type: none"> • Cycle power On-Off. • Pixel that is permanently off is a natural defect that can occur in LCD technology. • For more information on Dell Monitor Quality and Pixel Policy, see Dell Support site at: www.dell.com/support/monitors
Brightness Problems	<ul style="list-style-type: none"> • Reset the monitor to Factory Settings (Factory Reset). • Adjust brightness & contrast controls via OSD.
Geometric Distortion	<ul style="list-style-type: none"> • Reset the monitor to Factory Settings (Factory Reset). • Adjust horizontal & vertical controls via OSD.
Horizontal/Vertical Lines	<ul style="list-style-type: none"> • Reset the monitor to Factory Settings (Factory Reset). • Perform monitor self-test feature check and determine if these lines are also in self-test mode. • Check for bent or broken pins in the video cable connector. • Run the built-in diagnostics.
Synchronization Problems	<ul style="list-style-type: none"> • Reset the monitor to Factory Settings (Factory Reset). • Perform monitor self-test feature check to determine if the scrambled screen appears in self-test mode. • Check for bent or broken pins in the video cable connector. • Restart the computer in the safe mode.
Safety Related Issues	<ul style="list-style-type: none"> • Do not perform any troubleshooting steps. • Contact Dell immediately.
Intermittent Problems	<ul style="list-style-type: none"> • Ensure that the video cable connecting the monitor to the computer is connected properly and is secure. • Reset the monitor to Factory Settings (Factory Reset). • Perform monitor self-test feature check to determine if the intermittent problem occurs in self-test mode.
Missing Color	<ul style="list-style-type: none"> • Perform monitor self-test feature check. • Ensure that the video cable connecting the monitor to the computer is connected properly and is secure. • Check for bent or broken pins in the video cable connector.



Wrong Color	<ul style="list-style-type: none"> • Try different Preset Modes in Color settings OSD. Adjust R/G/B value in Custom Color in Color settings OSD. • Change the Input Color Format to RGB or YPbPr in the Color settings OSD. • Run the built-in diagnostics.
Image retention from a static image left on the monitor for a long period of time	<ul style="list-style-type: none"> • Set the screen to turn off after a few minutes of screen idle time. These can be adjusted in Windows Power Options or Mac Energy Saver setting. • Alternatively, use a dynamically changing screensaver.
Video Ghosting or Overshooting	<ul style="list-style-type: none"> • Change the Response Time in the Display OSD to Normal, Fast or Extreme depending on your application and usage.



Product-specific problems

Specific Symptoms	Possible Solutions
Screen image is too small	<ul style="list-style-type: none">• Check the Aspect Ratio setting in the Display settings OSD.• Reset the monitor to Factory Settings (Factory Reset).
Cannot adjust the monitor with the buttons on the bottom of the panel	<ul style="list-style-type: none">• Turn Off the monitor, unplug the power cord, plug it back, and then turn On the monitor.• Check if the OSD menu is locked. If yes, press and hold the menu button for 6 seconds to unlock.
No Input Signal when user controls are pressed	<ul style="list-style-type: none">• Check the signal source. Ensure the computer is not in standby or sleep mode by moving the mouse or pressing any key on the keyboard.• Check if the video cable is plugged in properly. Disconnect and reconnect the video cable if necessary.• Reset the computer or video player.
The picture does not fill the entire screen	<ul style="list-style-type: none">• Due to different video formats (aspect ratio) of DVDs, the monitor may display in full screen.• Run the built-in diagnostics.



Appendix

Safety Instructions

 **WARNING: Use of controls, adjustments, or procedures other than those specified in this documentation may result in exposure to shock, electrical hazards, and/or mechanical hazards.**

For information on safety instructions, see the **Safety Environment and Regulatory Information (SERI)**.

FCC notices (U.S. Only) and other regulatory information

For FCC notices and other regulatory information, see the regulatory compliance website located at www.dell.com/regulatory_compliance

Please follow these safety instructions for best performance, and long life for your monitor:

1. The socket-outlet shall be installed near the equipment and shall be easily accessible.
2. The equipment can be installed on wall or ceiling mounting in horizontal position.
3. The monitor is equipped with a three-pronged grounded plug, a plug with a third (Grounding) pin.
4. Do not use this product near water.
5. Read these instructions carefully. Keep this document for future reference. Follow all warnings and instructions marked on product.
6. Excessive sound pressure from earphones and headphones can cause hearing loss. Adjustment of the equalizer to maximum increases the earphones and headphones output voltage and therefore the sound pressure level.



Contacting Dell

For customers in the United States, call 800-WWW-DELL (800-999-3355).

 **NOTE: If you do not have an active Internet connection, you can find contact information on your purchase invoice, packing slip, bill, or Dell product catalog.**

Dell provides several online and telephone-based support and service options. Availability varies by country and product, and some services may not be available in your area.

To get online Monitor support content:

1. Visit www.dell.com/support/monitors

To contact Dell for sales, technical support, or customer service issues:

1. Visit www.dell.com/support
2. Verify your country or region in the **Choose A Country/Region** drop-down menu at the bottom of the page.
3. Click **Contact Us** on the left side of the page.
4. Select the appropriate service or support link based on your need.
5. Choose the method of contacting Dell that is convenient for you.

EU product database for energy label and product information sheet

S3422DWG: <https://eprel.ec.europa.eu/qr/463492>

