

Product data sheet

Specifications

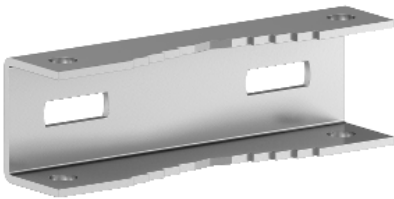

Post fixing device WM Spacial,
length 600. For post max 675. Max.
Load:100kg.

NSYSFPSC60

Overview

Lead time	Usually Ships within 4 Weeks
-----------	------------------------------

Main

Range	Spacial
Accessory / separate part category	Fixing accessory
Product or component type	Post fixing device
Device application	Multi-purpose
Enclosure nominal dimensions	-
Mounting location	Rear of enclosure
Range compatibility	Spacial S3D Spacial SBM Spacial CRN
Device composition	fixing elements 2 support rail 2 strip
Quantity per set	Set of 1

Complementary

Material	Galvanised steel
Fixing mode	By fixing element - screw type M8 - to the inserts in the rear of the enclosure location Minimum diameter 150 mm Maximum diameter 215 mm
Permanent permissible load	100 kg
Height	45 mm
Width	595 mm
Depth	32.5 mm
Net weight	3.2 kg

Packing Units

Unit Type of Package 1	PCE
Number of Units in Package 1	1
Package 1 Weight	3.2 kg

Package 1 Height	59.6 cm
Package 1 width	14.0 cm
Package 1 Length	4.0 cm

Offer Sustainability

Sustainable offer status	Green Premium product
REACH Regulation	REACH Declaration
REACH free of SVHC	Yes
EU RoHS Directive	Pro-active compliance (Product out of EU RoHS legal scope) EU RoHS Declaration
Toxic heavy metal free	Yes
Mercury free	Yes
RoHS exemption information	Yes
China RoHS Regulation	China RoHS declaration Pro-active China RoHS declaration (out of China RoHS legal scope)
Environmental Disclosure	Product Environmental Profile

Contractual warranty

Warranty	18 months
----------	-----------